

# CHANCELLOR DRIVE

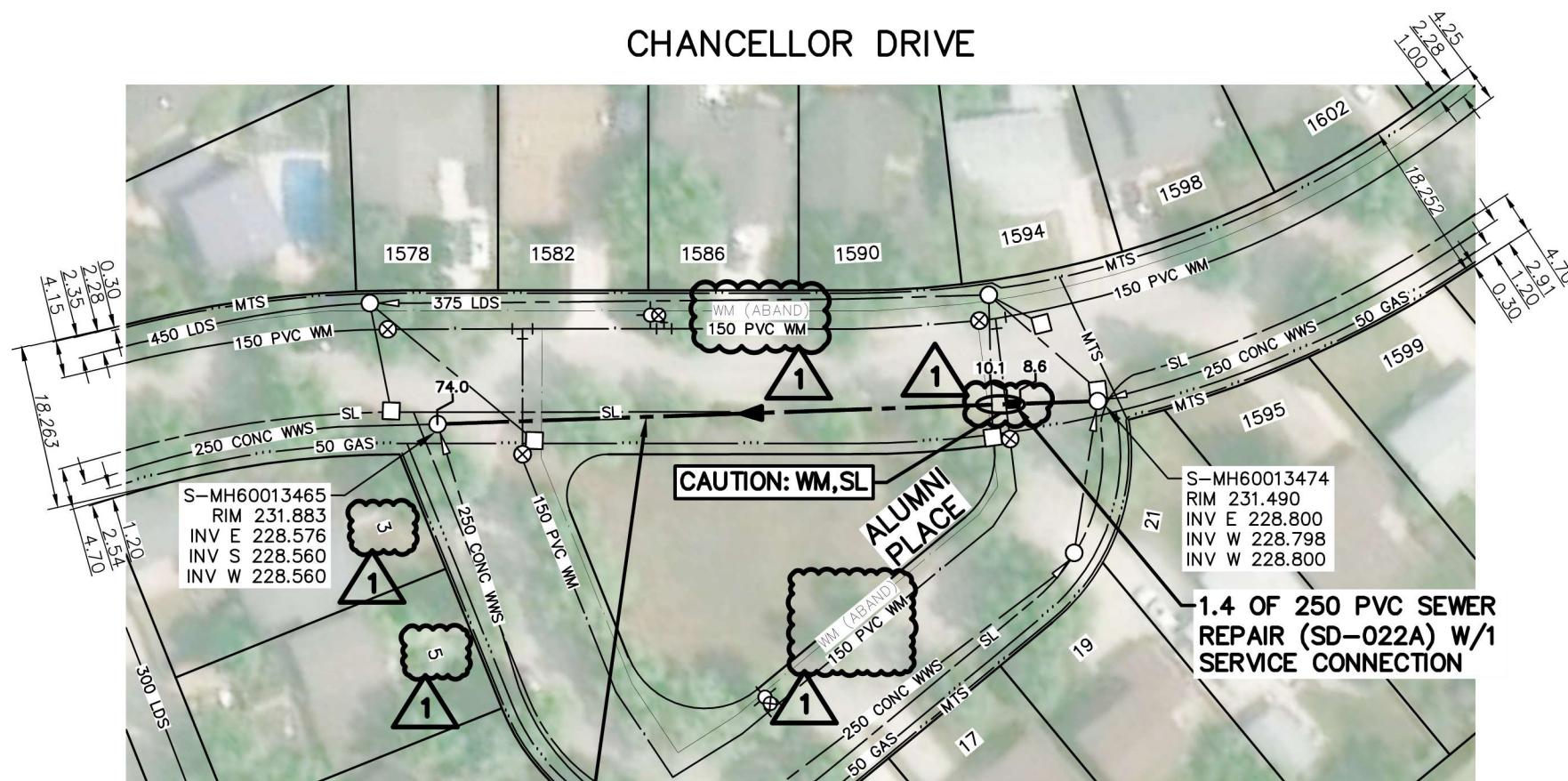

S-MH60013465  
RIM 231.883  
INV E 228.576  
INV S 228.560  
INV W 228.560

S-MH60013474  
RIM 231.490  
INV E 228.800  
INV W 228.798  
INV W 228.800

74.0 OF 250 CONC WWS  
TO BE LINED S-MA60015751  
(FULLY DETERIORATED)

1.4 OF 250 PVC SEWER  
REPAIR (SD-022A) W/1  
SERVICE CONNECTION

SEWER JUNCTION INFORMATION FROM SEWER VIDEO INSPECTION		
SEWER ID S-MA60015751		
DISTANCE FROM S-MH60013474		
DISTANCE	DIAMETER	CLOCK
9.5	150	2:00
24.9	150	2:00
40.2	150	2:00
55.7	150	2:00
70.1	150	2:00

## WARNING

IF POWER EQUIPMENT OR EXPLOSIVES ARE TO BE USED FOR EXCAVATION ON THIS PROJECT THE CONTRACTOR MUST:  
1) NOTIFY THE GAS COMPANY OF THE PROPOSED LOCATION OF EXCAVATION.  
2) TAKE PRECAUTION TO AVOID DAMAGE TO GAS COMPANY INSTALLATIONS.  
SEE PROVINCIAL REGULATION 140/92 FOR DETAILS

**ENGINEERS GEOSCIENTISTS MANITOBA**  
Certificate of Authorization  
Stantec Consulting Ltd.  
No. 1301

FOR INDEX SEE 13826

TENDER NO. 1137-2025



## METRIC

WHOLE NUMBERS INDICATE MILLIMETRES  
DECIMALIZED NUMBERS INDICATE METRES

### LOCATION APPROVED UNDERGROUND STRUCTURES

SUPV. U/G STRUCTURES COMMITTEE DATE

NOTE:  
LOCATION OF UNDERGROUND STRUCTURES AS SHOWN ARE BASED ON THE BEST INFORMATION AVAILABLE BUT NO GUARANTEE IS GIVEN THAT ALL EXISTING UTILITIES ARE SHOWN OR THAT THE GIVEN LOCATIONS ARE EXACT. CONFIRMATION OF EXISTENCE AND EXACT LOCATION OF ALL SERVICES MUST BE OBTAINED FROM THE INDIVIDUAL UTILITIES BEFORE PROCEEDING WITH CONSTRUCTION.

NO.	REVISIONS	DATE	BY
1	REVISED FOR TENDER ADDENDUM 2	26.03.26	NK
0	ISSUED FOR CONSTRUCTION	26.03.04	NK

**Stantec**  
311 Portage Avenue, Winnipeg, Manitoba  
Tel 204-489-5900 Fax 204-453-9012

DESIGNED BY	NK	CHECKED BY	RS
DRAWN BY	MR	APPROVED BY	NK
HOR. SCALE:	1:750	RELEASED FOR CONSTRUCTION:	S. COURNOYER, P. ENG.
VERTICAL:		DATE	26.03.03
DATE	26.02.13		

ENGINEER'S SEAL  
KEHLER  
Member 30100  
REGISTERED PROFESSIONAL ENGINEER  
2026-03-27  
CONSULTANT DRAWING NO. C-105

**THE CITY OF WINNIPEG**  
WATER AND WASTE DEPARTMENT

2025 SEWER MAIN RENEWALS BY CIPP LINING  
CONTRACT 4  
**CHANCELLOR DRIVE**  
MH AT ALUMNI PLACE (E LEG) TO  
MH AT ALUMNI PLACE (W LEG)

SHEET	OF
7	48
CAD FILE DRAWING NUMBER	
20976c-101-108.dwg	
CITY DRAWING NUMBER	
13831	