

WALLER AVENUE

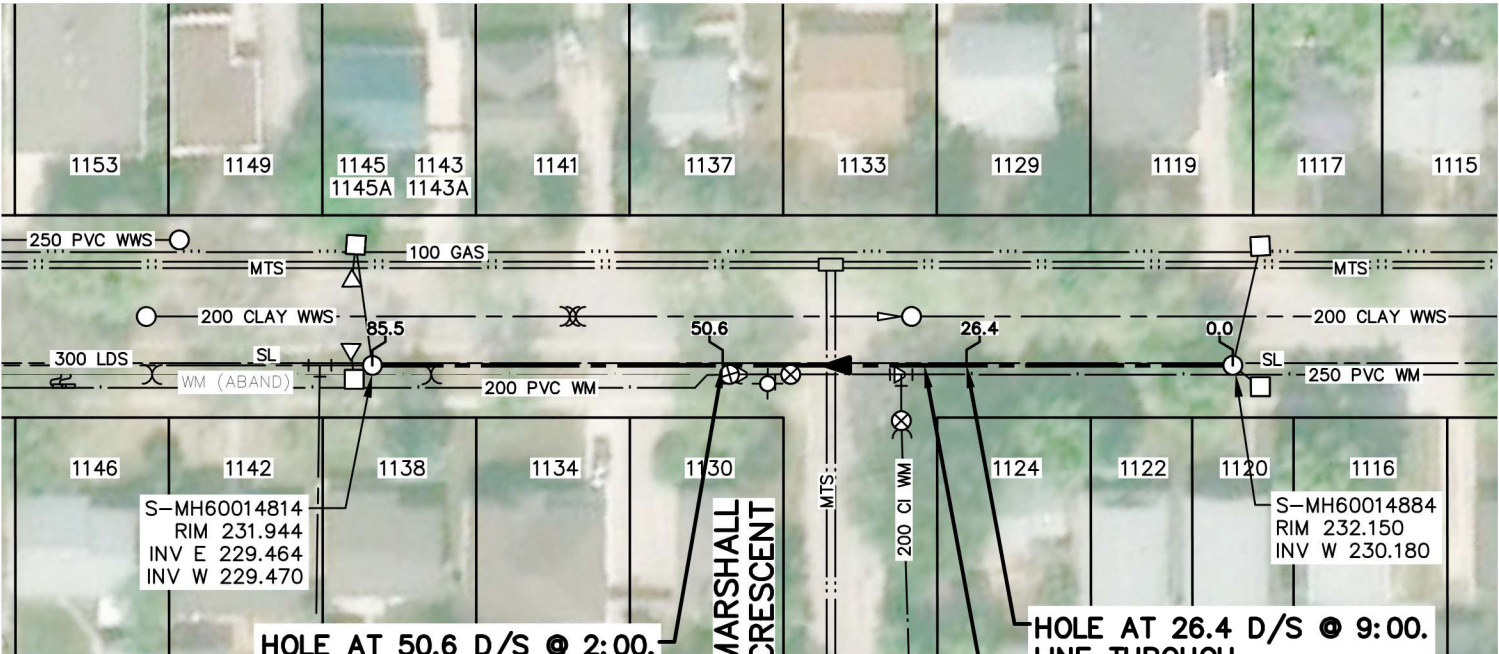

S-MH60014814
RIM 231.944
INV E 229.464
INV W 229.470

S-MH60014884
RIM 232.150
INV W 230.180

HOLE AT 50.6 D/S @ 2:00.
LINE THROUGH

HOLE AT 26.4 D/S @ 9:00.
LINE THROUGH

85.5 OF 300 LDS TO BE
LINED S-MA60017186
(FULLY DETERIORATED)

WARNING

IF POWER EQUIPMENT OR EXPLOSIVES ARE TO BE USED FOR EXCAVATION ON THIS PROJECT THE CONTRACTOR MUST:
1) NOTIFY THE GAS COMPANY OF THE PROPOSED LOCATION OF EXCAVATION.
2) TAKE PRECAUTION TO AVOID DAMAGE TO GAS COMPANY INSTALLATIONS.
SEE PROVINCIAL REGULATION 140/92 FOR DETAILS



Certificate of Authorization
Stantec Consulting Ltd.
No. 1301

FOR INDEX SEE
13826

TENDER NO. 1137-2025

SEWER JUNCTION INFORMATION FROM SEWER VIDEO INSPECTION		
SEWER ID S-MA60017186		
DISTANCE FROM S-MH60014884		
DISTANCE	DIAMETER	CLOCK
NO SERVICE JUNCTIONS		



METRIC

WHOLE NUMBERS INDICATE MILLIMETRES
DECIMALIZED NUMBERS INDICATE METRES

LOCATION APPROVED
UNDERGROUND STRUCTURES

SUPV. U/G STRUCTURES DATE
COMMITTEE

NOTE:
LOCATION OF UNDERGROUND STRUCTURES AS SHOWN ARE BASED ON THE BEST INFORMATION AVAILABLE BUT NO GUARANTEE IS GIVEN THAT ALL EXISTING UTILITIES ARE SHOWN OR THAT THE GIVEN LOCATIONS ARE EXACT. CONFIRMATION OF EXISTENCE AND EXACT LOCATION OF ALL SERVICES MUST BE OBTAINED FROM THE INDIVIDUAL UTILITIES BEFORE PROCEEDING WITH CONSTRUCTION.

B.M. ELEV.			
0	ISSUED FOR CONSTRUCTION	26.03.04	NK
NO.	REVISIONS	DATE	BY



Stantec

311 Portage Avenue, Winnipeg, Manitoba
Tel 204-489-5900 Fax 204-453-9012

DESIGNED BY	NK	CHECKED BY	RS
DRAWN BY	MR	APPROVED BY	NK
HOR. SCALE:	1:750	RELEASED FOR CONSTRUCTION:	S. COURNOYER, P. ENG.
VERTICAL:		DATE	26.03.03
DATE	26.02.13		



CONSULTANT DRAWING NO.
C-139



THE CITY OF WINNIPEG
WATER AND WASTE DEPARTMENT

2025 SEWER MAIN RENEWALS BY CIPP LINING
CONTRACT 4
WALLER AVENUE
1ST MH E OF MARSHALL CRESCENT (E LEG) TO
1ST MH W OF MARSHALL CRESCENT (E LEG)

SHEET	OF
41	48
CAD FILE DRAWING NUMBER 20976c-132-139.dwg	
CITY DRAWING NUMBER 13865	