

NOTE: CHAINAGES SHOWN ARE ALONG W R OF ST. ANNE'S RD

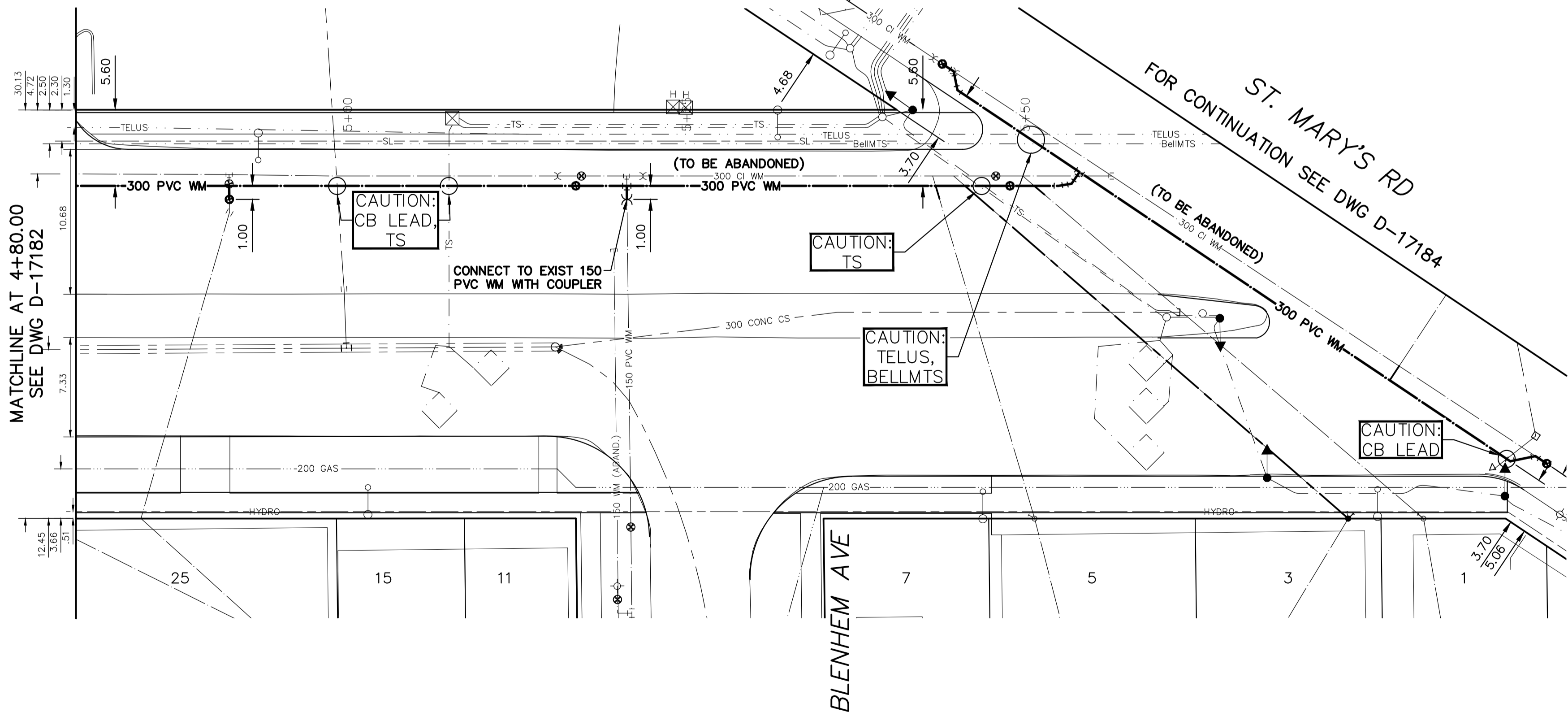

ST. ANNE'S ROAD



WATER SERVICE INFORMATION

ADDRESS	SIZE (mm)	SIZE (mm)	SHORT & LONG MEASUREMENT	CORP. LOCATION	REMARKS
1 ST. ANNE'S ROAD COMMERCIAL	UNKN	20	0.78 NSL HSE	29.5 S OF S/C	RECONNECT SERVICE
*3 ST. ANNE'S ROAD COMMERCIAL	UNKN	12	1.22 SNL HSE	29.1 S OF S/C	RENEW TO R
5 ST. ANNE'S ROAD COMMERCIAL	UNKN	25	2.46 NSL HSE	7.5 S OF S/C	RECONNECT SERVICE
25 ST. ANNE'S ROAD COMMERCIAL	50	50	7.24 SNL HSE	OPP VALVE	RECONNECT SERVICE
	CU	CU	94.190 SSEL ST. MARY'S RD		

*SERVICES TO BE RENEWED TO R. ALL OTHERS TO BE RECONNECTED

ENGINEERS GEOSCIENTISTS MANITOBA
 Certificate of Authorization
 WSP Canada Inc.
 No. 5750

NOTE: ALL VALVES TO BE INSTALLED CLOCKWISE TO CLOSE

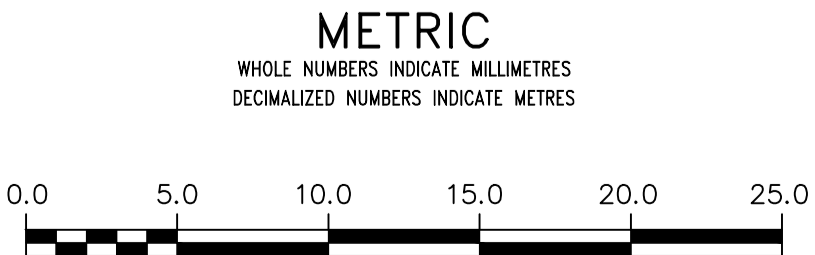

WARNING
 IF POWER EQUIPMENT OR EXPLOSIVES ARE TO BE USED FOR EXCAVATION ON THIS PROJECT THE CONTRACTOR MUST:
 1) NOTIFY THE GAS COMPANY OF THE PROPOSED LOCATION OF EXCAVATION.
 2) TAKE PRECAUTION TO AVOID DAMAGE TO GAS COMPANY INSTALLATIONS.
 SEE PROVINCIAL REGULATION 210/72 FOR DETAILS

LOCATION APPROVED UNDERGROUND STRUCTURES
 SUPV. U/G STRUCTURES COMMITTEE DATE
 NOTE:
 LOCATION OF UNDERGROUND STRUCTURES AS SHOWN ARE BASED ON THE BEST INFORMATION AVAILABLE BUT NO GUARANTEE IS GIVEN THAT ALL EXISTING UTILITIES ARE SHOWN OR THAT THE GIVEN LOCATIONS ARE EXACT. CONFIRMATION OF EXISTENCE AND EXACT LOCATION OF ALL SERVICES MUST BE OBTAINED FROM THE INDIVIDUAL UTILITIES BEFORE PROCEEDING WITH CONSTRUCTION.

B.M. ELEV.	DESIGNED BY	CHECKED BY	DATE	BY
G	N.T.	K.G.		
F				
E				
D				
C				
B	ISSUED FOR TENDER		2025/02/18	N.T.
A	PRELIMINARY DESIGN		2025/01/27	N.T.
NO.	REVISIONS		DATE	BY

wsp
 1600 Buffalo Place
 Winnipeg, Manitoba
 R3T 6B8 Canada
 Phone: 204-477-6650
 Fax: 204-474-2864
 wsp.com

DESIGNED BY: N.T.
 CHECKED BY: K.G.
 DRAWN BY: N.T.
 APPROVED BY: S.M.
 RELEASED FOR CONSTRUCTION
 DATE: 2025 02 18

ENGINEER'S SEAL
 CONSULTANT DRAWING NUMBER
CA0043377.5914-15

THE CITY OF WINNIPEG
 WATER AND WASTE DEPARTMENT
 ENGINEERING DIVISION

2025 ST. ANNE'S WATERMAIN RENEWAL

ST. ANNE'S ROAD
 60.6 W OF ST. MARY'S RD TO
 ST. MARY'S RD

SHEET **06** OF **09**
 CITY DRAWING NUMBER
D-17183