

WATER SERVICE INFORMATION

ADDRESS	SIZE (mm) MATERIAL (STREET)	SIZE (mm) MATERIAL (PROP.)	SHORT & LONG MEASUREMENT	LINEAR DISTANCE (1) CORP LOCATION (2)	REMARKS
589 JOHNSON AVE E	20	20	OPP EL HSE	3.0 W OF S/C	RECONNECT SERVICE
RESIDENTIAL	CU	CU	250.074 EEL GATEWAY RD		
591 JOHNSON AVE E	20	20	OPP EL HSE	0.8 W OF S/C	RECONNECT SERVICE
RESIDENTIAL	CU	CU	260.111 EEL GATEWAY RD		
* 593 JOHNSON AVE E	12	12	0.62 WEL HSE	OPP OF S/C	RENEW TO 150 w/19 SERVICE PIPE
RESIDENTIAL	LEAD	LEAD	268.759 EEL GATEWAY RD		
* 595 JOHNSON AVE E	20	20	OPP EL HSE	0.3 W OF S/C	RENEW TO 150 w/19 SERVICE PIPE
RESIDENTIAL	CU	CU	278.298 EEL GATEWAY RD		
* 597 JOHNSON AVE E	12	12	OPP EL HSE	OPP OF S/C	RENEW TO 150 w/19 SERVICE PIPE
RESIDENTIAL	LEAD	LEAD	287.491 EEL GATEWAY RD		
599 JOHNSON AVE E	20	20	2.94 WEL HSE	0.6 W OF S/C	RECONNECT SERVICE
RESIDENTIAL	CU	CU	297.596 EEL GATEWAY RD		
609 JOHNSON AVE E	20	20	0.85 EEL HSE		RECONNECT SERVICE
RESIDENTIAL	CU	CU	44.871 WML GREY ST	2.9 W OF S/C	RECONNECT SERVICE
613 JOHNSON AVE E	20	20	3.14 WEL HSE	0.6 W OF S/C	RECONNECT SERVICE
RESIDENTIAL	CU	CU	36.368 WML GREY ST		
615 JOHNSON AVE E	20	20	2.90 EWL HSE	2.7 W OF S/C	RECONNECT SERVICE
RESIDENTIAL	CU	CU	28.219 WML GREY ST		
615A JOHNSON AVE E	20	20	2.90 EWL HSE	2.7 W OF S/C	RECONNECT SERVICE
RESIDENTIAL	CU	CU	28.219 WML GREY ST		
* 619 JOHNSON AVE E	12	12	1.44 WEL HSE	OPP W OF S/C	RENEW TO 150 w/19 SERVICE PIPE
RESIDENTIAL	LEAD	LEAD	15.254 WML GREY ST		
623 JOHNSON AVE E	20	20	2.33 WEL HSE	0.9 W OF S/C	RECONNECT SERVICE
RESIDENTIAL	CU	CU	5.332 WML GREY ST		

* SERVICES TO BE RENEWED TO 150. ALL OTHERS TO BE RECONNECTED

NOTE: CHAINAGES SHOWN ARE ALONG S R OF JOHNSON AVENUE E

JOHNSON AVENUE E

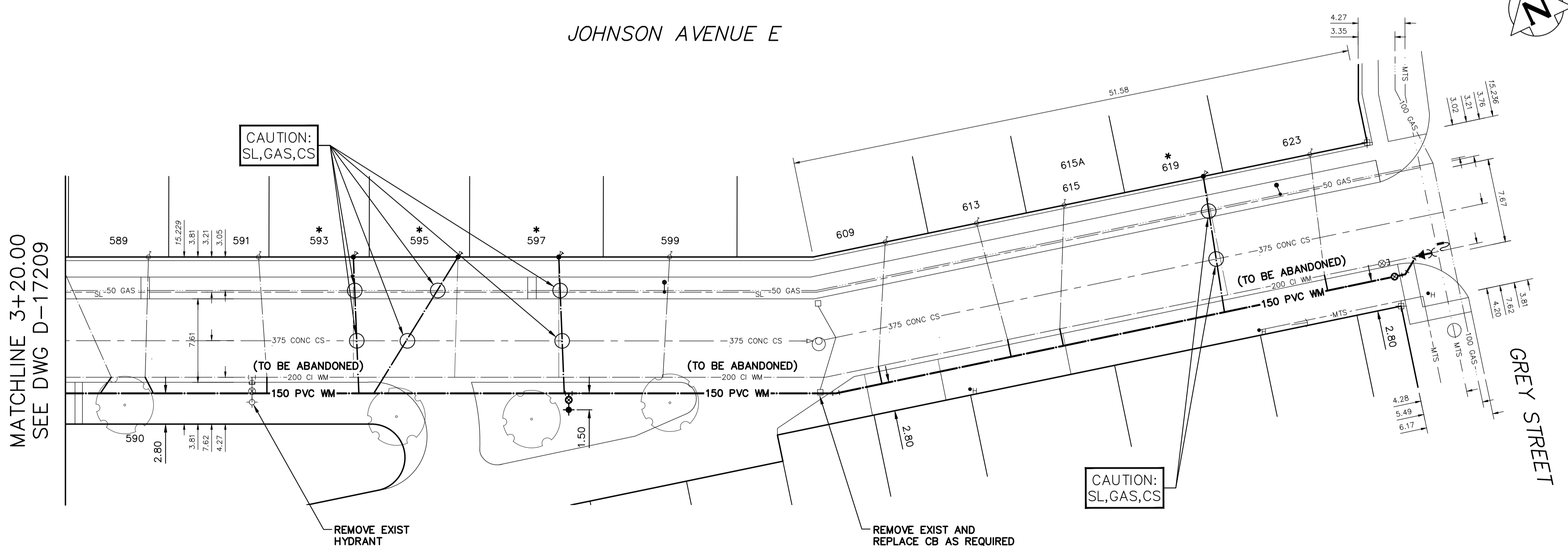

MATCHLINE 3+20.00
SEE DWG D-17209

FOR INDEX SEE
D-17203

NOTE: ALL VALVES TO BE INSTALLED
COUNTERCLOCKWISE TO CLOSE

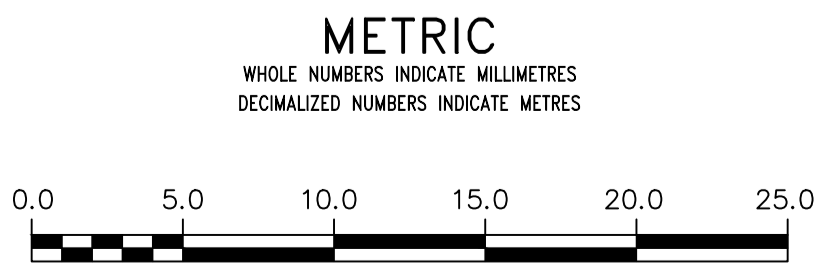

WARNING
IF POWER EQUIPMENT OR EXPLOSIVES ARE TO BE USED FOR EXCAVATION ON THIS PROJECT THE CONTRACTOR MUST:
1) NOTIFY THE GAS COMPANY OF THE PROPOSED LOCATION OF EXCAVATION.
2) TAKE PRECAUTION TO AVOID DAMAGE TO GAS COMPANY INSTALLATIONS.
SEE PROVINCIAL REGULATION 210/72 FOR DETAILS

LOCATION APPROVED UNDERGROUND STRUCTURES
SUPV. U/G STRUCTURES COMMITTEE DATE
NOTE:
LOCATION OF UNDERGROUND STRUCTURES AS SHOWN ARE BASED ON THE BEST INFORMATION AVAILABLE BUT NO GUARANTEE IS GIVEN THAT ALL EXISTING UTILITIES ARE SHOWN OR THAT THE GIVEN LOCATIONS ARE EXACT. CONFIRMATION OF EXISTENCE AND EXACT LOCATION OF ALL SERVICES MUST BE OBTAINED FROM THE INDIVIDUAL UTILITIES BEFORE PROCEEDING WITH CONSTRUCTION.

VERTICAL DATUM: CGVD28 (HT2.0 Geoid)
HORIZONTAL DATUM: NAD83 (June 1990), Zone 14

NO.	COMMENTS	DATE	BY
1	COMMENTS REMOVED	2025/05/16	MA
0	ISSUED FOR TENDER	2025/03/21	RG
	REVISIONS		

DESIGNED BY	RG	CHECKED BY	RG
DRAWN BY	AOM	APPROVED BY	SC
SCALE:		RELEASED FOR CONSTRUCTION	
HORIZONTAL	1:250		
VERTICAL	1:50		
DATE	2025 05 16	DATE	



THE CITY OF WINNIPEG
WATER AND WASTE DEPARTMENT
ENGINEERING DIVISION

2025 WATER MAIN RENEWALS
CONTRACT 4
JOHNSON AVENUE E
250M E OF GATEWAY ROAD TO
GREY STREET

SHEET 9 OF 11
CITY DRAWING NUMBER
D-17210

FILE PATH: R:\DRAWINGS\WATER\RENEWAL\2025 RENEWALS\Cont 4\Construction Dwg\ JOHNSON AVE.dwg