

APPENDIX 'D'

**TEMPROARY TRAFFIC SIGNAGE
DRAWINGS**

Mar 10, 2025 - 1:01pm
F:\2024\CA004\425\8941 - CA-25-R-07 Local Streets\02 Drawings\03_Work_Dwg\CA004\3425\6941_Gillies Cr_Signage.dwg - tab: GILLIES SIGNAGE

GILLIES CRESCENT

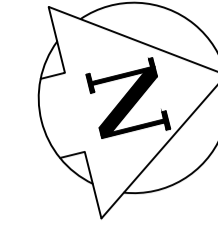
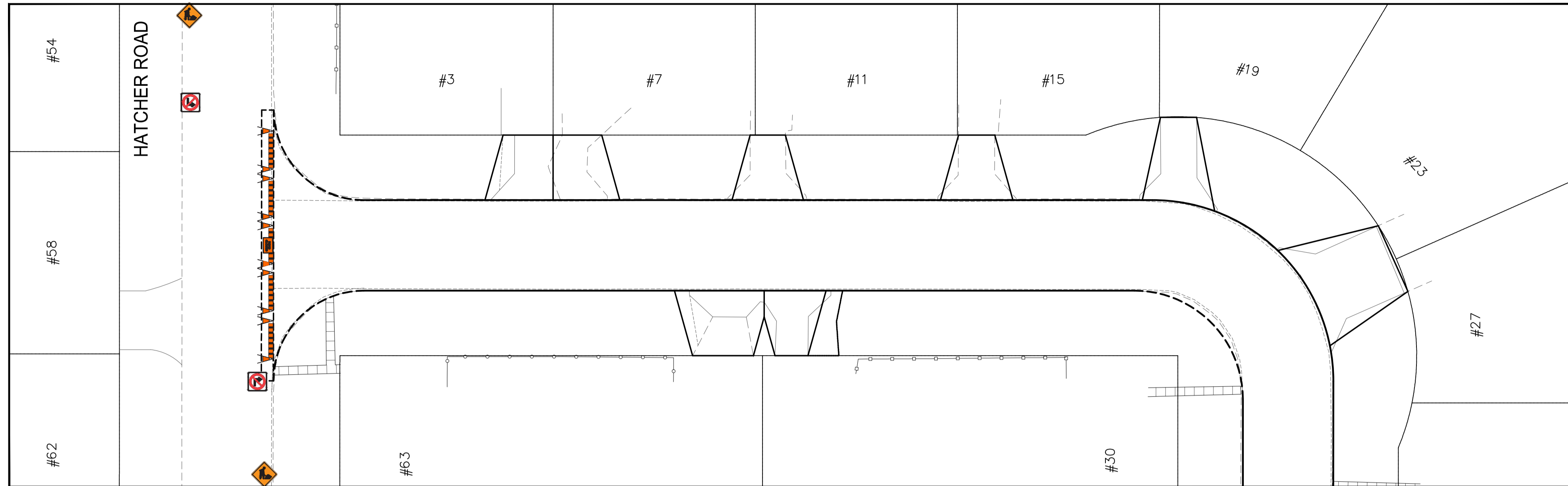

GILLIES CRESCENT

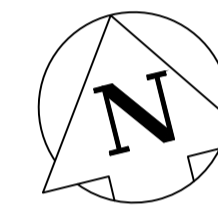
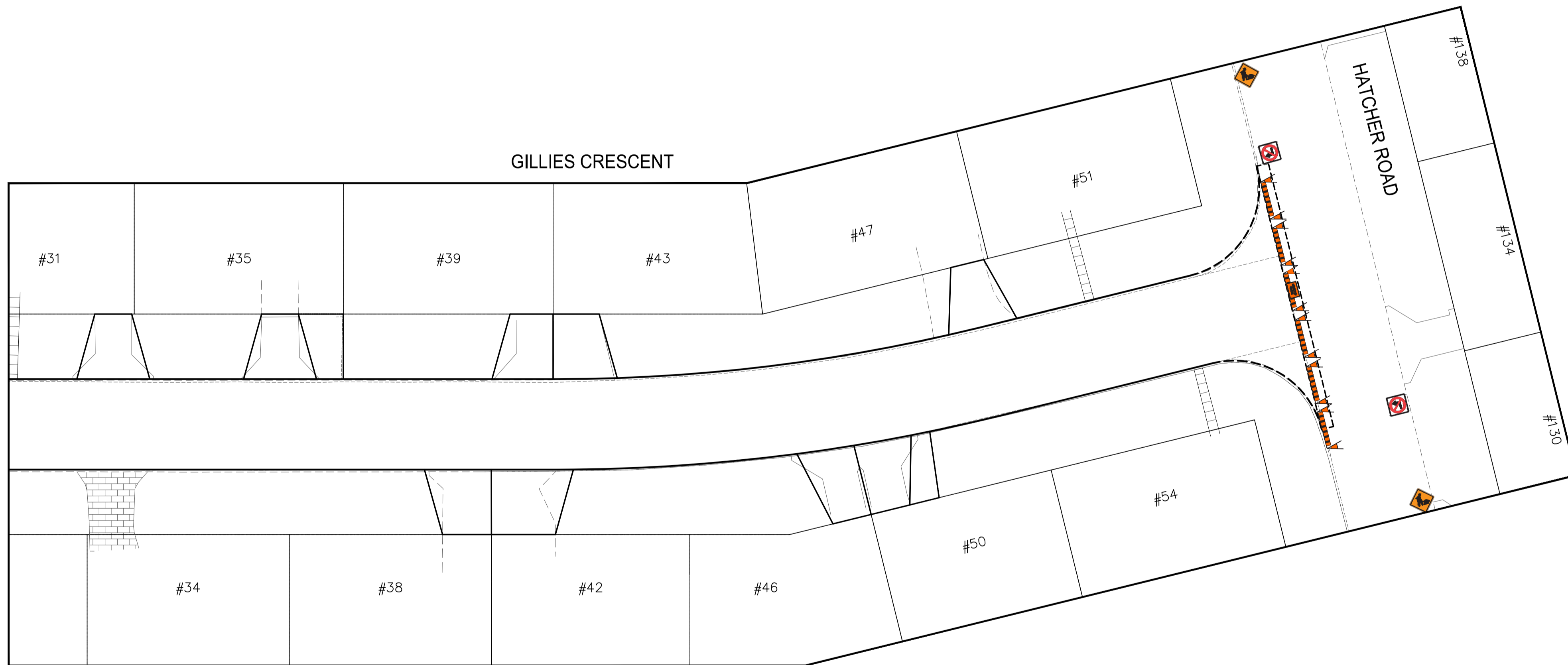

RB-11 (L/R) TURN PROHIBITED



TC-2 ROADWORK



ROAD CLOSED BARRICADE



BARRICADE



NOTES:

1. ALL TRAFFIC SIGNAGE AND TEMPORARY TRAFFIC CONTROL TO CONFORM WITH THE LATEST REVISION OF THE CITY OF WINNIPEG MANUAL OF TEMPORARY TRAFFIC CONTROL ON CITY STREETS
2. CONTRACTOR TO MAINTAIN RESIDENT ACCESS TO PRIVATE APPROACHES.
3. PARKING TO BE REMOVED AT THE TIME OF CONSTRUCTION

METRIC

WHOLE NUMBERS INDICATE MILLIMETRES
DECIMALIZED NUMBERS INDICATE METRES

**ENGINEERS
GEOLOGISTS
MANITOBA**
Certificate of Authorization
WSP Canada Inc.
No. 5750

FOR INFORMATION ONLY



THE CITY OF WINNIPEG
PUBLIC WORKS DEPARTMENT
ENGINEERING SERVICES DIVISION

2025 LOCAL STREET RENEWALS

GILLIES CRESCENT

TEMPORARY TRAFFIC SIGNAGE



WSP Canada Inc.
1600 Buffalo Place
Winnipeg, MB R3T 6B8
t. 204.477.6650
f. 204.474.2864
www.wsp.com

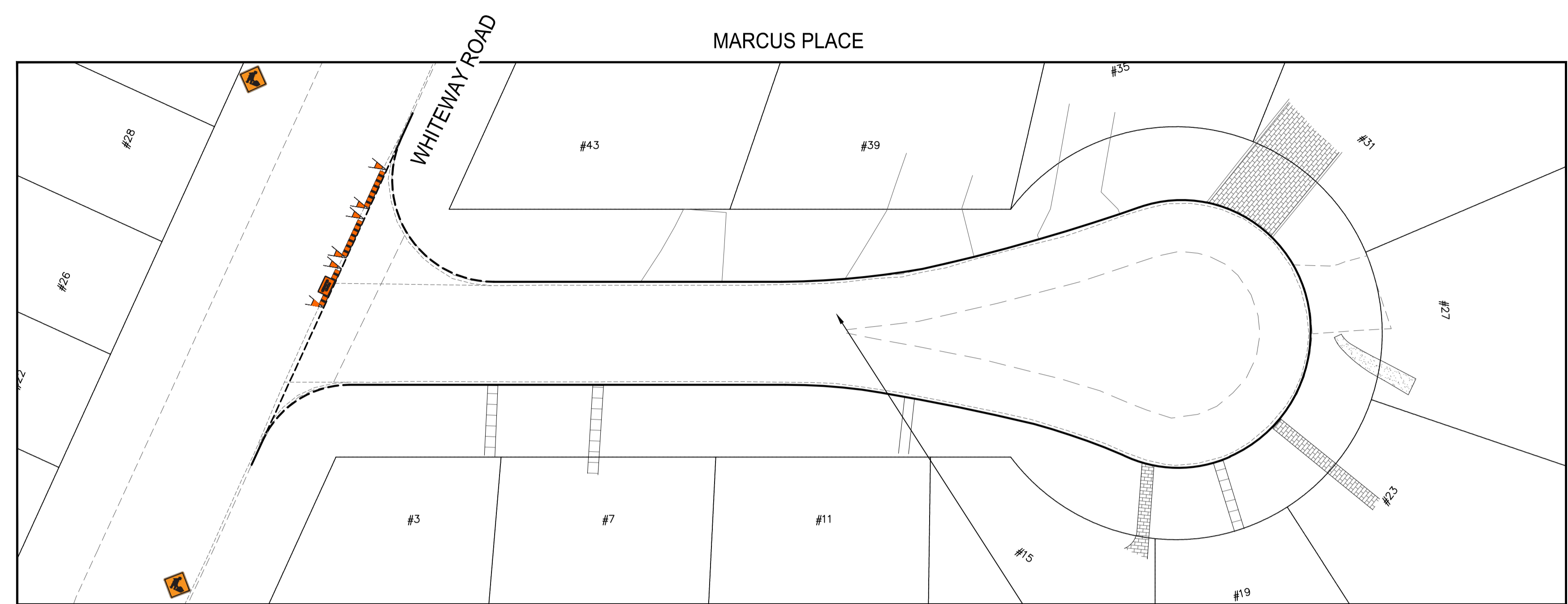
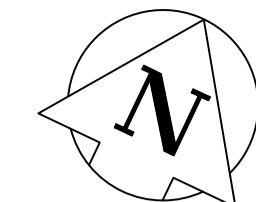

SET UP BARRICADES AROUND
CONCRETE REPAIRS AS REQUIRED

Mar 10, 2025 - 12:56pm
 F:\2024\CA00434256941 - CA-25-R-07 Local Streets\02 Drawings\03_Work_Dwg\CA00434256941_Marcus Pl_Signage.dwg - Job: MARCUS SIGNAGE

TC-2 ROADWORK



ROAD CLOSED BARRICADE



BARRICADE



NOTES:

1. ALL TRAFFIC SIGNAGE AND TEMPORARY TRAFFIC CONTROL TO CONFORM WITH THE LATEST REVISION OF THE CITY OF WINNIPEG MANUAL OF TEMPORARY TRAFFIC CONTROL ON CITY STREETS
2. PARKING TO BE REMOVED AT THE TIME OF CONSTRUCTION

METRIC

WHOLE NUMBERS INDICATE MILLIMETRES
DECIMALIZED NUMBERS INDICATE METRES



**Engineers
Geoscientists
Manitoba**
Certificate of Authorization
WSP Canada Inc.
No. 5750

FOR INFORMATION ONLY



THE CITY OF WINNIPEG
PUBLIC WORKS DEPARTMENT
ENGINEERING SERVICES DIVISION

2025 LOCAL STREET RENEWALS

MARCUS PLACE
TEMPORARY TRAFFIC SIGNAGE



WSP Canada Inc.
1600 Buffalo Place
Winnipeg, MB R3T 6B8
t. 204.477.6650
f. 204.474.2864
www.wsp.com

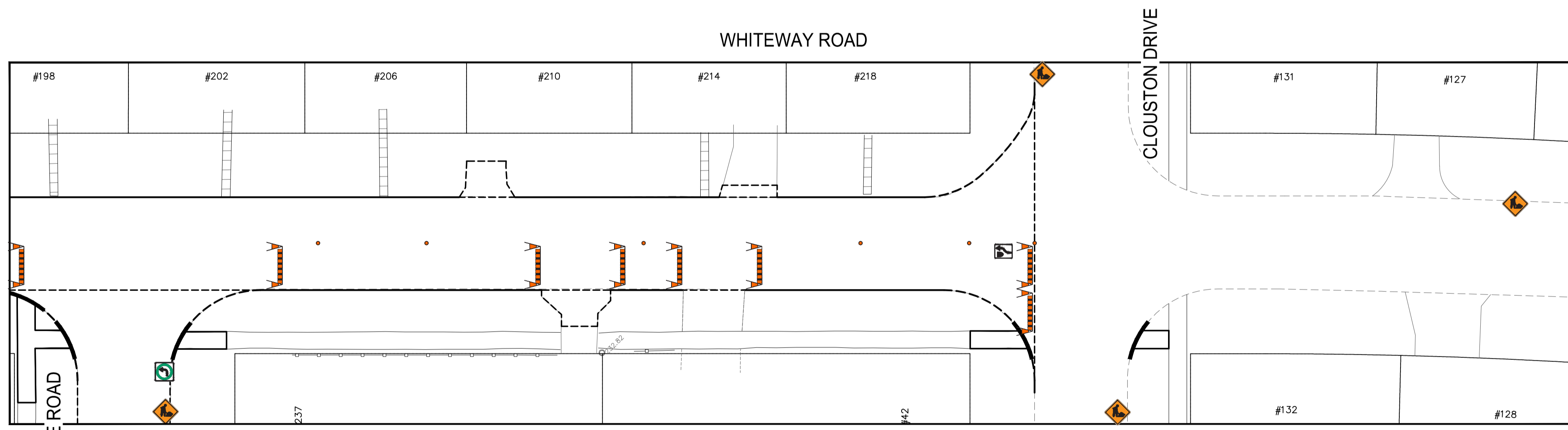
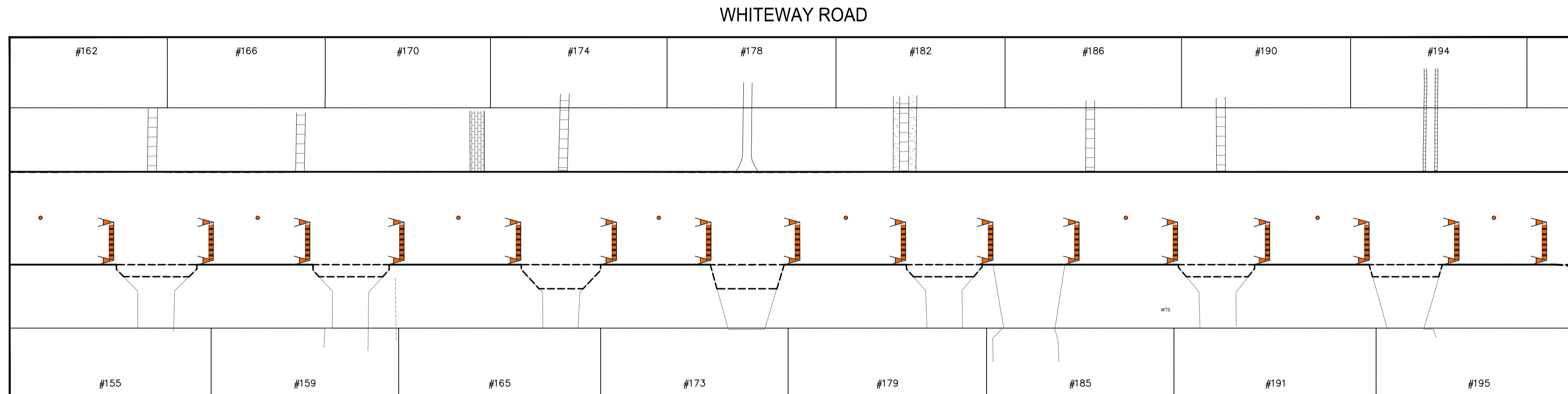
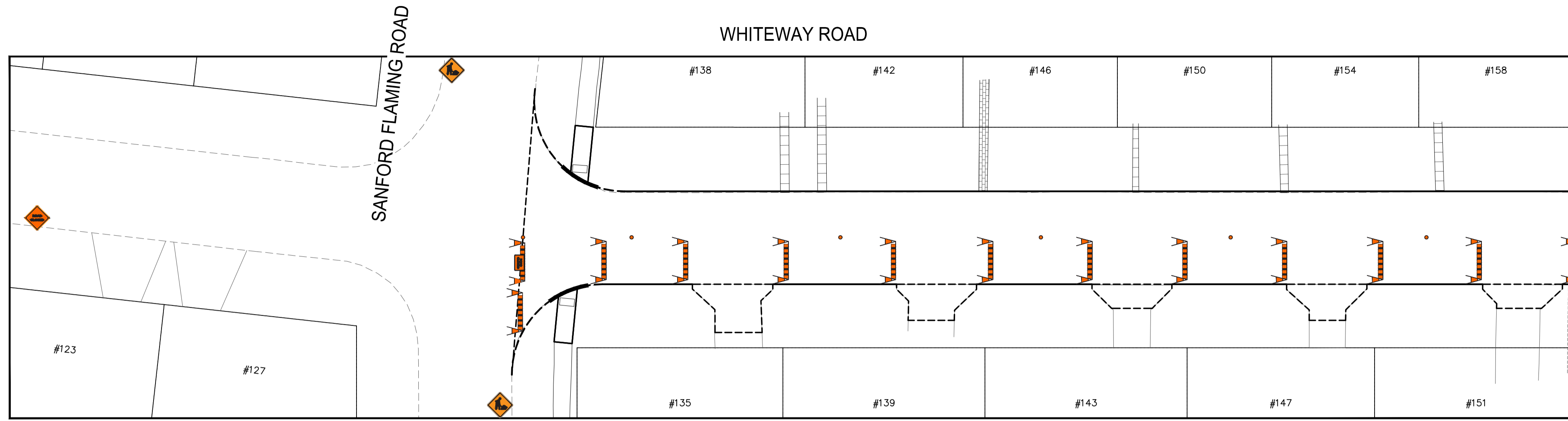
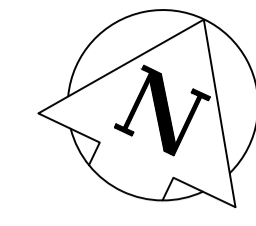

Mar 10, 2025 - 12:00pm
 F:\2024\CA004\425.6941 - CA-25-R-07 Local Streets\02 Drawings\03_Work_Dwg\CA004\425.6941_Whiteway Rd_Signage.dwg -tab: WHITEWAY_PHASE 1

RB-14R TURN RIGHT / RB-14L TURN LEFT

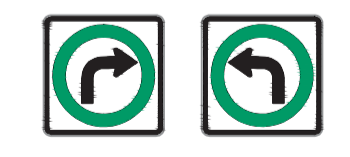

RB-25R KEEP RIGHT / RB-25L KEEP LEFT

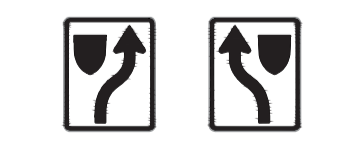

TC-2 ROADWORK



ROAD CLOSED BARRICADE



BARRICADE



POLY POST



ROAD CLOSED

NOTES:

1. ALL TRAFFIC SIGNAGE AND TEMPORARY TRAFFIC CONTROL TO CONFORM WITH THE LATEST REVISION OF THE CITY OF WINNIPEG MANUAL OF TEMPORARY TRAFFIC CONTROL ON CITY STREETS
2. CONTRACTOR SHALL MAINTAIN SAFE PEDESTRIAN ACCESS AND CROSSINGS. WHERE SIDEWALKS ARE LOCATED ON BOTH SIDES OF THE STREET, CONTRACTOR MUST MAINTAIN PEDESTRIAN ACCESS ON ONE SIDE AT ALL TIME.
3. CONSTRUCTION IS TO BE DONE LANE AT A TIME WITH TRAFFIC TO BE MAINTAINED IN THE EASTBOUND DIRECTION. TRAFFIC IN THE WESTBOUND DIRECTION IS TO BE CLOSED FOR THE DURATION OF THE PROJECT. WHEN CONSTRUCTION IS COMPLETED IN FIRST LANE, TRAFFIC WILL BE MOVED TO THE COMPLETED LANE AND TRAFFIC CONTROL WILL BE MIRRORRED.
4. PARKING TO BE REMOVED AT THE TIME OF CONSTRUCTION

METRIC
 WHOLE NUMBERS INDICATE MILLIMETRES
 DECIMALIZED NUMBERS INDICATE METRES

**ENGINEERS
 GEOSCIENTISTS
 MANITOBA**
 Certificate of Authorization
 WSP Canada Inc.
 No. 5750

FOR INFORMATION ONLY

THE CITY OF WINNIPEG
 PUBLIC WORKS DEPARTMENT
 ENGINEERING SERVICES DIVISION

2025 LOCAL STREET RENEWALS

TYPICAL REHABILITATION

TEMPORARY TRAFFIC SIGNAGE



WSP Canada Inc.
 1600 Buffalo Place
 Winnipeg, MB R3T 6B8
 t. 204.477.6650
 f. 204.474.2864
 www.wsp.com

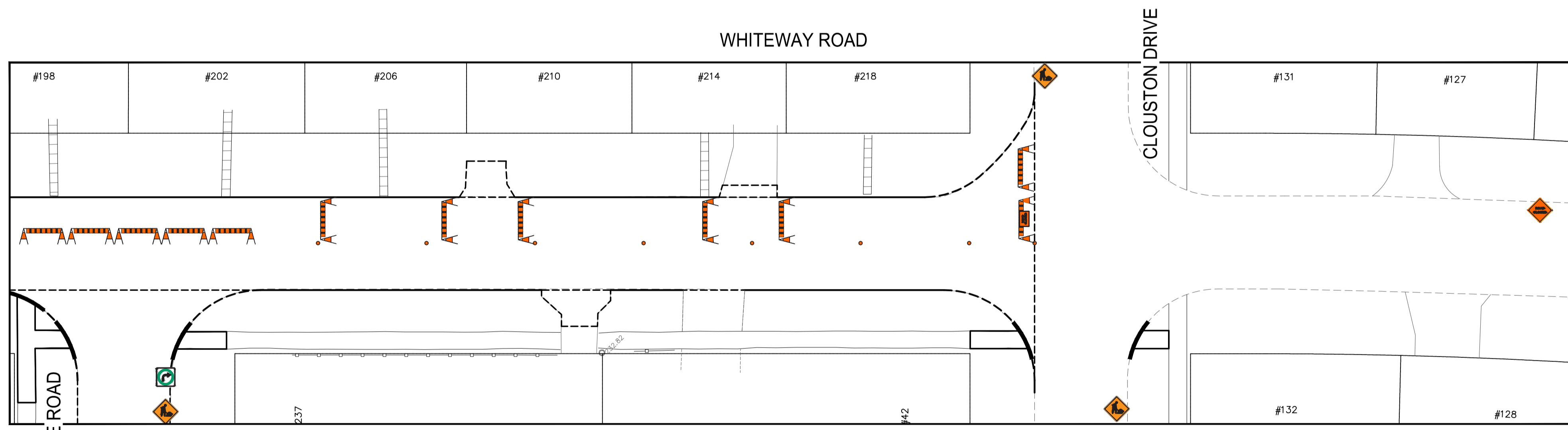
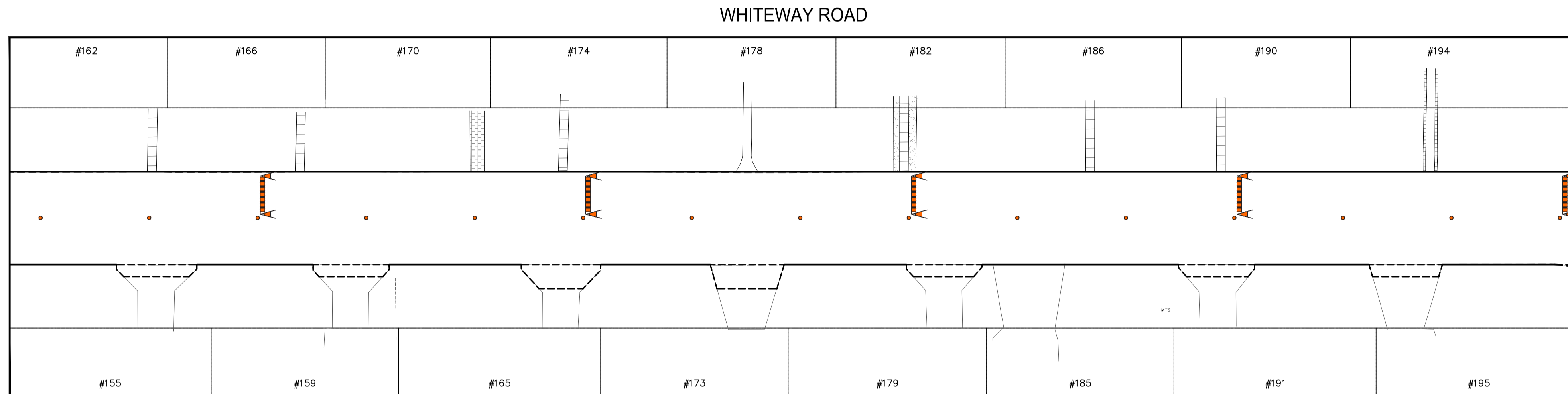
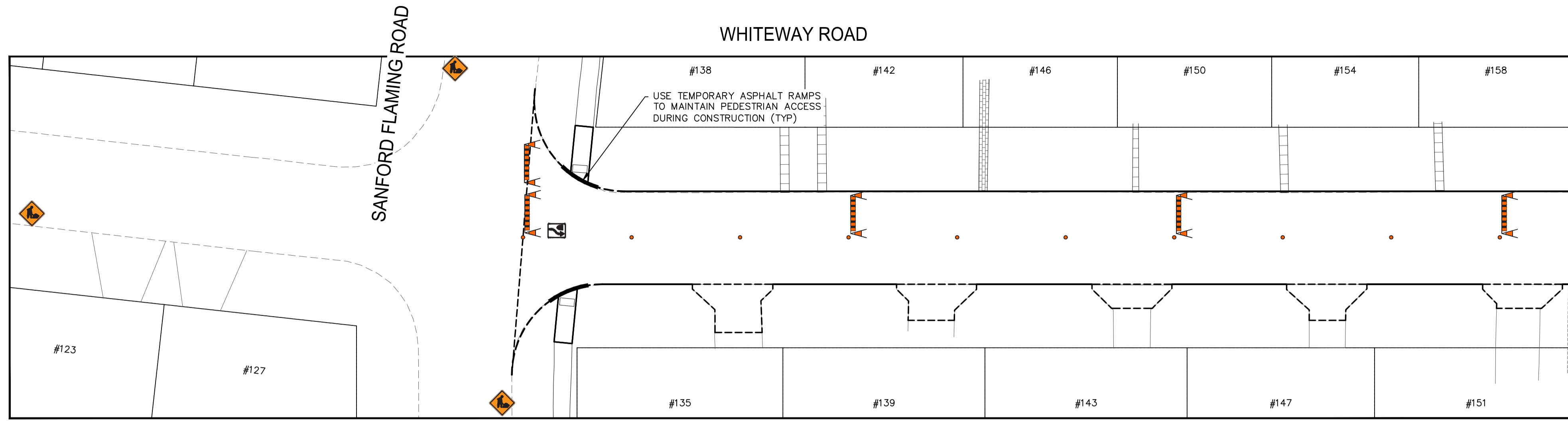
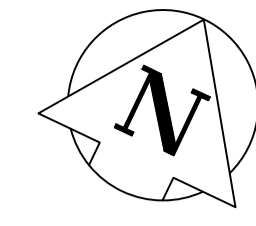

Mar 10, 2025 - 12:00pm
 F:\2024\CA004\425\6941 - CA-25-R-07 Local Streets\02 Drawings\03_Work_Dwg\CA004\425\6941_Whiteway Rd_Signage.dwg -tab:WHITWAY_PHASE 2

RB-14R TURN RIGHT / RB-14L TURN LEFT

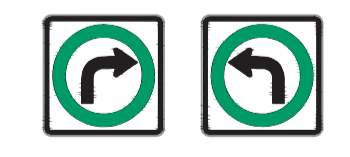

RB-25R KEEP RIGHT / RB-25L KEEP LEFT

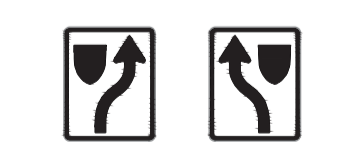

TC-2 ROADWORK



ROAD CLOSED BARRICADE



BARRICADE



POLY POST

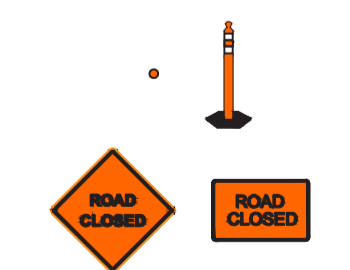

ROAD CLOSED

NOTES:

1. ALL TRAFFIC SIGNAGE AND TEMPORARY TRAFFIC CONTROL TO CONFORM WITH THE LATEST REVISION OF THE CITY OF WINNIPEG MANUAL OF TEMPORARY TRAFFIC CONTROL ON CITY STREETS
2. CONTRACTOR SHALL MAINTAIN SAFE PEDESTRIAN ACCESS AND CROSSINGS. WHERE SIDEWALKS ARE LOCATED ON BOTH SIDES OF THE STREET, CONTRACTOR MUST MAINTAIN PEDESTRIAN ACCESS ON ONE SIDE AT ALL TIME.
3. CONSTRUCTION IS TO BE DONE LANE AT A TIME WITH TRAFFIC TO BE MAINTAINED IN THE EASTBOUND DIRECTION. TRAFFIC IN THE WESTBOUND DIRECTION IS TO BE CLOSED FOR THE DURATION OF THE PROJECT. WHEN CONSTRUCTION IS COMPLETED IN FIRST LANE, TRAFFIC WILL BE MOVED TO THE COMPLETED LANE AND TRAFFIC CONTROL WILL BE MIRRORRED.
4. PARKING TO BE REMOVED AT THE TIME OF CONSTRUCTION

METRIC
 WHOLE NUMBERS INDICATE MILLIMETRES
 DECIMALIZED NUMBERS INDICATE METRES

**ENGINEERS
 GEOSCIENTISTS
 MANITOBA**
 Certificate of Authorization
 WSP Canada Inc.
 No. 5750

FOR INFORMATION ONLY



WSP Canada Inc.
 1600 Buffalo Place
 Winnipeg, MB R3T 6B8
 t. 204.477.6650
 f. 204.474.2864
 www.wsp.com

THE CITY OF WINNIPEG
 PUBLIC WORKS DEPARTMENT
 ENGINEERING SERVICES DIVISION

2025 LOCAL STREET RENEWALS
 TYPICAL REHABILITATION
 TEMPORARY TRAFFIC SIGNAGE