

Stantec Consulting Ltd.
Suite 500, 311 Portage Avenue
Winnipeg MB Canada R3B 2B9
Tel. 204.489.5900 Fax. 204.453.9012
www.stantec.com

Copyright Reserved

The Contractor shall verify and be responsible for all dimensions.
DO NOT scale the drawing - any errors or omissions shall be reported to Stantec without delay.
The Copyrights to all designs and drawings are the property of Stantec. Reproduction or use for any purpose other than that authorized by Stantec is forbidden.

Consultants

Legend

Revision

ISSUED FOR CONSTRUCTION
Issued

File Name:

Permit-Seal



Client/Project

WINNIPEG TRANSIT MAINTENANCE FACILITY
OFFICE REDEVELOPMENT

DEPARTMENT:
TRAINING, PLANT, AND EQUIPMENT
421 OSBORNE ST. SOUTH, WINNIPEG, MB

Title

FLOOR PLAN

Project No.
115421006

Drawing No.

Scale
1/8"=1'-0"

Sheet

Revision

AE-101

of

0

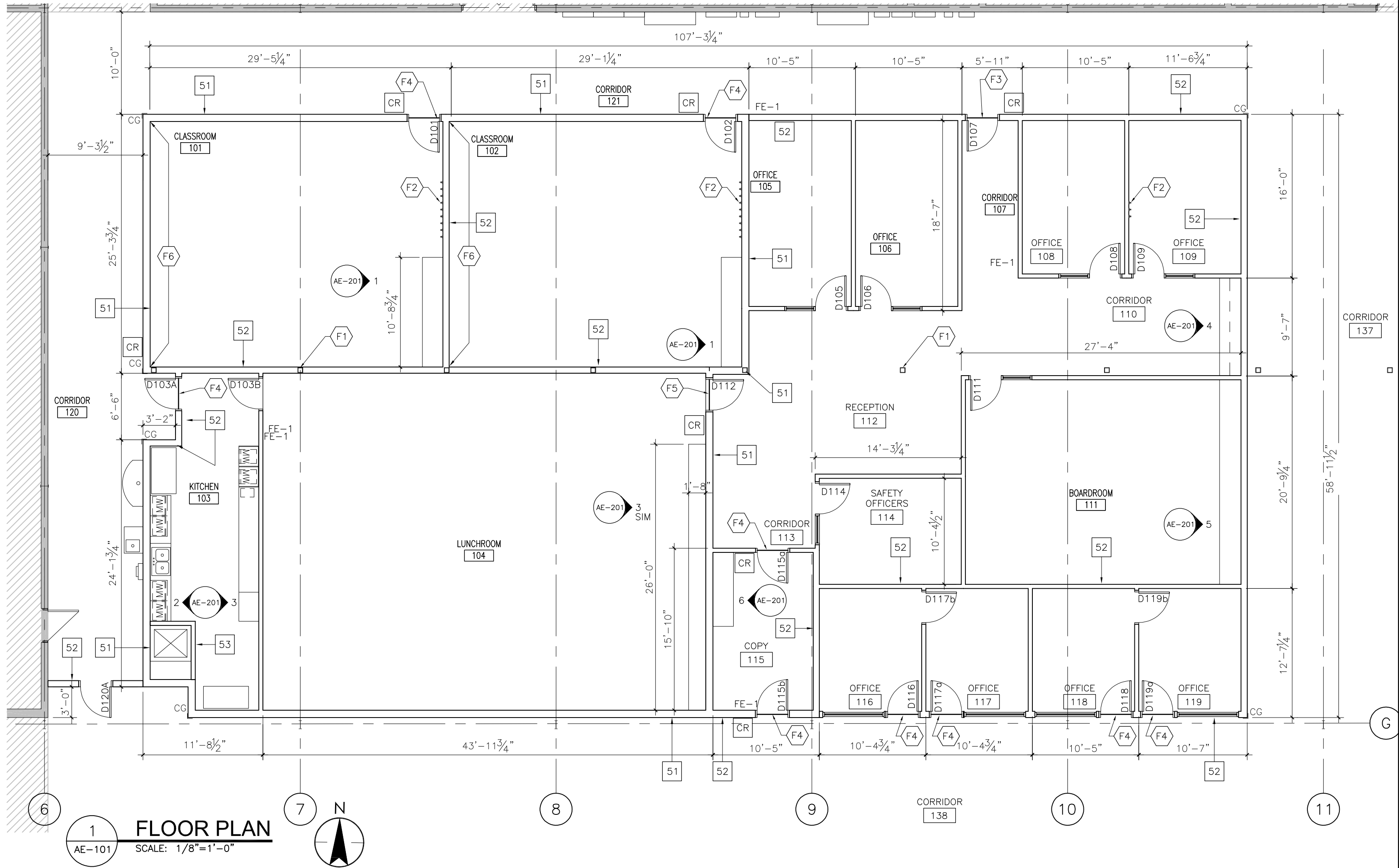

PARTITION PLAN - GENERAL NOTES

- REFER TO LIFE SAFETY PLANS FOR RATED WALL ASSEMBLIES.
- FIRE STOP AND SMOKE SEAL ALL PENETRATIONS FROM M & E.
- INTERIOR FLOOR PLAN DIMENSIONS TO GB PARTITIONS ARE SHOWN FROM FACE OF WALL TO FINISHED FACE OF WALL.
- REFER TO MATERIAL SCHEDULE IN SPECIFICATION FOR MATERIAL CODES.
- ALL EXISTING WALL MOUNTED PULL STATIONS, ANNUNCIATORS ETC. TO REMAIN UNLESS OTHERWISE NOTED. LOCATION OF ALL NEW WALL MOUNTED PULL STATIONS, ANNUNCIATORS, FIRE EXTINGUISHERS, ETC. TO BE COORDINATED WITH M & E & ID.
- REFER TO REFLECTED CEILING PLANS FOR LOCATION OF GB AND ACT CEILINGS AND FINISHES.
- REFER TO DOOR SCHEDULE FOR DOOR AND FRAME TYPES.
- LOCATE NEW HOLLOW METAL FRAMES 6" AWAY FROM ADJACENT WALLS UNLESS NOTED OTHERWISE. DOORS TO HAVE 2'-0" LATCH SIDE CLEARANCE ON PULL SIDE AND 1'-0" ON PUSH SIDE.
- ALL INTERIOR PARTITION TYPES TO U/S CEILING TO BE BRACED TO U/S. DO NOT MECHANICALLY FASTEN TO T-BAR. ALL BRACINGS SHALL BE ABOVE CEILING LEVEL TYP. AND NOT TO PENETRATE OR DAMAGE ANY ACT TILES/GRID.
- ALL FULL HEIGHT WALLS TO AIR-TIGHT SEALS AT FLOORS, CEILINGS AND UNDERSIDE OF STRUCTURE.
- PREPARE ALL EXISTING GB FOR FINISH COATS OF PAINT - SEE FINISHES PLAN.
- CONTRACTOR SHALL PROVIDE BLOCKING IN WALL FOR ALL WALL MOUNTED MILLWORK, EQUIPMENT AND FURNITURE AS INDICATED ON DRAWINGS. THIS INCLUDES OWNER SUPPLIED FURNITURE, FIXTURES, EQUIPMENT AND SIGNAGE.

INTERIOR PARTITION TYPES

-ALL INTERIOR PARTITION TO BE 50 UNLESS NOTED OTHERWISE
-ALL INTERIOR PARTITIONS THAT ARE NOT TO U/S OF STRUCTURE MUST BE BRACED TO U/S STRUCTURE FROM ABOVE THE CEILING, UNLESS NOTED OTHERWISE

PARTITION FROM FLOOR TO 12'-0" A.F.F.
-5/8" GYPSUM BOARD
-3 5/8" STEEL STUDS @16" O/C
-ACOUSTIC BATT INSULATION
-5/8" GYPSUM BOARD

2 HR FIRE RATED PARTITION FROM FLOOR TO U/S DECK
-2 LAYERS OF 5/8" TYPE X GYPSUM BOARD
-6" STEEL STUDS @16" O/C (18 GA.)
-ACOUSTIC BATT INSULATION
-2 LAYERS OF 5/8" TYPE X GYPSUM BOARD

PARTITION FROM FLOOR TO U/S DECK
-5/8" GYPSUM BOARD
-6" STEEL STUDS @16" O/C (18 GA.)
-ACOUSTIC BATT INSULATION
-5/8" GYPSUM BOARD

PARTITION FROM FLOOR TO 10'-0" A.F.F.
-5/8" GYPSUM BOARD
-3 5/8" STEEL STUDS @16" O/C
-ACOUSTIC BATT INSULATION