

CROSS SECTION 'A' - ASPHALT SPEED HUMP
N.T.S.

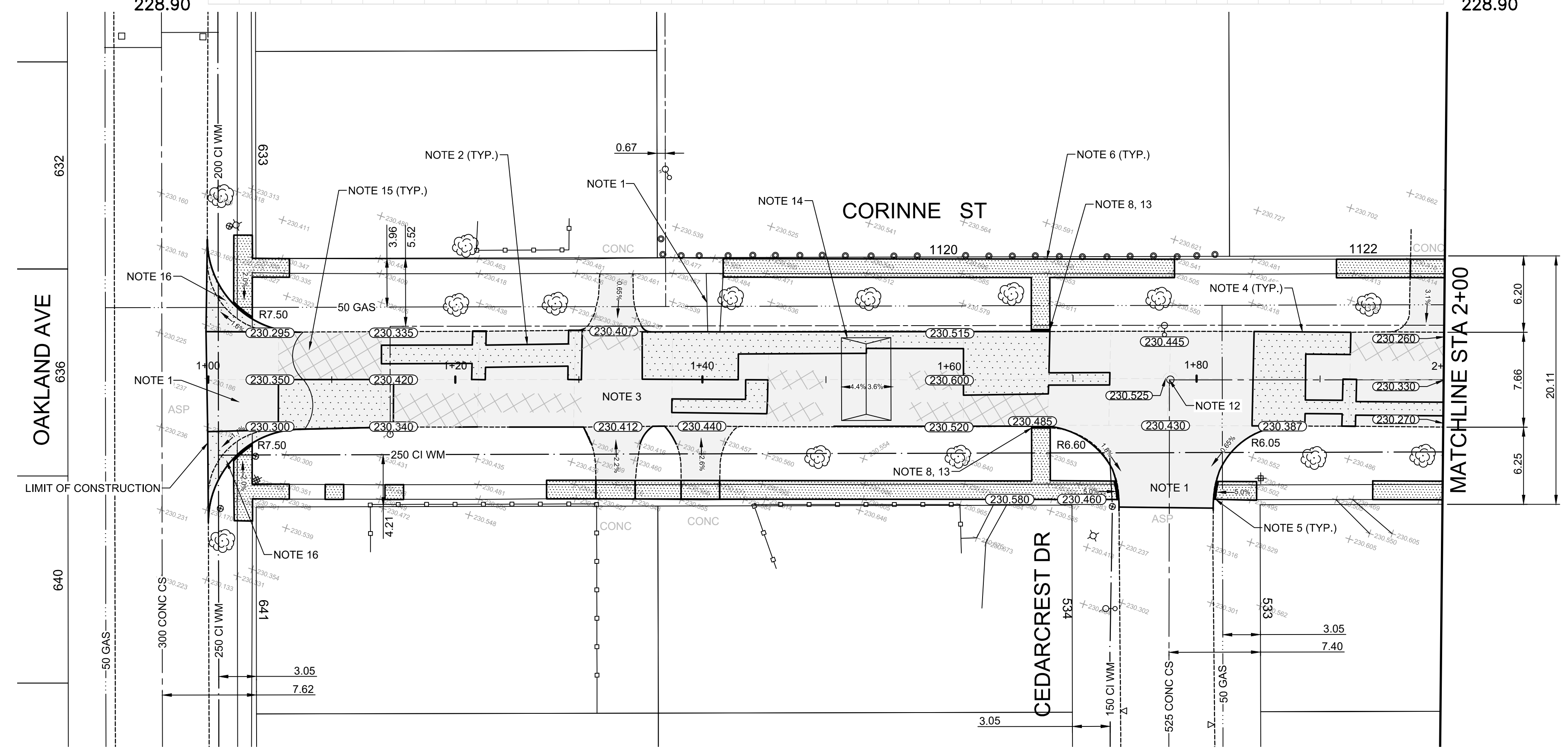

- CONSTRUCTION NOTES**
1. REMOVE EXISTING ASPHALT PAVEMENT
 2. REMOVE EXISTING PAVEMENT AND CONSTRUCT NEW 150mm REINFORCED CONCRETE PAVEMENT
 3. CONSTRUCT NEW MS1 ASPHALT OVERLAY (+/- 80mm TYP.) (E14)
 4. RENEW EXISTING BARRIER CURB (SD-205, 206A)
 5. RENEW EXISTING CURB RAMP (SD-229D)
 6. RENEW EXISTING 100mm CONCRETE SIDEWALK (E19)
 7. REMOVE EXISTING CONCRETE SIDEWALK
 8. CONSTRUCT NEW 100mm CONCRETE SIDEWALK (SD-228A, E19)
 9. RELOCATE EXISTING CURB INLET AND INSTALL NEW INLET BOX COVER WITH NEW PVC PIPE CONNECTING TO CATCH BASIN AS PER CW 2130
 10. REMOVE AND REPLACE 200mm CONCRETE REDUCER, ADJUST FRAME AND COVER
 11. REMOVE EXISTING RISERS AND INSTALL NEW CONCRETE RISERS
 12. INSTALL NEW LIFTER RING
 13. CONSTRUCT NEW CONCRETE CURB RAMP (SD-229D)
 14. CONSTRUCT NEW ASPHALT SPEED HUMP AS PER CROSS SECTION 'A'
 15. SUPPLY AND INSTALL TYPE 'A' PAVEMENT REPAIR FABRIC
 16. CONSTRUCT NEW 150mm REINFORCED CONCRETE PAVEMENT
 17. ABANDON EXISTING CURB INLET AND PVC PIPE CONNECTION

- GENERAL NOTES**
- A. PAVEMENT DIMENSIONS ARE TO BACK OF CURB
 - B. ALL CURB RADII UNDER 15.0m SHALL BE MODIFIED
 - C. CURB REPLACEMENT AS DIRECTED BY CONTRACT ADMINISTRATOR
 - D. CONTRACTOR TO CONFIRM THE LOCATION OF ALL UTILITIES / SERVICES IN THE FIELD PRIOR TO CONSTRUCTION
 - E. ADJUST WATER VALVES AND CURB STOPS AS DIRECTED BY CONTRACT ADMINISTRATOR
 - F. PAVEMENT REPAIRS SHOWN ARE A REPRESENTATIVE SAMPLE OF THE TENDER QUANTITIES
 - G. ASPHALT TIE-INS ARE TO BE DETERMINED IN THE FIELD BY THE CONTRACT ADMINISTRATOR
 - H. CONCRETE SIDEWALK PLACED THROUGH PRIVATE APPROACHES SHALL BE 150mm REINFORCED (SD-235)

ISSUED FOR TENDER
NOT TO BE USED FOR CONSTRUCTION

METRIC
WHOLE NUMBERS INDICATE MILLIMETERS
DECIMALIZED NUMBERS INDICATE METERS

TENDER NO. 27-2025

EXISTING	LEGEND - PLAN	PROPOSED	EXISTING	LEGEND - PLAN	PROPOSED	EXISTING	LEGEND - PROFILE	PROPOSED
⊕	HYDRANT	◆	---	LDS/WWS	---	▨	CONCRETE	▨
⊗	VALVE	◆	---	WATERMAIN	---	▨	CONCRETE SIDEWALK	▨
⊙	CURB STOP	◆	---	GAS	---	▨	ASPHALT	▨
⊖	MANHOLE	●	---	TRAFFIC SIGNALS	---	▨	PAVEMENT REPAIR FABRIC	▨
⊚	CATCH BASIN	●	---	HYDRO/STREET LIGHT	---			
△	CATCH PIT/CURB INLET	■	---	MTS/SHAW	---	○	BOLLARD	○
⊙	HYDRO POLE	◆	---	CURB RENEWAL	---	□	WOOD FENCE	□
⊙	LIGHT STANDARD	◆	---	PROPERTY LINE	---	---	LEGEND - PLAN	---
⊙	TRAFFIC SIGNAL POLE	◆	---	RAMP CURB	---	---	WEST GUTTER	---
⊕	SURVEY BAR	◆	---	ELEVATIONS	(31.000)	---	CENTER LINE	---
⊕	UTILITY BOX	◆	---	TREE	---	---	EAST GUTTER	---

LOCATION APPROVED UNDERGROUND STRUCTURES

DATE

NOTE:
LOCATION OF UNDERGROUND STRUCTURES AS SHOWN ARE BASED ON THE BEST INFORMATION AVAILABLE. BUT NO GUARANTEE IS GIVEN THAT ALL EXISTING UTILITIES ARE SHOWN OR THAT THE GIVEN LOCATIONS ARE EXACT. CONFIRMATION OF EXISTENCE AND EXACT LOCATION OF ALL SERVICES MUST BE OBTAINED FROM THE INDIVIDUAL UTILITIES BEFORE PROCEEDING WITH CONSTRUCTION.

B.M. IB @ SW CORN. OF OAKLAND AV/CORINNE ST
ELEV. 230.165

ENGINEERING DIVISION
TECHNOLOGY SERVICES BRANCH
106 - 1155 PACIFIC AVE

DESIGNED BY D.PEN
CHECKED BY T.G. E.H. R.W. J.S.

DRAWN BY D.PEN
APPROVED BY J.T.S.

HOR. SCALE: 1 : 250
VERTICAL: 1 : 10

DATE 2025/02/28

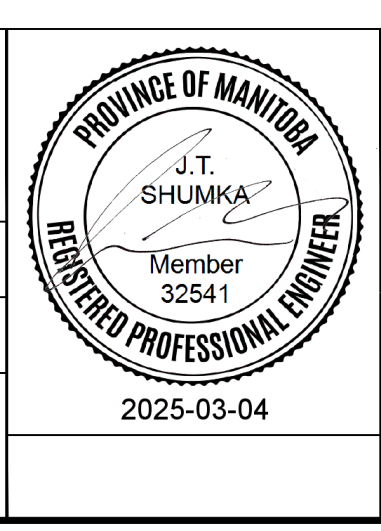

THE CITY OF WINNIPEG
PUBLIC WORKS DEPARTMENT

CORINNE STREET
FROM OAKLAND AVENUE TO MARK PEARCE AVENUE
CONCRETE PAVEMENT REHABILITATION AND ASSOCIATED WORKS
FROM STA. 1+00 TO STA. 2+00

CITY DRAWING NUMBER SE-25-304
SHEET 5 OF 23

1