

APPENDIX 'C'
TRANSIT STOP IMPROVEMENTS

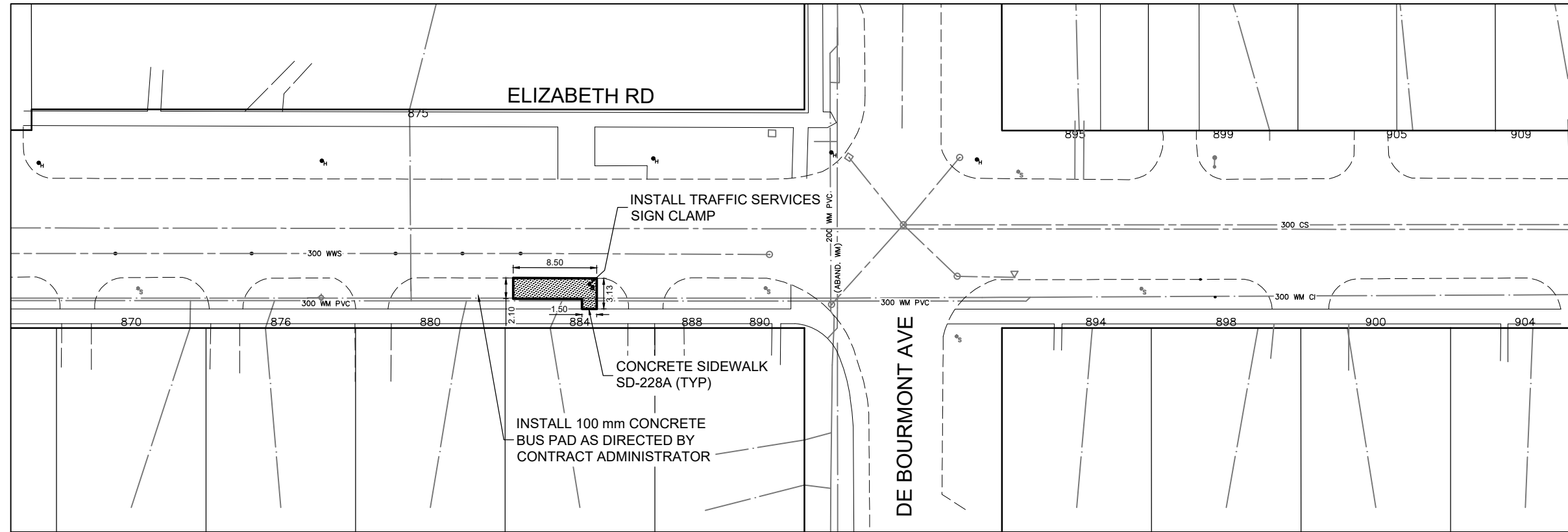

NOTES:

1. ALL WORK AND MATERIALS TO BE IN ACCORDANCE WITH LATEST REVISION OF THE CITY OF WINNIPEG STANDARD CONSTRUCTION SPECIFICATIONS.
2. LEGAL PLAN AND UNDERGROUND INFORMATION FROM CITY OF WINNIPEG LBIS. ALL UNDERGROUNDS TO BE VERIFIED BY THE CONTRACTOR IN THE FIELD.
3. CONTRACTOR TO TAKE PRECAUTIONARY STEPS TO AVOID DAMAGE FROM CONSTRUCTION ACTIVITIES TO TREES WITHIN THE LIMITS OF CONSTRUCTION.
4. LOCATION OF EXISTING SERVICES TO BE CONFIRMED IN THE FIELD BY THE CONTRACTOR.
5. LIMITS OF BOULEVARD GRADING TO BE FINALIZED IN THE FIELD BY THE CONTRACT ADMINISTRATOR.
6. ADJUST ALL WATER VALVES, MANHOLES, CATCH BASINS AND CATCH PITS TO GRADE.
7. PAVEMENT REPAIRS SHOWN ARE ONLY REPRESENTATIVE OF APPROXIMATION OF CONSTRUCTION.
8. CONTRACTOR TO INSTALL CONCRETE RISERS BY REMOVING THE EXISTING FLAT TOP REDUCER, PLACING RISERS AS DIRECTED BY THE CONTRACT ADMINISTRATOR AND THEN REINSTALLING THE EXISTING FLAT TOP REDUCER.
9. EXCAVATIONS WITHIN 1.0m FROM THE OUTER EDGE OF WM TO THE NEAREST EDGE OF EXCAVATION ARE TO BE CONDUCTED WITHOUT HEAVY VIBRATORY EQUIPMENT. BOTH SAW CUTTING AND REMOVAL OR SOFT DIGGING ARE ACCEPTABLE MEANS OF EXCAVATION AT THESE LOCATIONS.

EXISTING	LEGEND-PLAN	PROPOSED	EXISTING	LEGEND-PLAN	PROPOSED	EXISTING	LEGEND-PLAN	PROPOSED
⊕	HYDRANT	⊕	150 WM	WATERMAIN	150 WM	▬▬▬▬	CONCRETE ROAD	▬▬▬▬▬▬
⊙	VALVE	⊙	300 LDS	LAND DRAINAGE SEWER	300 LDS	▬▬▬▬▬▬	ASPHALT ROAD	▬▬▬▬▬▬▬▬
⌋	CURB STOP	⌋	250 WWS	WASTE WATER SEWER	250 WWS	▬▬▬▬▬▬▬▬	CONC ROAD W/ASP OVERLAY	▬▬▬▬▬▬▬▬▬▬
⊕	LIGHT STANDARD	⊕	HYDRO	HYDRO	HYDRO	▬▬▬▬▬▬▬▬	CONCRETE SIDEWALK	▬▬▬▬▬▬▬▬▬▬
⊕	HYDRO POLE	⊕	BELLMTS	BELLMTS	BELLMTS	▬▬▬▬▬▬▬▬	ASPHALT PATH	▬▬▬▬▬▬▬▬▬▬
⊕	TREE	⊕	100 GAS	GAS	100 GAS	▬▬▬▬▬▬▬▬	LANDSCAPING FEATURE	▬▬▬▬▬▬▬▬▬▬
⊕	GEODETIC BENCH MARK	⊕	T.S.	TRAFFIC SIGNALS	T.S.	▬▬▬▬▬▬▬▬	GRASS/SOD	▬▬▬▬▬▬▬▬▬▬
⊕	SURVEY BAR	⊕	S.L.	STREET LIGHTS	S.L.	▬▬▬▬▬▬▬▬	ELEVATION	232.000
⊕	MANHOLE	⊕	TRAFFIC SIGNAL POLE	TRAFFIC SIGNAL POLE	TRAFFIC SIGNAL POLE	▬▬▬▬▬▬▬▬	PROPERTY LINE	▬▬▬▬▬▬▬▬▬▬
⊕	CATCH BASIN	⊕	PAVING STONE	PAVING STONE	PAVING STONE	▬▬▬▬▬▬▬▬	CURB RAMP	▬▬▬▬▬▬▬▬▬▬
⊕	CATCH PIT	⊕	CURB RENEWAL	CURB RENEWAL	CURB RENEWAL	▬▬▬▬▬▬▬▬	DETECTABLE TILE	▬▬▬▬▬▬▬▬▬▬

METRIC
WHOLE NUMBERS INDICATE MILLIMETRES
DECIMALIZED NUMBERS INDICATE METRES

**ENGINEERS
GEOSCIENTISTS
MANITOBA**
Certificate of Authorization
Dillon Consulting Limited (MB)
No. 1789 Date: 2025/03/25

B.M. ELEV.	DESIGNED BY	DRAWN BY	CHECKED BY	APPROVED BY	HOR. SCALE	VERTICAL
	DRC	DRC	LAS	TJP	1:500	-
0	ISSUED FOR TENDER	25/03/25	LAS			
NO.	REVISIONS	DATE	BY	DATE		

DILLON CONSULTING

RELEASED FOR CONSTRUCTION

DATE

ENGINEER'S SEAL

CONSULTANT PROJECT NUMBER
24-9227

THE CITY OF WINNIPEG
PUBLIC WORKS DEPARTMENT

2025 RESIDENTIAL STREETS RENEWAL PROGRAM
CROMWELL STREET AND VARIOUS OTHER LOCATIONS

ELIZABETH ROAD
TRANSIT STOP IMPROVEMENT

CITY DRAWING NUMBER
SHEET **B1** OF **B5**
TENDER NO.

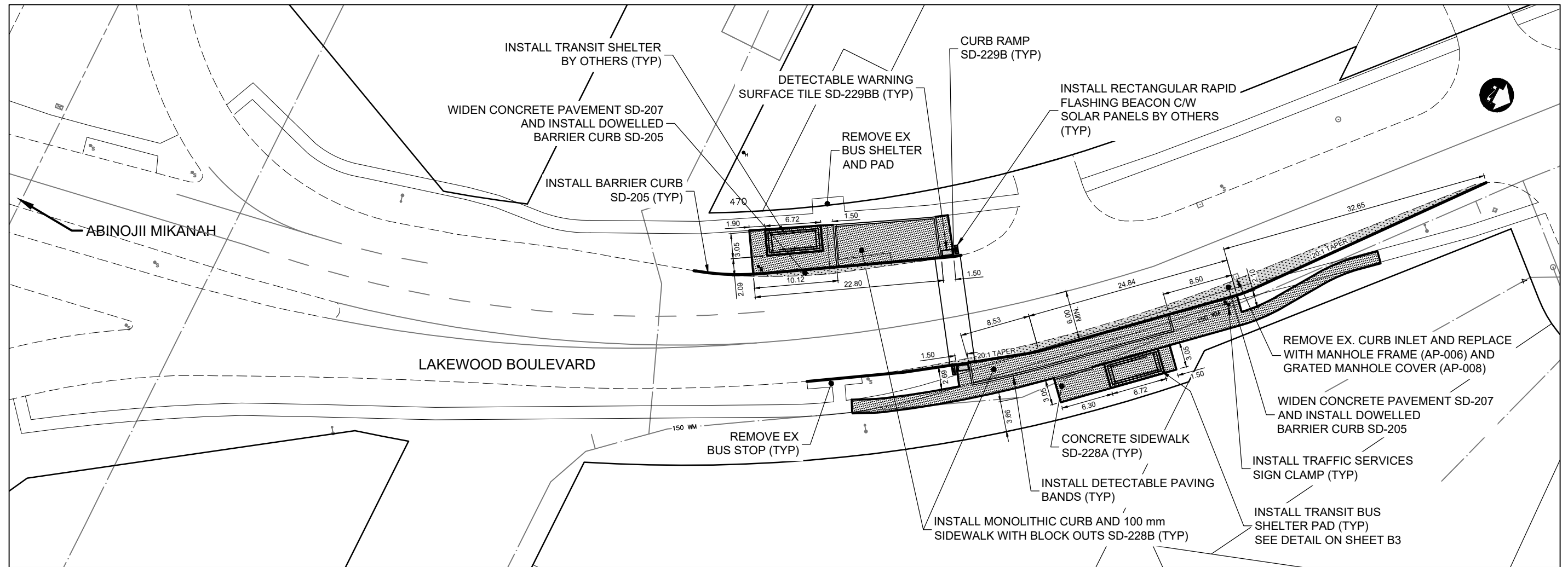

NOTES:

1. ALL WORK AND MATERIALS TO BE IN ACCORDANCE WITH LATEST REVISION OF THE CITY OF WINNIPEG STANDARD CONSTRUCTION SPECIFICATIONS.
2. LEGAL PLAN AND UNDERGROUND INFORMATION FROM CITY OF WINNIPEG LBIS. ALL UNDERGROUNDS TO BE VERIFIED BY THE CONTRACTOR IN THE FIELD.
3. CONTRACTOR TO TAKE PRECAUTIONARY STEPS TO AVOID DAMAGE FROM CONSTRUCTION ACTIVITIES TO TREES WITHIN THE LIMITS OF CONSTRUCTION.
4. LOCATION OF EXISTING SERVICES TO BE CONFIRMED IN THE FIELD BY THE CONTRACTOR.
5. LIMITS OF BOULEVARD GRADING TO BE FINALIZED IN THE FIELD BY THE CONTRACT ADMINISTRATOR.
6. ADJUST ALL WATER VALVES, MANHOLES, CATCH BASINS AND CATCH PITS TO GRADE.
7. PAVEMENT REPAIRS SHOWN ARE ONLY REPRESENTATIVE OF APPROXIMATION OF CONSTRUCTION.
8. CONTRACTOR TO INSTALL CONCRETE RISERS BY REMOVING THE EXISTING FLAT TOP REDUCER, PLACING RISERS AS DIRECTED BY THE CONTRACT ADMINISTRATOR AND THEN REINSTALLING THE EXISTING FLAT TOP REDUCER.
9. EXCAVATIONS WITHIN 1.0m FROM THE OUTER EDGE OF WM TO THE NEAREST EDGE OF EXCAVATION ARE TO BE CONDUCTED WITHOUT HEAVY VIBRATORY EQUIPMENT. BOTH SAW CUTTING AND REMOVAL OR SOFT DIGGING ARE ACCEPTABLE MEANS OF EXCAVATION AT THESE LOCATIONS.

EXISTING	LEGEND-PLAN	PROPOSED	EXISTING	LEGEND-PLAN	PROPOSED	EXISTING	LEGEND-PLAN	PROPOSED
	HYDRANT		150 WM	WATERMAIN	150 WM		CONCRETE ROAD	
	VALVE		300 LDS	LAND DRAINAGE SEWER	300 LDS		ASPHALT ROAD	
	CURB STOP		250 WWS	WASTE WATER SEWER	250 WWS		CONC ROAD W/ASP OVERLAY	
	LIGHT STANDARD		HYDRO	HYDRO	HYDRO		CONCRETE SIDEWALK	
	HYDRO POLE		BELLMTS	BELLMTS	BELLMTS		ASPHALT PATH	
	TREE		100 GAS	GAS	100 GAS		LANDSCAPING FEATURE	
	GEODETIC BENCH MARK		T.S.	TRAFFIC SIGNALS	T.S.		GRASS/SOD	
	SURVEY BAR		S.L.	STREET LIGHTS	S.L.		ELEVATION	
	MANHOLE		TRAFFIC SIGNAL POLE	TRAFFIC SIGNAL POLE	TRAFFIC SIGNAL POLE		PROPERTY LINE	
	CATCH BASIN		PAVING STONE	PAVING STONE	PAVING STONE		CURB RAMP	
	CATCH PIT		CURB RENEWAL	CURB RENEWAL	CURB RENEWAL		DETECTABLE TILE	

METRIC

WHOLE NUMBERS INDICATE MILLIMETRES
DECIMALIZED NUMBERS INDICATE METRES

**ENGINEERS
GEOSCIENTISTS
MANITOBA**

Certificate of Authorization
Dillon Consulting Limited (MB)
No. 1789 Date: 2025/03/25

B.M. ELEV.	DESIGNED BY	DRC
	DRAWN BY	DRC
	CHECKED BY	LAS
	APPROVED BY	TJP
	HOR. SCALE	1:500
	VERTICAL	-

NO.	REVISIONS	DATE	BY
1	ISSUED FOR ADDENDUM 2	25/04/04	LAS
0	ISSUED FOR TENDER	25/03/25	LAS

DILLON CONSULTING

RELEASED FOR CONSTRUCTION

DATE

THE CITY OF WINNIPEG
PUBLIC WORKS DEPARTMENT

2025 RESIDENTIAL STREETS RENEWAL PROGRAM
CROMWELL STREET AND VARIOUS OTHER LOCATIONS

LAKWOOD BOULEVARD
TRANSIT STOP IMPROVEMENT

ENGINEER'S SEAL

CONSULTANT PROJECT NUMBER
24-9227

CITY DRAWING NUMBER

SHEET **B2** OF **B5**

TENDER NO.

GENERAL CONSTRUCTION NOTES:

1. CITY OF WINNIPEG TRANSIT DEPARTMENT WILL BE RESPONSIBLE TO INSTALL TRANSIT SHELTERS.
2. CONTRACTOR RESPONSIBLE TO "MAKE GOOD" AND CLEAN SITE, REPAIR DAMAGED SOD, ETC. AT COMPLETION OF CONSTRUCTION.

GENERAL CONCRETE NOTES:

3. ALL DIMENSIONS SHALL BE CHECKED AND VERIFIED PRIOR TO COMMENCING CONSTRUCTION.
4. CONFIRM THE LOCATION OF ALL SUBGRADE SERVICES PRIOR TO COMMENCING SITE WORK.
5. EXCAVATE ALL TOPSOIL, ORGANIC MATERIAL AND LOOSE OR UNSUITABLE FILL TO THE APPROVAL OF THE CONTRACT ADMINISTRATOR.
6. EXCAVATE BELOW SLABS ON FILL TO PROVIDE A MINIMUM OF 150 mm OF GRANULAR. FILL SHALL BE COMPACTED TO 95% MODIFIED PROCTOR DENSITY.
7. CONSTRUCTION JOINT LOCATIONS ARE TO BE APPROVED BY THE CONTRACT ADMINISTRATOR.
8. ALL CONCRETE PILES AND BASES TO BE REVIEWED AND APPROVED BY SIGNAGE & SHELTER MANUFACTURERS' STRUCTURAL ENGINEER PRIOR TO CONSTRUCTION. CONTRACTOR TO MAKE ANY CHANGES REQUIRED AT NO EXTRA COST.

REINFORCING NOTES:

9. PERFORM CONCRETE WORK IN ACCORDANCE WITH CAN3-A23.3-M84 UNLESS INDICATED OTHERWISE.
10. ALL REINFORCING BARS SHALL BE DEFORMED BARS WITH A MINIMUM SPECIFIED YIELD STRENGTH 400MPa FOR 20M BARS AND 300MPa FOR 15M AND 10M BARS IN ACCORDANCE WITH CAN-630.18-M92.
11. COVER TO REINFORCING: SLABS 50 mm CLEAR TOP AND BOTTOM.
12. BEFORE PLACING ENSURE REINFORCING IS CLEAN, FREE OF LOOSE SCALE, DIRT, OR OTHER FOREIGN COATING WHICH WOULD REDUCE THE BOND TO CONCRETE.
13. SHOP DRAWINGS SHALL BE SUBMITTED WHICH CLEARLY INDICATE BAR SIZES, SPACINGS, LOCATIONS AND QUANTITIES OF REINFORCING STEEL AND WIRE FABRIC, BENDING AND CUTTING SCHEDULES, AND SUPPORTING AND SPACING DEVICES FOR REVIEW PRIOR TO FABRICATION OF THE REINFORCING STEEL. DETAIL IN ACCORDANCE WITH THE LATEST ACI DETAILING MANUAL.

CONCRETE NOTES:

14. ALL CONCRETE WORK SHALL BE IN ACCORDANCE WITH CAN3-A23.1-M90 - CONCRETE CONSTRUCTION.
15. PROPORTION NORMAL DENSITY CONCRETE IN ACCORDANCE WITH CAN-A23.1-M90. REFER TO SPECIFICATION FOR DESIGN MIXES.

16. CONSTRUCT FORMWORK, SHORING AND BRACING TO MEET DESIGN, CODE AND CAN3-A23.1-M90 REQUIREMENTS, ACCURATELY, SO THAT RESULTANT FINISHED CONCRETE CONFORMS TO SHAPES, LINES AND DIMENSIONS INDICATED ON THE DRAWINGS.
17. CONSTRUCTION JOINTS, OUR SCHEDULING AND WORK PROCEDURES SHALL BE DISCUSSED WITH THE CONTRACT ADMINISTRATOR PRIOR TO COMMENCING CONSTRUCTION.
18. FOR COLD WEATHER CONCRETING, ALL ICE, SNOW AND FROST SHALL BE REMOVED FROM FORMWORK AND THE TEMPERATURES OF ALL CONTRACT SURFACES SHALL BE RAISED ABOVE 10°C FOR 24 HOURS PRIOR TO CASTING CONCRETE SHALL BE NOT LESS THAN 20C NOR MORE THAN 5C FOR AN ADDITIONAL 4 DAYS.
19. NOTIFY THE CONTRACT ADMINISTRATOR 48 HOURS PRIOR TO POURING CONCRETE.
20. THREE CONCRETE TEST CYLINDERS AND ONE SLUMP TEST SHALL BE TAKEN FOR EVERY 75 CUBIC METERS OF EACH CLASS OF CONCRETE PLACED OR FOR EACH DAY OF CONCRETE PLACEMENT IF THE LATTER IS LESS THAN 75 CUBIC METERS. TESTING SHALL BE PERFORMED IN ACCORDANCE WITH CAN3-A23.1-M90.

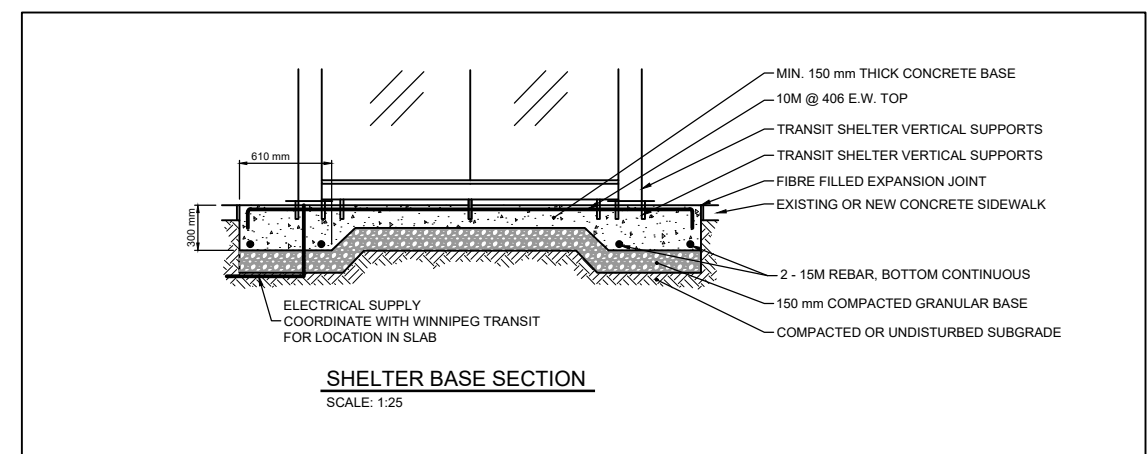
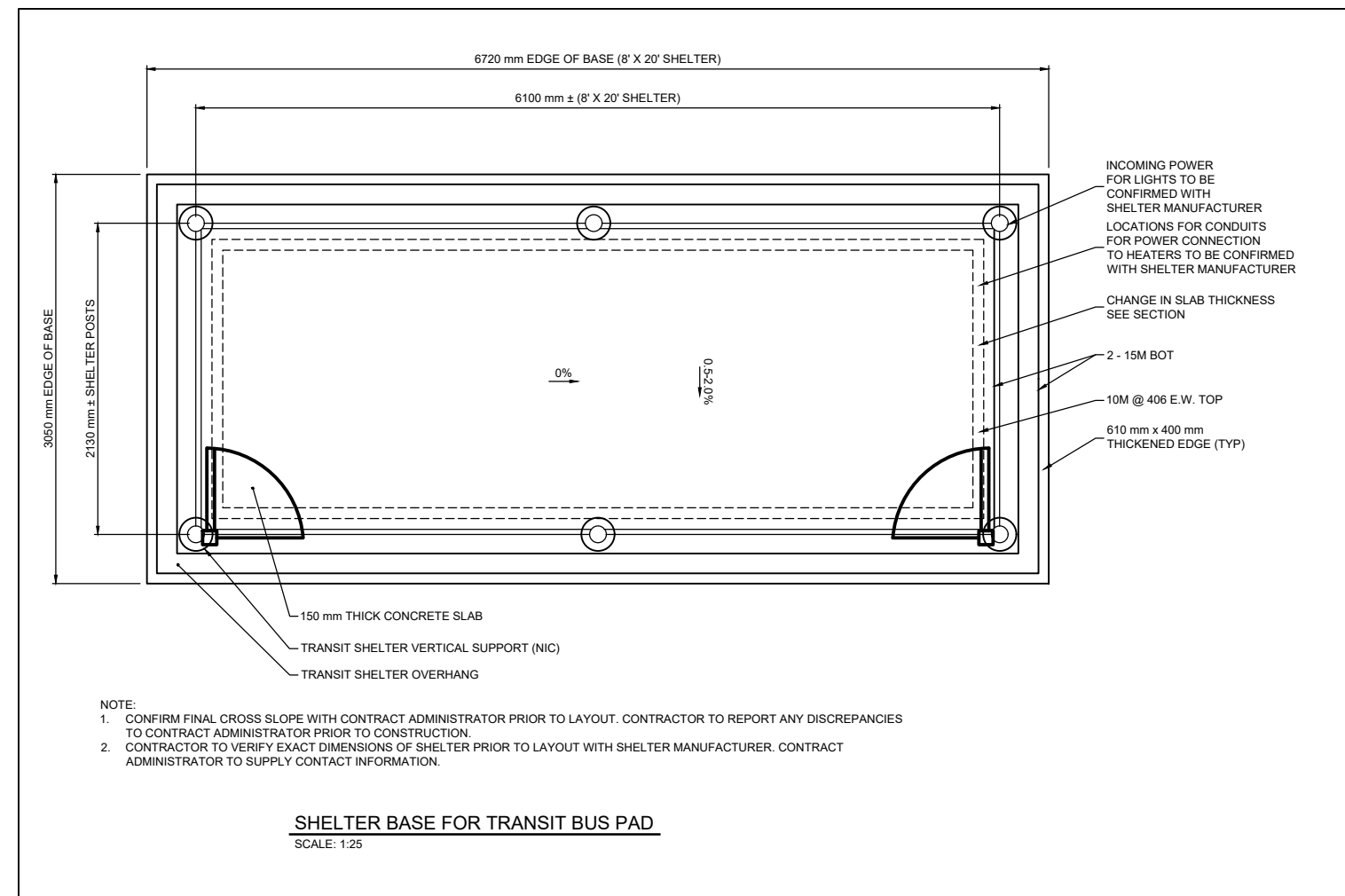

NOTES:

1. ALL WORK AND MATERIALS TO BE IN ACCORDANCE WITH LATEST REVISION OF THE CITY OF WINNIPEG STANDARD CONSTRUCTION SPECIFICATIONS.
2. LEGAL PLAN AND UNDERGROUND INFORMATION FROM CITY OF WINNIPEG LBIS. ALL UNDERGROUNDS TO BE VERIFIED BY THE CONTRACTOR IN THE FIELD.
3. CONTRACTOR TO TAKE PRECAUTIONARY STEPS TO AVOID DAMAGE FROM CONSTRUCTION ACTIVITIES TO TREES WITHIN THE LIMITS OF CONSTRUCTION.
4. LOCATION OF EXISTING SERVICES TO BE CONFIRMED IN THE FIELD BY THE CONTRACTOR.
5. LIMITS OF BOULEVARD GRADING TO BE FINALIZED IN THE FIELD BY THE CONTRACT ADMINISTRATOR.
6. ADJUST ALL WATER VALVES, MANHOLES, CATCH BASINS AND CATCH PITS TO GRADE.
7. PAVEMENT REPAIRS SHOWN ARE ONLY REPRESENTATIVE OF APPROXIMATION OF CONSTRUCTION.
8. CONTRACTOR TO INSTALL CONCRETE RISERS BY REMOVING THE EXISTING FLAT TOP REDUCER, PLACING RISERS AS DIRECTED BY THE CONTRACT ADMINISTRATOR AND THEN REINSTALLING THE EXISTING FLAT TOP REDUCER.
9. EXCAVATIONS WITHIN 1.0m FROM THE OUTER EDGE OF WM TO THE NEAREST EDGE OF EXCAVATION ARE TO BE CONDUCTED WITHOUT HEAVY VIBRATORY EQUIPMENT. BOTH SAW CUTTING AND REMOVAL OR SOFT DIGGING ARE ACCEPTABLE MEANS OF EXCAVATION AT THESE LOCATIONS.

⊕	HYDRANT	150 WM	WATERMAIN	150 WM	CONCRETE ROAD	CONCRETE ROAD
⊙	VALVE	300 LDS	LAND DRAINAGE SEWER	300 LDS	ASPHALT ROAD	ASPHALT ROAD
↙	CURB STOP	250 WWS	WASTE WATER SEWER	250 WWS	CONC ROAD W/ASP OVERLAY	CONC ROAD W/ASP OVERLAY
⊕	LIGHT STANDARD	HYDRO	HYDRO	HYDRO	CONCRETE SIDEWALK	CONCRETE SIDEWALK
⊕	HYDRO POLE	BELLMTS	BELLMTS	BELLMTS	ASPHALT PATH	ASPHALT PATH
⊙	TREE	100 GAS	GAS	100 GAS	LANDSCAPING FEATURE	LANDSCAPING FEATURE
⊙	GEODETIC BENCH MARK	T.S.	TRAFFIC SIGNALS	T.S.	GRASS/SOD	GRASS/SOD
⊕	SURVEY BAR	S.L.	STREET LIGHTS	S.L.	ELEVATION	ELEVATION
⊙	MANHOLE	→	TRAFFIC SIGNAL POLE	→	PROPERTY LINE	PROPERTY LINE
⊕	CATCH BASIN	→	PAVING STONE	→	CURB RAMP	CURB RAMP
▽	CATCH PIT	→	CURB RENEWAL	→	DETECTABLE TILE	DETECTABLE TILE
EXISTING	LEGEND-PLAN	PROPOSED	EXISTING	LEGEND-PLAN	PROPOSED	EXISTING

METRIC

WHOLE NUMBERS INDICATE MILLIMETRES
DECIMALIZED NUMBERS INDICATE METRES

**ENGINEERS
GEOSCIENTISTS
MANITOBA**

Certificate of Authorization
Dillon Consulting Limited (MB)
No. 1789 Date: 2025/03/25

B.M. ELEV.					
DESIGNED BY	DRC	ENGINEER'S SEAL			
DRAWN BY	DRC				
CHECKED BY	LAS				
APPROVED BY	TJP				
HOR. SCALE	AS NOTED	RELEASED FOR CONSTRUCTION			
VERTICAL	-	CONSULTANT PROJECT NUMBER	24-9227		
NO.	REVISIONS	DATE	BY	DATE	
0	ISSUED FOR TENDER	25/03/25	LAS		

**DILLON
CONSULTING**

THE CITY OF WINNIPEG
PUBLIC WORKS DEPARTMENT

2025 RESIDENTIAL STREETS RENEWAL PROGRAM
CROMWELL STREET AND VARIOUS OTHER LOCATIONS

LAKEWOOD BOULEVARD - DETAIL
TRANSIT STOP IMPROVEMENT

CITY DRAWING NUMBER

SHEET **B3** OF **B5**

TENDER NO.

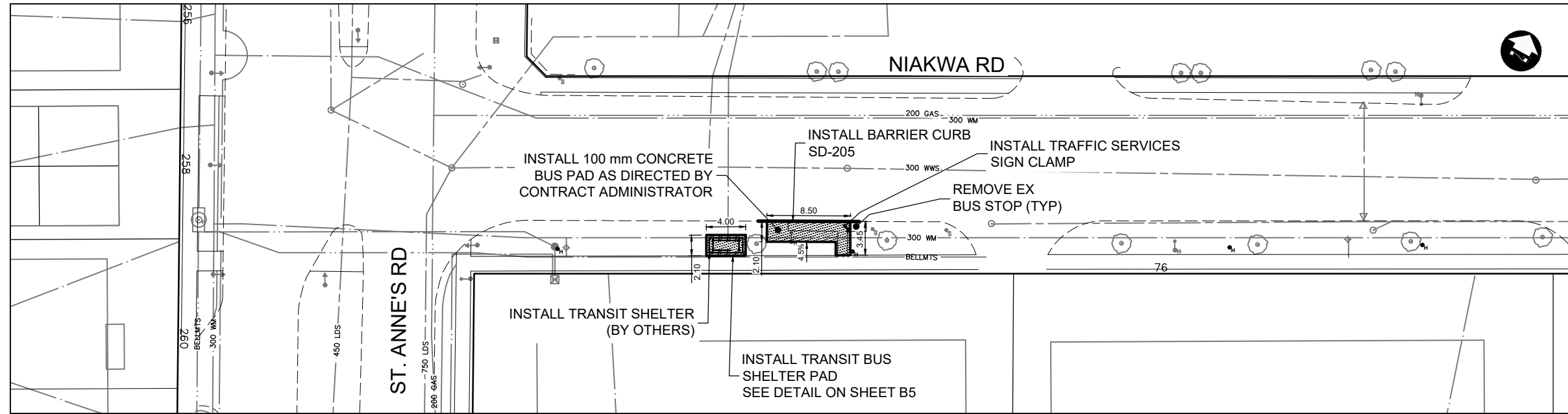

NOTES:

1. ALL WORK AND MATERIALS TO BE IN ACCORDANCE WITH LATEST REVISION OF THE CITY OF WINNIPEG STANDARD CONSTRUCTION SPECIFICATIONS.
2. LEGAL PLAN AND UNDERGROUND INFORMATION FROM CITY OF WINNIPEG LBIS. ALL UNDERGROUNDS TO BE VERIFIED BY THE CONTRACTOR IN THE FIELD.
3. CONTRACTOR TO TAKE PRECAUTIONARY STEPS TO AVOID DAMAGE FROM CONSTRUCTION ACTIVITIES TO TREES WITHIN THE LIMITS OF CONSTRUCTION.
4. LOCATION OF EXISTING SERVICES TO BE CONFIRMED IN THE FIELD BY THE CONTRACTOR.
5. LIMITS OF BOULEVARD GRADING TO BE FINALIZED IN THE FIELD BY THE CONTRACT ADMINISTRATOR.
6. ADJUST ALL WATER VALVES, MANHOLES, CATCH BASINS AND CATCH PITS TO GRADE.
7. PAVEMENT REPAIRS SHOWN ARE ONLY REPRESENTATIVE OF APPROXIMATION OF CONSTRUCTION.
8. CONTRACTOR TO INSTALL CONCRETE RISERS BY REMOVING THE EXISTING FLAT TOP REDUCER, PLACING RISERS AS DIRECTED BY THE CONTRACT ADMINISTRATOR AND THEN REINSTALLING THE EXISTING FLAT TOP REDUCER.
9. EXCAVATIONS WITHIN 1.0m FROM THE OUTER EDGE OF WM TO THE NEAREST EDGE OF EXCAVATION ARE TO BE CONDUCTED WITHOUT HEAVY VIBRATORY EQUIPMENT. BOTH SAW CUTTING AND REMOVAL OR SOFT DIGGING ARE ACCEPTABLE MEANS OF EXCAVATION AT THESE LOCATIONS.

EXISTING	LEGEND-PLAN	PROPOSED	EXISTING	LEGEND-PLAN	PROPOSED	EXISTING	LEGEND-PLAN	PROPOSED
	HYDRANT		150 WM	WATERMAIN	150 WM		CONCRETE ROAD	
	VALVE		300 LDS	LAND DRAINAGE SEWER	300 LDS		ASPHALT ROAD	
	CURB STOP		250 WWS	WASTE WATER SEWER	250 WWS		CONC ROAD W/ASP OVERLAY	
	LIGHT STANDARD		HYDRO	HYDRO	HYDRO		CONCRETE SIDEWALK	
	HYDRO POLE		BELLMTS	BELLMTS	BELLMTS		ASPHALT PATH	
	TREE		100 GAS	GAS	100 GAS		LANDSCAPING FEATURE	
	GEODETC BENCH MARK		T.S.	TRAFFIC SIGNALS	T.S.		GRASS/SOD	
	SURVEY BAR		S.L.	STREET LIGHTS	S.L.		ELEVATION	
	MANHOLE		232.000	TRAFFIC SIGNAL POLE	232.000		PROPERTY LINE	
	CATCH BASIN			PAVING STONE			CURB RAMP	
	CATCH PIT			CURB RENEWAL			DETECTABLE TILE	

METRIC

WHOLE NUMBERS INDICATE MILLIMETRES
DECIMALIZED NUMBERS INDICATE METRES

**ENGINEERS
GEOSCIENTISTS
MANITOBA**

Certificate of Authorization
Dillon Consulting Limited (MB)
No. 1789 Date: 2025/03/25

B.M. ELEV.	DESIGNED BY	ENGINEER'S SEAL
	DRC	
	DRAWN BY	
	CHECKED BY	
	APPROVED BY	
	HOR. SCALE	1:500
	VERTICAL	-
0	ISSUED FOR TENDER	25/03/25 LAS
	NO. REVISIONS	DATE BY DATE

	THE CITY OF WINNIPEG PUBLIC WORKS DEPARTMENT	CITY DRAWING NUMBER
2025 RESIDENTIAL STREETS RENEWAL PROGRAM CROMWELL STREET AND VARIOUS OTHER LOCATIONS		SHEET B4 OF B5
NIAKWA ROAD TRANSIT STOP IMPROVEMENT		TENDER NO.
CONSULTANT PROJECT NUMBER 24-9227		

GENERAL CONSTRUCTION NOTES:

1. CITY OF WINNIPEG TRANSIT DEPARTMENT WILL BE RESPONSIBLE TO INSTALL TRANSIT SHELTERS.
2. CONTRACTOR RESPONSIBLE TO "MAKE GOOD" AND CLEAN SITE, REPAIR DAMAGED SOD, ETC. AT COMPLETION OF CONSTRUCTION.

GENERAL CONCRETE NOTES:

3. ALL DIMENSIONS SHALL BE CHECKED AND VERIFIED PRIOR TO COMMENCING CONSTRUCTION.
4. CONFIRM THE LOCATION OF ALL SUBGRADE SERVICES PRIOR TO COMMENCING SITE WORK.
5. EXCAVATE ALL TOPSOIL, ORGANIC MATERIAL AND LOOSE OR UNSUITABLE FILL TO THE APPROVAL OF THE CONTRACT ADMINISTRATOR.
6. EXCAVATE BELOW SLABS ON FILL TO PROVIDE A MINIMUM OF 150 mm OF GRANULAR. FILL SHALL BE COMPACTED TO 95% MODIFIED PROCTOR DENSITY.
7. CONSTRUCTION JOINT LOCATIONS ARE TO BE APPROVED BY THE CONTRACT ADMINISTRATOR.
8. ALL CONCRETE PILES AND BASES TO BE REVIEWED AND APPROVED BY SIGNAGE & SHELTER MANUFACTURERS' STRUCTURAL ENGINEER PRIOR TO CONSTRUCTION. CONTRACTOR TO MAKE ANY CHANGES REQUIRED AT NO EXTRA COST.

REINFORCING NOTES:

9. PERFORM CONCRETE WORK IN ACCORDANCE WITH CAN3-A23.3-M84 UNLESS INDICATED OTHERWISE.
10. ALL REINFORCING BARS SHALL BE DEFORMED BARS WITH A MINIMUM SPECIFIED YIELD STRENGTH 400MPa FOR 20M BARS AND 300MPa FOR 15M AND 10M BARS IN ACCORDANCE WITH CAN-630.18-M92.
11. COVER TO REINFORCING: SLABS 50 mm CLEAR TOP AND BOTTOM.
12. BEFORE PLACING ENSURE REINFORCING IS CLEAN, FREE OF LOOSE SCALE, DIRT, OR OTHER FOREIGN COATING WHICH WOULD REDUCE THE BOND TO CONCRETE.
13. SHOP DRAWINGS SHALL BE SUBMITTED WHICH CLEARLY INDICATE BAR SIZES, SPACINGS, LOCATIONS AND QUANTITIES OF REINFORCING STEEL AND WIRE FABRIC, BENDING AND CUTTING SCHEDULES, AND SUPPORTING AND SPACING DEVICES FOR REVIEW PRIOR TO FABRICATION OF THE REINFORCING STEEL. DETAIL IN ACCORDANCE WITH THE LATEST ACI DETAILING MANUAL.

CONCRETE NOTES:

14. ALL CONCRETE WORK SHALL BE IN ACCORDANCE WITH CAN3-A23.1-M90 - CONCRETE CONSTRUCTION.
15. PROPORTION NORMAL DENSITY CONCRETE IN ACCORDANCE WITH CAN-A23.1-M90. REFER TO SPECIFICATION FOR DESIGN MIXES.

16. CONSTRUCT FORMWORK, SHORING AND BRACING TO MEET DESIGN, CODE AND CAN3-A23.1-M90 REQUIREMENTS, ACCURATELY, SO THAT RESULTANT FINISHED CONCRETE CONFORMS TO SHAPES, LINES AND DIMENSIONS INDICATED ON THE DRAWINGS.
17. CONSTRUCTION JOINTS, OUR SCHEDULING AND WORK PROCEDURES SHALL BE DISCUSSED WITH THE CONTRACT ADMINISTRATOR PRIOR TO COMMENCING CONSTRUCTION.
18. FOR COLD WEATHER CONCRETING, ALL ICE, SNOW AND FROST SHALL BE REMOVED FROM FORMWORK AND THE TEMPERATURES OF ALL CONTRACT SURFACES SHALL BE RAISED ABOVE 10°C FOR 24 HOURS PRIOR TO CASTING CONCRETE SHALL BE NOT LESS THAN 20C NOR MORE THAN 5C FOR AN ADDITIONAL 4 DAYS.
19. NOTIFY THE CONTRACT ADMINISTRATOR 48 HOURS PRIOR TO POURING CONCRETE.
20. THREE CONCRETE TEST CYLINDERS AND ONE SLUMP TEST SHALL BE TAKEN FOR EVERY 75 CUBIC METERS OF EACH CLASS OF CONCRETE PLACED OR FOR EACH DAY OF CONCRETE PLACEMENT IF THE LATTER IS LESS THAN 75 CUBIC METERS. TESTING SHALL BE PERFORMED IN ACCORDANCE WITH CAN3-A23.1-M90.

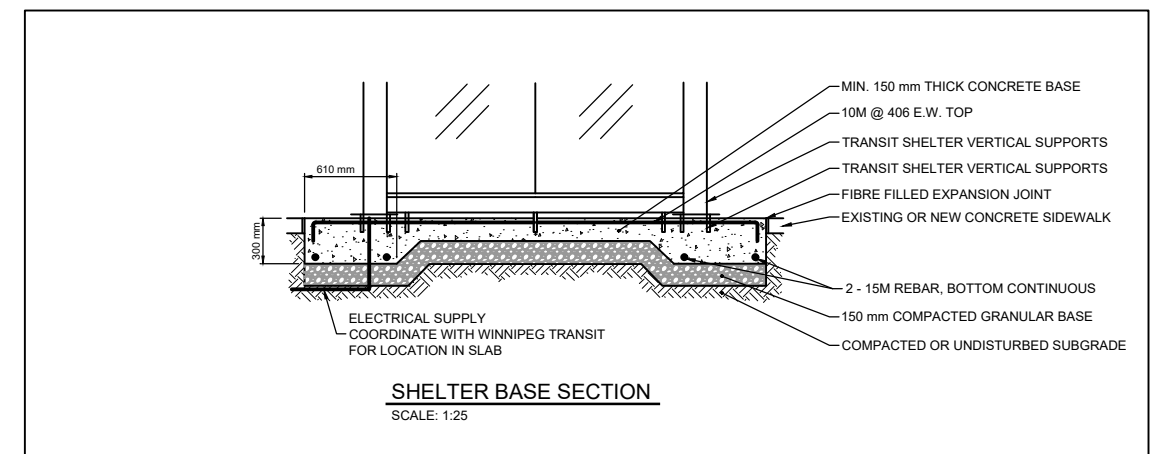
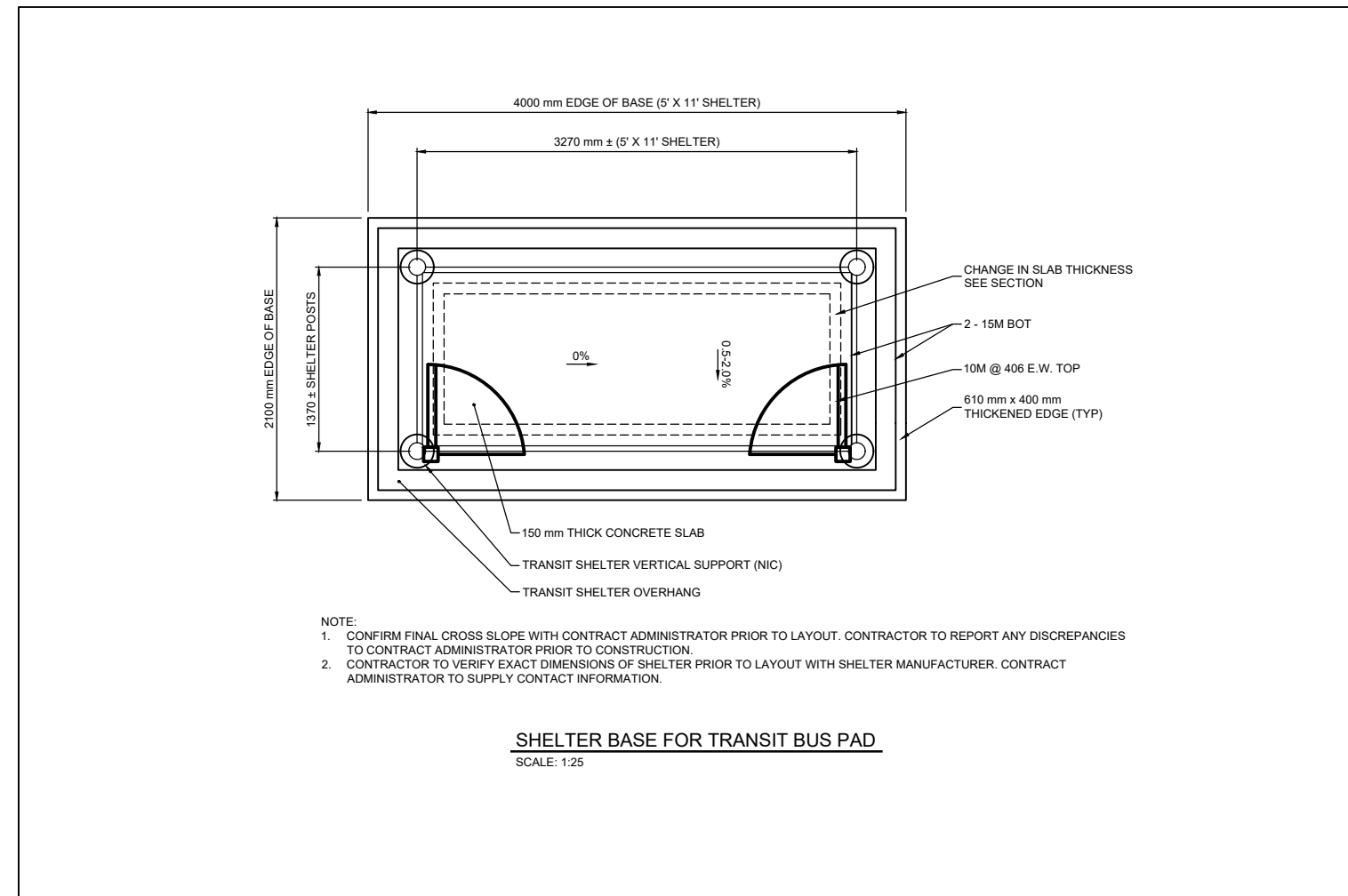

NOTES:

1. ALL WORK AND MATERIALS TO BE IN ACCORDANCE WITH LATEST REVISION OF THE CITY OF WINNIPEG STANDARD CONSTRUCTION SPECIFICATIONS.
2. LEGAL PLAN AND UNDERGROUND INFORMATION FROM CITY OF WINNIPEG LBIS. ALL UNDERGROUNDS TO BE VERIFIED BY THE CONTRACTOR IN THE FIELD.
3. CONTRACTOR TO TAKE PRECAUTIONARY STEPS TO AVOID DAMAGE FROM CONSTRUCTION ACTIVITIES TO TREES WITHIN THE LIMITS OF CONSTRUCTION.
4. LOCATION OF EXISTING SERVICES TO BE CONFIRMED IN THE FIELD BY THE CONTRACTOR.
5. LIMITS OF BOULEVARD GRADING TO BE FINALIZED IN THE FIELD BY THE CONTRACT ADMINISTRATOR.
6. ADJUST ALL WATER VALVES, MANHOLES, CATCH BASINS AND CATCH PITS TO GRADE.
7. PAVEMENT REPAIRS SHOWN ARE ONLY REPRESENTATIVE OF APPROXIMATION OF CONSTRUCTION.
8. CONTRACTOR TO INSTALL CONCRETE RISERS BY REMOVING THE EXISTING FLAT TOP REDUCER, PLACING RISERS AS DIRECTED BY THE CONTRACT ADMINISTRATOR AND THEN REINSTALLING THE EXISTING FLAT TOP REDUCER.
9. EXCAVATIONS WITHIN 1.0m FROM THE OUTER EDGE OF WM TO THE NEAREST EDGE OF EXCAVATION ARE TO BE CONDUCTED WITHOUT HEAVY VIBRATORY EQUIPMENT. BOTH SAW CUTTING AND REMOVAL OR SOFT DIGGING ARE ACCEPTABLE MEANS OF EXCAVATION AT THESE LOCATIONS.

EXISTING	LEGEND-PLAN	PROPOSED	EXISTING	LEGEND-PLAN	PROPOSED	EXISTING	LEGEND-PLAN	PROPOSED
⊕	HYDRANT	⊕	150 WM	WATERMAIN	150 WM	▬▬▬▬	CONCRETE ROAD	▬▬▬▬▬▬
⊙	VALVE	⊙	300 LDS	LAND DRAINAGE SEWER	300 LDS	▬▬▬▬▬▬	ASPHALT ROAD	▬▬▬▬▬▬▬▬
↙	CURB STOP	↙	250 WWS	WASTE WATER SEWER	250 WWS	▬▬▬▬▬▬▬▬	CONC ROAD W/ASP OVERLAY	▬▬▬▬▬▬▬▬▬▬
⊕	LIGHT STANDARD	⊕	HYDRO	HYDRO	HYDRO	▬▬▬▬▬▬▬▬	CONCRETE SIDEWALK	▬▬▬▬▬▬▬▬▬▬
⊕	HYDRO POLE	⊕	BELLMTS	BELLMTS	BELLMTS	▬▬▬▬▬▬▬▬	ASPHALT PATH	▬▬▬▬▬▬▬▬▬▬
⊕	TREE	⊕	100 GAS	GAS	100 GAS	▬▬▬▬▬▬▬▬	LANDSCAPING FEATURE	▬▬▬▬▬▬▬▬▬▬
⊕	GEODETIC BENCH MARK	⊕	T.S.	TRAFFIC SIGNALS	T.S.	▬▬▬▬▬▬▬▬	GRASS/SOD	▬▬▬▬▬▬▬▬▬▬
⊕	SURVEY BAR	⊕	S.L.	STREET LIGHTS	S.L.	▬▬▬▬▬▬▬▬	ELEVATION	232.000
⊕	MANHOLE	⊕	→	TRAFFIC SIGNAL POLE	→	▬▬▬▬▬▬▬▬	PROPERTY LINE	▬▬▬▬▬▬▬▬▬▬
⊕	CATCH BASIN	⊕	▬▬▬▬	PAVING STONE	▬▬▬▬	▬▬▬▬▬▬▬▬	CURB RAMP	▬▬▬▬▬▬▬▬▬▬
⊕	CATCH PIT	⊕	▬▬▬▬	CURB RENEWAL	▬▬▬▬	▬▬▬▬▬▬▬▬	DETECTABLE TILE	▬▬▬▬▬▬▬▬▬▬

METRIC
WHOLE NUMBERS INDICATE MILLIMETRES
DECIMALIZED NUMBERS INDICATE METRES

**ENGINEERS
GEOSCIENTISTS
MANITOBA**
Certificate of Authorization
Dillon Consulting Limited (MB)
No. 1789 Date: 2025/03/25

B.M. ELEV.	DESIGNED BY	ENGINEER'S SEAL
	DRC	
	DRAWN BY	
	DRC	
	CHECKED BY	
	LAS	
	APPROVED BY	
	TJP	
	HOR. SCALE	AS NOTED
	VERTICAL	-
0	ISSUED FOR TENDER	25/03/25 LAS
NO.	REVISIONS	DATE BY DATE

DILLON CONSULTING	ENGINEER'S SEAL	THE CITY OF WINNIPEG PUBLIC WORKS DEPARTMENT	CITY DRAWING NUMBER
	RELEASED FOR CONSTRUCTION		2025 RESIDENTIAL STREETS RENEWAL PROGRAM CROMWELL STREET AND VARIOUS OTHER LOCATIONS
CONSULTANT PROJECT NUMBER	24-9227	NIakwa ROAD - DETAIL TRANSIT STOP IMPROVEMENT	SHEET B5 OF B5
DATE		TENDER NO.	