

CONSTRUCTION NOTES:

PROJECT SCOPE

1. INSTALL CONDUIT, BASES AND PIT AS SHOWN.
2. INSTALL SERVICE AND GROUND ROD ON WOOD POLE #X AS SHOWN. INSTALL MAST AND DISCONNECT ON XX QUADRANT. INSTALL WEATHER HEAD 150mm LOWER THAN THE LOWEST HYDRO WIRE. TOTAL LENGTH OF SERVICE CABLE: 75m.
3. INSTALL EQUIPMENT AS SHOWN.
4. INSTALL LOW FLASHERS AT HEIGHT OF 2.6m (8'-6") ABOVE THE BASE. PEDESTRIAN SIGNS TO BE 4' BELOW LOW FLASHERS.
5. TIMINGS REQUIRED. CROSSING TIME FOR WEST CROSSWALK: XX SECONDS, EAST CROSSWALK: XX SECONDS.

PROJECT COORDINATION

1. COORDINATE WORK WITH (CA'S NAME), (204) XXX-XXXX.
2. COORDINATE HYDRO SERVICE INSTALLATION WITH (HYDRO DESIGNER), (204) XXX-XXXX. RE: JUTA PERMIT No. BXXXXX

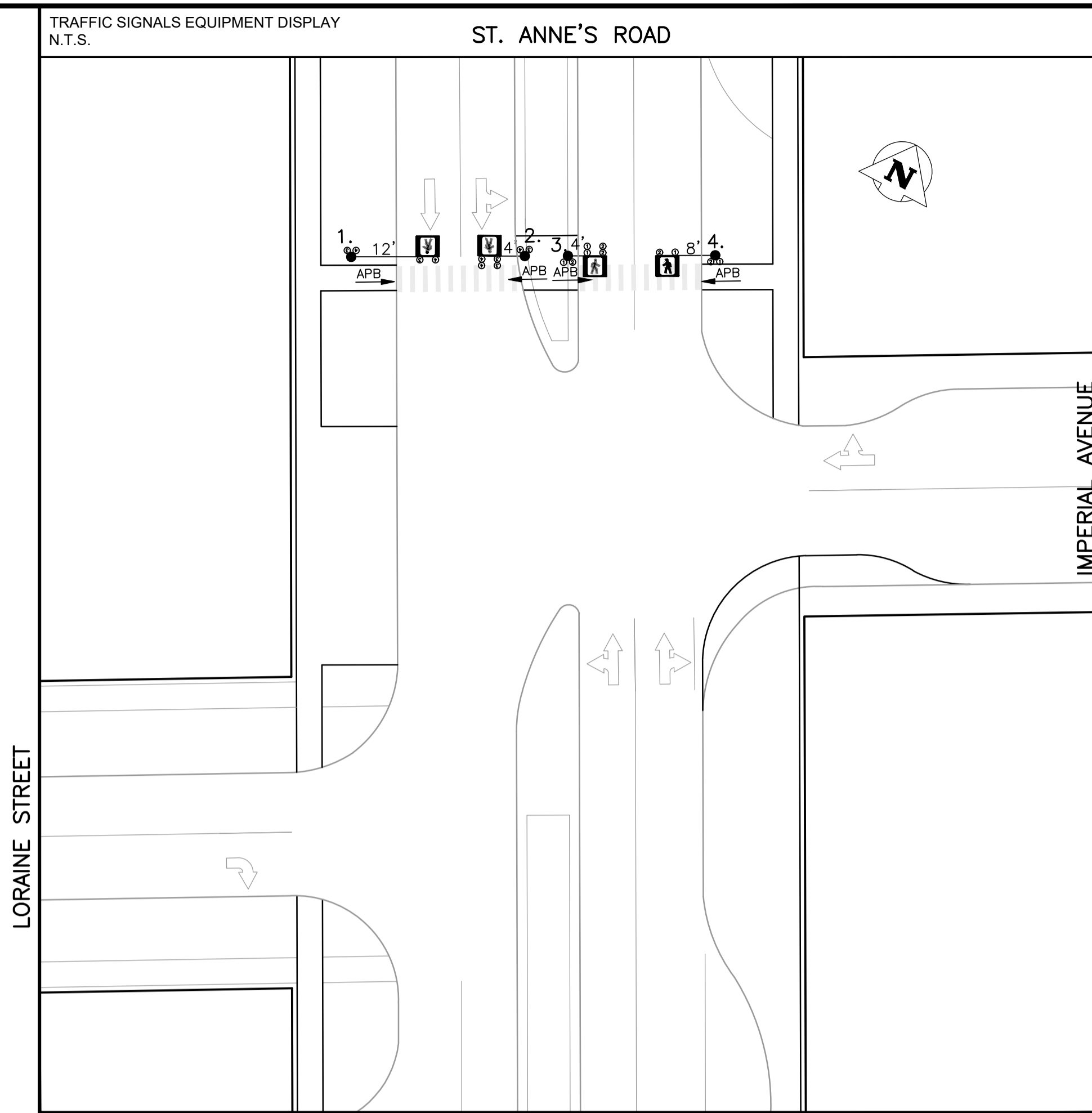
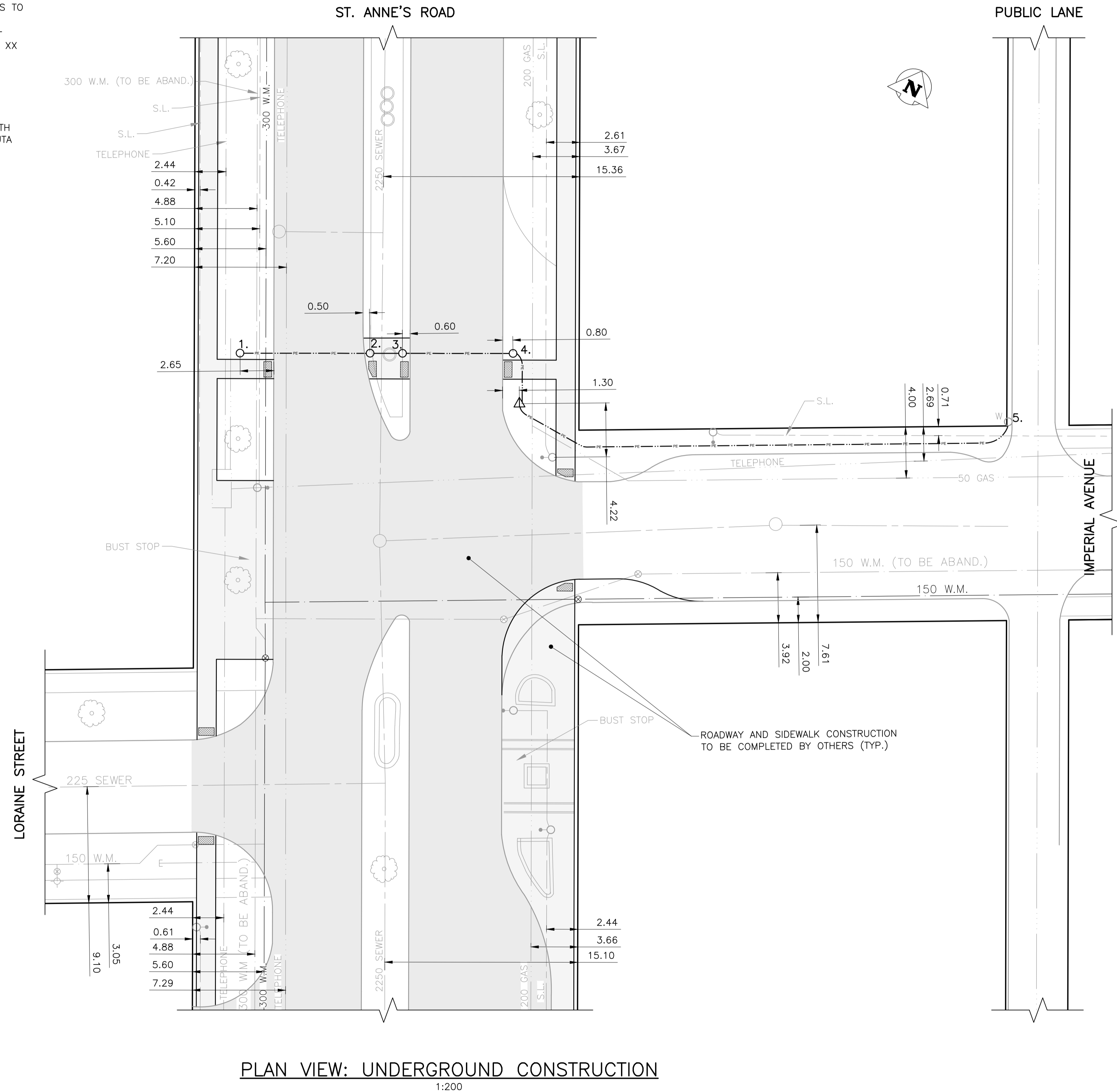

EQUIPMENT DISPLAY LEGEND

NO.	EQUIPMENT LIST	ARM	BASE	B.B.	NO.	EQUIPMENT LIST	ARM	BASE	B.B.
1.	CANTILEVER	12'	OD	DC					
2.	CANTILEVER	4'	OD	DC					
3.	CANTILEVER	4'	OD	DC					
4.	CANTILEVER	8'	OD	DC					
5.	HYDRO WOOD #XXXXXX SERVICE:								

TRAFFIC SIGNALS UNDERGROUND LEGEND		SIGNAL BASE BOLT SQUARE TYPES	
EXISTING	PROPOSED (AS SHOWN BELOW)	BOLT SQUARE (B.S.) DIA.	
1 1/2" PE CONDUIT	POLE BASE	TYPE "A" - 8 1/8"	
2" PE CONDUIT	WOOD POST	TYPE "B" - 6 3/4"	
4" PVC CONDUIT	CONTROLLER BASE	TYPE "C" - 8 1/8" SCREW TYPE	
AERIAL / BURIED CABLE	PEDESTAL BASE	TYPE "D" - 12 3/4" x 1 1/4" DIA. BOLTS, 28" DIA.	
CONDUIT STUB	TERMINAL BASE	TYPE "E" - 12 3/4" x 1 1/4" DIA. BOLTS, 28" DIA.	
BREAK-IN	SERVICE BOX (PIT)	TYPE "F" - 9 9/16" SCREW TYPE	
SPLICE	24" PRECAST PIT	TYPE "G" - 8 1/8" x 1 1/4" DIA. BOLTS, 89mm PROJ.	
SAW-CUT LOOPS	30" PRECAST PIT	TYPE "H" - 8 1/8" x 1 1/4" DIA. BOLTS, 76mm PROJ.	
PERFORMED LOOPS	36" PRECAST PIT	TYPE "I" - 6" x 5/8" DIA. BOLTS	
	REMOVAL	TYPE "J" - 7 3/4"	
		TYPE "K" - 10 5/8" x 1 1/4" DIA. BOLTS	
		TYPE "L" - 10 5/8" x 1 1/4" DIA. BOLTS	
		TYPE "M" - 8 1/8" x 5/8" DIA. BOLTS	
		TYPE "N" - 8 1/8" x 5/8" DIA. BOLTS	

INTERNAL REVIEW

TIMINGS (INITIAL):	NEW TIMINGS?	DATE	INITIALS
TIMINGS (PRE-FCI):	NEW TIMINGS?	DATE	INITIALS
OPERATIONS:	DAYS REQUIRED	DATE	INITIALS
UNDERGROUND CONSTRUCTABILITY:	DAYS REQUIRED	DATE	INITIALS
LAB:	REQUIRE FIC DWG?	DAYS REQUIRED	DATE
TMC:		DATE	INITIALS
STREET LIGHTING:		DATE	INITIALS
TRAFFIC MANAGEMENT:		DATE	INITIALS

U:\Staff\Projects\2020\20200202_Empire\PublicWorks\Imperial & St. Anne's_S2202.dwg
 2020/02/15 10:58 AM
 User: jgibson

EXISTING	LEGEND	PROPOSED	EXISTING	LEGEND	PROPOSED	EXISTING	LEGEND	PROPOSED
	WATERMAIN			GAS			TELEPHONE	
	HYDRANT			SURVEY MARKER			COMMUNICATION	
	SHUTOFF VALVE			SIDEWALK			WOOD POLE	
	MANHOLE			WARNING TILE			STREET LIGHT	
	CATCH BASIN			RAILWAY POLE			GUY-WIRE	
	CURB INLET			FENCE			GUARDRAIL	
	HYDRO			TREE				

UNDERGROUND STRUCTURES

PENDING	DATE (YYYYMMDD)

CONSTRUCTION REVISIONS

NO.	REVISION	DATE (YYYYMMDD)	BY

ACCOUNTS:

DESIGNED BY	C.H.
DRAWN BY	C.H.
CHECKED BY	
APPROVED BY	

LIABILITY DISCLAIMER NOTICE:
 THE DIGITAL INFORMATION PROVIDED FOR YOUR CONVENIENCE HEREIN IS FOR USE AT YOUR OWN RISK. THE CITY OF WINNIPEG, PUBLIC WORKS DEPARTMENT, SHALL ASSUME NO RESPONSIBILITY FOR THE INFORMATION AND IT SHOULD NOT BE CONSTRUED AS ASSULT INFORMATION. THE INFORMATION SHOULD BE USED FOR PLANNING PURPOSES ONLY AND SHOULD BE VERIFIED BY SURVEY. THE DEPARTMENT SHALL NOT IN ANY WAY SUFFER ANY LIABILITY WHATSOEVER TO ANY PARTY FOR INJURY, LOSS OR DAMAGES SUFFERED BY SUCH PARTY ARISING FROM THEIR USE OF, OR RELIANCE UPON, THIS INFORMATION.

PRELIMINARY
 NOT FOR CONSTRUCTION

THE CITY OF WINNIPEG
 PUBLIC WORKS DEPARTMENT
 TRANSPORTATION DIVISION

PEDESTRIAN CORRIDOR
 IMPERIAL AVENUE & ST. ANNE'S ROAD

UNITS: ALL DIMENSIONS ARE IN METERS UNLESS OTHERWISE NOTED
 DRAWING NUMBER: S-2220