

1 **TIMBER FENCE ELEVATION**
Scale: 1:25

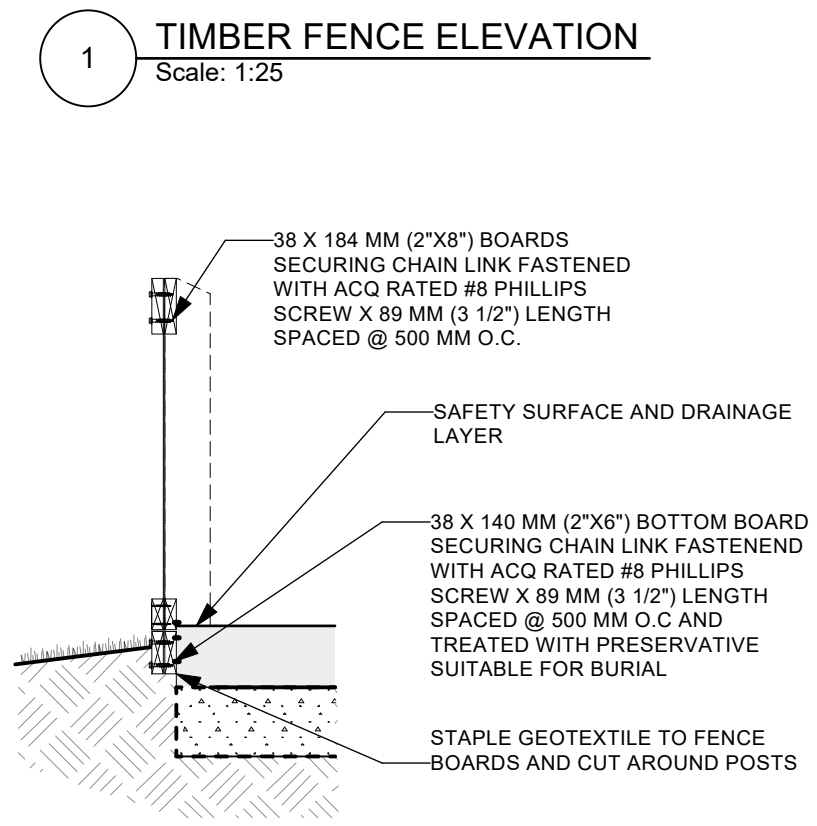

2 **TIMBER FENCE SECTION**
Scale: 1:25

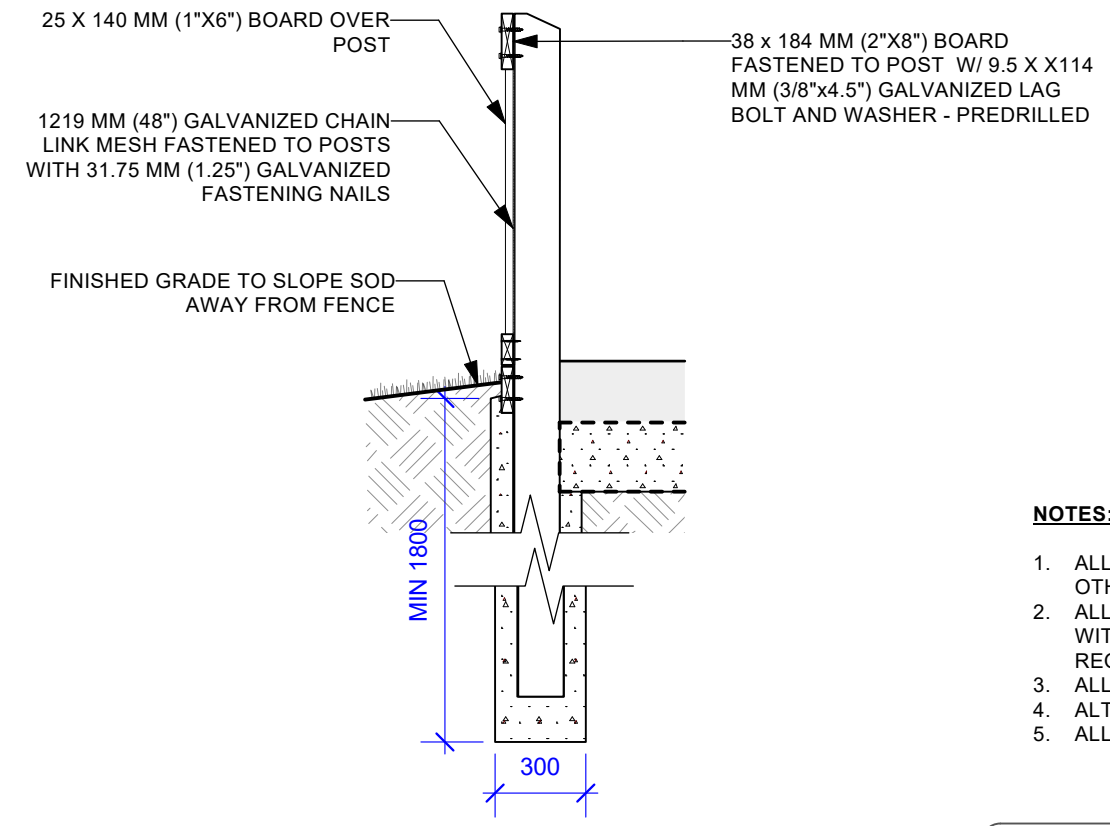

3 **TIMBER FENCE POST SECTION**
Scale: 1:25

NOTES:

1. ALL DIMENSIONS ARE IN MILLIMETERS UNLESS OTHERWISE NOTED
2. ALL WOOD TO BE PRESSURE TREATED, END AND CUTS TO BE TREATED WITH PRESERVATIVE (USE PRESERVATIVE SUITABLE FOR BURIAL WHERE REQUIRED)
3. ALL HARDWARE TO BE ACQ APPROVED
4. ALTERNATIVE ALIGNMENT OF BOARD ENDS ROW OVER ROW
5. ALL CHAIN LINK COMPONENTS TO BE GALVANIZED

CONTRACTOR TO CONFIRM ALL DIMENSIONS AND REPORT ANY DISCREPANCIES TO CONTRACT ADMINISTRATOR PRIOR TO CONSTRUCTION. LOCATION OF UNDERGROUND STRUCTURES AS SHOWN ARE BASED ON THE BEST INFORMATION AVAILABLE BUT NO GUARANTEE IS GIVEN THAT ALL EXISTING UTILITIES ARE SHOWN OR THAT THE GIVEN LOCATIONS ARE EXACT. CONFIRMATION OF EXISTENCE AND EXACT LOCATION OF ALL SERVICES MUST BE OBTAINED FROM THE INDIVIDUAL UTILITIES BEFORE PROCEEDING WITH CONSTRUCTION.



THE CITY OF WINNIPEG
Planning, Property and Development Department
Planning and Land Use Division
Unit 15 - 30 Fort Street, Winnipeg, MB, (R3C 4X5)

DESIGNED BY	CHECKED BY
DRAWN BY MA	APPROVED BY
HORIZ. SCALE As Shown	
VERT. SCALE As Shown	
DATE April 2025	

MANAGER, PARK AND OPEN SPACES	DATE
MANAGER, PLANNING AND LAND USE DIVISION	DATE

DRAWING TITLE Brooklyn Park South Tot Lot Playground Redevelopment Details	DRAWING NO. B.52-B4
SITE ADDRESS 242 Brooklyn St	BID OPPORTUNITY NO. 377-2025