

CROSS SECTION - STATION 1+95
 HORIZONTAL SCALE: 1:125
 VERTICAL SCALE: 1:25

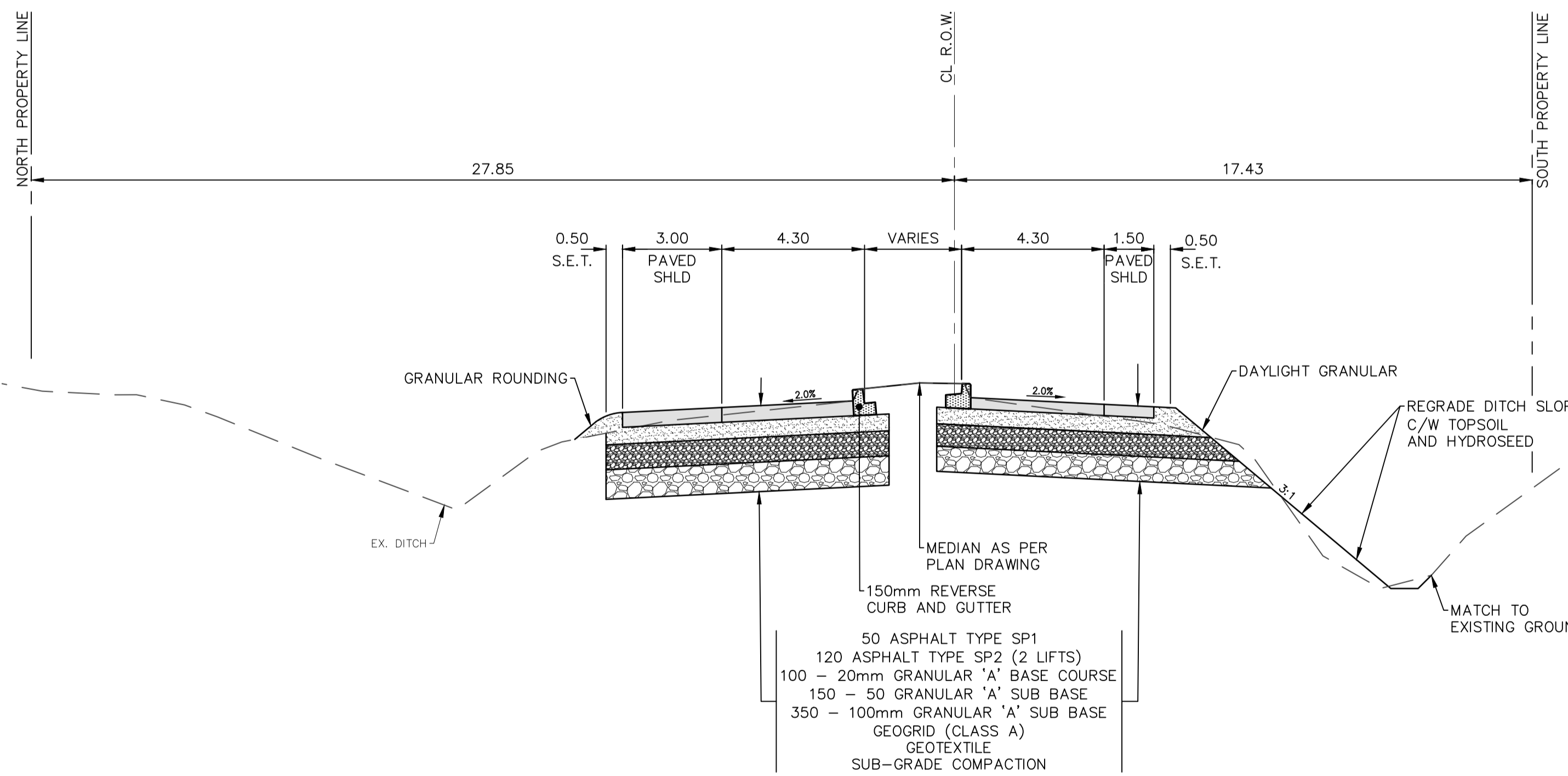

ASPHALT RECONSTRUCTION SECTION - STATION 4+25
 HORIZONTAL SCALE: 1:125
 VERTICAL SCALE: 1:25

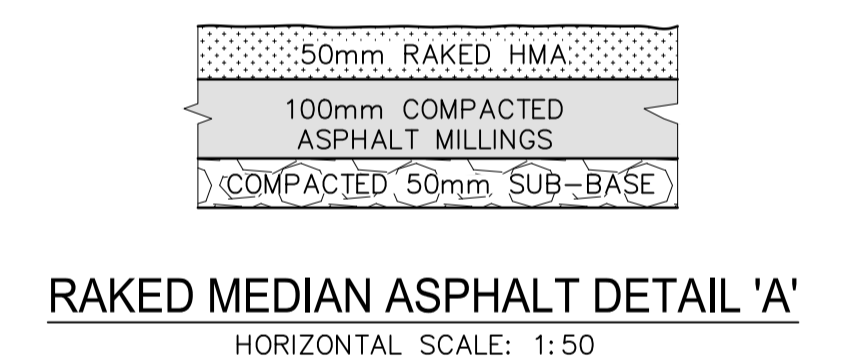

RAKED MEDIAN ASPHALT DETAIL 'A'
 HORIZONTAL SCALE: 1:50

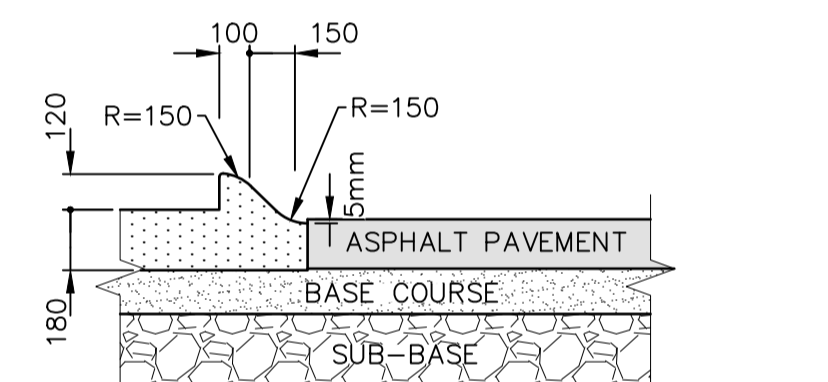

120mm MOUNTABLE REVERSE CURB AND GUTTER DETAIL 'C'
 HORIZONTAL SCALE: 1:25

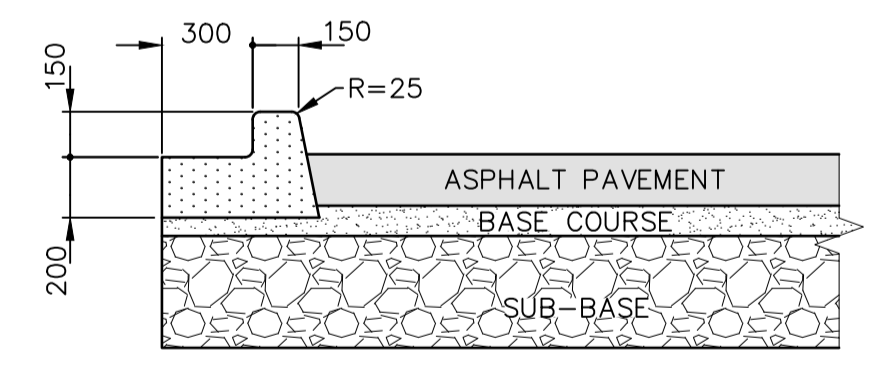

150mm BARRIER REVERSE CURB AND GUTTER DETAIL 'B'
 HORIZONTAL SCALE: 1:25

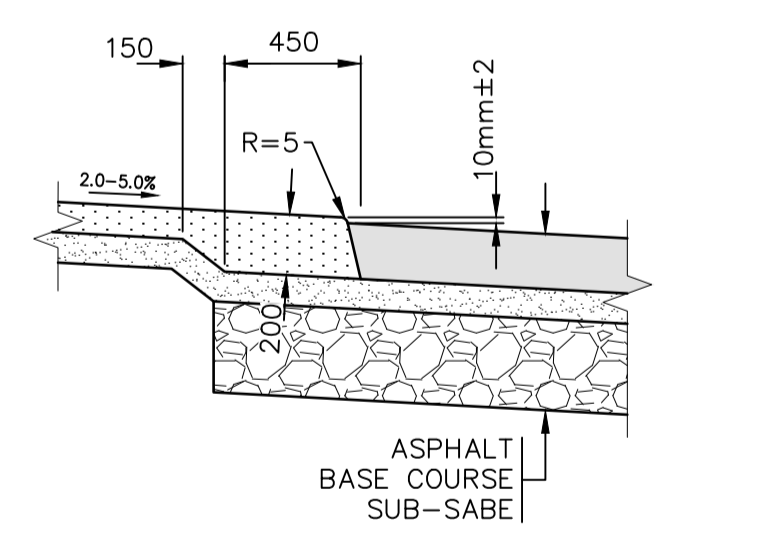

MONOLITHIC CURB RAMP DETAIL 'D'
 HORIZONTAL SCALE: 1:25

METRIC
 WHOLE NUMBERS INDICATE MILLIMETRES
 DECIMALIZED NUMBERS INDICATE METRES

FOR TENDER PURPOSES ONLY
 NOT FOR CONSTRUCTION

ENGINEERS
 GEOSCIENTISTS
 MANITOBA
 Certificate of Authorization
 WSP Canada Inc.
 No. 5750

—	WATER MAIN	⊙	⊙	VALVE	⊕	—	EDGE OF SIDEWALK	———
———	LAND DRAINAGE SEWER	⊕	⊕	CURB STOP	⊕	———	EDGE OF ASPHALT	———
———	WASTE WATER SEWER	⊕	⊕	HYDRO POLE & LIGHT STANDARD	⊕	———	EDGE OF CONCRETE	———
———	HYDRO	⊕	⊕	LIGHT STANDARD OR TRAFFIC SIGNAL	⊕	———	MODIFIED BARRIER CURB	———
———	GAS	⊕	⊕	HYDRO POLE / ANCHOR	⊕	———	BARRIER CURB	———
———	COMMUNICATIONS	⊕	⊕	FENCE	⊕	———	BARRIER CURB AND GUTTER	———
○	SIGNALS	⊕	⊕	PROPERTY LINE	———	———	CONCRETE SIDEWALK	———
○	MANHOLE	⊕	⊕	IRON BAR	⊕	———	CONCRETE SLAB	———
○	CATCH BASIN/CATCH PIT	⊕	⊕	TEST HOLE / PAVEMENT CORE	⊕	———	ASPHALT	———
△	CURB INLET	⊕	⊕	ELEVATIONS	(231.000)	———	MILLED SURFACE	———
△	UTILITIES ADJUSTED	△	△	CURB RAMP	———	———	RAKED ASPHALT	———
⊕	HYDRANT	⊕	⊕	DETECTABLE WARNING SURFACE TILE	⊕	———	CIREAM	———
—	EXISTING	—	—	LEGEND-PLAN	PROPOSED	EXISTING	LEGEND-PLAN	PROPOSED

LOCATIONS APPROVED UNDERGROUND STRUCTURES	SIGNED BY:	DATE:
	SUPV UG STRUCTURES	

G.B.M.	BOLT ON SIGNAL POLE AT DUGALD RD./RAVENHURST ST. CENTER MEDIAN EAST
ELEV.	235.970
7	
6	
5	
4	
3	
2	
1	
0	ISSUED FOR TENDER 2025-03-14 RB
NO.	REVISIONS DATE BY

DESIGNED BY: SS

CHECKED BY: VM

DRAWN BY: RB/SB/LT

APPROVED BY: SS

HOR. SCALE: 1:250

VERTICAL: 1:25

RELEASED FOR CONSTRUCTION

DATE: 2025/FEBRUARY

WSP Canada Inc. 1600 Buffalo Place Winnipeg, MB R3T 6B8 t. 204.477.6650 f. 204.474.2864 www.wsp.com
CONSULTANT ACAD DWG. NO. CA0022818.5512-25

THE CITY OF WINNIPEG
 PUBLIC WORKS DEPARTMENT
 ENGINEERING SERVICES DIVISION

DUGALD ROAD PAVEMENT RENEWAL - PLESSIS
 ROAD TO RAVENHURST STREET

CROSS SECTIONS AND DETAILS
 ASPHALT RECONSTRUCTION AND MILL&FILL

CITY DRAWING NUMBER: P-3594-25
 SHEET 25 OF 33

TENDER NO. 59-2025

Mar 14, 2025 - 9:04am P:\2024\CA0022818.5512 - Pavement Renewals Dugald & Plessis\02 Drawings\03_Work_Dwg\CA0022818.5512_Dugald Rd_Cross Sections.dwg - Job: P-3594-25