

ELECTRICAL NOTES:

- THE ELECTRICAL CONTRACTOR SHALL OBTAIN ALL ELECTRICAL PERMITS AND IS RESPONSIBLE FOR ALL INSPECTION COSTS
- THE ELECTRICAL SYSTEM SHALL BE INSTALLED IN ACCORDANCE WITH THE LATEST APPROVED ELECTRICAL CODE, MBC, MEBC AND LOCAL AUTHORITY BY LAWS
- THE CONTRACTOR WILL SUPPLY PDF OF SHOP DRAWINGS FOR REVIEW BY THE CONSULTANT PRIOR TO INSTALLATION/PURCHASE.
- THE CONTRACTOR WILL PREPARE OPERATION AND MAINTENANCE MANUALS AND PRESENT THEM IN A 3-RING BINDER TO THE CONSULTANT & OWNER PRIOR TO THE END OF THE PROJECT
- ALL WIRING, CONDUIT AND TECK CABLE WILL BE INSTALLED ON THE SQUARE, PARALLEL WITH THE BUILDING LINES. WIRING SHALL NOT BE INSTALLED ON THE DIAGONAL.
- THE LOCAL INSPECTION AUTHORITY WILL HAVE JURISDICTION WITH RESPECT TO THE INSTALLATION.
- THE ELECTRICAL CONTRACTOR WILL INSTALL AND TERMINATE ALL WIRING INCLUDING WIRING AND TERMINATION OF ELECTRICAL AND CONTROL EQUIPMENT PROVIDED BY THE OWNER AND THE OTHER TRADES.
- JUNCTION BOXES WILL BE NEMA 4X RATED
- DISCONNECT AND FUSED SWITCHES SHALL BE HEAVY-DUTY INDUSTRIAL GRADE, WATER PROOF, NEMA 4X QUICK MAKE, QUICK BREAK WITH FUSES SIZED TO MATCH LOAD (AS PER CODE).

- ALL CONDUITS WILL BE SIZED ACCORDING TO THE ELECTRICAL CODE. WHERE THE MAXIMUM NUMBER OF WIRES IS BEING INSTALLED IN A CONDUIT, THE NEXT SIZE OF CONDUIT WILL BE USED
- WHERE CONDUITS AND/OR CABLES PENETRATE THROUGH CONCRETE BELOW GRADE, STEEL SLEEVES WILL BE PROVIDED. LINK-SEAL WILL BE USED AS A SLEEVE SEAL.
- ALL CONDUIT AND CABLES WILL BE PROPERLY SUPPORTED.
- ALL CABLES SHALL MEET OR EXCEED FT4 FLAME TESTING STANDARDS.
- INSTALL POWER CABLE FROM PANEL PNL-M712 CCT. 31 TO FUSED PUMP DISCONNECT. PUMP IS 120V. FUSED DISCONNECT WILL BE MOUNTED TO C CHANNEL AT PIT LOCATION
- COORDINATE WITH MECHANICAL EQUIPMENT SUPPLIER TO ENSURE SUFFICIENT CABLE LENGTH FOR LEVEL SWITCHES AND PUMP
- PROVIDE A 1 METER EXCESS CABLE COILED TO ALLOW FOR MOVEMENT BETWEEN GROUND AND STRUCTURES
- SUPPLY AND INSTALL NEMA 4X JUNCTION BOX FOR CONNECTION OF LEVEL ALARMS. PROVIDE AND INSTALL MULTICONDUCTOR CABLE FROM CONTROL PANEL LOCATED IN PUMP HOUSE TO NEMA 4X JUNCTION BOX.
- COORDINATE WITH CITY OF WINNIPEG, THE LANDING OF THE ALARMS AT THE CONTROL PANEL. ALL ALARMS AND STATUS SIGNALS SHOULD BE WIRED FAIL SAFE.
- THE CITY OF WINNIPEG WILL COMPLETE ALL REQUIRED PLC PROGRAMMING
- COORDINATE ALL INSPECTIONS WITH THE AHJ AND THE ENGINEER OF RECORD
- PROVIDE 2C, 10AWG TECK 90 CABLE FOR POWER RUN TO SUMP PUMP INSTALLATION AND 8C, 16AWG ACIC, 600V CABLE FOR THE INSTRUMENTATION. CABLE SHOULD BE INSTALLED IN A SEPERATE CONDUIT.

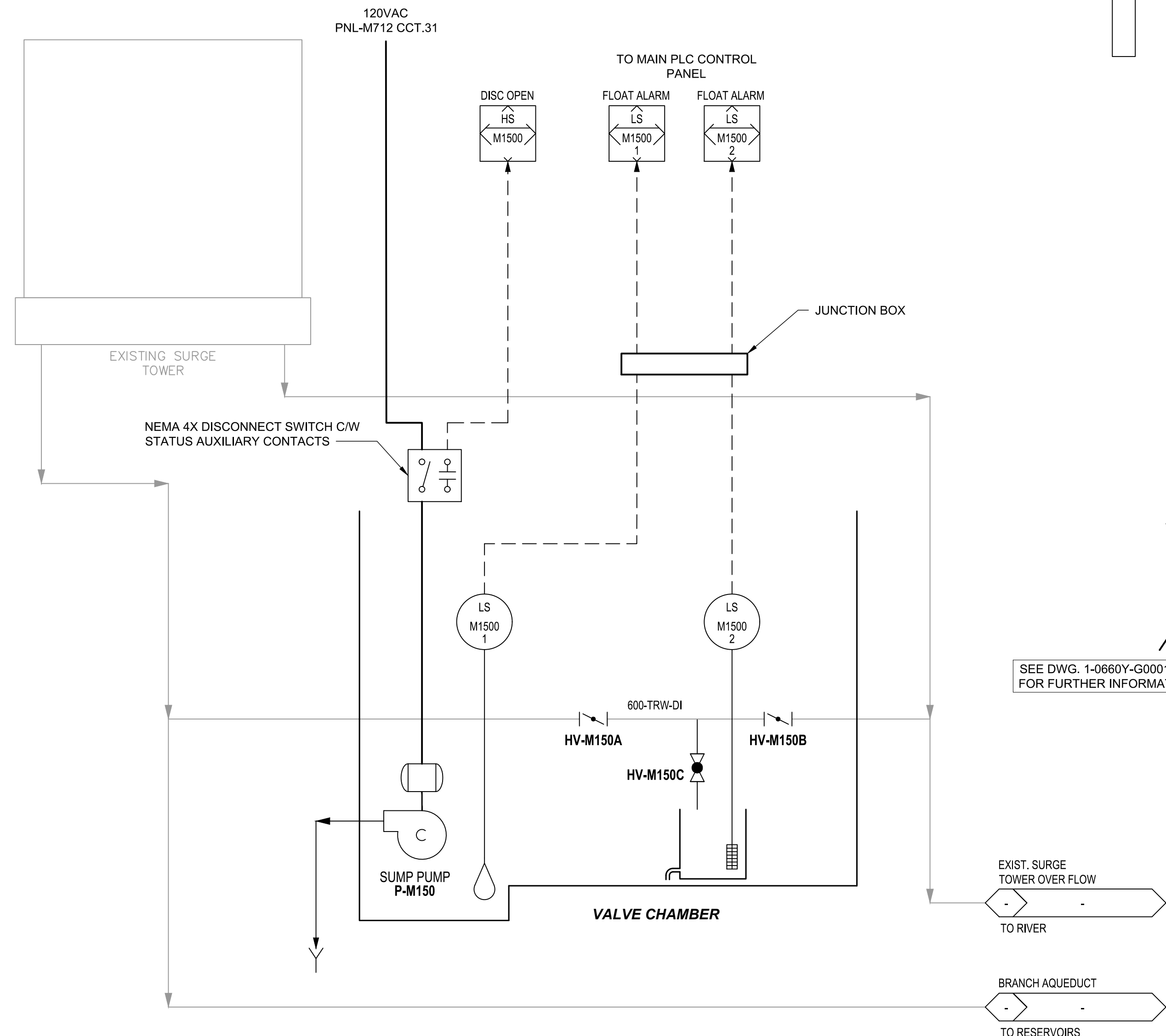
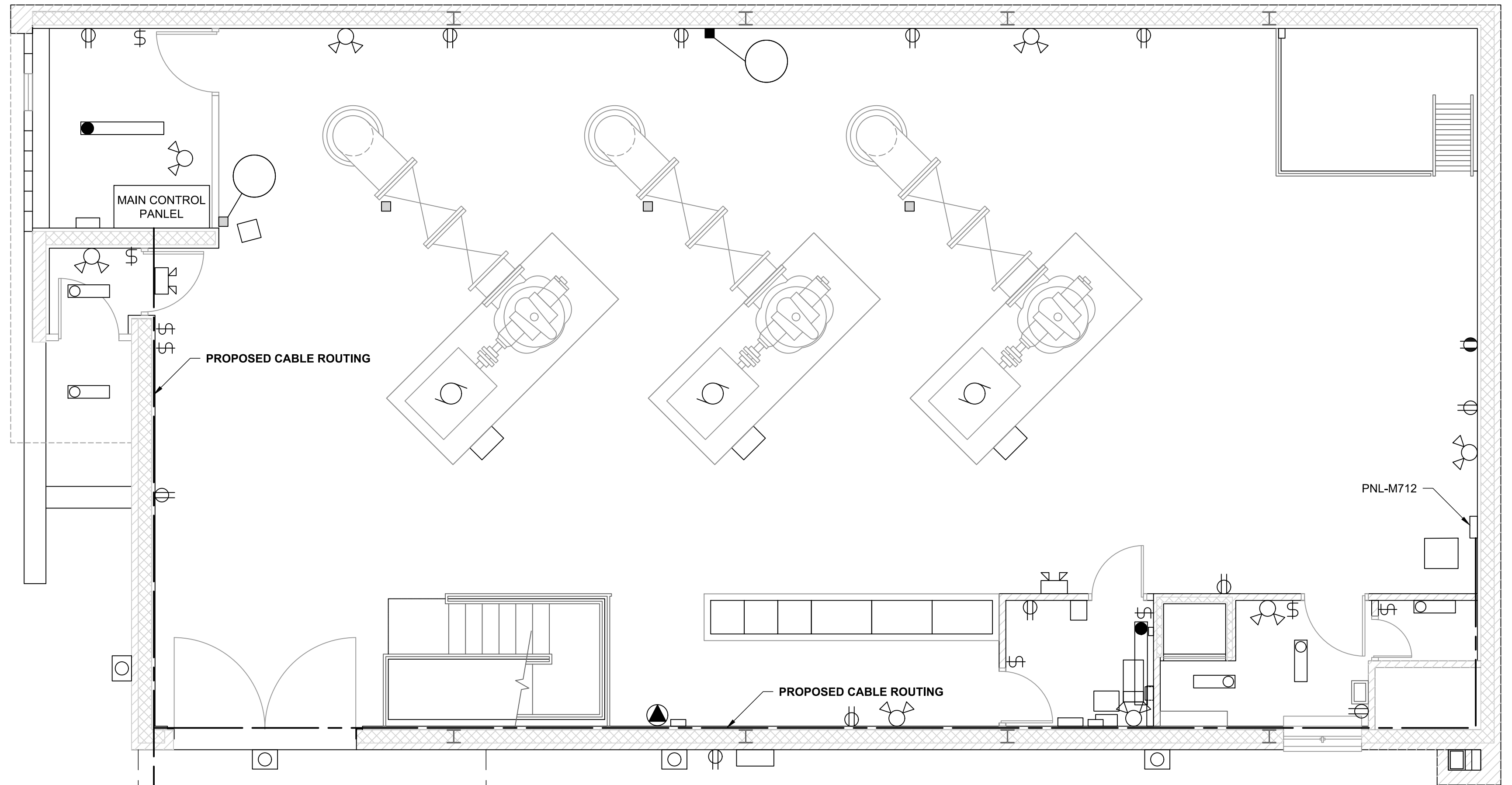

PROCESS MECHANICAL

PANEL ID:	PNL-M712	AMPS:	225	VOLTS:	120/240V	PHASE:	1Ø	WIRE:	3	SURF. MOUNT:	FLUSH MOUNT	TOP FED:	YES
DESCRIPTION:	NON-ESSENTIAL LIGHTING PANEL					LOCATION:	MAIN FLOOR						
MFG / MODEL:	SQUARE D					INTERRUPTING RATING:	10 KA						
MAIN BREAKER:	125A					INST. SETTINGS:	N/A						
CCT.	DESCRIPTION	NOTE	WIRE (AWG)	BKR AMPS	LOAD (VA)	L1	L2	LOAD (VA)	BKR AMPS	WIRE (AWG)	NOTE	DESCRIPTION	CCT.
1	GAS HEATER- BSMT EAST	1	-	15	-	-	-	15	12	2, 3		BASEMENT CEILING & STORAGE LIGHTS	2
3	SUMP PUMP RECEPTACLE	1, 3	12	15	-	-	-	15	12	2, 3		RECPD BASEMENT WEST	4
5	MAIN FLOOR CEILING LIGHTS	2	12	15	-	-	-	15	-	2		RECPD MAIN FLOOR EAST	6
7	LIGHTS IN WASHRM & SW RM	2, 3	12	15	-	-	-	15	12	2		RECPD MAIN FLOOR NORTH	8
9	MAIN LEVEL UNIT HEATER	-	-	15	-	-	-	20	12	2		RECPD WASHROOM GFCI	10
11	SPARE	1, 3	-	30	-	-	-	15	-	1		SPARE	12
13	HOT WATER	1, 3	-	15	-	-	-	30	-	-		AIR COMPRESSOR	14
15	SPARE	1	-	15	-	-	-	2P	-	1			16
17	SPARE	1	-	15	-	-	-	30	-	-			18
19	OUTSIDE SPLIT RECEPTACLE, TOP	2, 3	12	15	-	-	-	2P	-	1, 3		TOWER PANEL	20
21	OUTSIDE SPLIT RECEPTACLE, BOTTOM		12	2P	-	-	-	15	12	2, 3		RECPDTS BASEMENT/STORAGE	22
23	OUTSIDE LIGHTS	2, 3	12	15	-	-	-	15	12	2		MAIN FLOOR EMERG. LIGHTS ELB-M701	24
25	MAIN FLOOR EMERG. LIGHTS ELB-M702	2	12	15	-	-	-	15	12	2, 3		BASEMENT EMERG. LIGHTS ELB-M703	26
27	CONTROL ROOM LIGHT	2	12	15	-	-	-	15	12	2		CSTE THERMOSTAT	28
29	BASEMENT UNIT HEATER WEST	-	-	15	-	-	-	15	-	-		SPARE	30
31	NEW SUMP PUMP	2, 3	-	15	-	-	-	-	-	-		SPARE	32
33	SPARE	-	-	15	-	-	-	-	-	-		SPARE	34
35	SPARE	-	-	-	-	-	-	-	-	-		SPARE	36
37	SPARE	-	-	-	-	-	-	-	-	-		SPARE	38
39	SPARE	-	-	-	-	-	-	-	-	-		SPARE	40
41	SPARE	-	-	-	-	-	-	-	-	-		SPARE	42
TOTAL CONNECTED LOAD:			000.0 KVA	000.0 A (AVG)	000.0 A (MAX)	LINE 1: 000.0 KVA		000.0 A		NOTE LEGEND:			
						LINE 2: 000.0 KVA		000.0 A		AFCI ARC FAULT CIRCUIT INTERRUPTOR			
										GFCI GROUND FAULT CIRCUIT INTERRUPTOR			
NOTES:													
1. EXISTING LOAD.													
2. NEW LOAD.													
3. CLASS A GFCI BREAKER.													
4. FEEDS SPLIT RECEPTACLE													

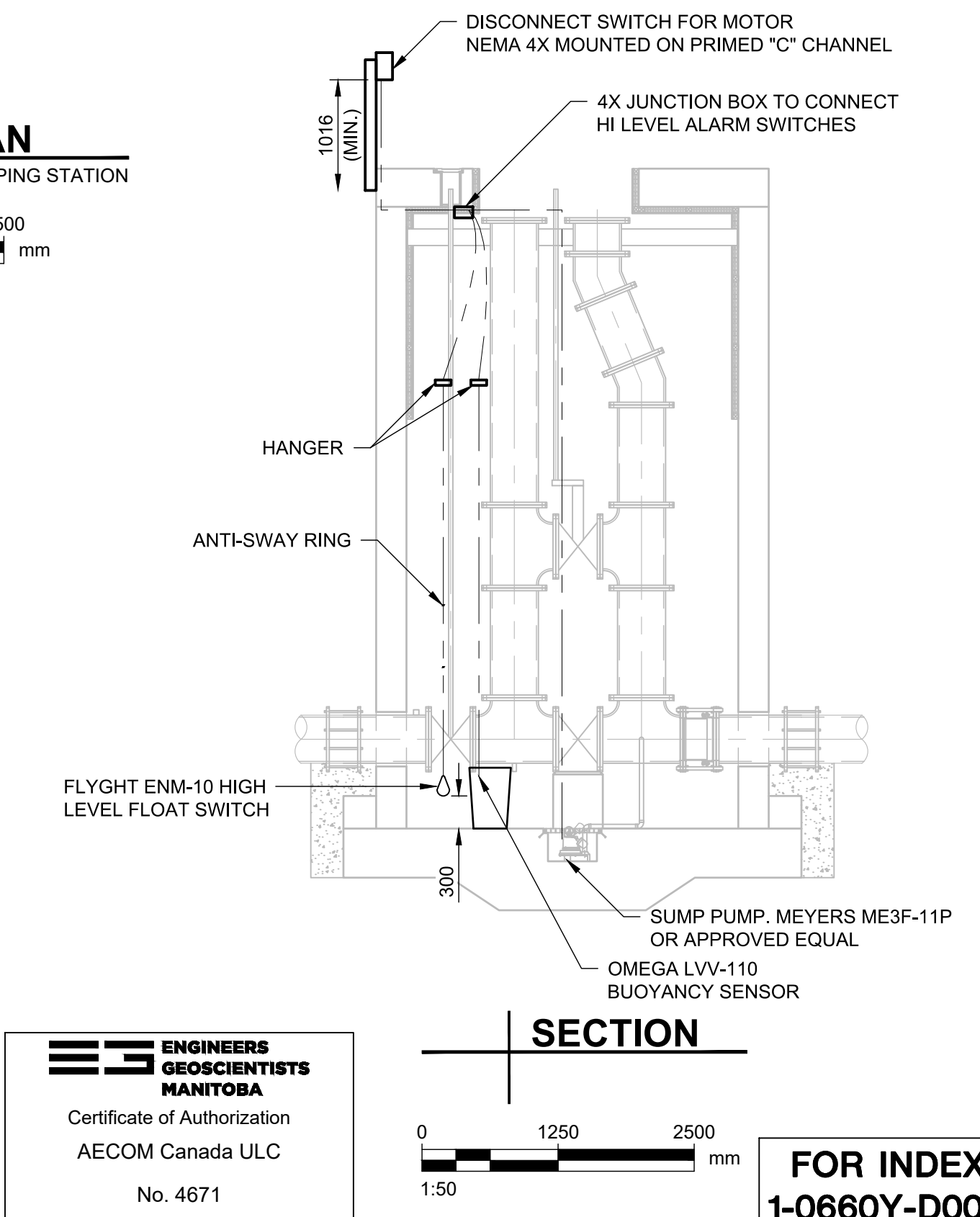

SECTION

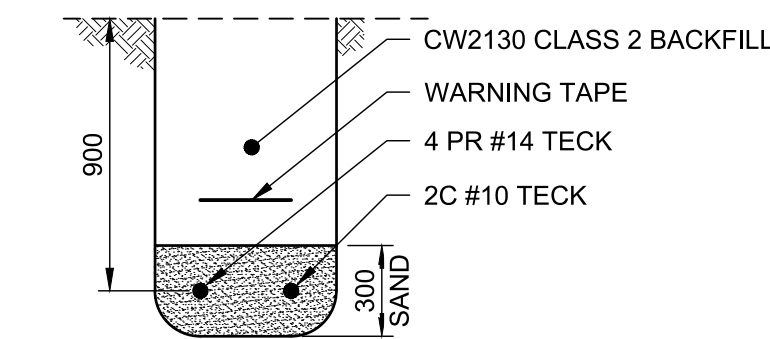

A SECTION

1-0660Y-G0001-001

METRIC

WHOLE NUMBERS INDICATE MILLIMETRES  
DECIMALIZED NUMBERS INDICATE METRES

LOCATION APPROVED  
UNDERGROUND STRUCTURES

SUPV. U/G STRUCTURES COMMITTEE DATE

NOTE:

LOCATION OF UNDERGROUND STRUCTURES AS SHOWN ARE BASED ON THE BEST INFORMATION AVAILABLE BUT NO GUARANTEE IS GIVEN THAT ALL EXISTING UTILITIES ARE SHOWN OR THAT THE GIVEN LOCATIONS ARE EXACT. CONFIRMATION OF EXISTENCE AND EXACT LOCATION OF ALL SERVICES MUST BE OBTAINED FROM THE INDIVIDUAL UTILITIES BEFORE PROCEEDING WITH CONSTRUCTION.

B.M. ELEV.

CONSTRUCTION COMPLETION DATE: YYYY MM DD

DESIGNED BY	ER	CHECKED BY	SB
DRAWN BY	ADL	APPROVED BY	KF
SCALE:	HORIZONTAL AS NOTED		
VERTICAL	N/A		
DATE	2025 07 22	DATE	2025 07 22
NO.	ISSUED FOR TENDER	DATE	25/07/22
BY	ADL	DATE	2025 07 22
REVISIONS		DATE	

AECOM

DESIGNED BY	ER	CHECKED BY	SB
DRAWN BY	ADL	APPROVED BY	KF
SCALE:	HORIZONTAL AS NOTED		
VERTICAL	N/A		
DATE	2025 07 22	DATE	2025 07 22
NO.	ISSUED FOR TENDER	DATE	25/07/22
BY	ADL	DATE	2025 07 22
REVISIONS		DATE	

PLOT DATE: 2025 07 22

ENGINEER'S SEAL

CONSULTANT DRAWING NUMBER

E-4001

Tender No: 639-2025

Winnipeg

THE CITY OF WINNIPEG  
WATER AND WASTE DEPARTMENT  
ENGINEERING SERVICES DIVISION

TACHE BOOSTER PUMPING STATION  
AQUEDUCT DRAIN CHAMBER  
ELECTRICAL DETAILS

SHEET 06 OF 07

CITY DRAWING NUMBER

1-0660Y-E0001-001

FILE PATH: C:\Users\leippla\AppData\Local\Temp\AcPublish\_32948\  
FILE NAME: 60668984-SHT-30-TBPS-E-4001.dwg