

NOTE: CHAINAGES SHOWN
ALONG S R OF LEILA AVENUE

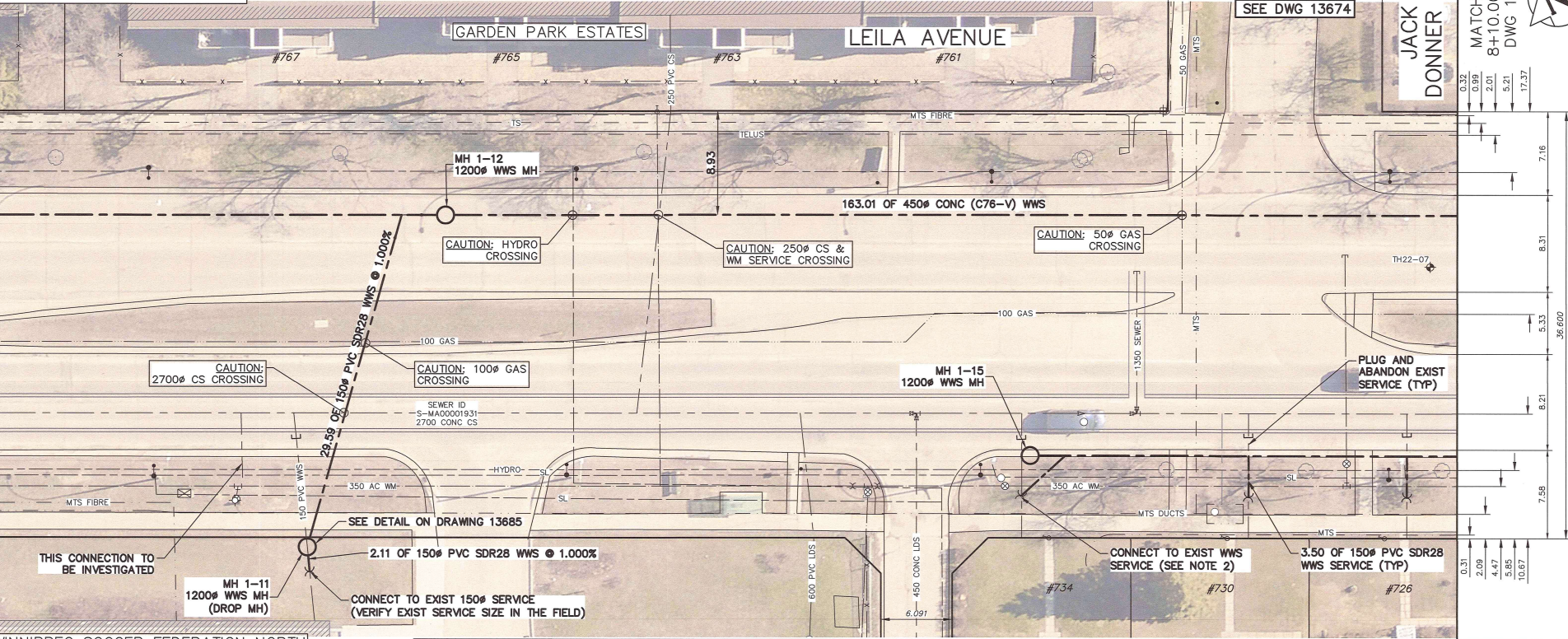

WINNIPEG SOCCER FEDERATION NORTH

FOR INDEX PAGE
SEE DWG 13643

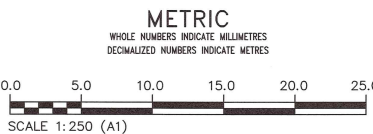

WARNING

IF POWER EQUIPMENT OR EXPLOSIVES
ARE TO BE USED FOR EXCAVATION ON
THIS PROJECT THE CONTRACTOR MUST:

- 1) NOTIFY THE GAS COMPANY OF THE
PROPOSED LOCATION OF EXCAVATION.
- 2) TAKE PRECAUTION TO AVOID DAMAGE
TO GAS COMPANY INSTALLATIONS.

SEE PROVINCIAL REGULATION 210/72 FOR DETAILS

LOCATION APPROVED UNDERGROUND STRUCTURES

SUPV. U/G STRUCTURES COMMITTEE DATE

NOTE:

LOCATION OF UNDERGROUND STRUCTURES AS
SHOWN ARE BASED ON THE BEST INFORMATION
AVAILABLE BUT NO GUARANTEE IS GIVEN THAT ALL
EXISTING UTILITIES ARE SHOWN OR THAT THE GIVEN
LOCATIONS ARE EXACT. CONFIRMATION OF
EXISTENCE AND EXACT LOCATION OF ALL
UTILITIES MUST BE OBTAINED FROM THE INDIVIDUAL
UTILITIES BEFORE PROCEEDING WITH CONSTRUCTION.

VERTICAL DATUM: CGVD28 (HT2.0 Geoid)

HORIZONTAL DATUM: NAD83 (June 1990), Zone 14

0 ISSUED FOR CONSTRUCTION 2026/03/10
NO. REVISIONS DATE BY

KGS
GROUP

DESIGNED BY MID
DRAWN BY GEL
SCALE: HORIZONTAL 1:250
VERTICAL 1:50
DATE

CHECKED BY TLE
APPROVED BY RBO
RELEASED FOR CONSTRUCTION
Duane Baker
DATE March 12th, 2026

ENGINEER'S SEAL



CONSULTANT DRAWING NUMBER
C1-09

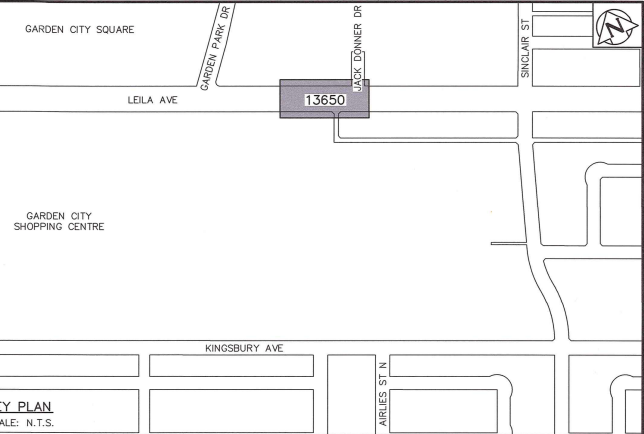

NOTES:

1. WHEN INSTALLING PROPOSED WASTEWATER SEWERS ON LEILA AVE TAKE CAUTION
WHEN CROSSING EXISTING RESIDENTIAL WATER SERVICES.
2. CONTRACTOR SHALL VERIFY ELEVATION OF EXISTING SEWER SERVICES AT
PROPOSED DOWNSTREAM CONNECTION LOCATIONS PRIOR TO INSTALLATION OF
COLLECTOR WWS TO ALLOW FOR CHANGES OF GRADE TO THE COLLECTOR WWS.

SEWER SERVICE INFORMATION					
ADDRESS	STATUS	SIZE (mm)	COORDINATES AT JUNCTION	COORDINATES AT PROPERTY	REMARKS
#726 LEILA AVE	ACTIVE	150 UNKNOWN	N=5534783.34 E=633533.17	UNKNOWN	NONE
#730 LEILA AVE	ACTIVE	150 UNKNOWN	N=5534789.07 E=633520.94	UNKNOWN	NONE
#730 LEILA AVE	ABAND	150 UNKNOWN	N=5534790.02 E=633518.90	UNKNOWN	NONE
#734 LEILA AVE	ACTIVE	150 UNKNOWN	N=5534797.29 E=633503.40	UNKNOWN	NONE
#763 LEILA AVE	ACTIVE	250 UNKNOWN	N=5534811.22 E=633473.68	N=5534833.47 E=633487.27	NONE
#770 LEILA AVE	ACTIVE	150 UNKNOWN	N=5534825.54 E=633443.09	UNKNOWN	NONE
#770 LEILA AVE	ACTIVE	150 UNKNOWN	N=5534823.63 E=633447.17	N=5534813.52 E=633443.62	NONE
#770 LEILA AVE	PROPOSED	150 PVC	N=5534835.13 E=633462.69	N=5534813.39 E=633443.69	NONE

SEWER JUNCTION INFORMATION FROM SEWER VIDEO INSPECTION SEWER ID S-MA00001931			
DISTANCE FROM MH ID S-MH00001643			
DISTANCE	DIAMETER	CLOCK	
247.9	150	1	
252.4	150	2	
282.6	250	11	
295.6	450	3	
304.1	300	2	
314.5	150	1	
SEWER JUNCTION INFORMATION FROM SEWER VIDEO INSPECTION SEWER ID S-MA70037684			
DISTANCE FROM MH ID S-MH00001749			
DISTANCE	DIAMETER	CLOCK	
6.0	1200	9	
11.4	150	1	
13.7	150	1	
27.2	150	1	



THE CITY OF WINNIPEG
WATER AND WASTE DEPARTMENT
ENGINEERING SERVICES DIVISION

ARMSTRONG SEWER RELIEF WORKS
CONTRACT 1
LEILA AVENUE
90.0 E OF GARDEN PARK DRIVE TO
6.4 E OF JACK DONNER DRIVE

SHEET 9 OF 46
CITY DRAWING NUMBER
13650