

NOTE: CHAINAGES SHOWN  
ALONG S R OF LEILA AVENUE

HEDGES ON LEILA  
APARTMENT BUILDING

SEE DWG 13675

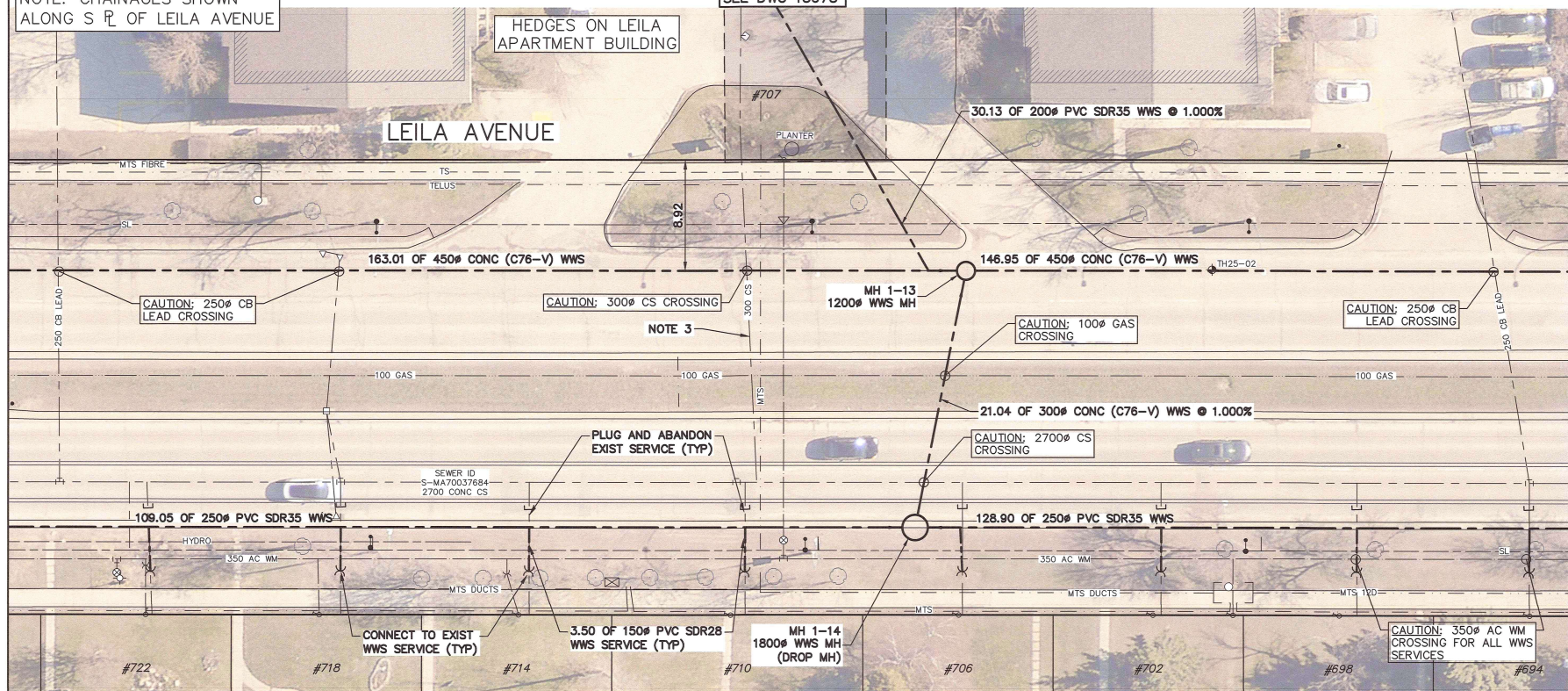

MATCHLINE  
9+35.00 SEE  
DWG 13652



MATCHLINE 8+10.00  
SEE DWG 13650

FOR INDEX PAGE  
SEE DWG 13643

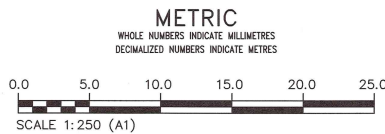

#### WARNING

IF POWER EQUIPMENT OR EXPLOSIVES  
ARE TO BE USED FOR EXCAVATION ON  
THIS PROJECT THE CONTRACTOR MUST:

- 1) NOTIFY THE GAS COMPANY OF THE  
PROPOSED LOCATION OF EXCAVATION.
- 2) TAKE PRECAUTION TO AVOID DAMAGE  
TO GAS COMPANY INSTALLATIONS.

SEE PROVINCIAL REGULATION 210/72 FOR DETAILS

#### LOCATION APPROVED UNDERGROUND STRUCTURES

SUPV. U/G STRUCTURES COMMITTEE DATE

NOTE:

LOCATION OF UNDERGROUND STRUCTURES AS  
SHOWN ARE BASED ON THE BEST INFORMATION  
AVAILABLE BUT NO GUARANTEE IS GIVEN THAT ALL  
EXISTING UTILITIES ARE SHOWN OR THAT THE GIVEN  
LOCATIONS ARE EXACT. CONFIRMATION OF  
EXISTENCE AND EXACT LOCATION OF ALL  
SERVICES MUST BE OBTAINED FROM THE INDIVIDUAL  
UTILITIES BEFORE PROCEEDING WITH CONSTRUCTION.

VERTICAL DATUM: CGVD28 (HT2.0 Geoid)  
HORIZONTAL DATUM: NAD83 (June 1990), Zone 14

NO.	ISSUED FOR CONSTRUCTION	DATE (YY/MM/DD)	BY
0	ISSUED FOR CONSTRUCTION	2026/03/10	HTD
NO.	REVISIONS	DATE (YY/MM/DD)	BY

**KGS**  
GROUP

DESIGNED BY	MID	CHECKED BY	TLE
DRAWN BY	GEL	APPROVED BY	R80
SCALE:		RELEASED FOR CONSTRUCTION	
HORIZONTAL	1:250	Duane Baker	
VERTICAL	1:50		
DATE		DATE	March 12th, 2026

PLOT DATE:

ENGINEER'S SEAL

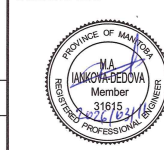

CONSULTANT DRAWING NUMBER  
C1-10

BID OPP: 839-2025  
CONTRACT NUMBER: 1

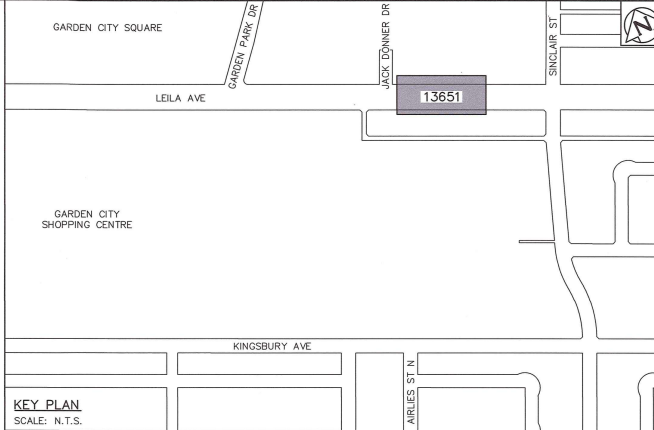

#### NOTES:

1. WHEN INSTALLING PROPOSED WASTEWATER SEWERS ON LEILA AVE TAKE CAUTION  
WHEN CROSSING EXISTING RESIDENTIAL WATER SERVICES.
2. CONTRACTOR SHALL VERIFY ELEVATION OF EXISTING SEWER SERVICES AT  
PROPOSED DOWNSTREAM CONNECTION LOCATIONS PRIOR TO INSTALLATION OF  
COLLECTOR WWS TO ALLOW FOR CHANGES OF GRADE TO THE COLLECTOR WWS.
3. EXISTING 300# CS SERVICE TO BE REPURPOSED FOR 300# LDS SERVICE.

SEWER SERVICE INFORMATION					
ADDRESS	STATUS	SIZE (mm) MATERIAL	COORDINATES AT JUNCTION	COORDINATES AT PROPERTY	REMARKS
#694 LEILA AVE	ACTIVE	150 UNKNOWN	N=5534729.84 E=633647.36	UNKNOWN	NONE
#698 LEILA AVE	ACTIVE	150 UNKNOWN	N=5534735.69 E=633634.86	UNKNOWN	NONE
#702 LEILA AVE	ACTIVE	150 UNKNOWN	N=5534742.35 E=633620.64	UNKNOWN	NONE
#706 LEILA AVE	ACTIVE	150 UNKNOWN	N=5534749.10 E=633606.25	UNKNOWN	NONE
#707 LEILA AVE	ACTIVE	300 UNKNOWN	N=5534756.06 E=633591.40	N=5534780.11 E=633601.19	NONE
#710 LEILA AVE	UNKNOWN	150 UNKNOWN	N=5534756.48 E=633590.49	UNKNOWN	NONE
#714 LEILA AVE	ACTIVE	150 UNKNOWN	N=5534763.82 E=633574.82	UNKNOWN	NONE
#718 LEILA AVE	ACTIVE	150 UNKNOWN	N=5534770.23 E=633561.15	UNKNOWN	NONE
#722 LEILA AVE	ACTIVE	150 UNKNOWN	N=5534776.80 E=633547.11	UNKNOWN	NONE
#722 LEILA AVE	ACTIVE	150 UNKNOWN	N=5534777.40 E=633545.85	UNKNOWN	NONE

SEWER JUNCTION INFORMATION FROM SEWER VIDEO INSPECTION SEWER ID S-MA70037684		
DISTANCE FROM MH ID S-MH00001749		
DISTANCE	DIAMETER	CLOCK
35.6	150	11
41.2	150	1
42.6	150	1
58.1	150	1
58.1	375	11
73.2	150	2
90.5	150	1
91.5	300	10
107.9	150	2
123.8	150	2
139.5	150	2
153.3	150	1
153.3	250	11



**THE CITY OF WINNIPEG**  
WATER AND WASTE DEPARTMENT  
ENGINEERING SERVICES DIVISION

ARMSTRONG SEWER RELIEF WORKS  
CONTRACT 1  
LEILA AVENUE  
6.4 E OF JACK DONNER DRIVE TO  
84.3 W OF SINCLAIR STREET

SHEET 10 OF 46  
CITY DRAWING NUMBER

13651

FILE PATH: \\kgs-file-v-data\Projects\2025\25-0107-002\DWG\Mun\C1 Sheets\  
FILE NAME: 25-0107-002\_C1\_Keyplan Plan&Profiles.dwg