

NOTE: CHAINAGES SHOWN
ALONG S R OF LEILA AVENUE

APARTMENT BUILDING (#607 LEILA AVE)
EXIST 150# WWS SERVICE TO MATHIAS AVE

CONSULATE NORTH APARTMENTS
(#595 LEILA AVE)

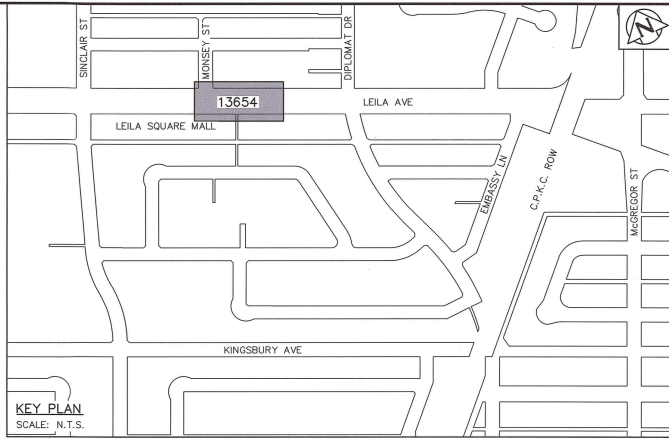
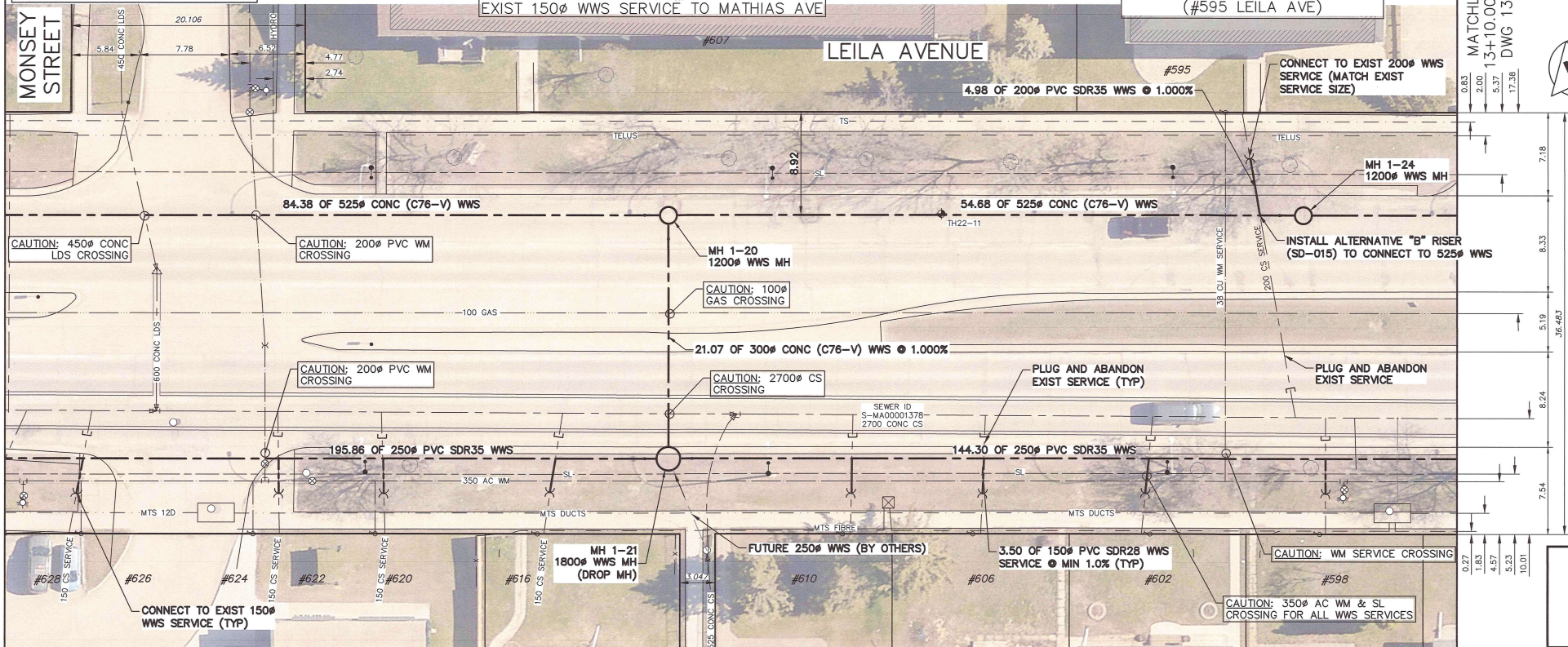

- NOTES:
1. WHEN INSTALLING PROPOSED WASTEWATER SEWERS ON LEILA AVE TAKE CAUTION WHEN CROSSING EXISTING RESIDENTIAL WATER SERVICES.
 2. CONTRACTOR SHALL VERIFY ELEVATION OF EXISTING SEWER SERVICES AT PROPOSED DOWNSTREAM CONNECTION LOCATIONS PRIOR TO INSTALLATION OF COLLECTOR WWS TO ALLOW FOR CHANGES OF GRADE TO THE COLLECTOR WWS.

SEWER SERVICE INFORMATION					
ADDRESS	STATUS	SIZE (mm) MATERIAL	COORDINATES AT JUNCTION	COORDINATES AT PROPERTY	REMARKS
#598 LEILA AVE	UNKNOWN	150	N=5534572.74 E=633981.66	UNKNOWN	NONE
#598 LEILA AVE	ACTIVE	150	N=5534573.82 E=633979.40	N=5534564.69 E=633975.14	NONE
#595 LEILA AVE	ACTIVE	200	N=5534574.93 E=633977.05	N=5534600.79 E=633984.09	NONE
#602 LEILA AVE	ACTIVE	150	N=5534580.21 E=633985.94	N=5534571.42 E=633980.76	NONE
#606 LEILA AVE	ACTIVE	150	N=5534586.39 E=633952.93	N=5534577.28 E=633948.23	NONE
#610 LEILA AVE	ACTIVE	150	N=5534591.28 E=633942.63	N=5534582.11 E=633938.08	NONE
#616 LEILA AVE	ACTIVE	150	N=5534602.00 E=633920.05	N=5534593.23 E=633914.18	NONE
#620/622 LEILA AVE	ACTIVE	150	N=5534608.69 E=633905.96	N=5534599.02 E=633901.79	NONE
#624/626 LEILA AVE	ACTIVE	150	N=5534612.50 E=633897.92	N=5534602.88 E=633893.55	NONE
#628 LEILA AVE	ACTIVE	150	N=5534619.35 E=633883.44	N=5534610.55 E=633877.17	NONE
#630 LEILA AVE	ACTIVE	150	N=5534621.72 E=633878.34	UNKNOWN	NONE
#640 MATHIAS AVE	ACTIVE	250	N=5534622.42 E=633876.97	UNKNOWN	NONE

SEWER JUNCTION INFORMATION FROM SEWER VIDEO INSPECTION SEWER ID S-MA00002050			
DISTANCE FROM MH ID S-MH00001804			
DISTANCE	DIAMETER	CLOCK	
153.4	250	11	
155.0	150	1	
160.8	150	2	
165.4	450	9	
SEWER JUNCTION INFORMATION FROM SEWER VIDEO INSPECTION SEWER ID S-MA00001378			
DISTANCE FROM MH ID S-MH00001787			
DISTANCE	DIAMETER	CLOCK	
6.8	150	2	
15.7	150	2	
31.3	150	2	
46.3	525	3	
56.3	150	2	
67.7	150	2	
82.1	150	2	
94.4	200	10	
97.3	150	2	
99.5	150	2	
103.2	150	2	



FOR INDEX PAGE
SEE DWG 13643

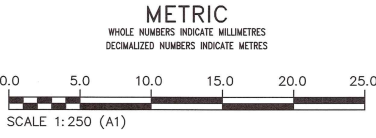

WARNING

IF POWER EQUIPMENT OR EXPLOSIVES ARE TO BE USED FOR EXCAVATION ON THIS PROJECT THE CONTRACTOR MUST:

- 1) NOTIFY THE GAS COMPANY OF THE PROPOSED LOCATION OF EXCAVATION.
- 2) TAKE PRECAUTION TO AVOID DAMAGE TO GAS COMPANY INSTALLATIONS.

SEE PROVINCIAL REGULATION 210/72 FOR DETAILS

**LOCATION APPROVED
UNDERGROUND STRUCTURES**

SUPV. U/G STRUCTURES COMMITTEE DATE

NOTE:

LOCATION OF UNDERGROUND STRUCTURES AS SHOWN ARE BASED ON THE BEST INFORMATION AVAILABLE BUT NO GUARANTEE IS GIVEN THAT ALL EXISTING UTILITIES ARE SHOWN OR THAT THE GIVEN LOCATIONS ARE EXACT. CONFIRMATION OF EXISTENCE AND EXACT LOCATION OF ALL SERVICES MUST BE OBTAINED FROM THE INDIVIDUAL UTILITIES BEFORE PROCEEDING WITH CONSTRUCTION.

VERTICAL DATUM: CGVD28 (HT2.0 Geoid)			
HORIZONTAL DATUM: NAD83 (June 1990), Zone 14			
NO.	ISSUED FOR CONSTRUCTION	DATE (YY/MM/DD)	BY
0	ISSUED FOR CONSTRUCTION	2026/03/10	MD
REVISIONS			
NO.	REVISIONS	DATE	BY

KGS GROUP

DESIGNED BY: MID
DRAWN BY: GEL
SCALE: HORIZONTAL 1:250, VERTICAL 1:50
CHECKED BY: TLE
APPROVED BY: RBO
RELEASED FOR CONSTRUCTION: Duane Baker
DATE: March 12th, 2026



THE CITY OF WINNIPEG
WATER AND WASTE DEPARTMENT
ENGINEERING SERVICES DIVISION

ARMSTRONG SEWER RELIEF WORKS
CONTRACT 1
LEILA AVENUE
5.7 W OF MONSEY STREET TO
81.5 W OF DIPLOMAT DRIVE

SHEET 13 OF 46
CITY DRAWING NUMBER
13654