

NOTES:

1. WHEN INSTALLING PROPOSED WASTEWATER SEWERS ON LEILA AVE TAKE CAUTION WHEN CROSSING EXISTING RESIDENTIAL WATER SERVICES.
2. CONTRACTOR SHALL VERIFY ELEVATION OF EXISTING SEWER SERVICES AT PROPOSED DOWNSTREAM CONNECTION LOCATIONS PRIOR TO INSTALLATION OF COLLECTOR WWS TO ALLOW FOR CHANGES OF GRADE TO THE COLLECTOR WWS.
3. EXISTING CS SERVICE TO BE REPURPOSED FOR LDS SERVICE.
4. FOR CONCRETE COLLAR DETAIL OF PVC/CONCRETE PIPE TRANSITION SEE DWG. 13685.
5. CASING PIPE SPECIFICATION:
 - OUTSIDE DIAMETER: 914mm
 - WALL THICKNESS: 13.5mm
 - PIPE MATERIAL: STEEL
 - ASTM A252 GR2
 - PROTECTION: N/A
 - JOINT: WELDED
 - INSTALLATION: AUGER BORING
 - CARRIER PIPE TO BE SUPPORTED BY MANUFACTURED CASING SPACERS. CASING ENDS TO BE SEALED WITH MANUFACTURED NEOPRENE RUBBER END SEALS.

SEWER SERVICE INFORMATION					
ADDRESS	STATUS	SIZE (mm)	COORDINATES AT JUNCTION	COORDINATES AT PROPERTY	REMARKS
-	ACTIVE	150	N=5534423.46 E=634301.60	UNKNOWN	MTS MH DRAIN?
#52 EMBASSY LN	ACTIVE	150	N=5534439.16 E=634267.88	N=5534430.77 E=634260.97	NONE
#520 LEILA AVE	ACTIVE	200	N=5534447.83 E=634249.20	N=5534439.72 E=634241.87	NONE
#524 LEILA AVE	ACTIVE	200	N=5534455.08 E=634233.60	N=5534447.08 E=634226.17	NONE
#528 LEILA AVE	ACTIVE	200	N=5534461.94 E=634218.81	N=5534453.52 E=634212.42	NONE
#549/553 LEILA AVE	ACTIVE	150 CONC	N=5534463.38 E=634215.73	N=5534457.43 E=634226.14	NONE

SEWER JUNCTION INFORMATION FROM SEWER VIDEO INSPECTION SEWER ID S-MA00001584			
DISTANCE FROM MH ID S-MH00001331			
DISTANCE	DIAMETER	CLOCK	
152.2	150	11	
155.6	200	2	
171.9	200	2	
189.1	200	2	
209.7	150	2	
228.1	400	9	
232.0	400	3	
SEWER JUNCTION INFORMATION FROM SEWER VIDEO INSPECTION SEWER ID S-MA00001634			
DISTANCE FROM MH ID S-MH00001366			
DISTANCE	DIAMETER	CLOCK	
11.7	150	1	



THE CITY OF WINNIPEG
WATER AND WASTE DEPARTMENT
ENGINEERING SERVICES DIVISION

ARMSTRONG SEWER RELIEF WORKS
CONTRACT 1
LEILA AVENUE
43.1 W OF AMBASSADOR ROW TO
53.6 E OF AMBASSADOR ROW

SHEET 16 OF 46
CITY DRAWING NUMBER
13657

BID OPP: 839-2025
CONTRACT NUMBER: 1

FILE PATH: \\kgs-file\y-data\Projects\25-0107-002\Draw\Man\C1 Sheets\
FILE NAME: 25-0107-002_C1_Keyplan_Plan&Profiles.dwg

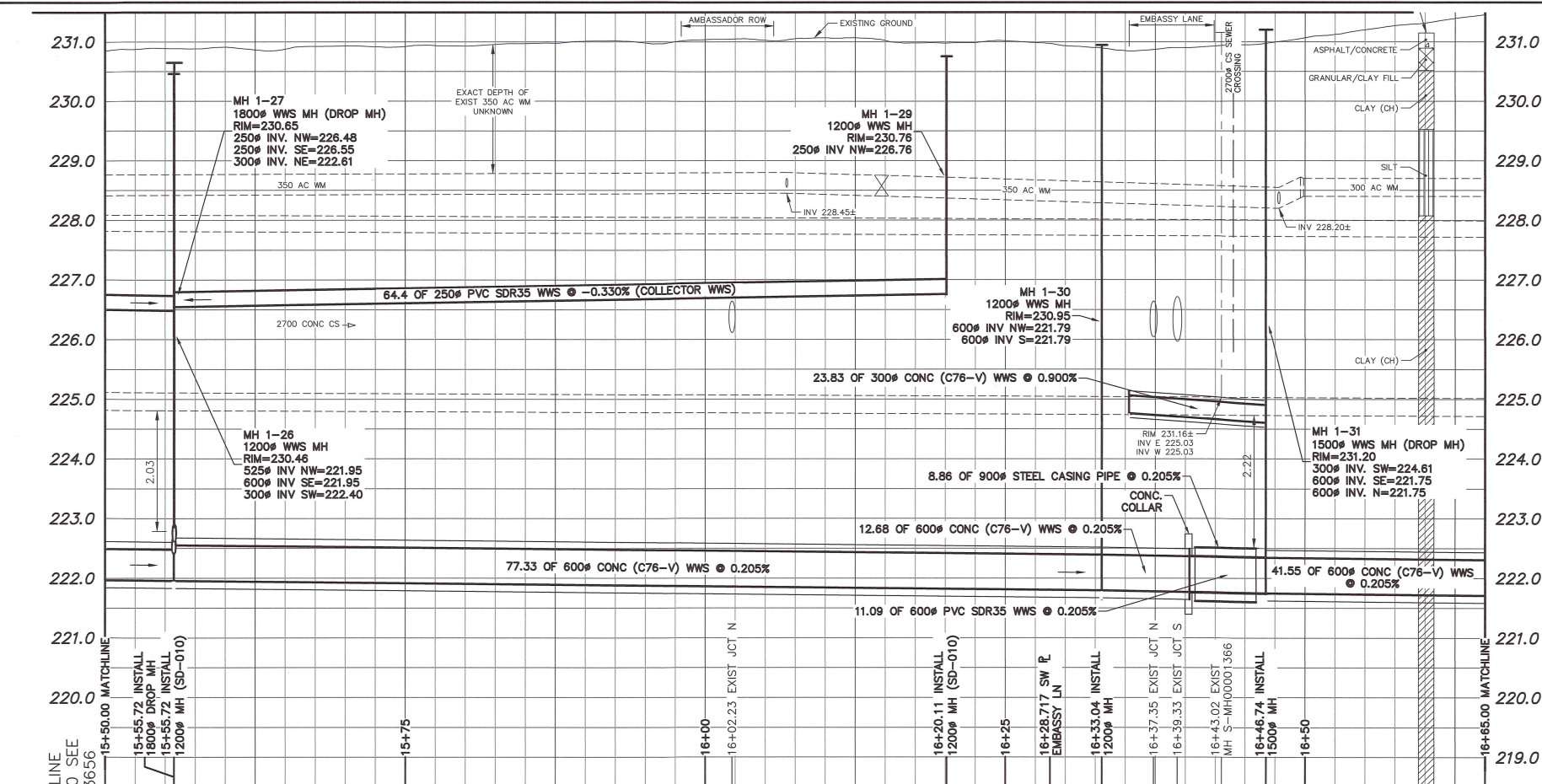

NOTE: CHAINAGES SHOWN
ALONG S R OF LEILA AVENUE

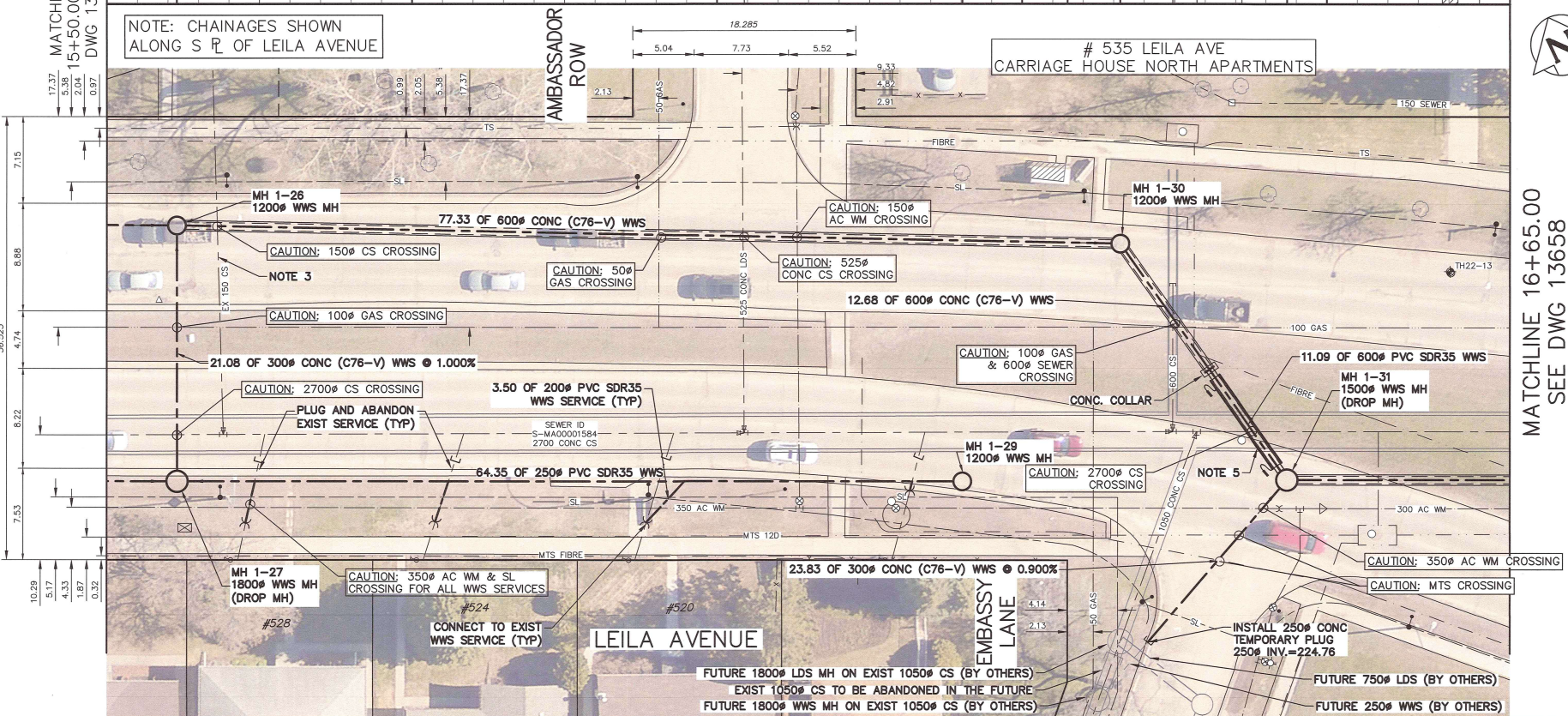

FOR INDEX PAGE
SEE DWG 13643

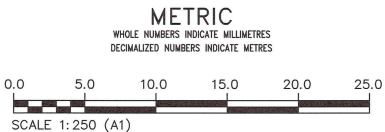

WARNING
IF POWER EQUIPMENT OR EXPLOSIVES
ARE TO BE USED FOR EXCAVATION ON
THIS PROJECT THE CONTRACTOR MUST:
1) NOTIFY THE GAS COMPANY OF THE
PROPOSED LOCATION OF EXCAVATION.
2) TAKE PRECAUTION TO AVOID DAMAGE
TO GAS COMPANY INSTALLATIONS.
SEE PROVINCIAL REGULATION 210/72 FOR DETAILS

**LOCATION APPROVED
UNDERGROUND STRUCTURES**
SUPV. U/G STRUCTURES COMMITTEE DATE
NOTE:
LOCATION OF UNDERGROUND STRUCTURES AS
SHOWN ARE BASED ON THE BEST INFORMATION
AVAILABLE BUT NO GUARANTEE IS GIVEN THAT ALL
EXISTING UTILITIES ARE SHOWN OR THAT THE GIVEN
LOCATIONS ARE EXACT. CONFIRMATION OF
EXISTENCE AND EXACT LOCATION OF ALL
SERVICES MUST BE OBTAINED FROM THE INDIVIDUAL
UTILITIES BEFORE PROCEEDING WITH CONSTRUCTION.

VERTICAL DATUM: CGVD28 (HT2.0 Geoid)	
HORIZONTAL DATUM: NAD83 (June 1990), Zone 14	
DESIGNED BY	MID
DRAWN BY	GEL
SCALE: HORIZONTAL	1:250
VERTICAL	1:50
DATE	March 12th, 2026
ISSUED FOR CONSTRUCTION	2026/03/10
NO.	REVISIONS

KGS GROUP	
DESIGNED BY	MID
DRAWN BY	GEL
SCALE: HORIZONTAL	1:250
VERTICAL	1:50
DATE	March 12th, 2026
ISSUED FOR CONSTRUCTION	2026/03/10
NO.	REVISIONS

ENGINEER'S SEAL	
DESIGNED BY	MID
DRAWN BY	GEL
SCALE: HORIZONTAL	1:250
VERTICAL	1:50
DATE	March 12th, 2026
ISSUED FOR CONSTRUCTION	2026/03/10
NO.	REVISIONS

CONSULTANT DRAWING NUMBER	
DESIGNED BY	MID
DRAWN BY	GEL
SCALE: HORIZONTAL	1:250
VERTICAL	1:50
DATE	March 12th, 2026
ISSUED FOR CONSTRUCTION	2026/03/10
NO.	REVISIONS