

CONSTRUCTION NOTES:

- ALL WORK AND MATERIALS TO BE IN ACCORDANCE WITH LATEST REVISION OF THE CITY OF WINNIPEG STANDARD CONSTRUCTION SPECIFICATIONS.
- LEGAL PLAN AND UNDERGROUND INFORMATION FROM CITY OF WINNIPEG LBS. CONTRACTOR TO VERIFY ALL UNDERGROUNDS IN THE FIELD.
- CONTRACTOR TO TAKE PRECAUTIONARY STEPS TO AVOID DAMAGE FROM CONSTRUCTION ACTIVITIES TO TREES WITHIN THE LIMITS OF CONSTRUCTION AS OUTLINED IN THE SPECIFICATIONS.
- LOCATION OF EXISTING SERVICES TO BE CONFIRMED IN THE FIELD BY THE CONTRACTOR.
- ALL DIMENSIONS ARE TO BACK OF CURB.
- INSTALL CB LEADS AT MIN. 1.0% SLOPE OR AS DIRECTED BY THE CONTRACT ADMINISTRATOR.
- CONTRACTOR TO CONFIRM EXISTING LEAD INVERT ELEVATIONS PRIOR TO INSTALLATION.
- LIMITS OF CURB AND SIDEWALK RECONSTRUCTION TO BE FINALIZED IN THE FIELD BY THE CONTRACT ADMINISTRATOR.
- ADJUST ALL WATER VALVES, MANHOLES, CATCH BASINS, CATCH PITS AND WATER SHUT OFF VALVES TO GRADE.
- ALL PRIVATE WALKWAYS TO BE ADJUSTED TO NEW SIDEWALK OR TOP OF CURB ELEVATION, AS REQUIRED.
- FOR ROAD RECONSTRUCTIONS, INSTALL 6 m of 150 mm SUBDRAIN TO CATCH BASINS IN BOTH DIRECTIONS PARALLEL TO ROADWAY AS PER SD-245 AND CAP ENDS.
- STREET LIGHT STANDARDS, HYDRO POLES AND ANCHORS THAT REQUIRE TEMPORARY SUPPORT, REMOVAL OR REPLACEMENT, ARE TO BE DONE AT THE EXPENSE OF THE CONTRACTOR, AS NECESSARY.
- FOR ROAD RECONSTRUCTIONS, ALL WATER MAIN SERVICES NEED TO BE INSULATED UNLESS NOTED OTHERWISE. ADDITIONALLY, ALL CATCH BASINS, MANHOLES AND LEAD PIPES LOCATED WITHIN 2.0 m OF A RESIDENTIAL SERVICE MUST BE INSULATED TO PROTECT THE SERVICE FROM POTENTIAL FUTURE FREEZING.
- CONSTRUCT MODIFIED BARRIER CURB (SD-203B) AT ALL INTERSECTION RADII AND ALLEY RADII.
- CONTRACTOR TO OVERLAY DRIVEWAYS TO ENSURE POSITIVE DRAINAGE TO NEW STREET GRADES. FINAL LIMITS TO BE DETERMINED IN THE FIELD BY CONTRACT ADMINISTRATOR.
- REFER TO TENDER FOR DETAILS REGARDING TRAFFIC MANAGEMENT.

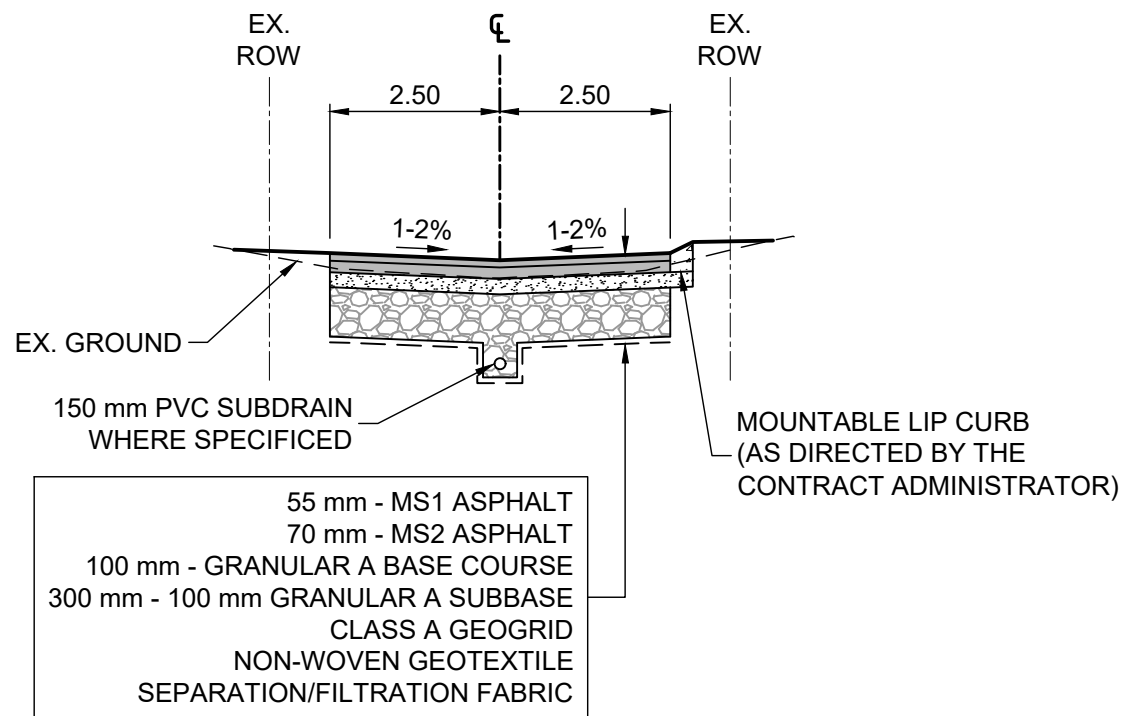

TYPICAL SECTION
SCALE: H:100, V:1:50

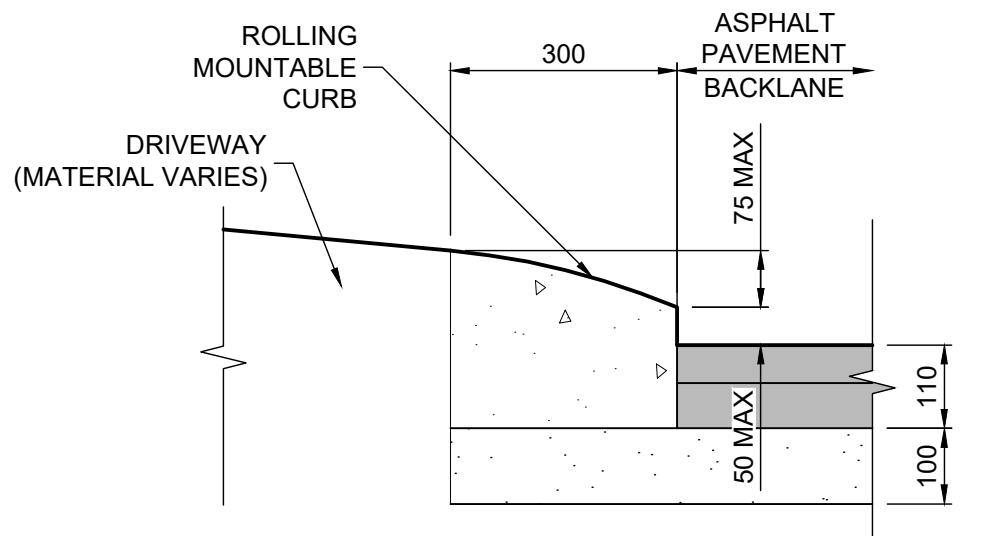

TYPICAL DETAIL - MOUNTABLE LIP CURB
SCALE: 1:10

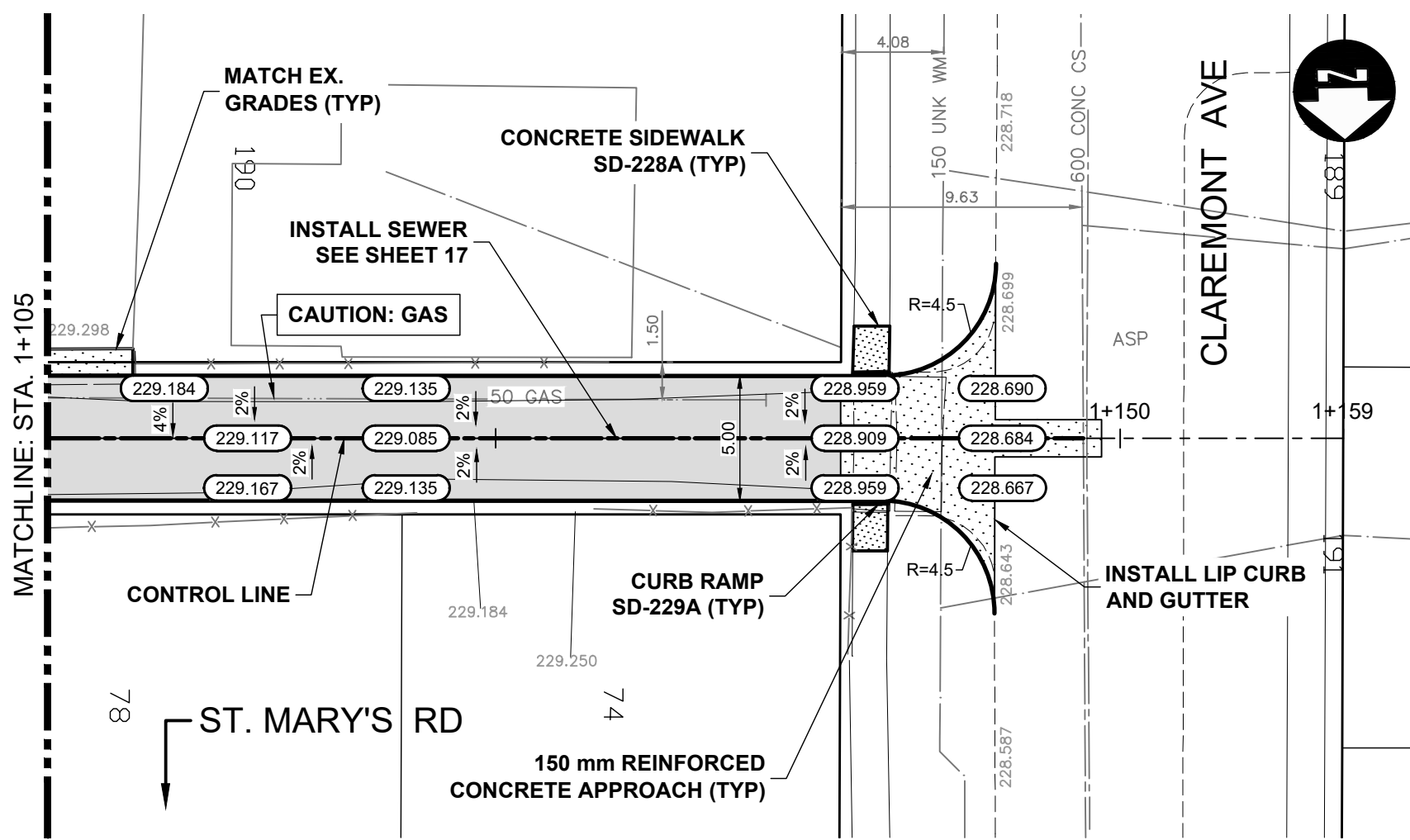
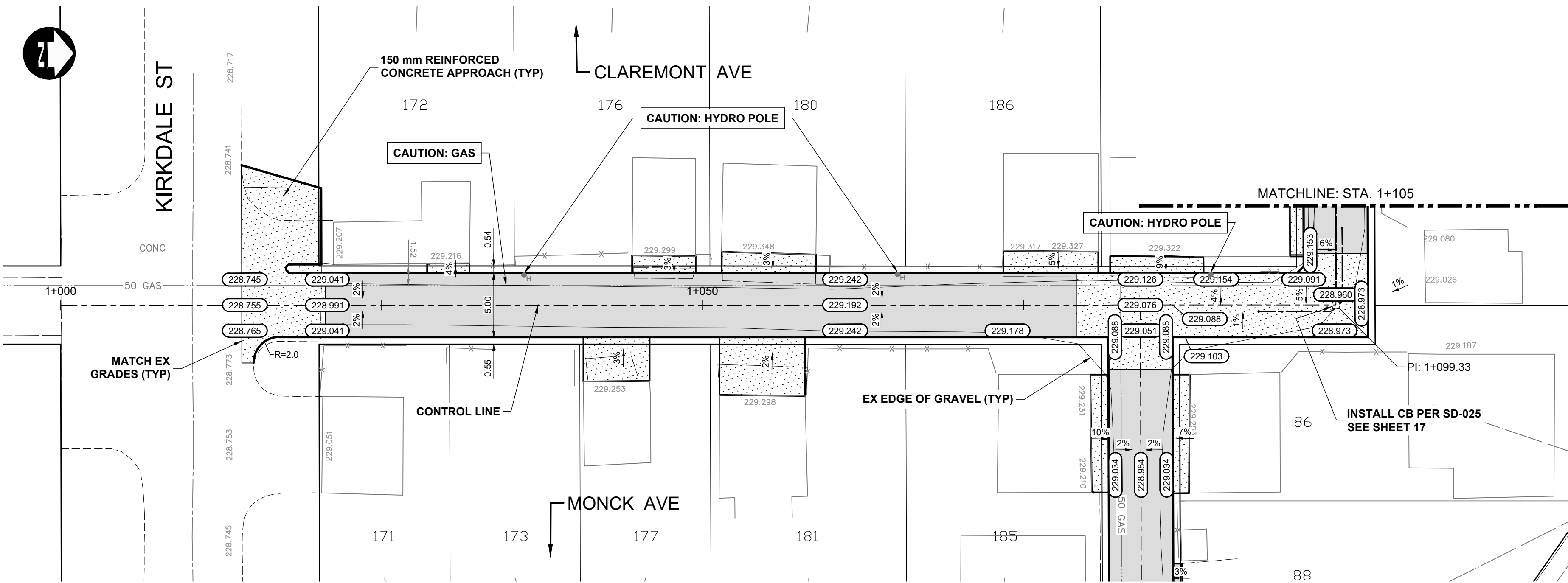
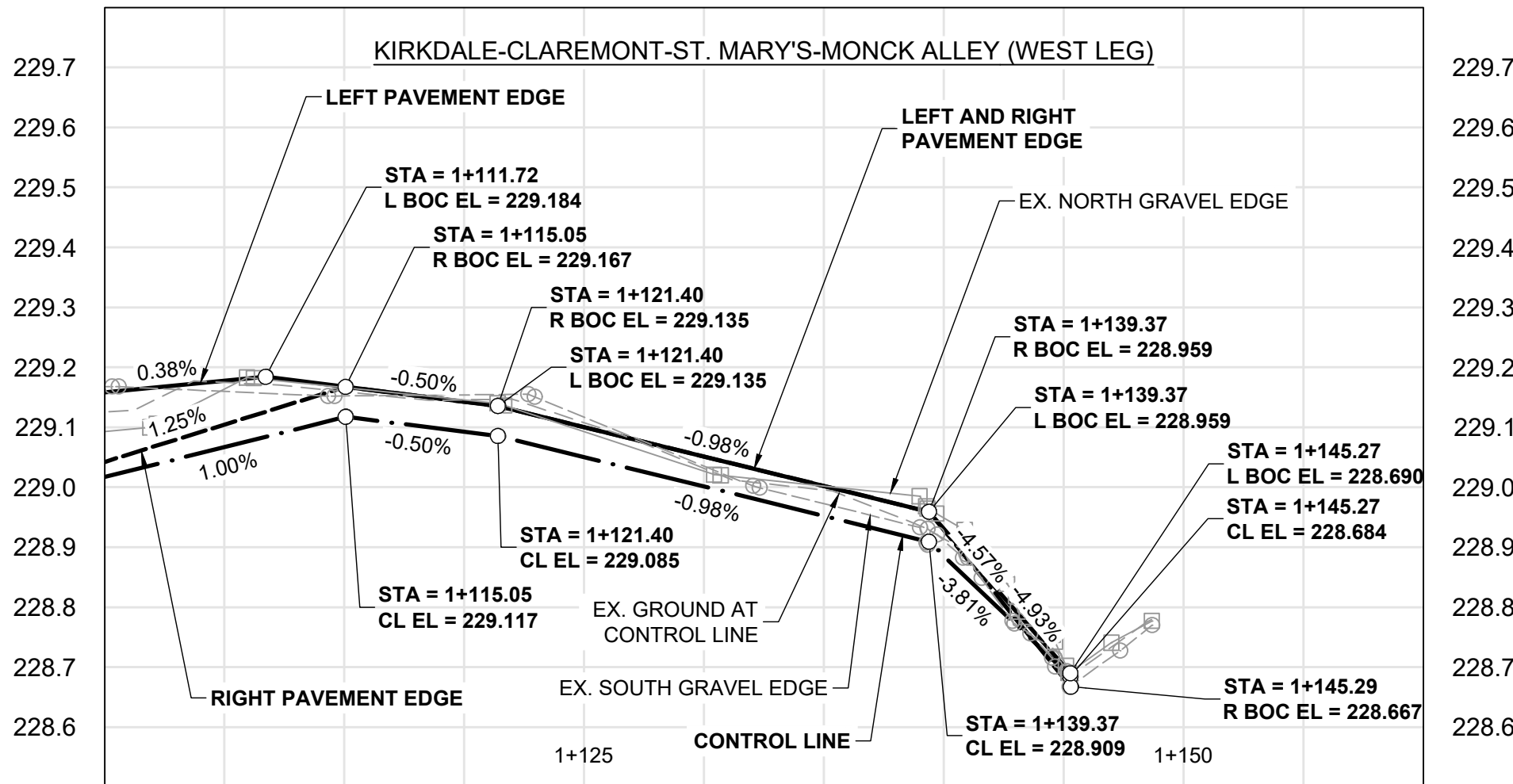
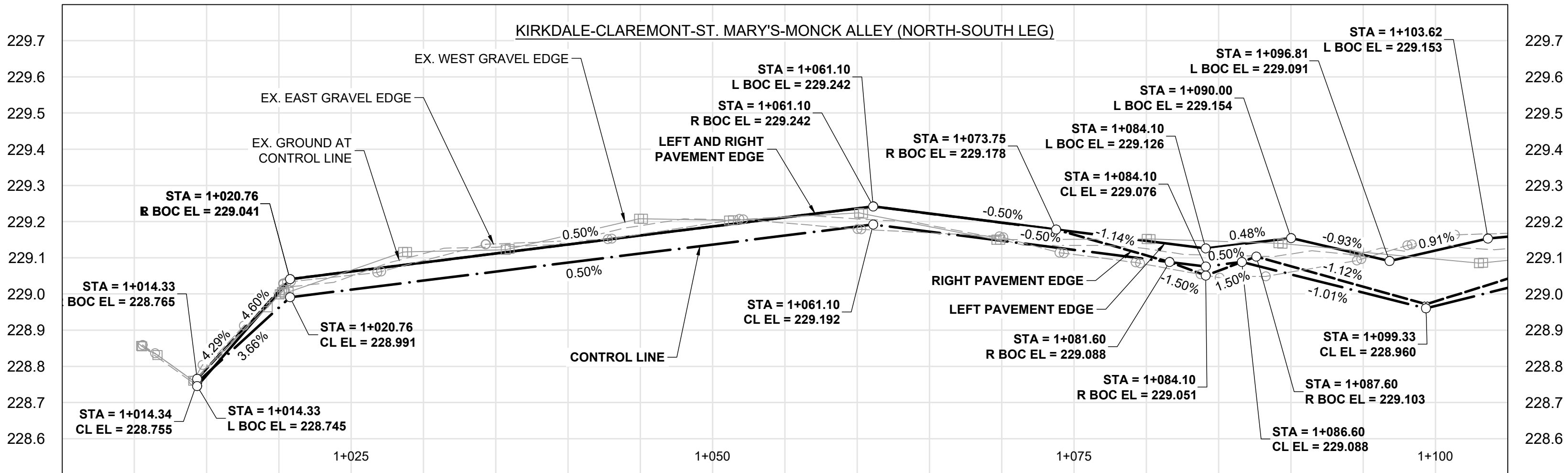

METRIC

WHOLE NUMBERS INDICATE MILLIMETRES
DECIMALIZED NUMBERS INDICATE METRES

150 WWS	WATERMAIN	150 WWS	CONCRETE ROAD
300 LDS	LAND DRAINAGE SEWER	300 LDS	ASPHALT ROAD
250 WWS	WASTE WATER SEWER	250 WWS	CONC ROAD W/ASP OVERLAY
HYDRO	HYDRO	HYDRO	CONCRETE SIDEWALK
BELLMTS	BELLMTS	BELLMTS	ASPHALT PATH
100 GAS	GAS	100 GAS	PAVEMENT REPAIR FABRIC
T.S.	TRAFFIC SIGNALS	T.S.	GRASS/SOD
S.L.	STREET LIGHTS	S.L.	ELEVATION
MANHOLE	TRAFFIC SIGNAL POLE	MANHOLE	PROPERTY LINE
CATCH BASIN	PAVING STONE	CATCH BASIN	CURB RAMP
CATCH PIT	CURB RENEWAL	CATCH PIT	DETECTABLE TILE
EXISTING	LEGEND-PLAN	PROPOSED	LEGEND-PLAN

UNDERGROUND STRUCTURES

SUPPLY U/G STRUCTURES DATE

LOCATION OF UNDERGROUND STRUCTURES AS SHOWN ARE BASED ON THE BEST INFORMATION AVAILABLE, BUT NO GUARANTEE IS GIVEN THAT ALL EXISTING UTILITIES ARE SHOWN OR THAT THE GIVEN LOCATIONS ARE EXACT. CONFIRMATION OF EXISTENCE AND EXACT LOCATION OF ALL SERVICES MUST BE OBTAINED FROM THE INDIVIDUAL UTILITIES BEFORE PROCEEDING WITH CONSTRUCTION.

B.M. ELEV.	DESIGNED BY	TJH
	DRAWN BY	HDT
	CHECKED BY	MRD
	APPROVED BY	DBW
	HOR. SCALE	1:250
	VERTICAL	1:10
1	ISSUED FOR TENDER	26/03/24
NO.	REVISIONS	DATE BY

RELEASED FOR CONSTRUCTION	DATE
DATE	

RELEASED FOR CONSTRUCTION	DATE
DATE	

ENGINEER'S SEAL	CONSULTANT PROJECT NUMBER
	25-2191

THE CITY OF WINNIPEG PUBLIC WORKS DEPARTMENT	CITY DRAWING NUMBER
2026 RESIDENTIAL STREETS RENEWAL PROGRAM - DAY STREET AND VARIOUS OTHER LOCATIONS KIRKDALE-CLAREMONT-ST. MARY'S-MONCK ALLEY	SHEET 15 OF 41
ASPHALT RECONSTRUCTION (NORTH-WEST LEG)	CONSULTANT DRAWING NUMBER