

C:\pwworking\projects\2025\dillon_400jh\mns56539\250151-CT-CON-GRANT SERVICE ROADS.dwg

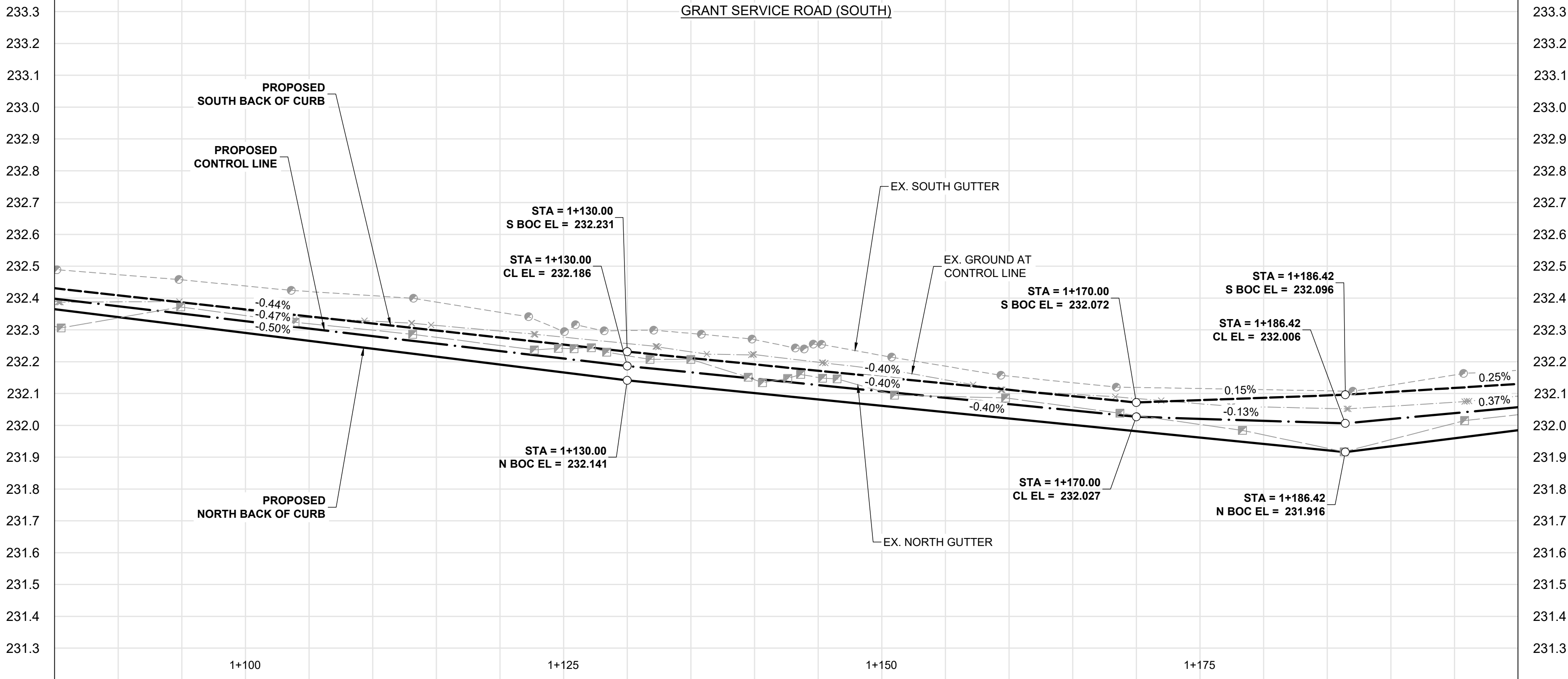

- CONSTRUCTION NOTES:**
- ALL WORK AND MATERIALS TO BE IN ACCORDANCE WITH LATEST REVISION OF THE CITY OF WINNIPEG STANDARD CONSTRUCTION SPECIFICATIONS.
 - LEGAL PLAN AND UNDERGROUND INFORMATION FROM CITY OF WINNIPEG L.B.S. CONTRACTOR TO VERIFY ALL UNDERGROUNDS IN THE FIELD.
 - CONTRACTOR TO TAKE PRECAUTIONARY STEPS TO AVOID DAMAGE FROM CONSTRUCTION ACTIVITIES TO TREES WITHIN THE LIMITS OF CONSTRUCTION AS OUTLINED IN THE SPECIFICATIONS.
 - LOCATION OF EXISTING SERVICES TO BE CONFIRMED IN THE FIELD BY THE CONTRACTOR.
 - ALL DIMENSIONS ARE TO BACK OF CURB.
 - LIMITS OF CURB AND SIDEWALK RECONSTRUCTION TO BE FINALIZED IN THE FIELD BY THE CONTRACT ADMINISTRATOR.
 - ADJUST ALL WATER VALVES, MANHOLES, CATCH BASINS, CATCH PITS AND WATER SHUT OFF VALVES TO GRADE.
 - ALL PRIVATE WALKWAYS TO BE ADJUSTED TO NEW SIDEWALK OR TOP OF CURB ELEVATION, AS REQUIRED.
 - STREET LIGHT STANDARDS, HYDRO POLES AND ANCHORS THAT REQUIRE TEMPORARY SUPPORT, REMOVAL OR REPLACEMENT, ARE TO BE DONE AT THE EXPENSE OF THE CONTRACTOR, AS NECESSARY.
 - FOR ROAD RECONSTRUCTIONS, ALL WATER MAIN SERVICES NEED TO BE INSULATED UNLESS NOTED OTHERWISE. ADDITIONALLY, ALL CATCH BASINS, MANHOLES AND LEAD PIPES LOCATED WITHIN 2.0 m OF A RESIDENTIAL SERVICE MUST BE INSULATED TO PROTECT THE SERVICE FROM POTENTIAL FUTURE FREEZING.
 - CONSTRUCT MODIFIED BARRIER CURB (SD-203B) AT ALL INTERSECTION RADII AND ALLEY RADII.
 - CONTRACTOR TO OVERLAY DRIVEWAYS TO ENSURE POSITIVE DRAINAGE TO NEW STREET GRADES. FINAL LIMITS TO BE DETERMINED IN THE FIELD BY CONTRACT ADMINISTRATOR.
 - REFER TO TENDER FOR DETAILS REGARDING TRAFFIC MANAGEMENT.

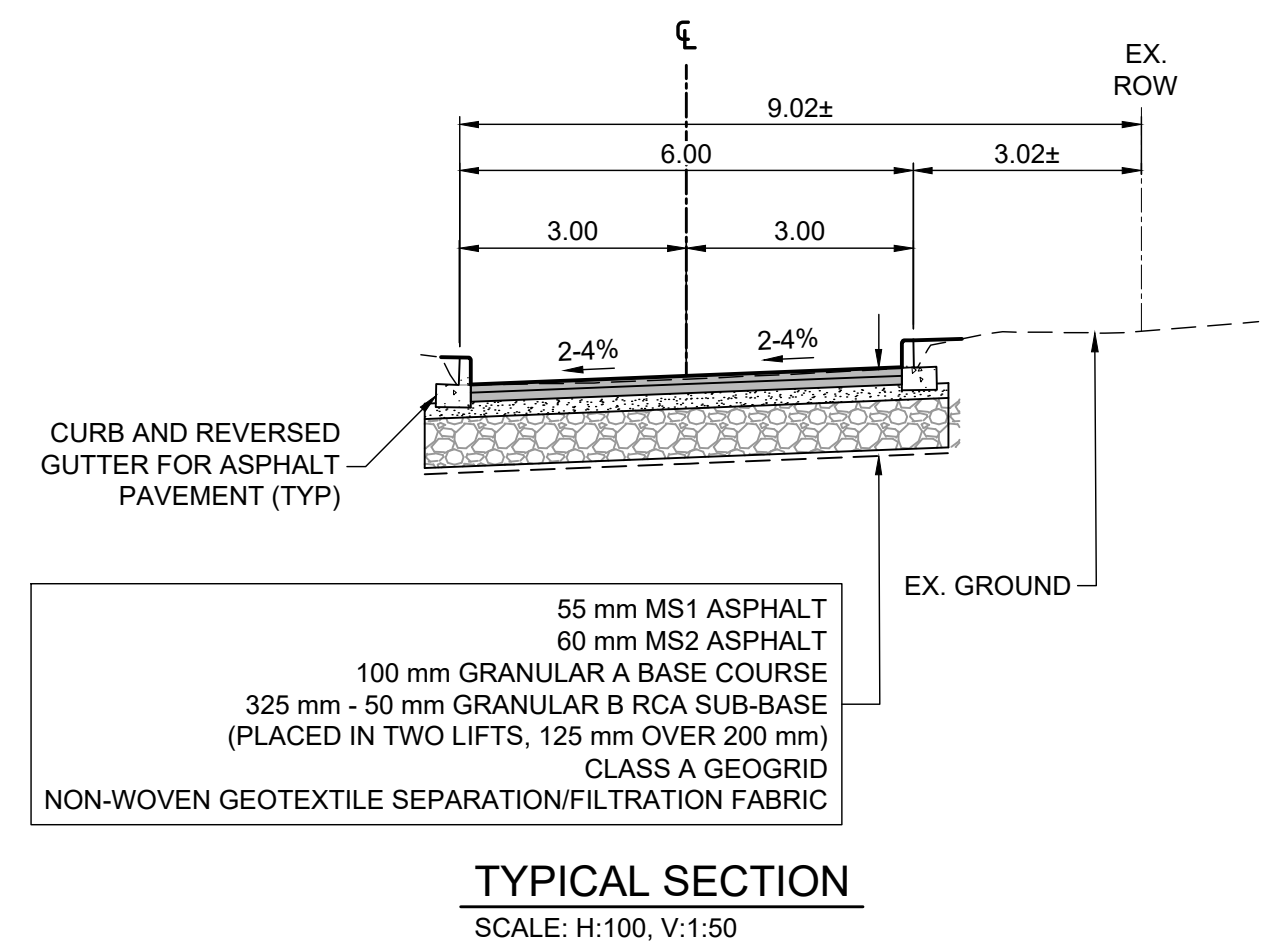
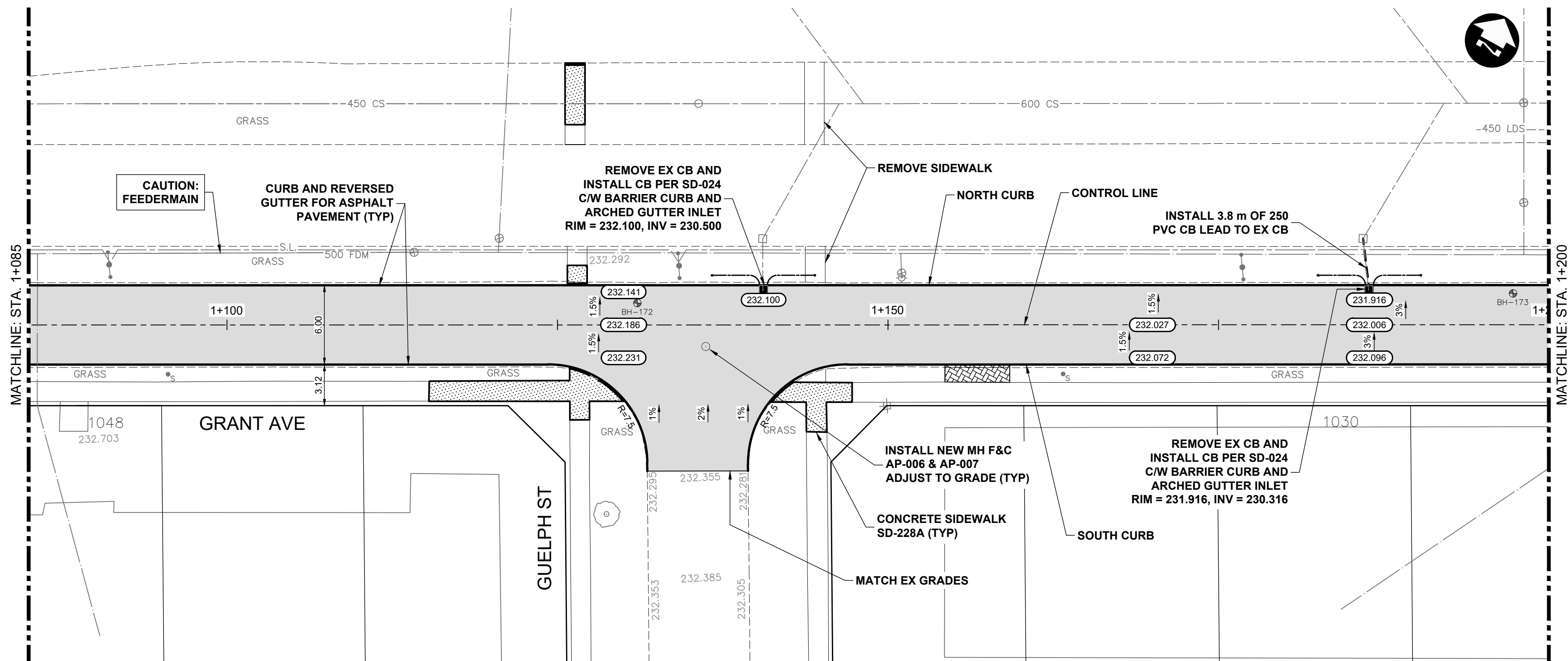

METRIC

WHOLE NUMBERS INDICATE MILLIMETRES
DECIMALIZED NUMBERS INDICATE METRES

EXISTING	LEGEND-PLAN	PROPOSED	EXISTING	LEGEND-PLAN	PROPOSED	EXISTING	LEGEND-PLAN	PROPOSED
HYDRANT	150 WM	WATERMAIN	150 WM	CONCRETE ROAD	CONCRETE ROAD	ASPHALT ROAD	ASPHALT ROAD	CONCRETE ROAD
VALVE	300 LDS	LAND DRAINAGE SEWER	300 LDS	ASPHALT ROAD	ASPHALT ROAD	CONC ROAD W/ASP OVERLAY	CONC ROAD W/ASP OVERLAY	CONCRETE SIDEWALK
CURB STOP	250 WWS	WASTE WATER SEWER	250 WWS	CONCRETE SIDEWALK	CONCRETE SIDEWALK	ASPHALT PATH	ASPHALT PATH	PAVEMENT REPAIR FABRIC
LIGHT STANDARD	HYDRO	HYDRO	HYDRO	GRASS/SOD	GRASS/SOD	ELEVATION	ELEVATION	PROPERTY LINE
HYDRO POLE	BELLMTS	BELLMTS	BELLMTS	CURB RAMP	CURB RAMP	DETECTABLE TILE	DETECTABLE TILE	
TREE	100 GAS	GAS	100 GAS					
GEODETIC BENCH MARK	T.S.	TRAFFIC SIGNALS	T.S.					
SURVEY BAR	S.L.	STREET LIGHTS	S.L.					
MANHOLE		TRAFFIC SIGNAL POLE						
CATCH BASIN		PAVING STONE						
CATCH PIT		CURB RENEWAL						

UNDERGROUND STRUCTURES

SUPPLY: U/G STRUCTURES DATE

LOCATION OF UNDERGROUND STRUCTURES AS SHOWN ARE BASED ON THE BEST INFORMATION AVAILABLE, BUT NO GUARANTEE IS GIVEN THAT ALL EXISTING UTILITIES ARE SHOWN OR THAT THE GIVEN LOCATIONS ARE EXACT. LOCATION OF ALL SERVICES MUST BE OBTAINED FROM THE INDIVIDUAL UTILITIES BEFORE PROCEEDING WITH CONSTRUCTION.

B.M. ELEV.	DESIGNED BY	DRAWN BY	CHECKED BY	APPROVED BY	HOR. SCALE	VERTICAL	NO.	REVISIONS	DATE	BY
	TJH	HDT	LAS	DBW	1:250	1:10	0	ISSUED FOR TENDER	26/03/27	LAS

RELEASED FOR CONSTRUCTION	DATE	BY

THE CITY OF WINNIPEG	2026 LOCAL STREET RENEWALS PROGRAM	GRANT SERVICE ROAD (SOUTH)	WILTON ST TO HARROW ST	ASPHALT RECONSTRUCTION	(STA. 1+085 TO 1+200)
----------------------	------------------------------------	----------------------------	------------------------	------------------------	-----------------------

ENGINEER'S SEAL	CONSULTANT PROJECT NUMBER
	25-2151

THE CITY OF WINNIPEG	2026 LOCAL STREET RENEWALS PROGRAM	GRANT SERVICE ROAD (SOUTH)	WILTON ST TO HARROW ST	ASPHALT RECONSTRUCTION	(STA. 1+085 TO 1+200)
CITY DRAWING NUMBER	SHEET 05 OF 55	TENDER NUMBER	136-2026		

ENGINEERS
GEOSCIENTISTS
MANITOBA
Certificate of Authorization
Dillon Consulting Limited (MB)
No. 1789 Date: 2026/03/27