

C:\pwworking\projects\2025\dillon_401h\mms96359\250151-GT-CON-ALLEY-ASH.dwg

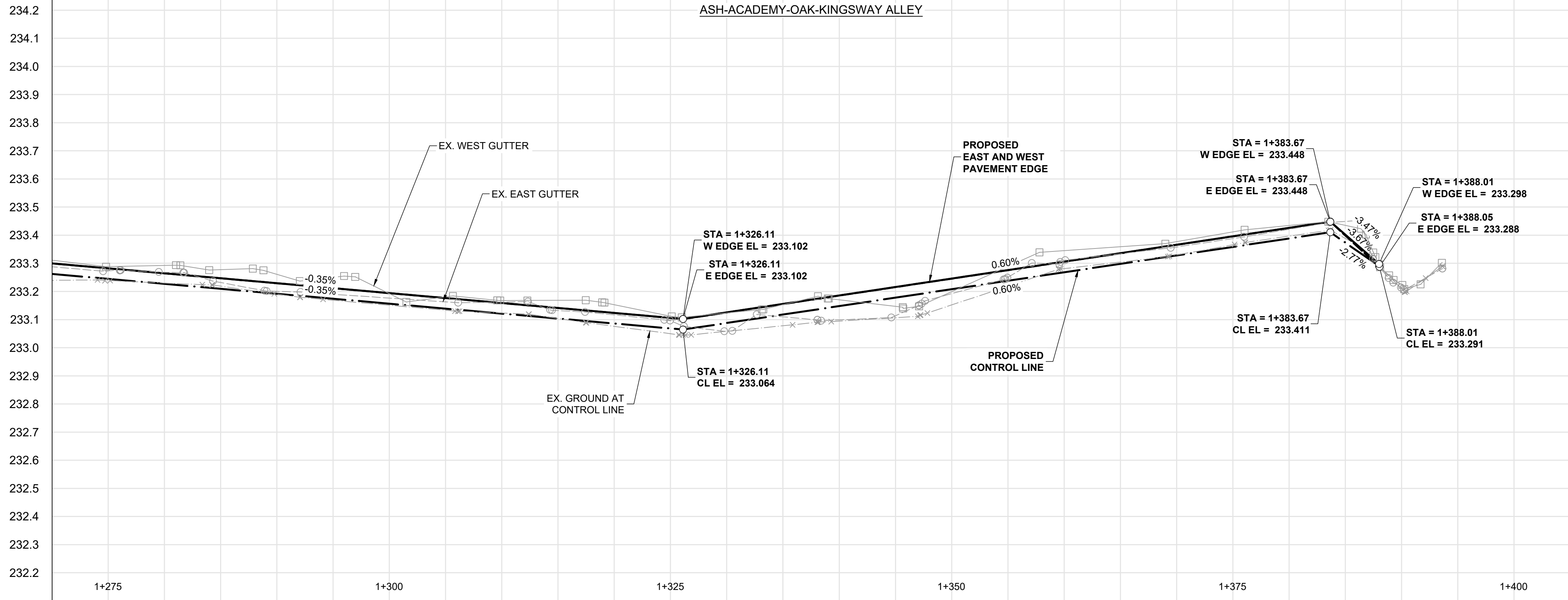

- CONSTRUCTION NOTES:
- ALL WORK AND MATERIALS TO BE IN ACCORDANCE WITH LATEST REVISION OF THE CITY OF WINNIPEG STANDARD CONSTRUCTION SPECIFICATIONS.
 - LEGAL PLAN AND UNDERGROUND INFORMATION FROM CITY OF WINNIPEG L.B.S. CONTRACTOR TO VERIFY ALL UNDERGROUNDS IN THE FIELD.
 - CONTRACTOR TO TAKE PRECAUTIONARY STEPS TO AVOID DAMAGE FROM CONSTRUCTION ACTIVITIES TO TREES WITHIN THE LIMITS OF CONSTRUCTION AS OUTLINED IN THE SPECIFICATIONS.
 - LOCATION OF EXISTING SERVICES TO BE CONFIRMED IN THE FIELD BY THE CONTRACTOR.
 - ALL DIMENSIONS ARE TO BACK OF CURB.
 - LIMITS OF CURB AND SIDEWALK RECONSTRUCTION TO BE FINALIZED IN THE FIELD BY THE CONTRACT ADMINISTRATOR.
 - ADJUST ALL WATER VALVES, MANHOLES, CATCH BASINS, CATCH PITS AND WATER SHUT OFF VALVES TO GRADE.
 - ALL PRIVATE WALKWAYS TO BE ADJUSTED TO NEW SIDEWALK OR TOP OF CURB ELEVATION, AS REQUIRED.
 - STREET LIGHT STANDARDS, HYDRO POLES AND ANCHORS THAT REQUIRE TEMPORARY SUPPORT, REMOVAL OR REPLACEMENT, ARE TO BE DONE AT THE EXPENSE OF THE CONTRACTOR, AS NECESSARY.
 - FOR ROAD RECONSTRUCTIONS, ALL WATER MAIN SERVICES NEED TO BE INSULATED UNLESS NOTED OTHERWISE. ADDITIONALLY, ALL CATCH BASINS, MANHOLES AND LEAD PIPES LOCATED WITHIN 2.0 m OF A RESIDENTIAL SERVICE MUST BE INSULATED TO PROTECT THE SERVICE FROM POTENTIAL FUTURE FREEZING.
 - CONSTRUCT MODIFIED BARRIER CURB (SD-203B) AT ALL INTERSECTION RADII AND ALLEY RADII.
 - CONTRACTOR TO OVERLAY DRIVEWAYS TO ENSURE POSITIVE DRAINAGE TO NEW STREET GRADES. FINAL LIMITS TO BE DETERMINED IN THE FIELD BY CONTRACT ADMINISTRATOR.
 - REFER TO TENDER FOR DETAILS REGARDING TRAFFIC MANAGEMENT.

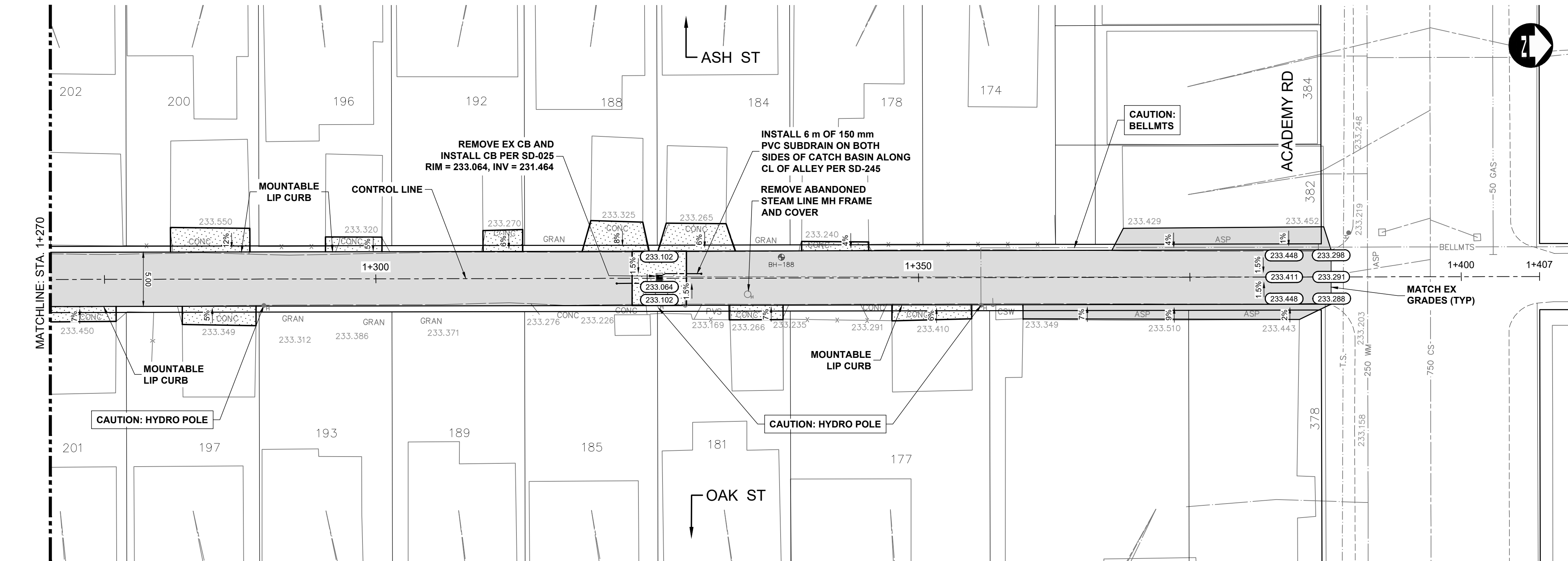
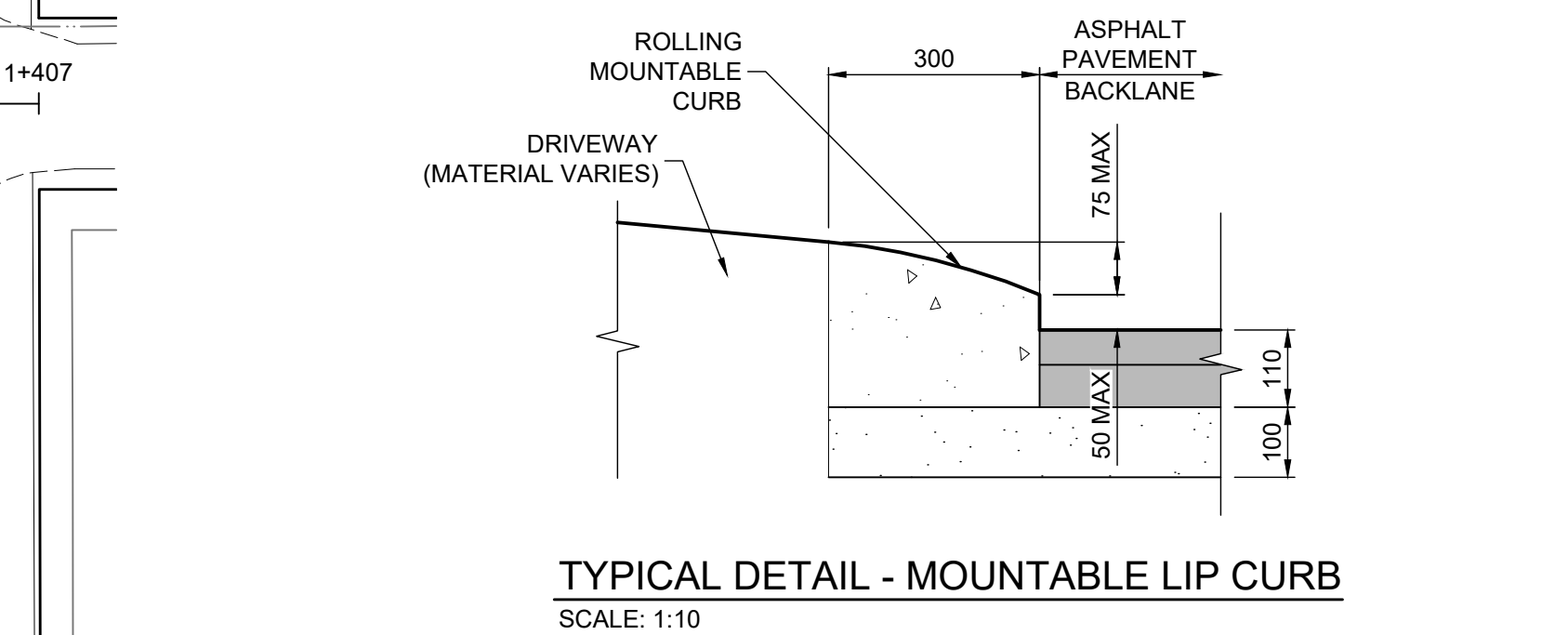
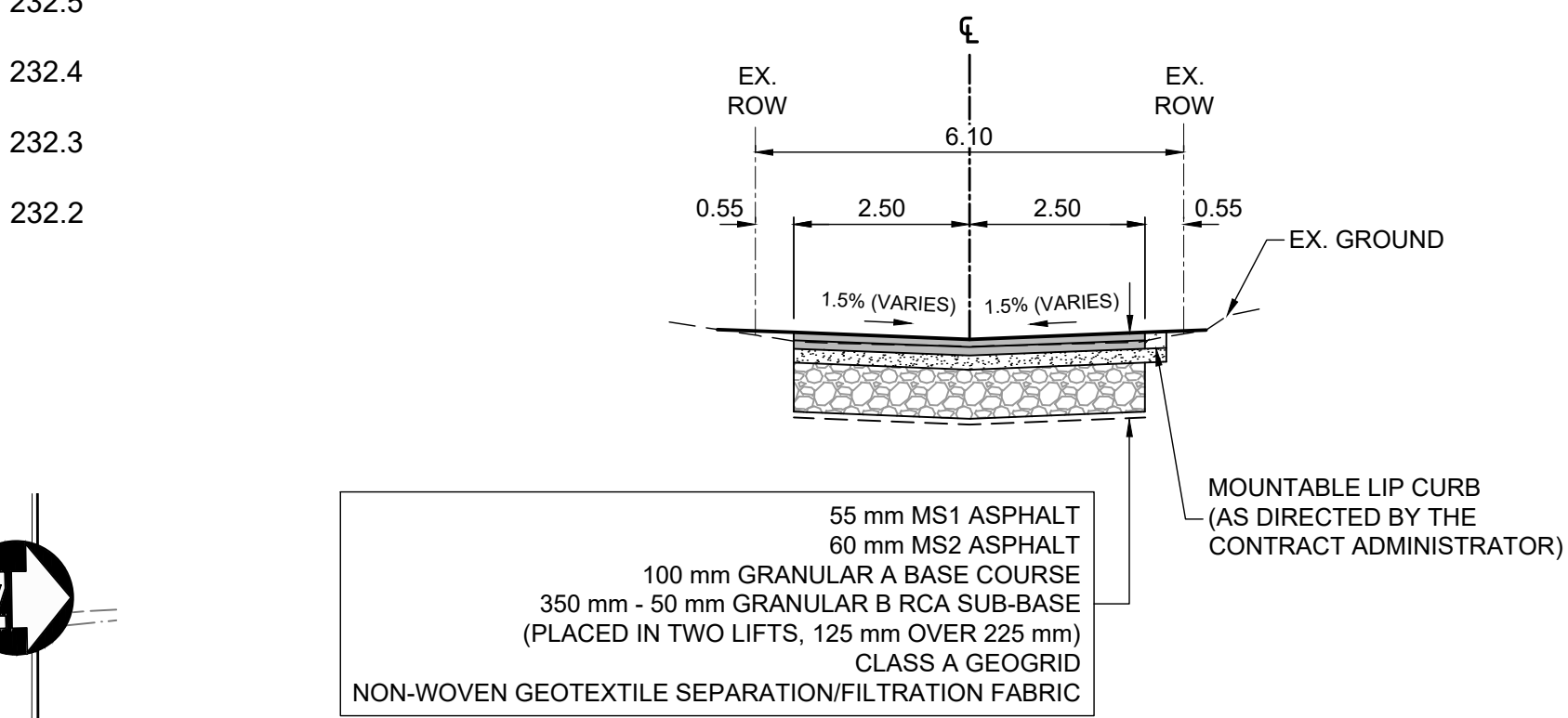

METRIC

WHOLE NUMBERS INDICATE MILLIMETRES
DECIMALIZED NUMBERS INDICATE METRES

HYDRANT	WATERMAIN	CONCRETE ROAD
VALVE	LAND DRAINAGE SEWER	ASPHALT ROAD
CURB STOP	WASTE WATER SEWER	CONC ROAD W/ASP OVERLAY
LIGHT STANDARD	HYDRO	CONCRETE SIDEWALK
HYDRO POLE	BELLMTS	ASPHALT PATH
TREE	GAS	PAVEMENT REPAIR FABRIC
GEODETIC BENCH MARK	TRAFFIC SIGNALS	GRASS/SOD
SURVEY BAR	STREET LIGHTS	ELEVATION
MANHOLE	TRAFFIC SIGNAL POLE	PROPERTY LINE
CATCH BASIN	PAVING STONE	CURB RAMP
CATCH PIT	CURB RENEWAL	DETECTABLE TILE
EXISTING	LEGEND-PLAN	LEGEND-PLAN
PROPOSED	PROPOSED	PROPOSED

UNDERGROUND STRUCTURES

SUPPLY: U/G STRUCTURES DATE

LOCATION OF UNDERGROUND STRUCTURES AS SHOWN ARE BASED ON THE BEST INFORMATION AVAILABLE, BUT NO GUARANTEE IS GIVEN THAT ALL EXISTING UTILITIES ARE SHOWN OR THAT THE GIVEN LOCATIONS ARE EXACT. CONFIRMATION OF EXISTENCE AND EXACT LOCATION OF ALL SERVICES MUST BE OBTAINED FROM THE INDIVIDUAL UTILITIES BEFORE PROCEEDING WITH CONSTRUCTION.

B.M. ELEV.	DESIGNED BY	TJH
	DRAWN BY	HDT
	CHECKED BY	LAS
	APPROVED BY	DBW
	HOR. SCALE	1:250
	VERTICAL	1:10
0	ISSUED FOR TENDER	26/03/27
NO.	REVISIONS	DATE BY

DESIGNED BY	TJH
DRAWN BY	HDT
CHECKED BY	LAS
APPROVED BY	DBW
HOR. SCALE	1:250
VERTICAL	1:10
DATE	

DESIGNED BY	TJH	
DRAWN BY	HDT	
CHECKED BY	LAS	
APPROVED BY	DBW	
HOR. SCALE	1:250	
VERTICAL	1:10	
0	ISSUED FOR TENDER	26/03/27
NO.	REVISIONS	DATE BY

ENGINEER'S SEAL	CONSULTANT PROJECT NUMBER	25-2151
-----------------	---------------------------	---------

THE CITY OF WINNIPEG PUBLIC WORKS DEPARTMENT	CITY DRAWING NUMBER	17 OF 55
2026 LOCAL STREET RENEWALS PROGRAM ASH-ACADEMY-OAK-KINGSWAY ALLEY	TENDER NUMBER	136-2026
ASPHALT RECONSTRUCTION (STA. 1+270 TO END)		