

- CONSTRUCTION NOTES:
- ALL WORK AND MATERIALS TO BE IN ACCORDANCE WITH LATEST REVISION OF THE CITY OF WINNIPEG STANDARD CONSTRUCTION SPECIFICATIONS.
 - LEGAL PLAN AND UNDERGROUND INFORMATION FROM CITY OF WINNIPEG L.B.S. CONTRACTOR TO VERIFY ALL UNDERGROUNDS IN THE FIELD.
 - CONTRACTOR TO TAKE PRECAUTIONARY STEPS TO AVOID DAMAGE FROM CONSTRUCTION ACTIVITIES TO TREES WITHIN THE LIMITS OF CONSTRUCTION AS OUTLINED IN THE SPECIFICATIONS.
 - LOCATION OF EXISTING SERVICES TO BE CONFIRMED IN THE FIELD BY THE CONTRACTOR.
 - ALL DIMENSIONS ARE TO BACK OF CURB.
 - LIMITS OF CURB AND SIDEWALK RECONSTRUCTION TO BE FINALIZED IN THE FIELD BY THE CONTRACT ADMINISTRATOR.
 - ADJUST ALL WATER VALVES, MANHOLES, CATCH BASINS, CATCH PITS AND WATER SHUT OFF VALVES TO GRADE.
 - ALL PRIVATE WALKWAYS TO BE ADJUSTED TO NEW SIDEWALK OR TOP OF CURB ELEVATION, AS REQUIRED.
 - STREET LIGHT STANDARDS, HYDRO POLES AND ANCHORS THAT REQUIRE TEMPORARY SUPPORT, REMOVAL OR REPLACEMENT, ARE TO BE DONE AT THE EXPENSE OF THE CONTRACTOR, AS NECESSARY.
 - FOR ROAD RECONSTRUCTIONS, ALL WATER MAIN SERVICES NEED TO BE INSULATED UNLESS NOTED OTHERWISE. ADDITIONALLY, ALL CATCH BASINS, MANHOLES AND LEAD PIPES LOCATED WITHIN 2.0 m OF A RESIDENTIAL SERVICE MUST BE INSULATED TO PROTECT THE SERVICE FROM POTENTIAL FUTURE FREEZING.
 - CONSTRUCT MODIFIED BARRIER CURB (SD-203B) AT ALL INTERSECTION RADII AND ALLEY RADII.
 - CONTRACTOR TO OVERLAY DRIVEWAYS TO ENSURE POSITIVE DRAINAGE TO NEW STREET GRADES. FINAL LIMITS TO BE DETERMINED IN THE FIELD BY CONTRACT ADMINISTRATOR.
 - REFER TO TENDER FOR DETAILS REGARDING TRAFFIC MANAGEMENT.

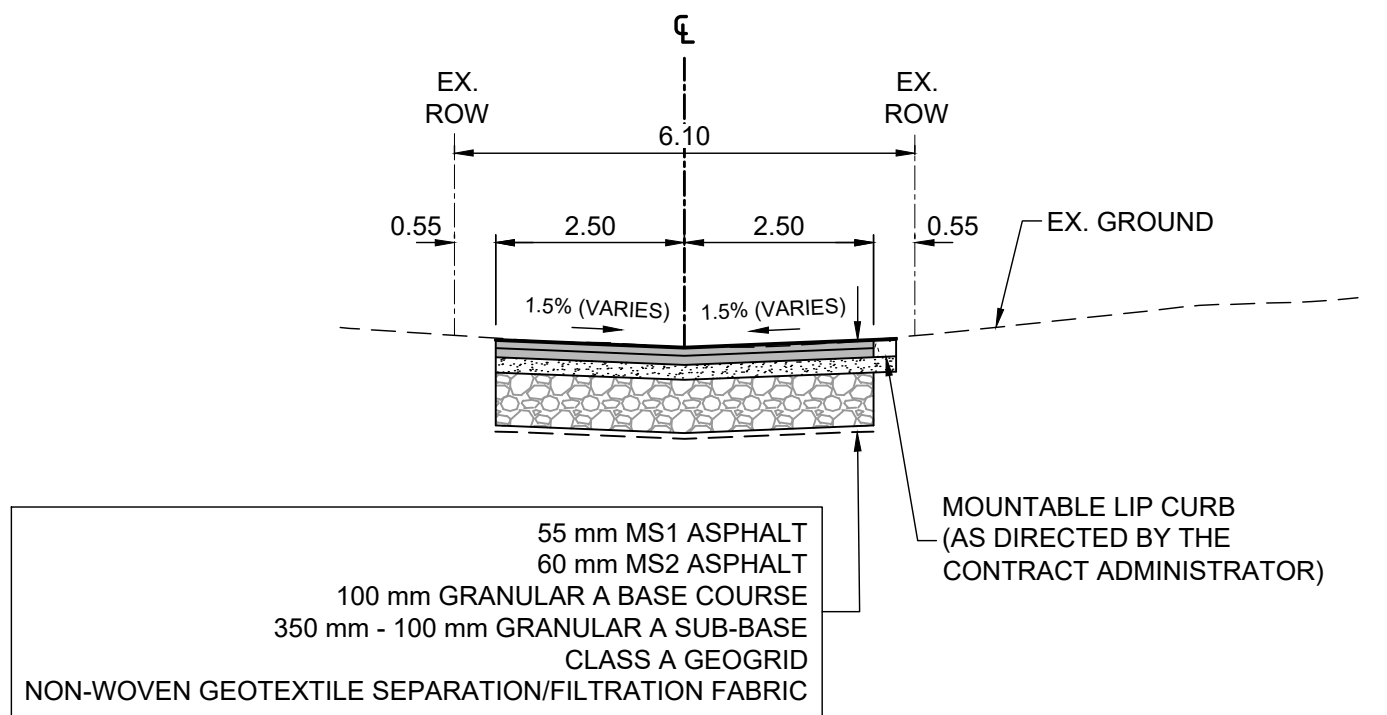

TYPICAL SECTION
SCALE: H:100, V:1:50

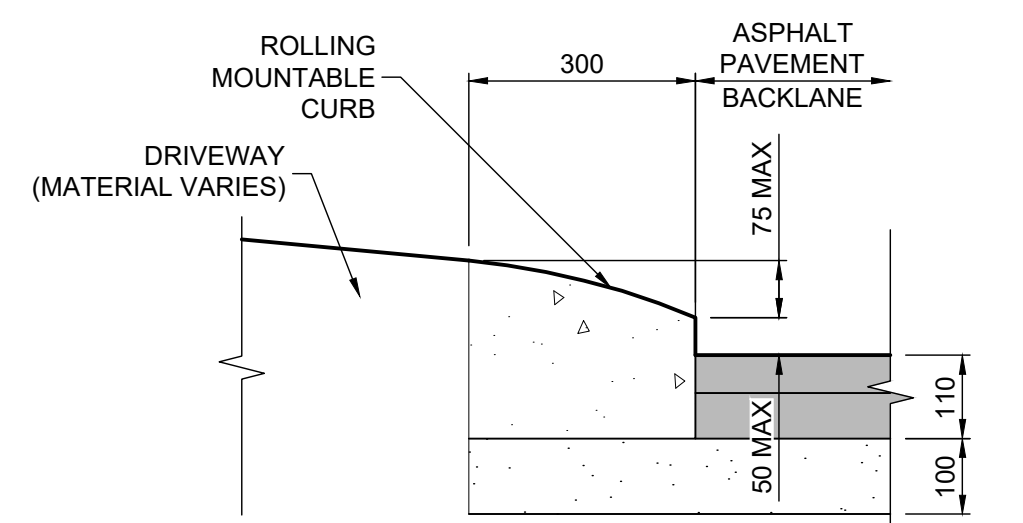
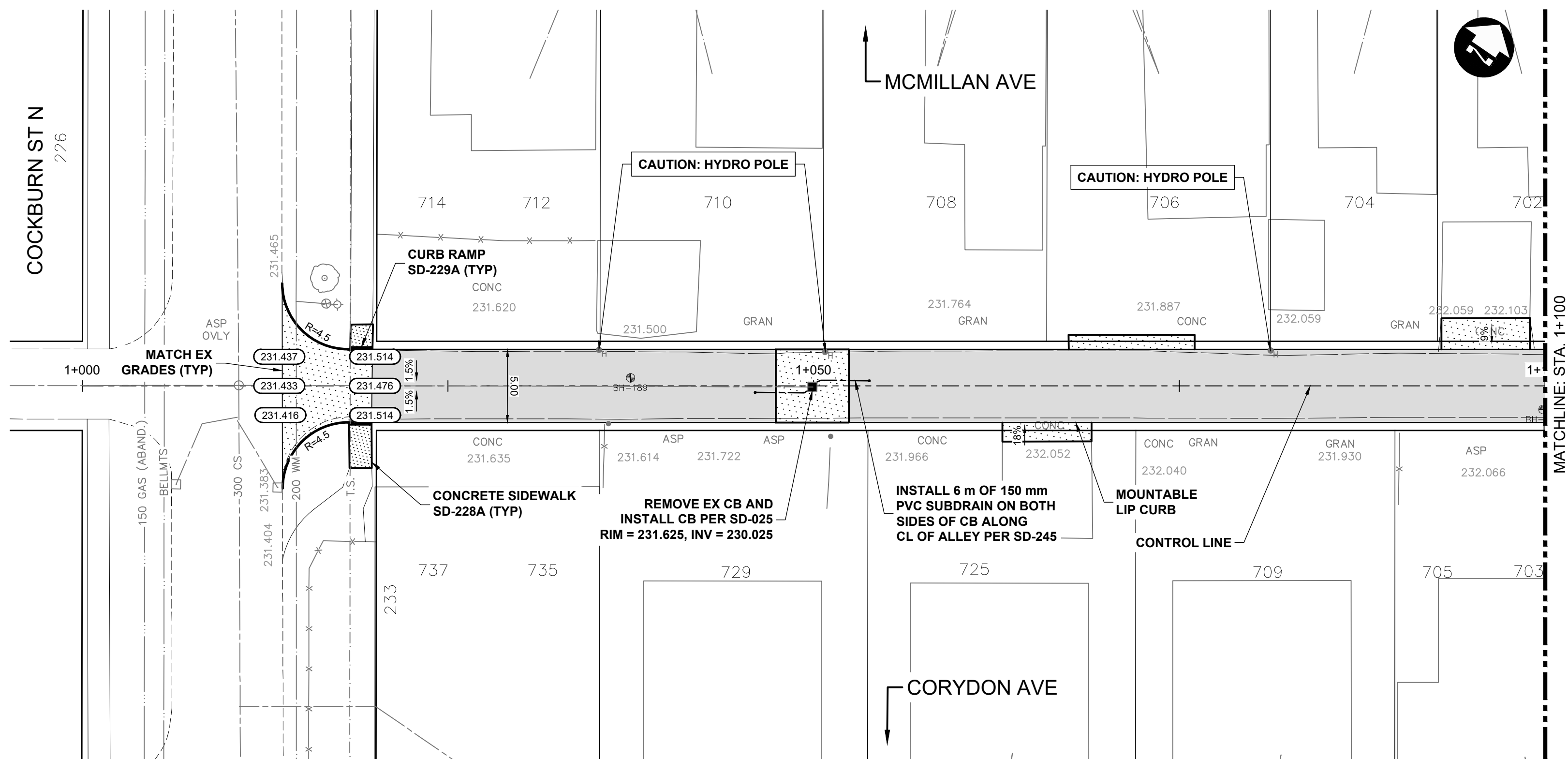

TYPICAL DETAIL - MOUNTABLE LIP CURB
SCALE: 1:10

METRIC

WHOLE NUMBERS INDICATE MILLIMETRES
DECIMALIZED NUMBERS INDICATE METRES

HYDRANT	WATERMAIN	CONCRETE ROAD
VALVE	LAND DRAINAGE SEWER	ASPHALT ROAD
CURB STOP	WASTE WATER SEWER	CONC ROAD W/ASP OVERLAY
LIGHT STANDARD	HYDRO	CONCRETE SIDEWALK
HYDRO POLE	BELLMTS	ASPHALT PATH
TREE	GAS	PAVEMENT REPAIR FABRIC
GEODETIC BENCH MARK	TRAFFIC SIGNALS	GRASS/SOD
SURVEY BAR	STREET LIGHTS	ELEVATION
MANHOLE	TRAFFIC SIGNAL POLE	PROPERTY LINE
CATCH BASIN	PAVING STONE	CURB RAMP
CATCH PIT	CURB RENEWAL	DETECTABLE TILE
EXISTING	LEGEND-PLAN	LEGEND-PLAN
PROPOSED	PROPOSED	PROPOSED

UNDERGROUND STRUCTURES
SUPPLY: U/G STRUCTURES
DATE
LOCATION OF UNDERGROUND STRUCTURES AS SHOWN ARE BASED ON THE BEST INFORMATION AVAILABLE. BUT NO GUARANTEE IS GIVEN THAT ALL EXISTING UTILITIES ARE SHOWN OR THAT THE GIVEN LOCATIONS ARE EXACT. CONFIRMATION OF EXISTENCE AND EXACT LOCATION OF ALL SERVICES MUST BE OBTAINED FROM THE INDIVIDUAL UTILITIES BEFORE PROCEEDING WITH CONSTRUCTION.

B.M. ELEV.
0
ISSUED FOR TENDER
26/03/27
LAS
NO. REVISIONS
DATE
BY

DESIGNED BY
TJH
DRAWN BY
HDT
CHECKED BY
LAS
APPROVED BY
DBW
HOR. SCALE
1:250
VERTICAL
1:10

RELEASED FOR CONSTRUCTION
DATE

ENGINEER'S SEAL
CONSULTANT PROJECT NUMBER
25-2151

THE CITY OF WINNIPEG PUBLIC WORKS DEPARTMENT
2026 LOCAL STREET RENEWALS PROGRAM COCKBURN-McMILLAN-CORYDON-HUGO ALLEY
ASPHALT RECONSTRUCTION (START TO STA. 1+100)
CITY DRAWING NUMBER
SHEET 22 OF 55
TENDER NUMBER
136-2026