

C:\pwworking\projects\2025\dillon_400h\rms56539\250151-CT-CON-SELKIRK.dwg

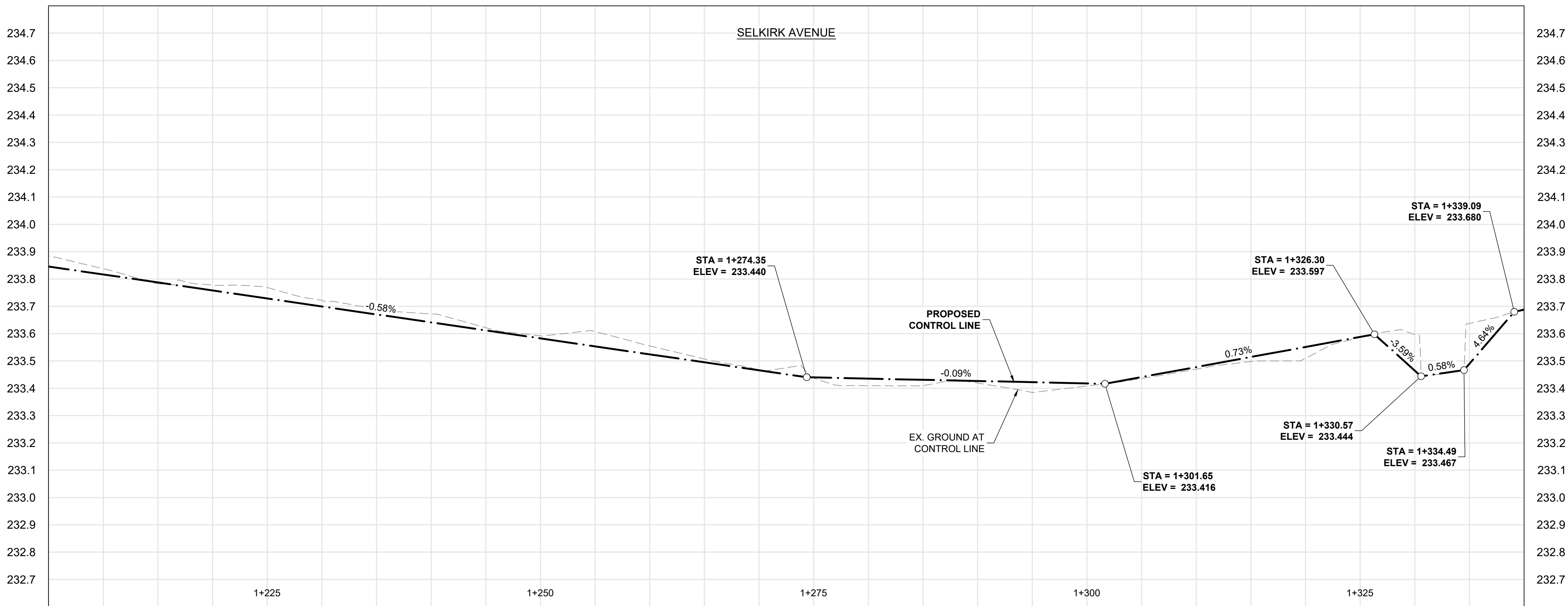

- CONSTRUCTION NOTES:**
- ALL WORK AND MATERIALS TO BE IN ACCORDANCE WITH LATEST REVISION OF THE CITY OF WINNIPEG STANDARD CONSTRUCTION SPECIFICATIONS.
 - LEGAL PLAN AND UNDERGROUND INFORMATION FROM CITY OF WINNIPEG L.B.S. CONTRACTOR TO VERIFY ALL UNDERGROUNDS IN THE FIELD.
 - CONTRACTOR TO TAKE PRECAUTIONARY STEPS TO AVOID DAMAGE FROM CONSTRUCTION ACTIVITIES TO TREES WITHIN THE LIMITS OF CONSTRUCTION AS OUTLINED IN THE SPECIFICATIONS.
 - LOCATION OF EXISTING SERVICES TO BE CONFIRMED IN THE FIELD BY THE CONTRACTOR.
 - ALL DIMENSIONS ARE TO BACK OF CURB.
 - LIMITS OF CURB AND SIDEWALK RECONSTRUCTION TO BE FINALIZED IN THE FIELD BY THE CONTRACT ADMINISTRATOR.
 - ADJUST ALL WATER VALVES, MANHOLES, CATCH BASINS, CATCH PITS AND WATER SHUT OFF VALVES TO GRADE.
 - ALL PRIVATE WALKWAYS TO BE ADJUSTED TO NEW SIDEWALK OR TOP OF CURB ELEVATION, AS REQUIRED.
 - STREET LIGHT STANDARDS, HYDRO POLES AND ANCHORS THAT REQUIRE TEMPORARY SUPPORT, REMOVAL OR REPLACEMENT, ARE TO BE DONE AT THE EXPENSE OF THE CONTRACTOR, AS NECESSARY.
 - FOR ROAD RECONSTRUCTIONS, ALL WATER MAIN SERVICES NEED TO BE INSULATED UNLESS NOTED OTHERWISE. ADDITIONALLY, ALL CATCH BASINS, MANHOLES AND LEAD PIPES LOCATED WITHIN 2.0 m OF A RESIDENTIAL SERVICE MUST BE INSULATED TO PROTECT THE SERVICE FROM POTENTIAL FUTURE FREEZING.
 - CONSTRUCT MODIFIED BARRIER CURB (SD-203B) AT ALL INTERSECTION RADII AND ALLEY RADII.
 - CONTRACTOR TO OVERLAY DRIVEWAYS TO ENSURE POSITIVE DRAINAGE TO NEW STREET GRADES. FINAL LIMITS TO BE DETERMINED IN THE FIELD BY CONTRACT ADMINISTRATOR.
 - REFER TO TENDER FOR DETAILS REGARDING TRAFFIC MANAGEMENT.

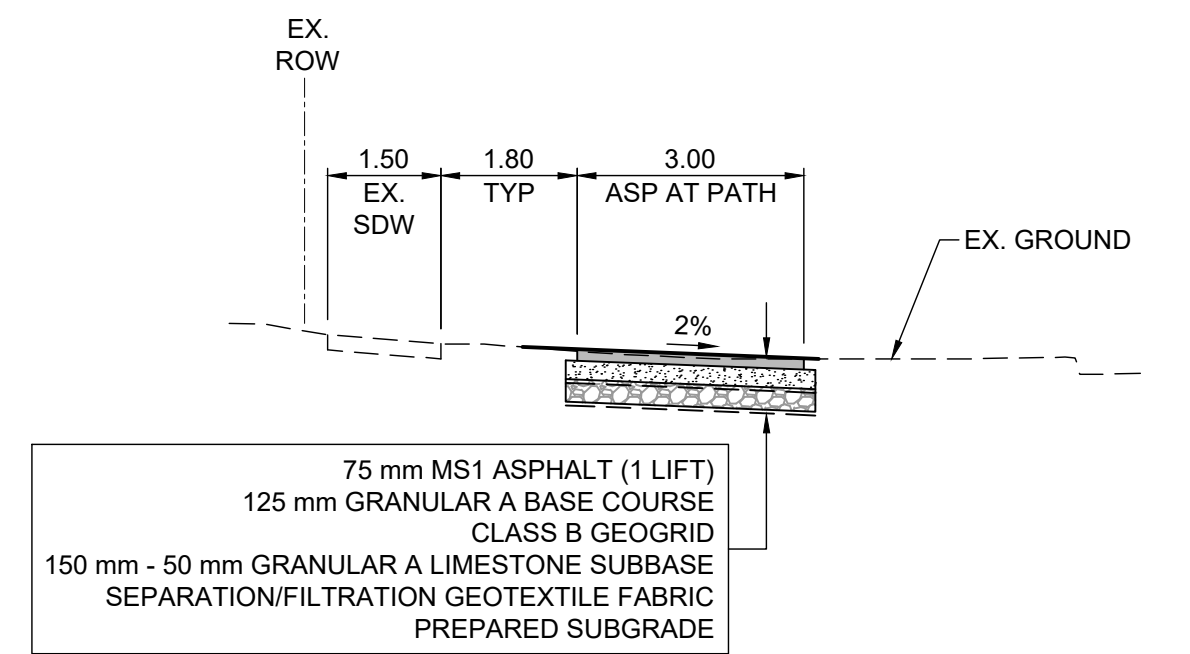
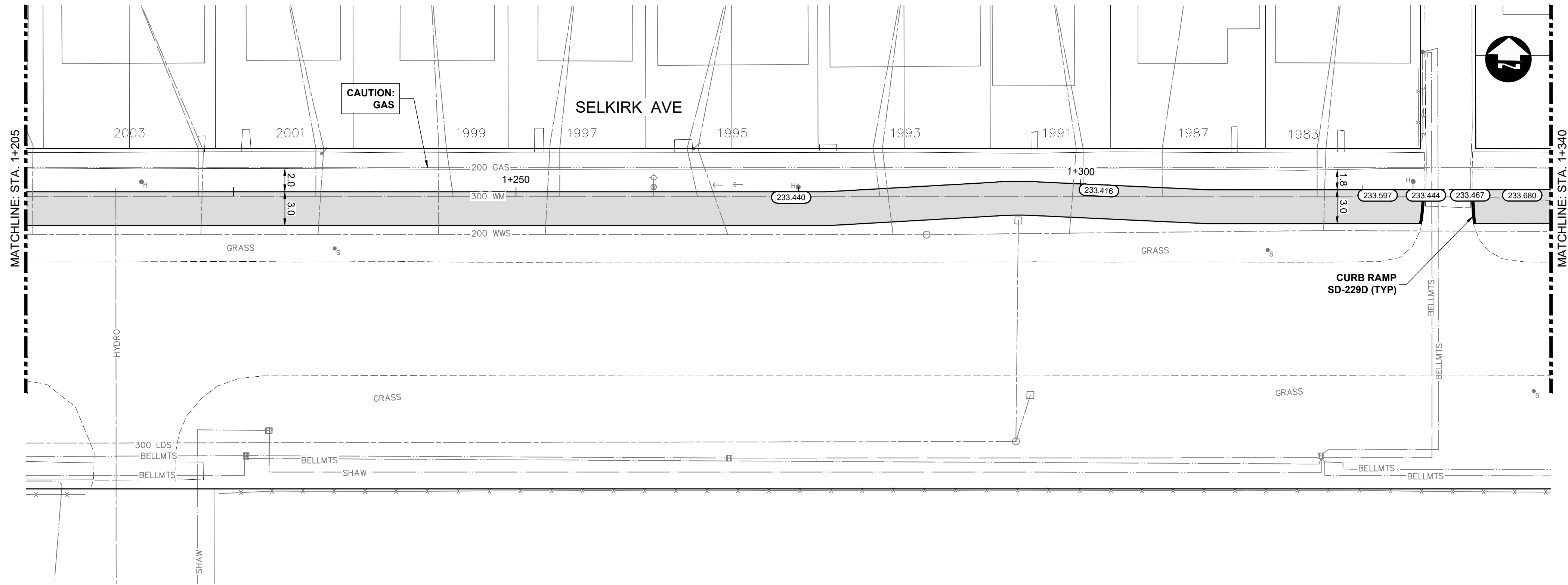

TYPICAL SECTION - AT PATH IN BOULEVARD
SCALE: H:100, V:1:50

METRIC

WHOLE NUMBERS INDICATE MILLIMETRES
DECIMALIZED NUMBERS INDICATE METRES

HYDRANT	150 WM	WATERMAIN	150 WM	CONCRETE ROAD
VALVE	300 LDS	LAND DRAINAGE SEWER	300 LDS	ASPHALT ROAD
CURB STOP	250 WWS	WASTE WATER SEWER	250 WWS	CONC ROAD W/ASP OVERLAY
LIGHT STANDARD	HYDRO	HYDRO	HYDRO	CONCRETE SIDEWALK
HYDRO POLE	BELLMTS	BELLMTS	BELLMTS	ASPHALT PATH
TREE	100 GAS	GAS	100 GAS	PAVEMENT REPAIR FABRIC
GEODETIC BENCH MARK	T.S.	TRAFFIC SIGNALS	T.S.	GRASS/SOD
SURVEY BAR	S.L.	STREET LIGHTS	S.L.	ELEVATION
MANHOLE		TRAFFIC SIGNAL POLE		PROPERTY LINE
CATCH BASIN		PAVING STONE		CURB RAMP
CATCH PIT		CURB RENEWAL		DETECTABLE TILE
EXISTING	LEGEND-PLAN	PROPOSED	EXISTING	LEGEND-PLAN

UNDERGROUND STRUCTURES

SUPPLY: U/G STRUCTURES DATE

LOCATION OF UNDERGROUND STRUCTURES AS SHOWN ARE BASED ON THE BEST INFORMATION AVAILABLE. BUT NO GUARANTEE IS GIVEN THAT ALL EXISTING UTILITIES ARE SHOWN OR THAT THE GIVEN LOCATIONS ARE EXACT. CONFIRMATION OF EXISTENCE AND EXACT LOCATION OF ALL SERVICES MUST BE OBTAINED FROM THE INDIVIDUAL UTILITIES BEFORE PROCEEDING WITH CONSTRUCTION.

B.M. ELEV.	DESIGNED BY	TJH
	DRAWN BY	HDT
	CHECKED BY	LAS
	APPROVED BY	DBW
	HOR. SCALE	1:250
	VERTICAL	1:10
0	ISSUED FOR TENDER	26/03/27
NO.	REVISIONS	DATE BY

DESIGNED BY	TJH
DRAWN BY	HDT
CHECKED BY	LAS
APPROVED BY	DBW
HOR. SCALE	1:250
VERTICAL	1:10
DATE	

RELEASED FOR CONSTRUCTION
DATE

ENGINEER'S SEAL
CONSULTANT PROJECT NUMBER
25-2151

THE CITY OF WINNIPEG PUBLIC WORKS DEPARTMENT	CITY DRAWING NUMBER
2026 LOCAL STREET RENEWALS PROGRAM	SHEET 28 OF 55
SELKIRK AVENUE OAK POINT HWY TO KEEWATIN ST	TENDER NUMBER
AT PATHWAY (3 OF 10)	136-2026