

C:\pwworking\projects\2025\dillon\_400h\mms56539\250151-CT-CON-SELKIRK.dwg

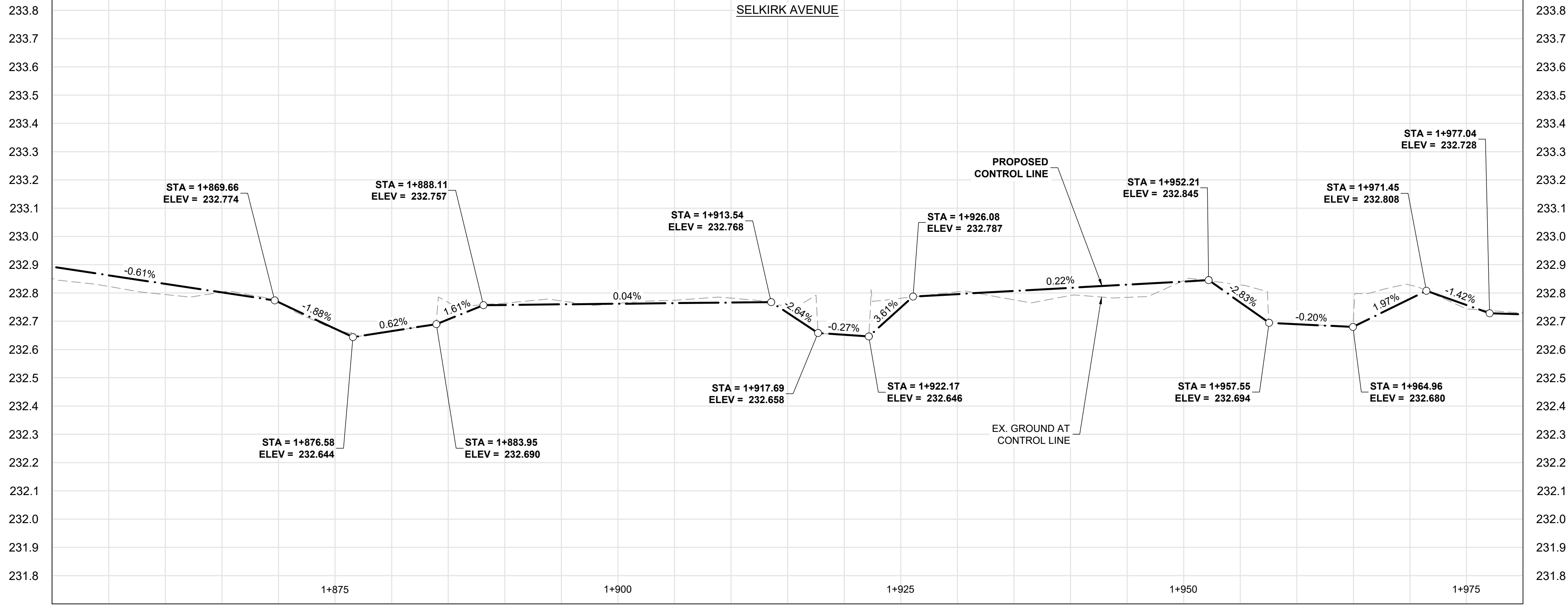

- CONSTRUCTION NOTES:**
- ALL WORK AND MATERIALS TO BE IN ACCORDANCE WITH LATEST REVISION OF THE CITY OF WINNIPEG STANDARD CONSTRUCTION SPECIFICATIONS.
  - LEGAL PLAN AND UNDERGROUND INFORMATION FROM CITY OF WINNIPEG L.B.S. CONTRACTOR TO VERIFY ALL UNDERGROUNDS IN THE FIELD.
  - CONTRACTOR TO TAKE PRECAUTIONARY STEPS TO AVOID DAMAGE FROM CONSTRUCTION ACTIVITIES TO TREES WITHIN THE LIMITS OF CONSTRUCTION AS OUTLINED IN THE SPECIFICATIONS.
  - LOCATION OF EXISTING SERVICES TO BE CONFIRMED IN THE FIELD BY THE CONTRACTOR.
  - ALL DIMENSIONS ARE TO BACK OF CURB.
  - LIMITS OF CURB AND SIDEWALK RECONSTRUCTION TO BE FINALIZED IN THE FIELD BY THE CONTRACT ADMINISTRATOR.
  - ADJUST ALL WATER VALVES, MANHOLES, CATCH BASINS, CATCH PITS AND WATER SHUT OFF VALVES TO GRADE.
  - ALL PRIVATE WALKWAYS TO BE ADJUSTED TO NEW SIDEWALK OR TOP OF CURB ELEVATION, AS REQUIRED.
  - STREET LIGHT STANDARDS, HYDRO POLES AND ANCHORS THAT REQUIRE TEMPORARY SUPPORT, REMOVAL OR REPLACEMENT, ARE TO BE DONE AT THE EXPENSE OF THE CONTRACTOR, AS NECESSARY.
  - FOR ROAD RECONSTRUCTIONS, ALL WATER MAIN SERVICES NEED TO BE INSULATED UNLESS NOTED OTHERWISE. ADDITIONALLY, ALL CATCH BASINS, MANHOLES AND LEAD PIPES LOCATED WITHIN 2.0 m OF A RESIDENTIAL SERVICE MUST BE INSULATED TO PROTECT THE SERVICE FROM POTENTIAL FUTURE FREEZING.
  - CONSTRUCT MODIFIED BARRIER CURB (SD-203B) AT ALL INTERSECTION RADII AND ALLEY RADII.
  - CONTRACTOR TO OVERLAY DRIVEWAYS TO ENSURE POSITIVE DRAINAGE TO NEW STREET GRADES. FINAL LIMITS TO BE DETERMINED IN THE FIELD BY CONTRACT ADMINISTRATOR.
  - REFER TO TENDER FOR DETAILS REGARDING TRAFFIC MANAGEMENT.

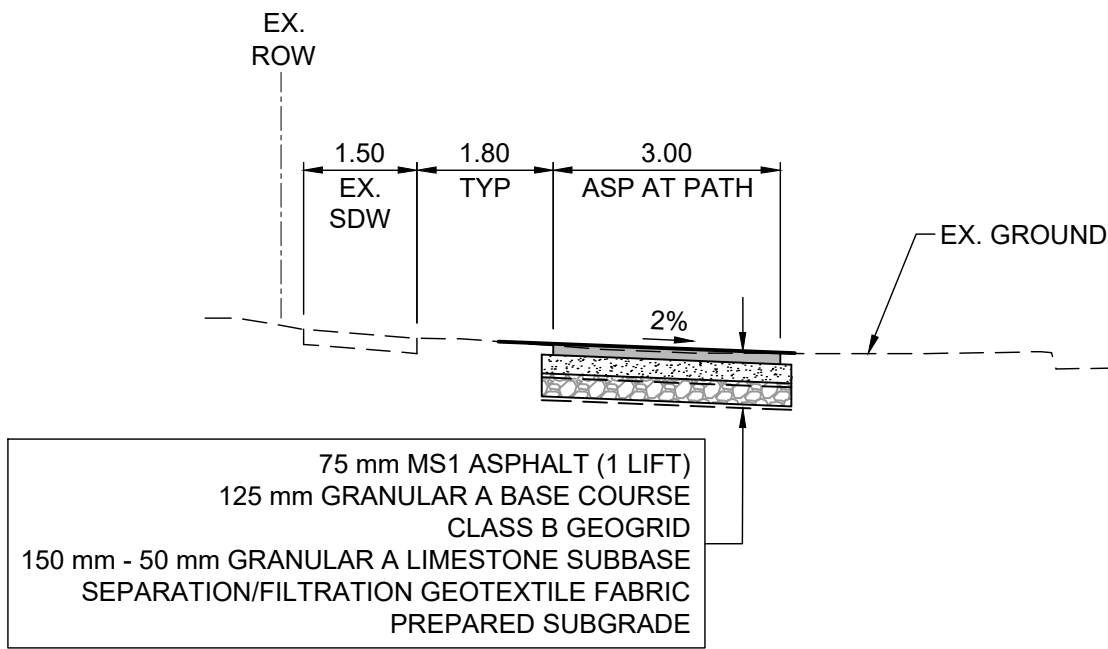
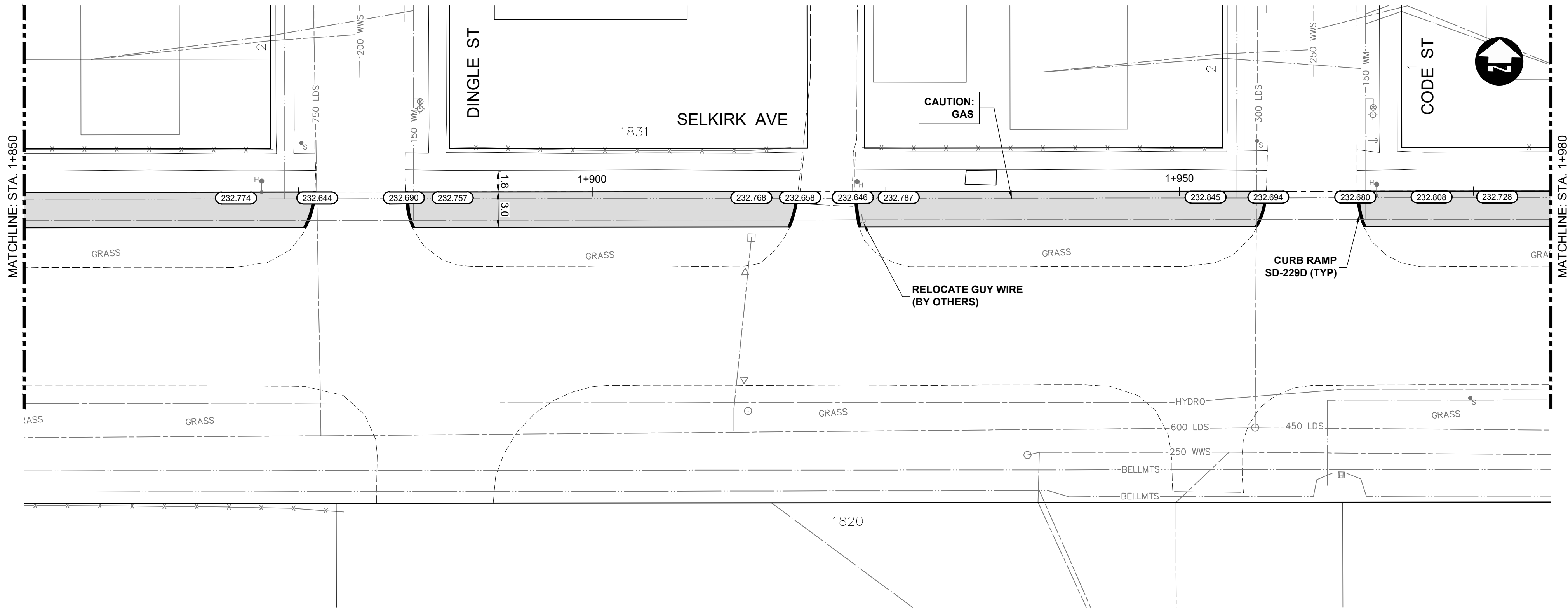

**TYPICAL SECTION - AT PATH IN BOULEVARD**  
SCALE: H:100, V:1:50

## METRIC

WHOLE NUMBERS INDICATE MILLIMETRES  
DECIMALIZED NUMBERS INDICATE METRES

	HYDRANT			WATERMAIN			CONCRETE ROAD
	VALVE			LAND DRAINAGE SEWER			ASPHALT ROAD
	CURB STOP			WASTE WATER SEWER			CONC ROAD W/ASP OVERLAY
	LIGHT STANDARD			HYDRO			CONCRETE SIDEWALK
	HYDRO POLE			BELLMTS			ASPHALT PATH
	TREE			GAS			PAVEMENT REPAIR FABRIC
	GEODETIC BENCH MARK			TRAFFIC SIGNALS			GRASS/SOD
	SURVEY BAR			STREET LIGHTS			ELEVATION
	MANHOLE			TRAFFIC SIGNAL POLE			PROPERTY LINE
	CATCH BASIN			PAVING STONE			CURB RAMP
	CATCH PIT			CURB RENEWAL			DETECTABLE TILE
	EXISTING			EXISTING			EXISTING
	LEGEND-PLAN			LEGEND-PLAN			LEGEND-PLAN

## UNDERGROUND STRUCTURES

SUPPLY: U/G STRUCTURES DATE

LOCATION OF UNDERGROUND STRUCTURES AS SHOWN ARE BASED ON THE BEST INFORMATION AVAILABLE, BUT NO GUARANTEE IS GIVEN THAT ALL EXISTING UTILITIES ARE SHOWN OR THAT THE GIVEN LOCATIONS ARE EXACT. CONFIRMATION OF EXISTENCE AND EXACT LOCATION OF ALL SERVICES MUST BE OBTAINED FROM THE INDIVIDUAL UTILITIES BEFORE PROCEEDING WITH CONSTRUCTION.

B.M. ELEV.	DESIGNED BY	TJH
	DRAWN BY	HDT
	CHECKED BY	LAS
	APPROVED BY	DBW
	HOR. SCALE	1:250
	VERTICAL	1:10
0	ISSUED FOR TENDER	26/03/27
NO.	REVISIONS	DATE BY

DESIGNED BY	TJH
DRAWN BY	HDT
CHECKED BY	LAS
APPROVED BY	DBW
HOR. SCALE	1:250
VERTICAL	1:10
DATE	

RELEASED FOR CONSTRUCTION
DATE

ENGINEER'S SEAL
CONSULTANT PROJECT NUMBER
25-2151

	<b>THE CITY OF WINNIPEG</b> PUBLIC WORKS DEPARTMENT
<b>2026 LOCAL STREET RENEWALS PROGRAM</b>	CITY DRAWING NUMBER
SELKIRK AVENUE OAK POINT HWY TO KEEWATIN ST	SHEET 33 OF 55
AT PATHWAY (8 OF 10)	TENDER NUMBER
	136-2026