

C:\dw_working_directory\projects_2025\dillon_401h\cims9539\250151-CT-CO-CON-STAGING.dwg

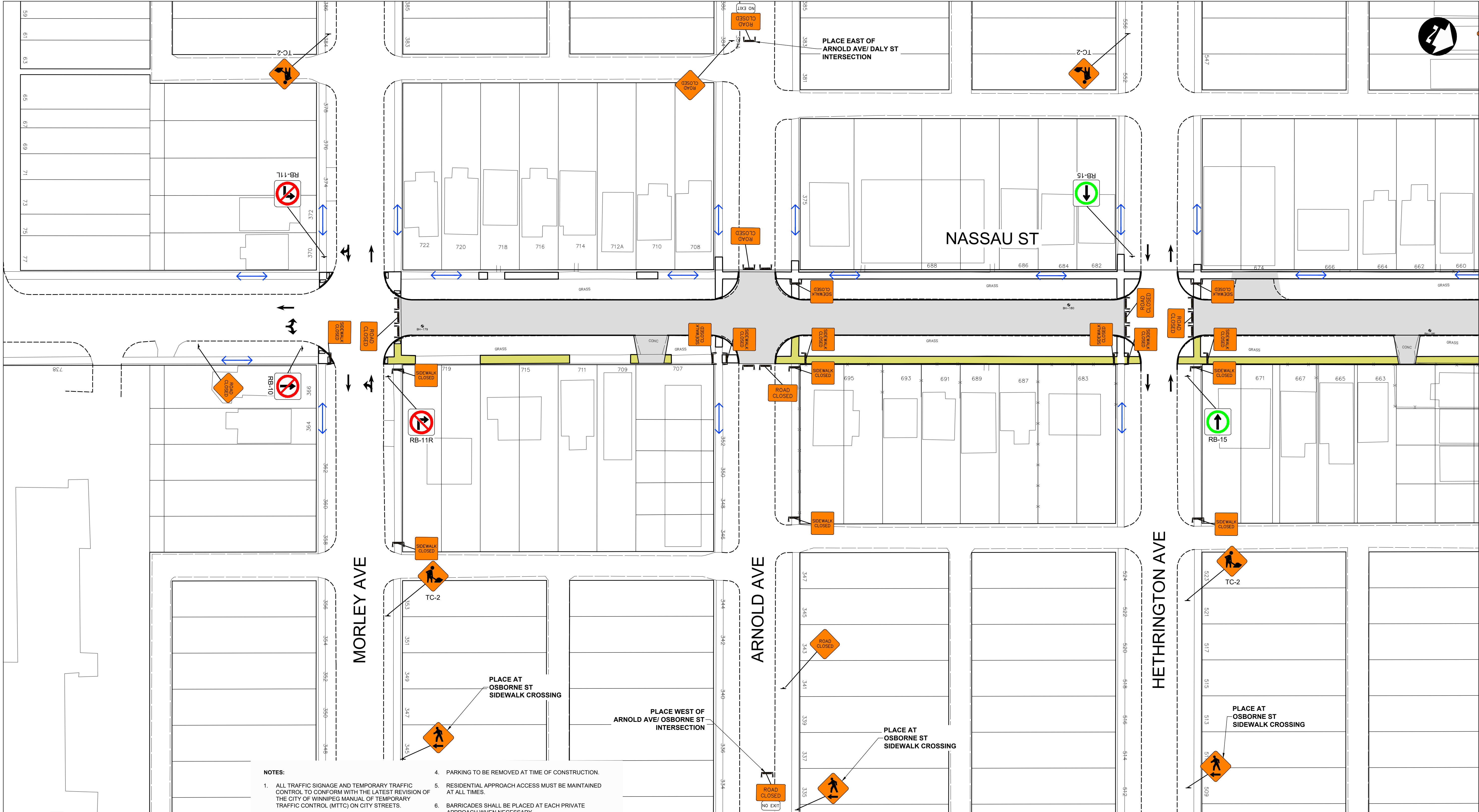

- NOTES:**
- ALL TRAFFIC SIGNAGE AND TEMPORARY TRAFFIC CONTROL TO CONFORM WITH THE LATEST REVISION OF THE CITY OF WINNIPEG MANUAL OF TEMPORARY TRAFFIC CONTROL (MTTC) ON CITY STREETS.
 - CONTRACTOR SHALL MAINTAIN SAFE PEDESTRIAN ACCESS AND CROSSINGS, WHERE SIDEWALKS ARE LOCATED ON BOTH SIDES OF THE STREET, CONTRACTOR MUST MAINTAIN PEDESTRIAN ACCESS ON ONE SIDE AT ALL TIMES.
 - WHERE APPLICABLE, CONSTRUCTION IS TO BE COMPLETED LANE AT A TIME. WHEN CONSTRUCTION IS COMPLETE IN THE FIRST LANE, TRAFFIC WILL BE MOVED TO THE COMPLETED LANE AND TRAFFIC CONTROL MIRRORED.
 - PARKING TO BE REMOVED AT TIME OF CONSTRUCTION.
 - RESIDENTIAL APPROACH ACCESS MUST BE MAINTAINED AT ALL TIMES.
 - BARRICADES SHALL BE PLACED AT EACH PRIVATE APPROACH WHEN NECESSARY.
 - BARRICADES AND POLY POSTS SHALL BE PLACED AT REQUIRED SPACING AS PER MTTC.
 - ADVANCED SIDEWALK CLOSURE SIGNS TO BE PLACED AS PER MTTC.
 - ALL SIDEWALK CLOSED BARRICADES SHALL BE INSTALLED WITH A BOTTOM BARRIER IN ACCORDANCE WITH THE MTTC.

METRIC

WHOLE NUMBERS INDICATE MILLIMETRES
DECIMALIZED NUMBERS INDICATE METRES

- LEGEND - STAGING**
- | | | | |
|--|-------------------------------------|--|--|
| | PERMANENT ROADWAY CONSTRUCTION | | REFLECTORIZED LIGHT BARRICADE (TC-64A) |
| | PERMANENT SIDEWALK/MUP CONSTRUCTION | | PEDESTRIAN CHANNELIZATION DEVICE |
| | TALL CONE | | VEHICULAR TRAFFIC |
| | CHANNELIZATION BARREL (TC-63) | | PEDESTRIAN/CYCLIST TRAFFIC |

UNDERGROUND STRUCTURES		B.M. ELEV.	DESIGNED BY DRC		ENGINEER'S SEAL	THE CITY OF WINNIPEG PUBLIC WORKS DEPARTMENT	
SUPPLY: U/G STRUCTURES		DATE	DRAWN BY DRC				
			CHECKED BY LAS				
			APPROVED BY DBW				
LOCATION OF UNDERGROUND STRUCTURES AS SHOWN ARE BASED ON THE BEST INFORMATION AVAILABLE, BUT NO GUARANTEE IS GIVEN THAT ALL EXISTING UTILITIES ARE SHOWN OR THAT THE GIVEN LOCATIONS ARE EXACT. CONFIRMATION OF EXISTENCE AND EXACT LOCATION OF ALL SERVICES MUST BE OBTAINED FROM THE INDIVIDUAL UTILITIES BEFORE PROCEEDING WITH CONSTRUCTION.			HOR. SCALE 1:400	RELEASED FOR CONSTRUCTION	CONSULTANT PROJECT NUMBER 25-2151	2026 LOCAL STREET RENEWALS PROGRAM TRAFFIC STAGING NASSAU STREET (1 OF 2)	
			VERTICAL -				
NO. REVISIONS		DATE	BY	DATE	DATE	CITY DRAWING NUMBER SHEET 37 OF 55 TENDER NUMBER 136-2026	