

**WATER SERVICE INFORMATION**

ADDRESS	SIZE (mm) MATERIAL (STREET)	SIZE (mm) MATERIAL (PROP.)	SHORT & LONG MEASUREMENT	CORP LOCATION	REMARKS
1409 SOMERVILLE AVE	20	-	5.38 EWL HSE	0.1 E OF S/C	RECONNECT SERVICE
RESIDENTIAL	CU	-	92.310 WML BEAUMONT ST	-	-
1410 SOMERVILLE AVE	20	20	3.00 WEL HSE	1.9 W OF S/C	RECONNECT SERVICE
RESIDENTIAL	CU	CU	90.900 WML BEAUMONT ST	-	-
1411 SOMERVILLE AVE	20	-	5.25 WEL HSE	0.1 E OF S/C	RECONNECT SERVICE
RESIDENTIAL	CU	-	106.070 WML BEAUMONT ST	-	-
1412 SOMERVILLE AVE	-	-	5.87 WEL HSE	0.3 E OF S/C	RECONNECT SERVICE
RESIDENTIAL	-	-	109.190 WML BEAUMONT ST	-	-
1413 SOMERVILLE AVE	-	-	7.33 WEL HSE	0.9 W OF S/C	RECONNECT SERVICE
RESIDENTIAL	-	-	130.450 WML BEAUMONT ST	-	-
1414 SOMERVILLE AVE	20	-	3.67 WEL HSE	1.8 W OF S/C	RECONNECT SERVICE
RESIDENTIAL	CU	-	130.180 WML BEAUMONT ST	-	-
1415 SOMERVILLE AVE	20	-	4.84 WEL HSE	2.6 W OF S/C	RENEW TO R W/20 CU
RESIDENTIAL	CU	-	147.730 WML BEAUMONT ST	-	-
1416 SOMERVILLE AVE	20	-	3.85 WEL HSE	4.0 E OF S/C	RECONNECT SERVICE
RESIDENTIAL	CU	-	149.290 WML BEAUMONT ST	-	-
1417 SOMERVILLE AVE	20	-	3.77 WEL HSE	0.6 W OF S/C	RENEW TO R W/20 CU
RESIDENTIAL	CU	-	153.500 EEL PLANET ST	-	-
1418 SOMERVILLE AVE	20	-	5.16 WEL HSE	1.0 W OF S/C	RENEW TO R W/20 CU
RESIDENTIAL	CU	-	150.350 EEL PLANET ST	-	-
1419 SOMERVILLE AVE	20	-	4.00 WEL HSE	0.8 W OF S/C	RECONNECT SERVICE
RESIDENTIAL	CU	-	134.410 EEL PLANET ST	-	-
1420 SOMERVILLE AVE	20	-	3.12 WEL HSE	0.2 E OF S/C	RECONNECT SERVICE
RESIDENTIAL	CU	-	135.550 EEL PLANET ST	-	-

\* SERVICES TO BE RENEWED TO R. ALL OTHERS TO BE RECONNECTED

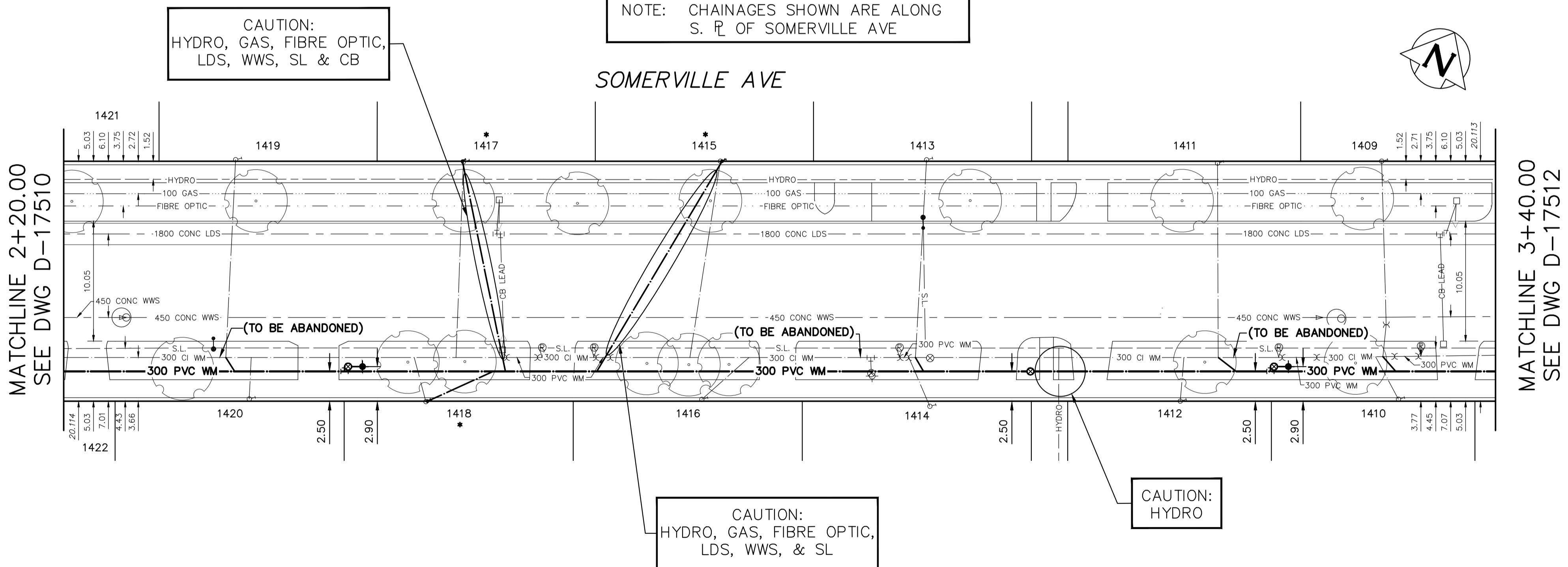

MATCHLINE 2+20.00  
SEE DWG D-17510

MATCHLINE 3+40.00  
SEE DWG D-17512

FOR INDEX SEE  
D-17504

NOTE: ALL VALVES TO BE INSTALLED  
CLOCKWISE TO CLOSE

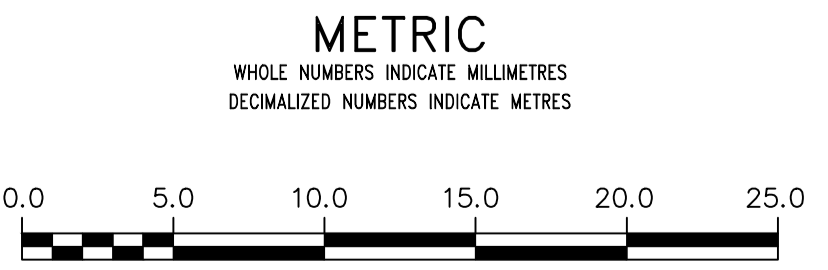

**WARNING**  
IF POWER EQUIPMENT OR EXPLOSIVES ARE TO BE USED FOR EXCAVATION ON THIS PROJECT THE CONTRACTOR MUST:  
1) NOTIFY THE GAS COMPANY OF THE PROPOSED LOCATION OF EXCAVATION.  
2) TAKE PRECAUTION TO AVOID DAMAGE TO GAS COMPANY INSTALLATIONS.  
SEE PROVINCIAL REGULATION 210/72 FOR DETAILS

**LOCATION APPROVED UNDERGROUND STRUCTURES**  
SUPPLY U/G STRUCTURES COMMITTEE DATE  
NOTE:  
LOCATION OF UNDERGROUND STRUCTURES AS SHOWN ARE BASED ON THE BEST INFORMATION AVAILABLE BUT NO GUARANTEE IS GIVEN THAT ALL EXISTING UTILITIES ARE SHOWN OR THAT THE GIVEN LOCATIONS ARE EXACT. CONFIRMATION OF EXISTENCE AND EXACT LOCATION OF ALL UTILITIES MUST BE OBTAINED FROM THE INDIVIDUAL UTILITIES BEFORE PROCEEDING WITH CONSTRUCTION.

VERTICAL DATUM: CGVD28 (HT2.0 Geoid)			
HORIZONTAL DATUM: NAD83 (June 1990), Zone 14			
NO.	ISSUED FOR TENDER	DATE	BY
0	ISSUED FOR TENDER	2026/04/21	SC
NO.	REVISIONS	DATE	BY

DESIGNED BY	MA	CHECKED BY	MA
DRAWN BY	JD	APPROVED BY	SC
SCALE:		RELEASED FOR CONSTRUCTION	
HORIZONTAL	1:250		
VERTICAL	1:50		
DATE	2026 04 20	DATE	

ENGINEER'S SEAL  
CONSULTANT DRAWING NUMBER

**THE CITY OF WINNIPEG**  
WATER AND WASTE DEPARTMENT  
ENGINEERING DIVISION

2026 WATER MAIN RENEWALS  
CONTRACT 3  
SOMERVILLE AVENUE  
120 E PLANET STREET TO  
240 E OF PLANET STREET

SHEET 9 OF 11  
CITY DRAWING NUMBER  
D-17511