

HERBERT AVENUE

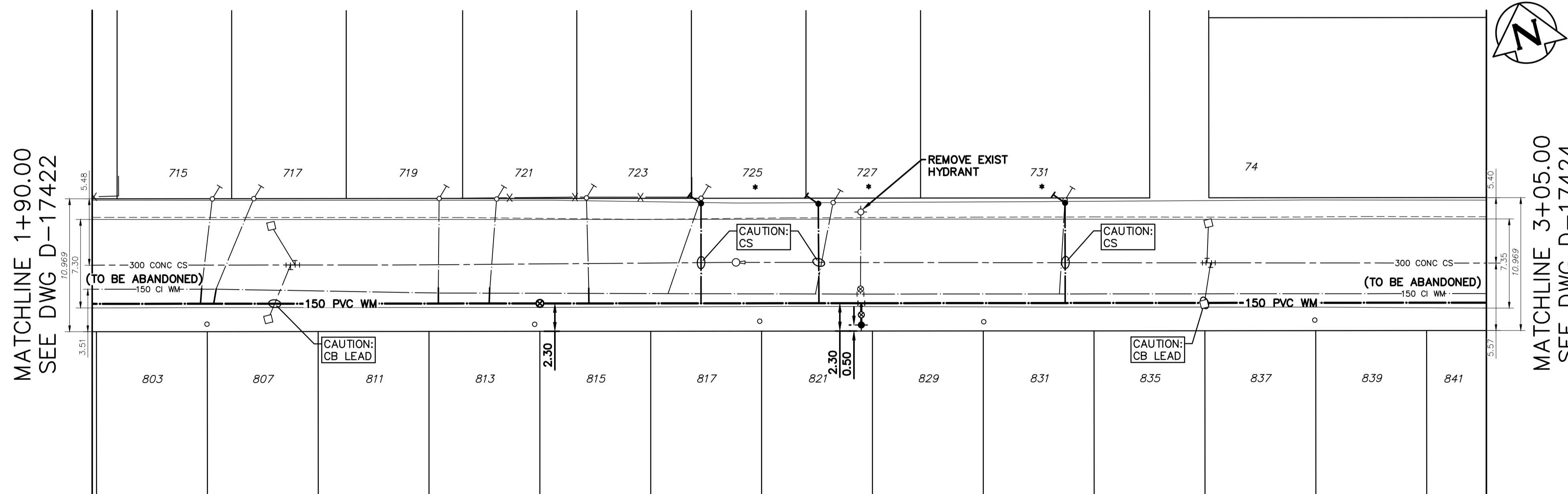

| WATER SERVICE INFORMATION     |                             |                            |  |               |                   |
|-------------------------------|-----------------------------|----------------------------|--|---------------|-------------------|
| ADDRESS                       | SIZE (mm) MATERIAL (STREET) | SIZE (mm) MATERIAL (PROP.) | SHORT & LONG MEASUREMENT                 | CORP LOCATION | REMARK            |
| 715 HERBERT AVE RESIDENTIAL   | -                           | 20 CU                      | 1.82 WEL HSE 0.30 SL HSE FRONT           | -             | RECONNECT SERVICE |
| 717 HERBERT AVE RESIDENTIAL   | 20 CU                       | 20 CU                      | 1.50 WWL HOUSE 166.00 E 1ST HYD W CAMERO | 9.0 W OF S/C  | RECONNECT SERVICE |
| 719 HERBERT AVE RESIDENTIAL   | 20 CU                       | 20 CU                      | 2.10 WELL                                | OPP S/C       | RECONNECT SERVICE |
| 721 HERBERT AVE RESIDENTIAL   | 20 CU                       | 20 CU                      | 2.92 EWPL                                | 0.3 W OF S/C  | RECONNECT SERVICE |
| 723 HERBERT AVE RESIDENTIAL   | 20 CU                       | 20 CU                      | 0.76 WW HSE LINE 7.31 OUT                | 0.6 E WL #723 | RECONNECT SERVICE |
| * 725 HERBERT AVE RESIDENTIAL | 20 LEAD                     | 20 LEAD                    | 3.00 EWL HSE 40.00 W 1ST HYD W CAMERON   | 8.0 W OF S/C  | RENEW TO P/L      |
| * 727 HERBERT AVE RESIDENTIAL | 12 LEAD                     | 12 LEAD                    | 4.00 EWL HSE 177.00 WWL CAMERON          | OPP S/C       | RENEW TO P/L      |
| * 731 HERBERT AVE RESIDENTIAL | 12 LEAD                     | 12 LEAD                    | 10.00 EWL HSE 379.00 WWL GREEN           | 1.0 W OF S/C  | RENEW TO P/L      |

\* SERVICES TO BE RENEWED TO P/L. ALL OTHER TO BE RECONNECTED

NOTE: CHAINAGES SHOWN ARE ALONG S. P/L OF HERBERT AVENUE

NOTE: VALVES TO BE INSTALLED COUNTER-CLOCKWISE TO CLOSE

FOR INDEX SEE D-17414



METRIC  
WHOLE NUMBERS INDICATE MILLIMETRES  
DECIMALIZED NUMBERS INDICATE METRES

**ENGINEERS GEOSCIENTISTS MANITOBA**  
Certificate of Authorization  
Stantec Consulting Ltd.  
No. 1301

LOCATION APPROVED  
UNDERGROUND STRUCTURES

SUPV. U/G STRUCTURES COMMITTEE DATE

NOTE:  
LOCATION OF UNDERGROUND STRUCTURES AS SHOWN ARE BASED ON THE BEST INFORMATION AVAILABLE BUT NO GUARANTEE IS GIVEN THAT ALL EXISTING UTILITIES ARE SHOWN OR THAT THE GIVEN LOCATIONS ARE EXACT. CONFIRMATION OF EXISTENCE AND EXACT LOCATION OF ALL SERVICES MUST BE OBTAINED FROM THE INDIVIDUAL UTILITIES BEFORE PROCEEDING WITH CONSTRUCTION.

VERTICAL DATUM:  
HORIZONTAL DATUM:

| NO. | REVISIONS         | DATE       | BY |
|-----|-------------------|------------|----|
| 00  | ISSUED FOR TENDER | 2026.03.16 | RS |

**Stantec**

DESIGNED BY: RS  
CHECKED BY: RS

DRAWN BY: MR  
APPROVED BY: RS

SCALE:  
HORIZONTAL 1:250  
VERTICAL 1:50

DATE: 2026.01.21

RELEASED FOR CONSTRUCTION  
S. COURNOYER  
DATE: 2026.03.13

ENGINEER'S SEAL

CONSULTANT DRAWING NUMBER  
**C-209**

**THE CITY OF WINNIPEG**  
WATER AND WASTE DEPARTMENT  
ENGINEERING DIVISION

2026 WATER MAIN RENEWALS  
CONTRACT 2  
HERBERT AVENUE  
90 E OF FOSTER STREET TO  
205 E OF FOSTER STREET

SHEET 11 OF 19  
CITY DRAWING NUMBER  
**D-17423**