

- CONSTRUCTION NOTES:**
- ALL WORK AND MATERIALS TO BE IN ACCORDANCE WITH LATEST REVISION OF THE CITY OF WINNIPEG STANDARD CONSTRUCTION SPECIFICATIONS.
  - LEGAL PLAN AND UNDERGROUND INFORMATION FROM CITY OF WINNIPEG LBIS.
  - LOCATION OF EXISTING UTILITIES/SERVICES TO BE CONFIRMED IN THE FIELD BY THE CONTRACTOR.
  - CONTRACTOR TO TAKE PRECAUTIONARY STEPS TO AVOID DAMAGE FROM CONSTRUCTION ACTIVITIES TO TREES WITHIN THE LIMITS OF CONSTRUCTION. REFER TO SPECIFICATION E5-PROTECTION OF EXISTING TREES.
  - MILL EXIST MOUNTABLE CURB AND CONSTRUCT BARRIER CURB DOWELED SD-205 (100 mm REVEAL).
  - REMOVE EXISTING CURB AND CONSTRUCT MODIFIED BARRIER CURB SD-203B (100 mm REVEAL).
  - CONSTRUCT 75 mm LIP CURB SD-202B.
  - OVERLAY EXISTING CURB AND APPROACH WITH ASPHALT TO LIMITS SHOWN.
  - REGRADE EXISTING PAVING STONES.
  - REMOVE MOUNTABLE CURB AND GUTTER FRAME AND COVER AP-015, AP-016, AND INSTALL BARRIER CURB FRAME AND COVER AP-011, AP-012. ADJUST TO GRADE. COMPLETE CATCH BASIN/CATCH PIT CURB ISOLATIONS IN ACCORDANCE WITH SD-220E.
  - ADJUST MANHOLE AND CATCH BASIN RIMS TO NEW GRADES.
  - ADJUST WATER VALVES AND CURB STOPS TO NEW GRADES.
  - REMOVE EXISTING STREET LIGHT POLE AND BASE.
  - INSTALL NEW STREET LIGHT BASE AND POLE.
  - CB AND CP LEADS TO BE INSTALLED TO INVERT ELEVATIONS AS SHOWN. ALL CB AND CP LEADS TO BE INSTALLED AT MIN 2.0% SLOPE AND AS DIRECTED BY CONTRACT ADMINISTRATOR.
  - LIMITS OF BOULEVARD GRADING TO BE FINALIZED IN THE FIELD BY THE CONTRACT ADMINISTRATOR.
  - LAMP STANDARDS, HYDRO POLES AND ANCHORS THAT REQUIRE TEMPORARY SUPPORT, REMOVAL OR REPLACEMENT, TO BE DONE AT THE EXPENSE OF THE CONTRACTOR, AS NECESSARY. REFER TO SPECIFICATION E30-WORKING AROUND MANITOBA HYDRO POLES.
  - ALL DIMENSIONS ARE TO BACK OF CURB.

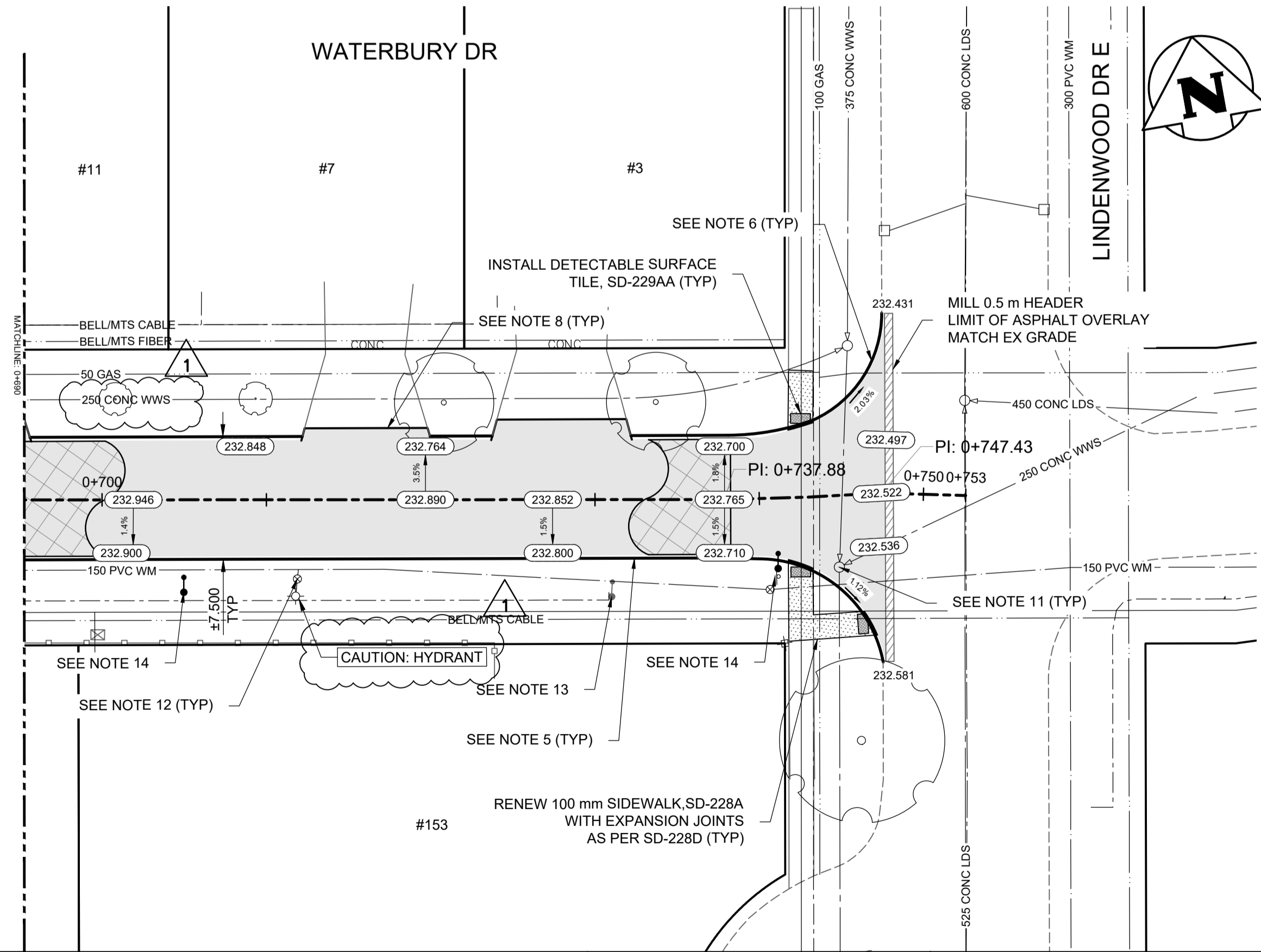

**METRIC**

WHOLE NUMBERS INDICATE MILLIMETRES  
DECIMALIZED NUMBERS INDICATE METRES

**WARNING**

IF POWER EQUIPMENT OR EXPLOSIVES ARE TO BE USED FOR EXCAVATION ON THIS PROJECT THE CONTRACTOR MUST:

- NOTIFY THE GAS COMPANY OF THE PROPOSED LOCATION OF EXCAVATION.
- TAKE PRECAUTION TO AVOID DAMAGE TO GAS COMPANY INSTALLATIONS SEE PROVINCIAL REGULATION 210/72 FOR DETAILS.
- OBTAIN EXCAVATION PERMITS PRIOR TO CONSTRUCTION.

**ENGINEERS  
GEOLOGISTS  
MANITOBA**  
Certificate of Authorization  
Tetra Tech Canada Inc.  
No. 6499

○	HYDRANT	◆	CONCRETE	150 WM	WATERMAIN	150 WM
⊗	VALVE	⊗	ASPHALT	300 LDS	LAND DRAINAGE SEWER	300 LDS
○	MANHOLE	●	SIDEWALK	250 WWS	WASTE WATER SEWER	250 WWS
□	CATCH BASIN	■	PAVING STONES	+	HYDRANT	+
▽	CATCH PIT	▼	PAVEMENT REPAIR FABRIC	⊗	VALVE	⊗
150 WM	WATERMAIN	150 WM	PARTIAL DEPTH REPAIR	—	Q PROFILE	—
300 LDS	LAND DRAINAGE SEWER	300 LDS	PROPERTY LINE	□	NORTH/WEST GUTTER	—
250 WWS	WASTE WATER SEWER	250 WWS	ELEVATION	(232.000)	SOUTH/EAST GUTTER	—
HYDRO	HYDRO	HYDRO	CURB RAMP	—	NORTH/WEST DITCH	—
MTS	M.T.S.	MTS	DETECTABLE TILE	—	SOUTH/EAST DITCH	—
100 GAS	GAS	100 GAS				
EXISTING	LEGEND-PLAN	PROPOSED	EXISTING	LEGEND-PLAN	PROPOSED	EXISTING
				LEGEND-PROFILE	PROPOSED	

**UNDERGROUND STRUCTURES**

LOCATION OF UNDERGROUND STRUCTURES AS SHOWN ARE BASED ON THE BEST INFORMATION AVAILABLE. BUT NO GUARANTEE IS GIVEN THAT ALL EXISTING UTILITIES ARE SHOWN OR THAT THE GIVEN LOCATIONS ARE EXACT. CONFIRMATION OF EXISTENCE AND EXACT LOCATION OF ALL SERVICES MUST BE OBTAINED FROM THE INDIVIDUAL UTILITIES BEFORE PROCEEDING WITH CONSTRUCTION.

B.M. ELEV.			
1	ISSUED FOR ADDENDUM 1	26.03.27	JNC
0	ISSUED FOR TENDER	26.03.17	JNC
NO.	REVISIONS	DATE	BY

**TETRA TECH**

DESIGNED BY	KHL	REVIEWED BY	JT/DL/JNC
DRAWN BY	KHL	APPROVED BY	JNC
SCALE:	H = 1:250	RELEASED FOR CONSTRUCTION	
	V = 1:10	STREETS PROJECT ENGINEER	
DATE	26.03.17	DATE	

ORIGINAL DRAWING  
REVISION "0" SEALED BY  
J.N. CRANG  
26.03.17

**THE CITY OF WINNIPEG  
PUBLIC WORKS DEPARTMENT**

2026 LOCAL STREET RENEWAL PROGRAM  
26-R-03

MAJOR REHABILITATION  
WATERBURY DRIVE (STA 0+690 TO LINDENWOOD DRIVE E)  
PLAN AND PROFILE

CITY DRAWING NUMBER  
P-3599-22  
SHEET OF  
22 28  
C022

CONSULTANT DRAWING NO.  
704-INF.MB103048-01-C022