

- CONSTRUCTION NOTES:**
- ALL WORK AND MATERIALS TO BE IN ACCORDANCE WITH LATEST REVISION OF THE CITY OF WINNIPEG STANDARD CONSTRUCTION SPECIFICATIONS.
  - LEGAL PLAN AND UNDERGROUND INFORMATION FROM CITY OF WINNIPEG LBIS.
  - LOCATION OF EXISTING UTILITIES/SERVICES TO BE CONFIRMED IN THE FIELD BY THE CONTRACTOR.
  - CONTRACTOR TO TAKE PRECAUTIONARY STEPS TO AVOID DAMAGE FROM CONSTRUCTION ACTIVITIES TO TREES WITHIN THE LIMITS OF CONSTRUCTION. REFER TO SPECIFICATIONS E5 AND E27.
  - RENEW BARRIER CURB AND GUTTER SD-200 WHERE SHOWN ON THE DRAWINGS AND AS DIRECTED BY THE CONTRACT ADMINISTRATOR.
  - CONSTRUCT MODIFIED BARRIER CURB AND GUTTER (100mm REVEAL)
  - ADJUST ALL WATER VALVES, MANHOLES, CATCH PITS, CURB INLETS, CATCH BASIN RIMS, AND WATER SHUT OFF VALVES TO NEW GRADES. MANHOLE AND CATCH PIT ISOLATIONS AS PER SD-220G/SD-220E, RESPECTIVELY.
  - ABANDON CATCH BASIN, CATCH PIT, AND CATCH INLET
  - SIDEWALK RENEWAL LOCATIONS TO BE FINALIZED IN THE FIELD BY THE CONTRACT ADMINISTRATOR. PROVIDE 13mm SIDEWALK EXPANSION JOINTS AS PER SD-228AA AS LAID OUT BY THE CONTRACT ADMINISTRATOR.
  - ALL PRIVATE SIDEWALKS TO BE ADJUSTED TO NEW SIDEWALK OR TOP OF CURB ELEVATIONS AS REQUIRED. SIDEWALKS TO BE REPLACED WITH LIKE MATERIALS.
  - CB LEADS AND CP LEADS TO BE INSTALLED TO INVERT ELEVATIONS AS SHOWN. ALL CB AND CP LEADS TO BE INSTALLED AT MIN 2.0% SLOPE AND AS DIRECTED BY CONTRACT ADMINISTRATOR.
  - LIMITS OF BOULEVARD GRADING TO BE FINALIZED IN THE FIELD BY THE CONTRACT ADMINISTRATOR.
  - CONTRACTOR TO CONFIRM LOCATION AND LIMITS OF SEWER REPAIRS AS INDICATED ON THE DRAWINGS BY PERFORMING VIDEO INSPECTION AND REVIEWING WITH THE CONTRACT ADMINISTRATOR PRIOR TO CONSTRUCTION.
  - LAMP STANDARDS, HYDRO POLES AND ANCHORS THAT REQUIRE TEMPORARY SUPPORT, REMOVAL OR REPLACEMENT, TO BE DONE AT THE EXPENSE OF THE CONTRACTOR, AS NECESSARY. REFER TO SPECIFICATION E30 AND E36.
  - COMPLETE CATCH BASIN/CATCH PIT CURB ISOLATIONS IN ACCORDANCE WITH SD-220E
  - COVER PARTIAL AND FULL DEPTH ASPHALT REPAIRS WITH PAVEMENT REPAIR FABRIC EXTENDING 150mm AROUND PERIMETER OF REPAIR AS PER E13.
  - CONSTRUCT PARTIAL/FULL DEPTH ASPHALT PAVEMENT REPAIR AS DETAILED IN SECTION 2
  - ADJUST PRECAST SIDEWALK BLOCKS AS DIRECTED BY THE CA.
  - CONSTRUCT SPEED TABLES AS PER DETAIL IN DWG 025 AND E34.
  - UPGRADE TRANSIT STOP.
  - ALL DIMENSIONS ARE TO BACK OF CURB.
  - ALL PIPE UNDER EXISTING AND FUTURE PAVEMENT TO BE INSTALLED USING TRENCHLESS METHODS. WHERE NOT POSSIBLE, OPEN CUT WITH CLASS 2 BACKFILL.
  - ALL TRENCHES AND EXCAVATION FOR UNDER GROUND WORKS WITHIN 1 METRE OF A PAVED AREA INCLUDING SIDEWALKS SHALL BE CLASS 3 BACKFILL, (FLOODED, JETTED AND TAMPED) UNLESS OTHERWISE NOTED.
  - ALL BACKFILL UNDER BOULEVARD TO BE CLASS 4 UNLESS OTHERWISE NOTED.

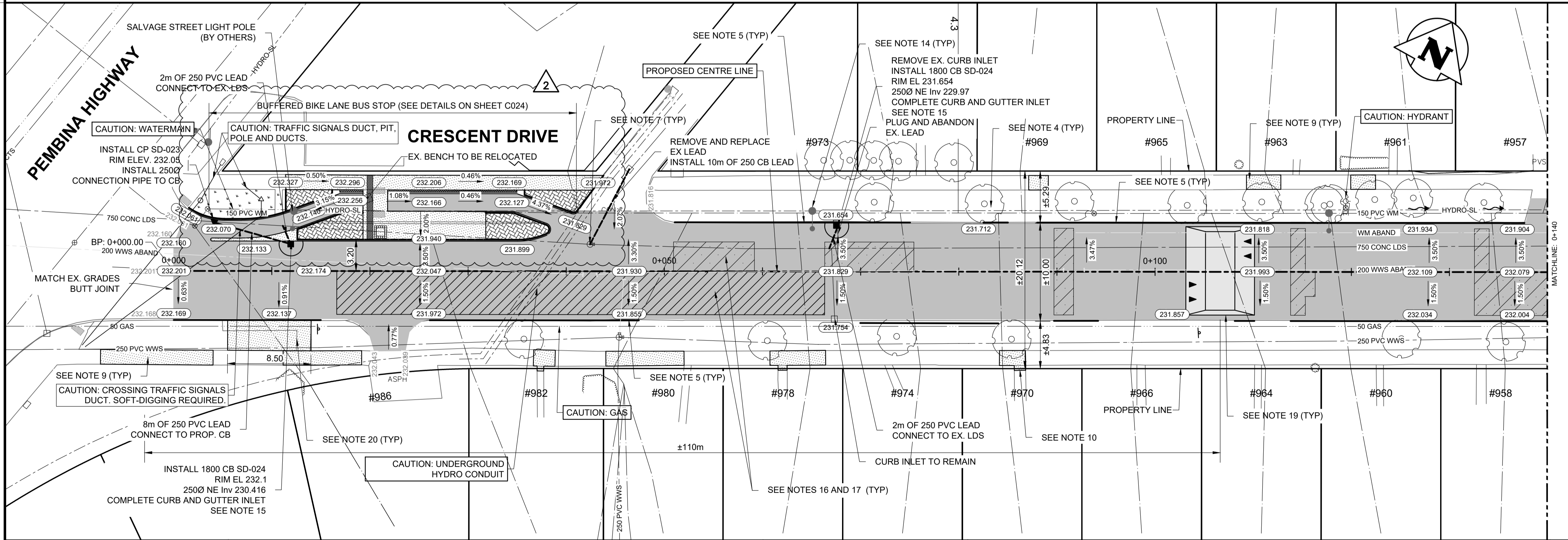
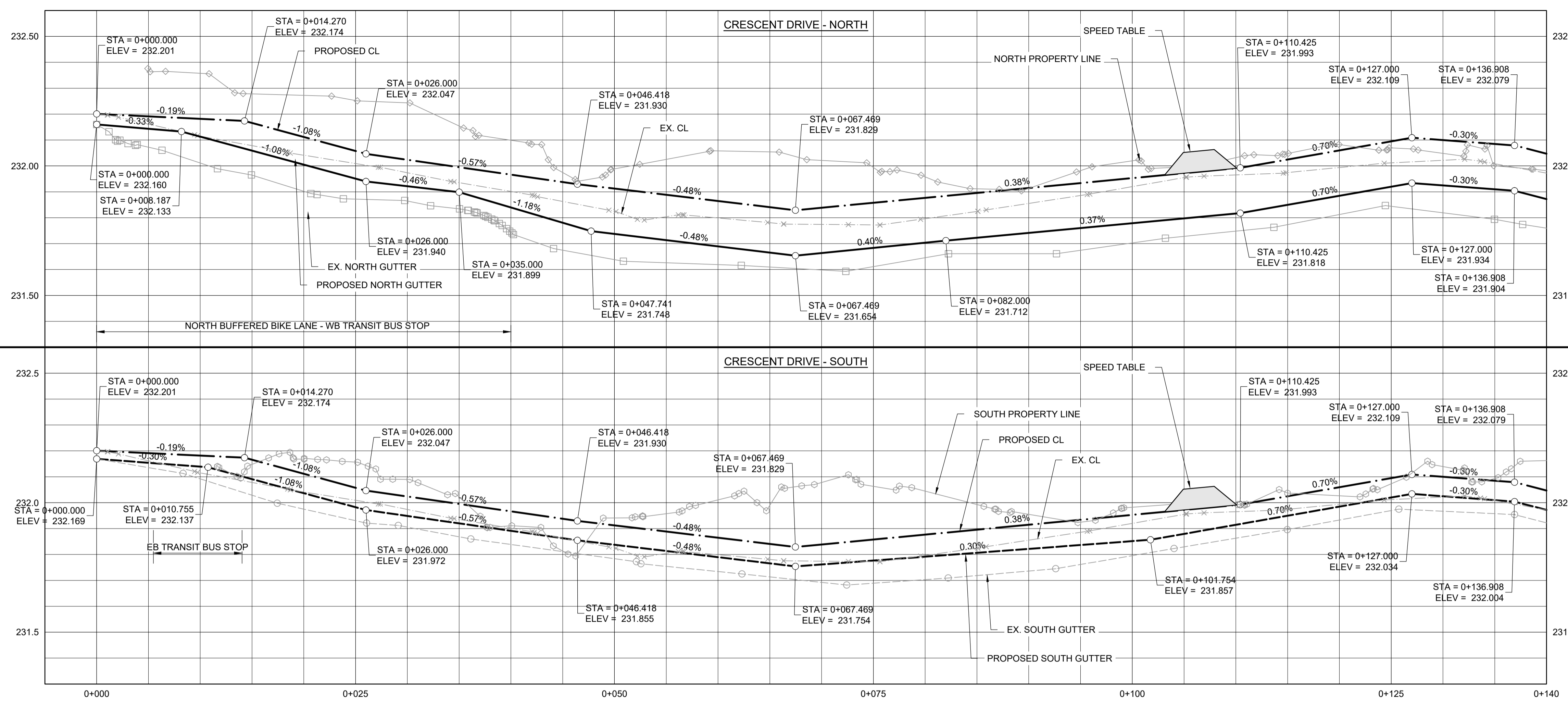

○	HYDRANT	●	CONCRETE	—	150 WM	—	WATERMAIN	—	150 WM
⊗	VALVE	▨	ASPHALT	—	300 LDS	—	LAND DRAINAGE SEWER	—	300 LDS
○	MANHOLE	▩	SIDEWALK	—	250 WWS	—	WASTE WATER SEWER	—	250 WWS
□	CATCH BASIN	▩	PAVING STONES	—	250 WWS	—	HYDRANT	—	+
▽	CATCH PIT	▩	PARTIAL DEPTH REPAIR	—	250 WWS	—	VALVE	—	+
—	WATERMAIN	▩	FULL DEPTH REPAIR	—	250 WWS	—	PROPERTY LINE	—	—
—	300 LDS	▩	PROPERTY LINE	—	250 WWS	—	ELEVATION	—	(232.000)
—	250 WWS	▩	ELEVATION	—	250 WWS	—	CURB RAMP	—	—
—	250 WWS	▩	DETECTABLE TILE	—	250 WWS	—	—	—	—
—	HYDRO	▩	—	—	250 WWS	—	—	—	—
—	MTS	▩	—	—	250 WWS	—	—	—	—
—	100 GAS	▩	—	—	250 WWS	—	—	—	—
—	—	▩	—	—	250 WWS	—	—	—	—

—	EXISTING	—	LEGEND—PLAN	—	PROPOSED	—	EXISTING	—	LEGEND—PROFILE	—	PROPOSED
---	----------	---	-------------	---	----------	---	----------	---	----------------	---	----------

LOCATION OF UNDERGROUND STRUCTURES AS SHOWN ARE BASED ON THE BEST INFORMATION AVAILABLE. BUT NO GUARANTEE IS GIVEN THAT ALL EXISTING UTILITIES ARE SHOWN OR THAT THE GIVEN LOCATIONS ARE EXACT. CONFIRMATION OF EXISTENCE AND EXACT LOCATION OF ALL SERVICES MUST BE OBTAINED FROM THE INDIVIDUAL UTILITIES BEFORE PROCEEDING WITH CONSTRUCTION.

**TETRA TECH**

DESIGNED BY: CF

REVIEWED BY: JT/DL/JNC

APPROVED BY: JNC

SCALE: H = 1:250, V = 1:10

RELEASED FOR CONSTRUCTION

STREETS PROJECT ENGINEER

DATE: 26.03.17

ORIGINAL DRAWING REVISION "0" SEALED BY J.N. CRANG 26.03.17

CONSULTANT DRAWING NO. 704-INF.003048-01-DWG-C001

**THE CITY OF WINNIPEG**

**PUBLIC WORKS DEPARTMENT**

2026 LOCAL STREET RENEWAL PROGRAM

26-R-03

ASPHALT REHABILITATION CRESCENT DR. (PEMBINA HWY TO STA 0+140)

CITY DRAWING NUMBER P-3599-1

SHEET OF 01 28

C001

ENGINEERS GEOSCIENTISTS MANITOBA

Certificate of Authorization Tetra Tech Canada Inc. No. 6499