

- CONSTRUCTION NOTES:
1. ALL WORK AND MATERIALS TO BE IN ACCORDANCE WITH LATEST REVISION OF THE CITY OF WINNIPEG STANDARD CONSTRUCTION SPECIFICATIONS.
 2. LEGAL PLAN AND UNDERGROUND INFORMATION FROM CITY OF WINNIPEG LBIS.
 3. LOCATION OF EXISTING UTILITIES/SERVICES TO BE CONFIRMED IN THE FIELD BY THE CONTRACTOR.
 4. CONTRACTOR TO TAKE PRECAUTIONARY STEPS TO AVOID DAMAGE FROM CONSTRUCTION ACTIVITIES TO TREES WITHIN THE LIMITS OF CONSTRUCTION. REFER TO SPECIFICATIONS E5 AND E-27.
 5. RENEW BARRIER CURB AND GUTTER SD-200 WHERE SHOWN ON THE DRAWINGS AND AS DIRECTED BY THE CONTRACT ADMINISTRATOR.
 6. CONSTRUCT MODIFIED BARRIER CURB AND GUTTER (100mm REVEAL)
 7. ADJUST MANHOLE, CURB INLETS AND CATCH BASIN RIMS TO NEW GRADES. MANHOLE ISOLATION AS PER SD-220G.
 8. ABANDON CATCH BASIN, CATCH PIT, AND CATCH INLET
 9. SIDEWALK RENEWAL LOCATIONS TO BE FINALIZED IN THE FIELD BY THE CONTRACT ADMINISTRATOR. PROVIDE 13mm SIDEWALK EXPANSION JOINTS AS PER SD-228AA AS LAID OUT BY THE CONTRACT ADMINISTRATOR.
 10. ALL PRIVATE SIDEWALKS TO BE ADJUSTED TO NEW SIDEWALK OR TOP OF CURB ELEVATIONS AS REQUIRED. SIDEWALKS TO BE REPLACED WITH LIKE MATERIALS.
 11. CB LEADS AND CP LEADS TO BE INSTALLED TO INVERT ELEVATIONS AS SHOWN. ALL CB AND CP LEADS TO BE INSTALLED AT MIN 2.0% SLOPE AND AS DIRECTED BY CONTRACT ADMINISTRATOR.
 12. LIMITS OF BOULEVARD GRADING TO BE FINALIZED IN THE FIELD BY THE CONTRACT ADMINISTRATOR.
 13. CONTRACTOR TO CONFIRM LOCATION AND LIMITS OF SEWER REPAIRS AS INDICATED ON THE DRAWINGS BY PERFORMING VIDEO INSPECTION AND REVIEWING WITH THE CONTRACT ADMINISTRATOR PRIOR TO CONSTRUCTION.
 14. LAMP STANDARDS, HYDRO POLES AND ANCHORS THAT REQUIRE TEMPORARY SUPPORT, REMOVAL OR REPLACEMENT, TO BE DONE AT THE EXPENSE OF THE CONTRACTOR, AS NECESSARY. REFER TO SPECIFICATION E30 AND E38.
 15. COMPLETE CATCH BASIN/CATCH PIT CURB ISOLATIONS IN ACCORDANCE WITH SD-220E
 16. COVER PARTIAL AND FULL DEPTH ASPHALT REPAIRS WITH PAVEMENT REPAIR FABRIC EXTENDING 150mm AROUND PERIMETER OF REPAIR AS PER E13.
 17. CONSTRUCT PARTIAL/FULL DEPTH ASPHALT PAVEMENT REPAIR AS DETAILED IN SECTION 2
 18. ADJUST PRECAST SIDEWALK BLOCKS AS DIRECTED BY THE CA.
 19. CONSTRUCT SPEED TABLES AS PER DETAIL IN DWG 025 AND E34.
 20. UPGRADE TRANSIT STOP.
 21. ALL DIMENSIONS ARE TO BACK OF CURB.

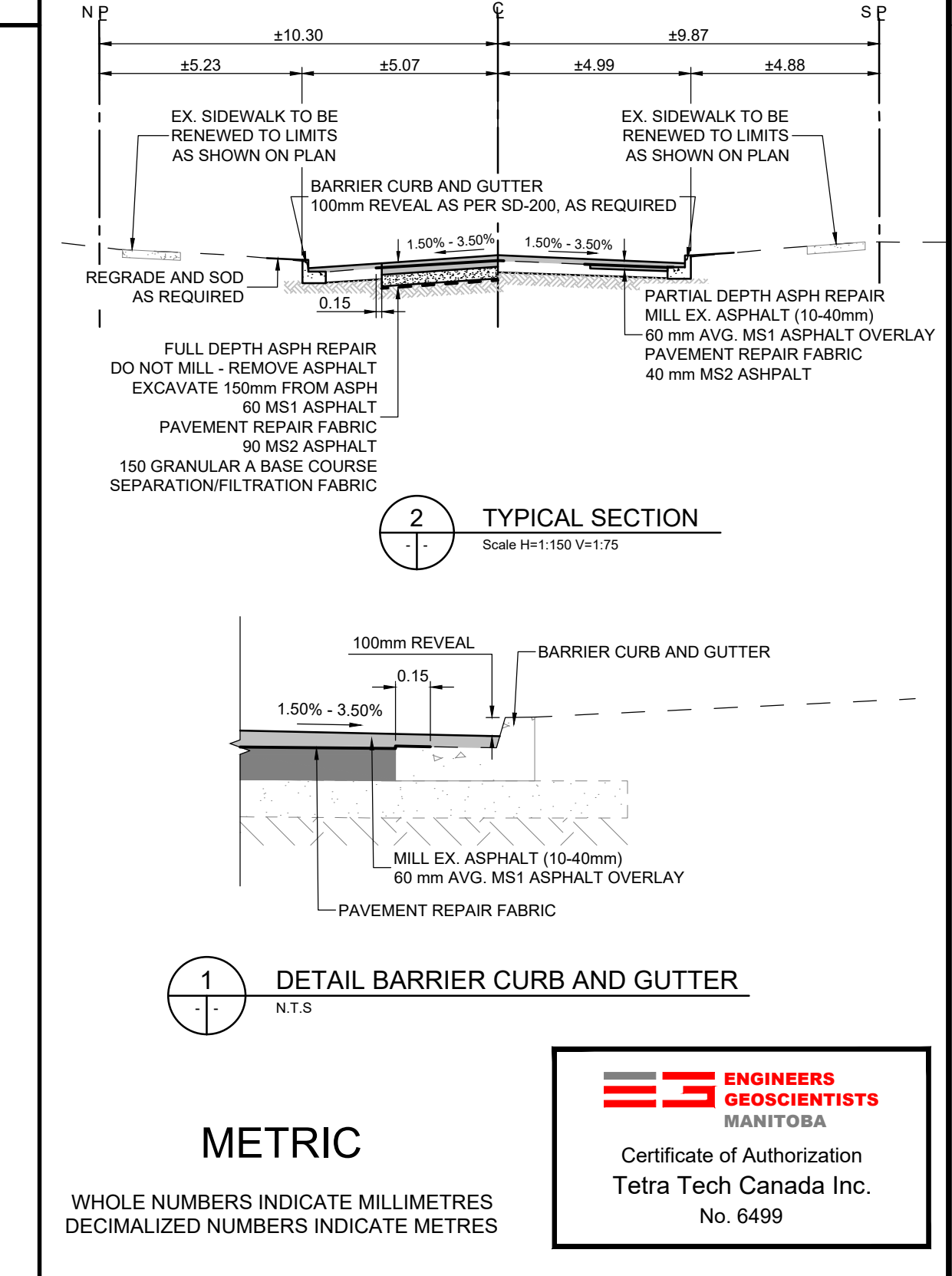
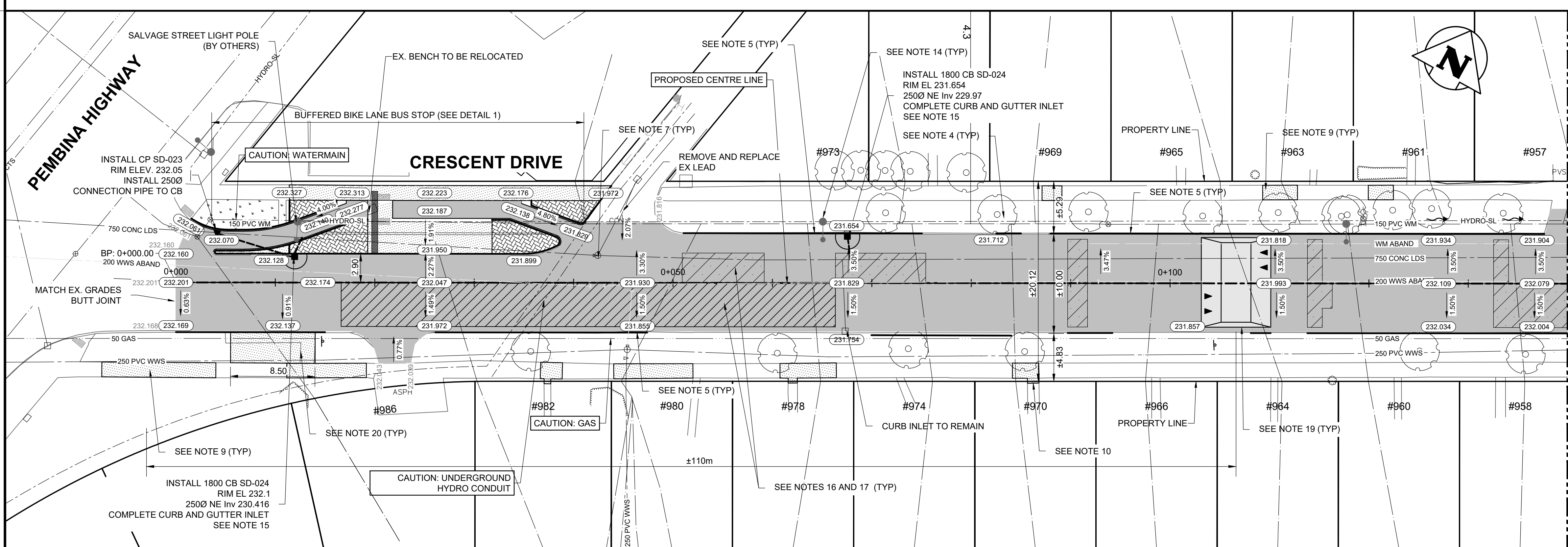

EXISTING	LEGEND-PLAN	PROPOSED	EXISTING	LEGEND-PLAN	PROPOSED	EXISTING	LEGEND-PROFILE	PROPOSED
	HYDRANT			CONCRETE			WATERMAIN	
	VALVE			ASPHALT			LAND DRAINAGE SEWER	
	MANHOLE			SIDEWALK			WASTE WATER SEWER	
	CATCH BASIN			PAVING STONES			HYDRANT	
	CATCH PIT			PARTIAL DEPTH REPAIR			VALVE	
	WATERMAIN			FULL DEPTH REPAIR			Q PROFILE	
	LAND DRAINAGE SEWER			PROPERTY LINE			NORTH/WEST GUTTER	
	WASTE WATER SEWER			ELEVATION			SOUTH/EAST GUTTER	
	HYDRO			CURB RAMP			NORTH/WEST DITCH	
	M.T.S.			DETECTABLE TILE			SOUTH/EAST DITCH	
	GAS							

EXISTING	LEGEND-PLAN	PROPOSED	EXISTING	LEGEND-PROFILE	PROPOSED
	HYDRANT			CONCRETE	
	VALVE			ASPHALT	
	MANHOLE			SIDEWALK	
	CATCH BASIN			PAVING STONES	
	CATCH PIT			PARTIAL DEPTH REPAIR	
	WATERMAIN			FULL DEPTH REPAIR	
	LAND DRAINAGE SEWER			PROPERTY LINE	
	WASTE WATER SEWER			ELEVATION	
	HYDRO			CURB RAMP	
	M.T.S.			DETECTABLE TILE	
	GAS				

DESIGNED BY	CF	REVIEWED BY	JT/DL/JNC
DRAWN BY	CF	APPROVED BY	JNC
SCALE:	H = 1:250	RELEASED FOR CONSTRUCTION	
	V = 1:10	STREETS PROJECT ENGINEER	
0	ISSUED FOR TENDER	26.03.17	JNC
NO	REVISIONS	DATE	BY
		DATE	26.03.17

TETRA TECH

THE CITY OF WINNIPEG
PUBLIC WORKS DEPARTMENT

2026 LOCAL STREET RENEWAL PROGRAM
26-R-03

CITY DRAWING NUMBER
P-3599-1
SHEET
01 25

ASPHALT REHABILITATION
CRESCENT DR. (PEMBINA HWY TO STA 0+140)
PLAN AND PROFILE

C001