

Notes

- 1. Wood slats: 89x89mm (4x4") composite slats with cedar tone finish
- 2. Frame: welded steel with galv. finish

Drawing Title:

**Tache Backless Bench
Composite with Arms**

Drawing Number:

SCD-121C

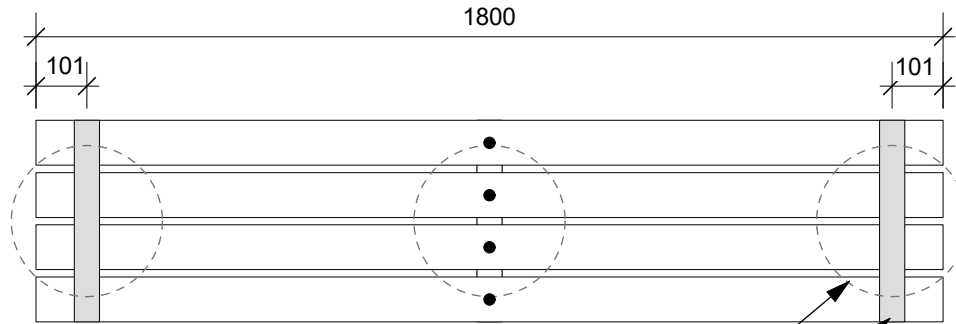

Plan View

Poured in place concrete base below
Steel arm rest

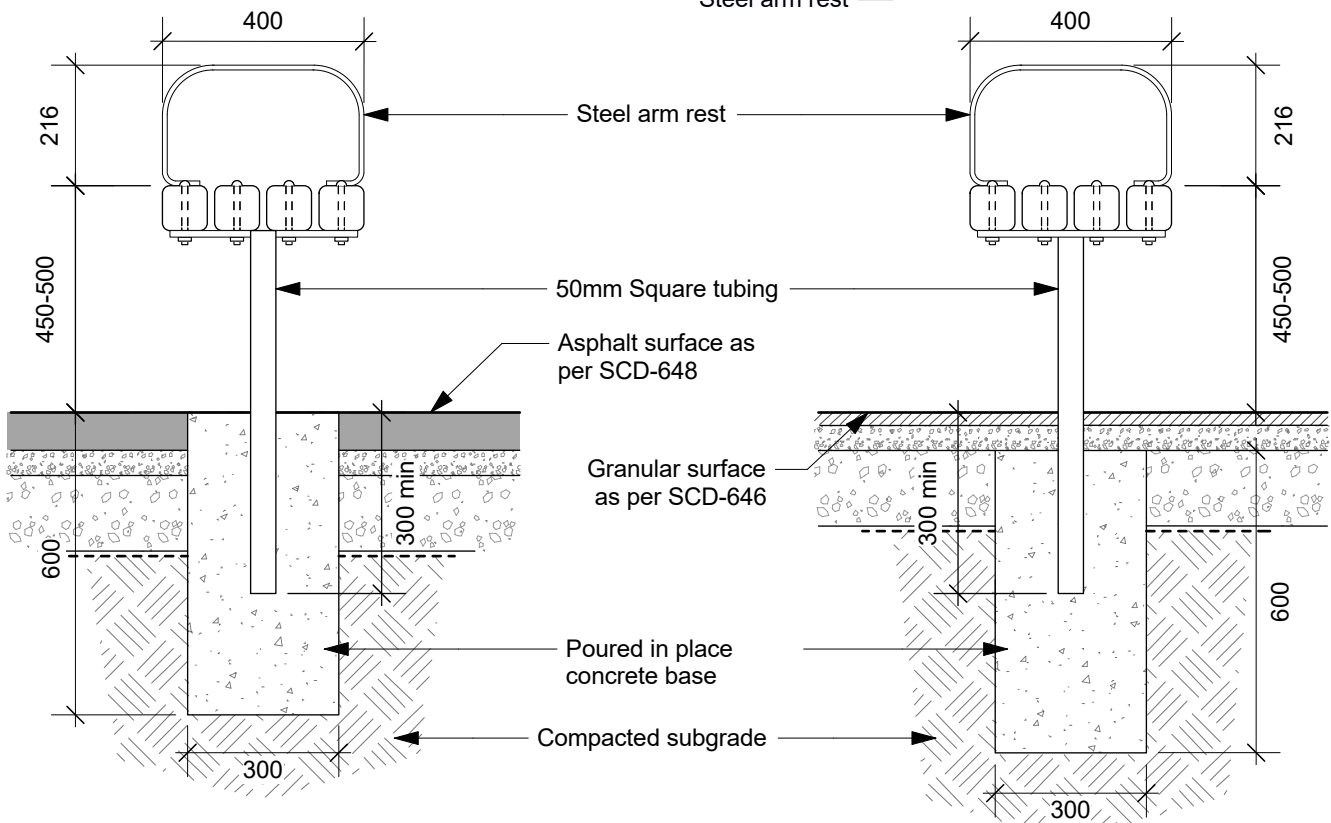

Section - Asphalt

Section - Granular

Dimensions shown are in millimetres unless otherwise specified

Revision: 4
Date: January 2026
Scale: NTS
Drawn by: MG

The City of Winnipeg
Planning, Property & Development Department
Urban Planning & Design
Unit 15 - 30 Fort Street, Winnipeg, MB, R3C 4X5

