

TYPICAL BRADFORD STREET CROSS SECTION
Scale N.T.S.

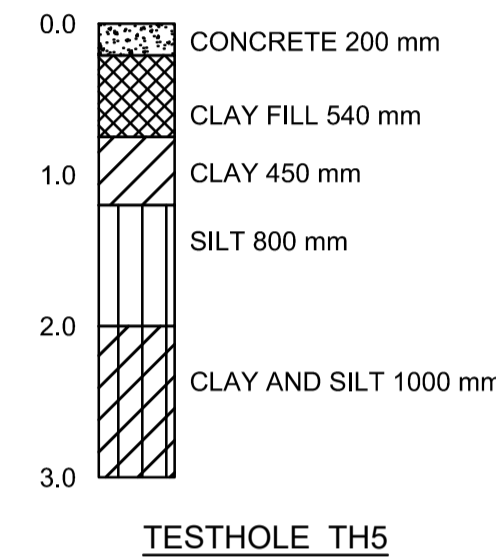

CATCH BASIN TABLE								
ITEM	RIM ELEV.	Sta	INVERT			SEWER	CONNECTION	LEAD
			EAST	WEST	NORTH SOUTH			
CB05	233.770	0+513.91	232.120		232.770 232.770	230.270	750mm CS	3.7m
CB06	233.770	0+513.91		232.120	232.770 232.770	230.270	750mm CS	5.8m

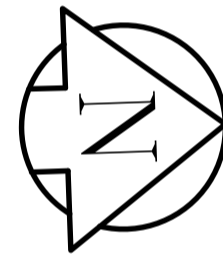

REFERENCE NOTES:

- A. PAVEMENT DIMENSIONS ARE TO BACK OF CURB
- B. BASELINE IS CENTRE LINE ROADWAY
- C. PROPERTY LINES OBTAINED FROM CITY OF WINNIPEG L.B.I.S., AND NO SCALE FACTOR WAS APPLIED
- D. REFER TO AECOM FIELD BOOK NO. 5215
- E. REFER TO DRAWING CT-05 FOR PROPOSED PAVEMENT GEOMETRY

CONSTRUCTION NOTES:

1. REMOVE EXISTING PAVEMENT AND CONSTRUCT NEW 250mm PLAIN DOWELLED CONCRETE PAVEMENT
2. REMOVE EXISTING PAVEMENT AND CONSTRUCT NEW 200mm REINFORCED CONCRETE PAVEMENT
3. REMOVE EXISTING ASPHALT PAVEMENT AND PLACE NEW ASPHALT PAVEMENT TYPE MS1
4. CONSTRUCT NEW MODIFIED BARRIER CURB (180mm HT. INTEGRAL)
5. CONSTRUCT NEW RAMP CURB (10-12mm HT., INTEGRAL)
6. CONSTRUCT NEW 100mm CONCRETE SIDEWALK
7. INSTALL NEW CURB AND GUTTER INLET c/w 1800mm CATCHBASIN (SD-024) AND CONNECT 250mm PVC LDS TO EXISTING 750mm COMBINED SEWER
8. INSTALL NEW 150mm SUBDRAIN 6.0m ON EACH SIDE OF CATCH BASIN
9. REMOVE EXISTING CATCH PIT AND ABANDON LEAD
10. REMOVE EXISTING CATCH BASIN AND ABANDON LEAD
11. INSTALL DETECTABLE SURFACE WARNING TILE
12. CONTRACTOR TO LOCATE AND INSULATE LONG SIDE OF WATER SERVICES
13. ADJUST EXISTING COMMUNICATIONS BOX TO GRADE

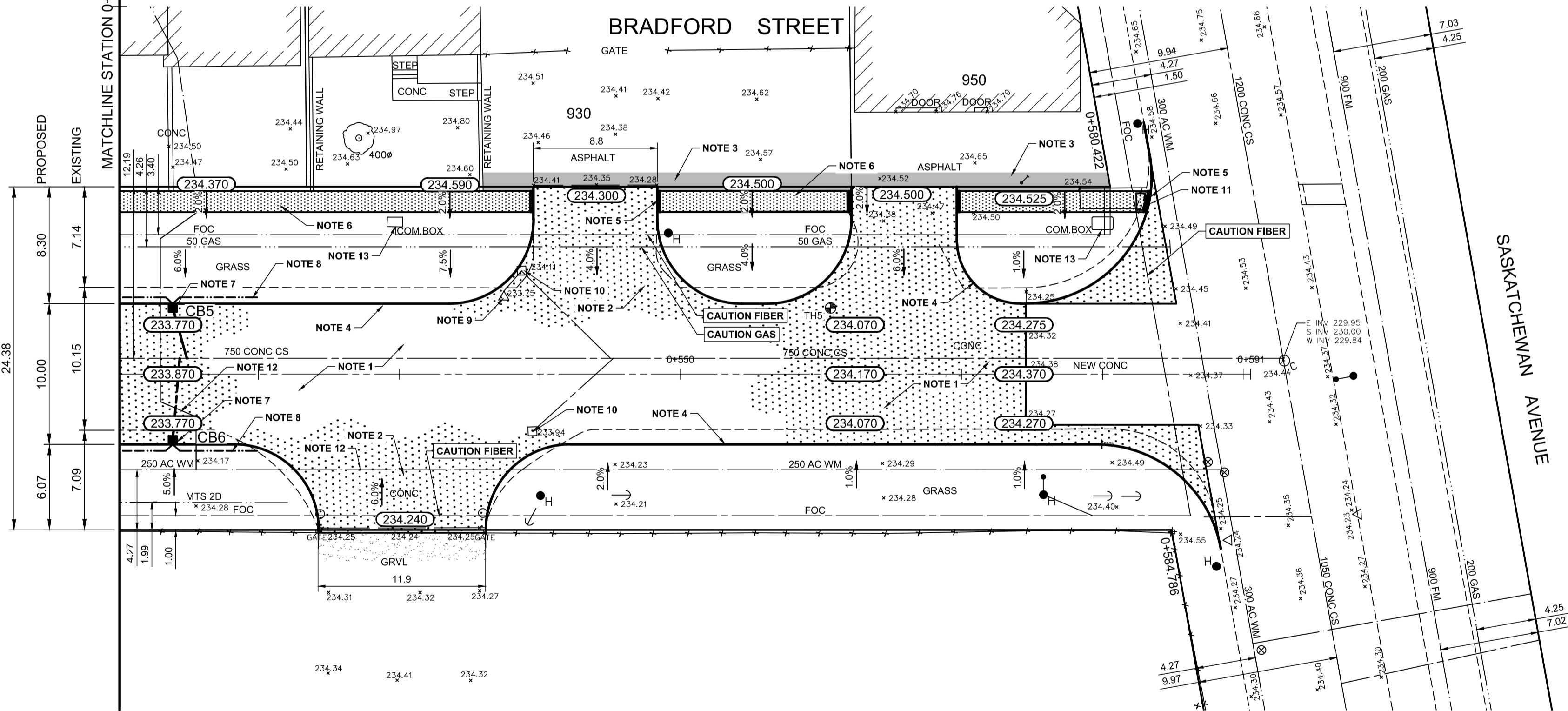

Certificate of Authorization
AECOM Canada ULC.

No. 4671 Date: 03/12/2026

METRIC

WHOLE NUMBERS INDICATE MILLIMETRES
DECIMALIZED NUMBERS INDICATE METRES

EXISTING	LEGEND - PLAN	PROPOSED	EXISTING	LEGEND - PLAN	PROPOSED	EXISTING	LEGEND - PROFILE	PROPOSED
150 mm W.M.	WATERMAIN	150 mm W.M.	HYDRO	M.T.S.	HYDRO	PROFILE	N/W GUTTER	
300mm L.D.S.	LAND DRAINAGE SEWER	300mm L.D.S.	CONCRETE	CONCRETE	CONCRETE	S/E GUTTER		
250mm W.W.S.	WASTEWATER SEWER	250mm W.W.S.	ASPHALT	ASPHALT	ASPHALT	N/W PROPERTY LINE		
MANHOLE	MANHOLE	MANHOLE	PROPERTY LINE	PROPERTY LINE	PROPERTY LINE	S/E PROPERTY LINE		
CATCH BASIN	CATCH BASIN	CATCH BASIN	SURVEY BAR	SURVEY BAR	SURVEY BAR			
CATCH PIT	CATCH PIT	CATCH PIT	ELEVATION	ELEVATION	ELEVATION			
TRAFFIC SIGNAL POLE	TRAFFIC SIGNAL POLE	TRAFFIC SIGNAL POLE	TREE	TREE	TREE			
STREET LIGHT	STREET LIGHT	STREET LIGHT	SIDEWALK RAMP	SIDEWALK RAMP	SIDEWALK RAMP			
GAS	GAS	GAS	CONCRETE SIDEWALK	CONCRETE SIDEWALK	CONCRETE SIDEWALK			
			FENCE	FENCE	FENCE			

LOCATION APPROVED
UNDERGROUND STRUCTURES

SUPV. U/G STRUCTURES
COMMITTEE

NOTE:
LOCATION OF UNDERGROUND STRUCTURES AS SHOWN ARE BASED ON THE BEST INFORMATION AVAILABLE. BUT NO GUARANTEE IS GIVEN THAT ALL EXISTING UTILITIES ARE SHOWN OR THAT THE GIVEN LOCATIONS ARE EXACT. CONFIRMATION OF EXISTENCE AND EXACT LOCATION OF ALL SERVICES MUST BE OBTAINED FROM THE INDIVIDUAL UTILITIES BEFORE PROCEEDING WITH CONSTRUCTION.

B.M. ELEV. 12 - S.E. Cor. King Edward St. & Saskatchewan Ave., Tblt. in N. Conc. foundation No. 945 King Edward St., 1m E. & 0.7m below brick of N.W. Cor. of Bldg.

ELEVATION: 234.972

NO.	REVISIONS	DATE	BY
0	ISSUED FOR TENDER	03/12/2026	BC
A	ISSUED FOR REVIEW	03/02/2026	BC

AECOM

DESIGNED BY	BC	CHECKED BY	RC
DRAWN BY	RAM	APPROVED BY	RC
HOR. SCALE:	1:250	RELEASED FOR CONSTRUCTION BY:	
VERTICAL:	1:10	DATE	24/10/2025

ENGINEER'S SEAL



PUBLIC WORKS DEPARTMENT
ENGINEERING DIVISION

2026 LOCAL STREET RENEWAL PROGRAM
BRADFORD STREET

CONCRETE PAVEMENT RECONSTRUCTION
STATION 0+510 TO SASKATCHEWAN AVENUE
PLAN/PROFILE

CITY DRAWING NUMBER

SHEET 10 OF 36

CONSULTANT DRAWING NO.
CT-10