

- REFERENCE NOTES:**
- A. PAVEMENT DIMENSIONS ARE TO BACK OF CURB
 - B. PROPERTY LINES OBTAINED FROM CITY OF WINNIPEG L.B.I.S., AND NO SCALE FACTOR WAS APPLIED
 - C. REFER TO AECOM FIELD BOOK NO. 5213
- CONSTRUCTION NOTES:**
- 1. MILL EXISTING ASPHALT PAVEMENT AND PLACE NEW ASPHALT PAVEMENT OVERLAY TYPE MS1 (65mm AVERAGE THICKNESS)
 - 2. REMOVE AND REINSTALL CONCRETE PARKING CURBS
 - 3. CLEAN OUT EXISTING CONCRETE SWALE

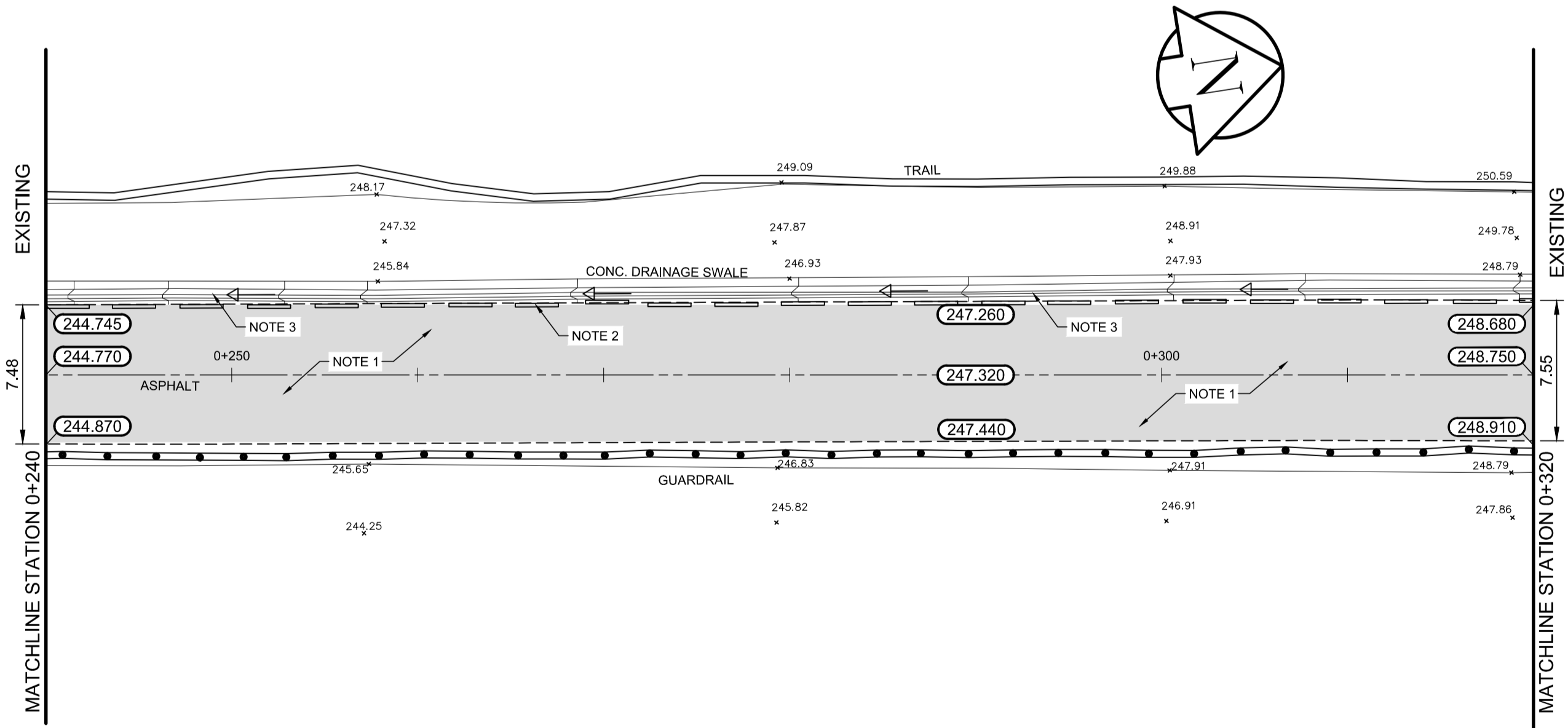

**ENGINEERS
GEOSCIENTISTS
MANITOBA**

Certificate of Authorization
AECOM Canada ULC.
No. 4671 Date: 03/12/2026

METRIC
WHOLE NUMBERS INDICATE MILLIMETRES
DECIMALIZED NUMBERS INDICATE METRES

150 mm W.M.	WATERMAIN	150 mm W.M.	HYDRO	150 mm W.M.	HYDRO	150 mm W.M.	HYDRO	150 mm W.M.	HYDRO
HYDRANT	HYDRANT	HYDRANT	M.T.S.	HYDRANT	M.T.S.	HYDRANT	M.T.S.	HYDRANT	M.T.S.
VALVE	VALVE	VALVE	CONCRETE	VALVE	CONCRETE	VALVE	CONCRETE	VALVE	CONCRETE
LAND DRAINAGE SEWER	LAND DRAINAGE SEWER	LAND DRAINAGE SEWER	ASPHALT	LAND DRAINAGE SEWER	ASPHALT	LAND DRAINAGE SEWER	ASPHALT	LAND DRAINAGE SEWER	ASPHALT
WASTEWATER SEWER	WASTEWATER SEWER	WASTEWATER SEWER	PROPERTY LINE	WASTEWATER SEWER	PROPERTY LINE	WASTEWATER SEWER	PROPERTY LINE	WASTEWATER SEWER	PROPERTY LINE
MANHOLE	MANHOLE	MANHOLE	SURVEY BAR	MANHOLE	SURVEY BAR	MANHOLE	SURVEY BAR	MANHOLE	SURVEY BAR
CATCH BASIN	CATCH BASIN	CATCH BASIN	ELEVATION	CATCH BASIN	ELEVATION	CATCH BASIN	ELEVATION	CATCH BASIN	ELEVATION
CATCH PIT	CATCH PIT	CATCH PIT	TREE	CATCH PIT	TREE	CATCH PIT	TREE	CATCH PIT	TREE
TRAFFIC SIGNAL POLE	TRAFFIC SIGNAL POLE	TRAFFIC SIGNAL POLE	SIDEWALK RAMP	TRAFFIC SIGNAL POLE	SIDEWALK RAMP	TRAFFIC SIGNAL POLE	SIDEWALK RAMP	TRAFFIC SIGNAL POLE	SIDEWALK RAMP
STREET LIGHT	STREET LIGHT	STREET LIGHT	CONCRETE SIDEWALK	STREET LIGHT	CONCRETE SIDEWALK	STREET LIGHT	CONCRETE SIDEWALK	STREET LIGHT	CONCRETE SIDEWALK
GAS	GAS	GAS	FENCE	GAS	FENCE	GAS	FENCE	GAS	FENCE
EXISTING	LEGEND - PLAN	PROPOSED	EXISTING	LEGEND - PLAN	PROPOSED	EXISTING	LEGEND - PROFILE	PROPOSED	LEGEND - PROFILE

**LOCATION APPROVED
UNDERGROUND STRUCTURES**

SUPV. U/G STRUCTURES COMMITTEE DATE

NOTE:
LOCATION OF UNDERGROUND STRUCTURES AS SHOWN ARE BASED ON THE BEST INFORMATION AVAILABLE. BUT NO GUARANTEE IS GIVEN THAT ALL EXISTING UTILITIES ARE SHOWN OR THAT THE GIVEN LOCATIONS ARE EXACT. CONFIRMATION OF EXISTENCE AND EXACT LOCATION OF ALL SERVICES MUST BE OBTAINED FROM THE INDIVIDUAL UTILITIES BEFORE PROCEEDING WITH CONSTRUCTION.

B.M. ELEV.	54 - S.E. Cor. Wellington Ave. & Empress St., Tblt. in N. Conc. foundation No. 1115/ 1113 Empress St., 3m E. & 0.3m below bricks of N.W. Cor. of Bldg.	ELEVATION: 233.863
DESIGNED BY	BC	CHECKED BY RC
DRAWN BY	RAM	APPROVED BY RC
HOR. SCALE:	1:250	RELEASED FOR CONSTRUCTION BY:
VERTICAL:	1:10	DATE
NO.	REVISIONS	DATE BY

AECOM	
DESIGNED BY	BC
DRAWN BY	RAM
HOR. SCALE:	1:250
VERTICAL:	1:10
DATE	24/10/2025

ENGINEER'S SEAL

CONSULTANT DRAWING NO. CT-23

THE CITY OF WINNIPEG PUBLIC WORKS DEPARTMENT ENGINEERING DIVISION	
2026 LOCAL STREET RENEWAL PROGRAM WESTVIEW PARK ROAD	CITY DRAWING NUMBER
ASPHALT PAVEMENT OVERLAY STATION 0+240 TO STATION 0+320 PLAN/PROFILE	SHEET 23 OF 36