

- NOTES**
1. ADJUST MH AND CB RIMS TO NEW GRADES.
 2. LAMP STANDARDS, HYDRO POLES, AND ANCHORS THAT REQUIRE TEMPORARY SUPPORT, REMOVAL OR REPLACEMENT, TO BE DONE SO AT THE EXPENSE OF THE CONTRACTOR AS NECESSARY.
 3. CONTRACTOR TO REGRADE/RENEW EXISTING PRIVATE SIDEWALKS TO LIMITS AS SHOWN. SIDEWALKS TO BE RENEWED WITH CONCRETE UNLESS NOTED OTHERWISE.
 4. CONTRACTOR TO TAKE PRECAUTIONARY STEPS TO PROTECT EXISTING TREES WITHIN THE LIMITS OF CONSTRUCTION FROM DAMAGE FROM CONSTRUCTION ACTIVITIES AS OUTLINED IN THE SPECIFICATIONS.
 5. CONTRACTOR TO CONFIRM THE LOCATION OF ALL UTILITIES/SERVICES IN THE FIELD PRIOR TO CONSTRUCTION.
 6. MODIFIED BARRIER CURB TO BE USED AT ALL INTERSECTION RADII, BACK LANE RADII AND BULLNOSES.
 7. CONTRACTOR TO OVERLAY DRIVEWAYS TO ENSURE POSITIVE DRAINAGE TO NEW STREET GRADES. FINAL LIMITS TO BE DETERMINED IN THE FIELD BY CONTRACT ADMINISTRATOR.
 8. CB SD-023 & SD-024 OFFSETS ARE DIMENSIONED TO BOC. CB SD-025 OFFSETS ARE DIMENSIONED O/C.
 9. REFER TO TENDER FOR DETAILS REGARDING TRAFFIC MANAGEMENT.
 10. ADJUST EXISTING WATER VALVES AND WATER SERVICE CURB STOPS TO GRADE.
 11. ADD 200.000 m TO ABBREVIATED ELEVATIONS TO OBTAIN GEODETIC ELEVATIONS.

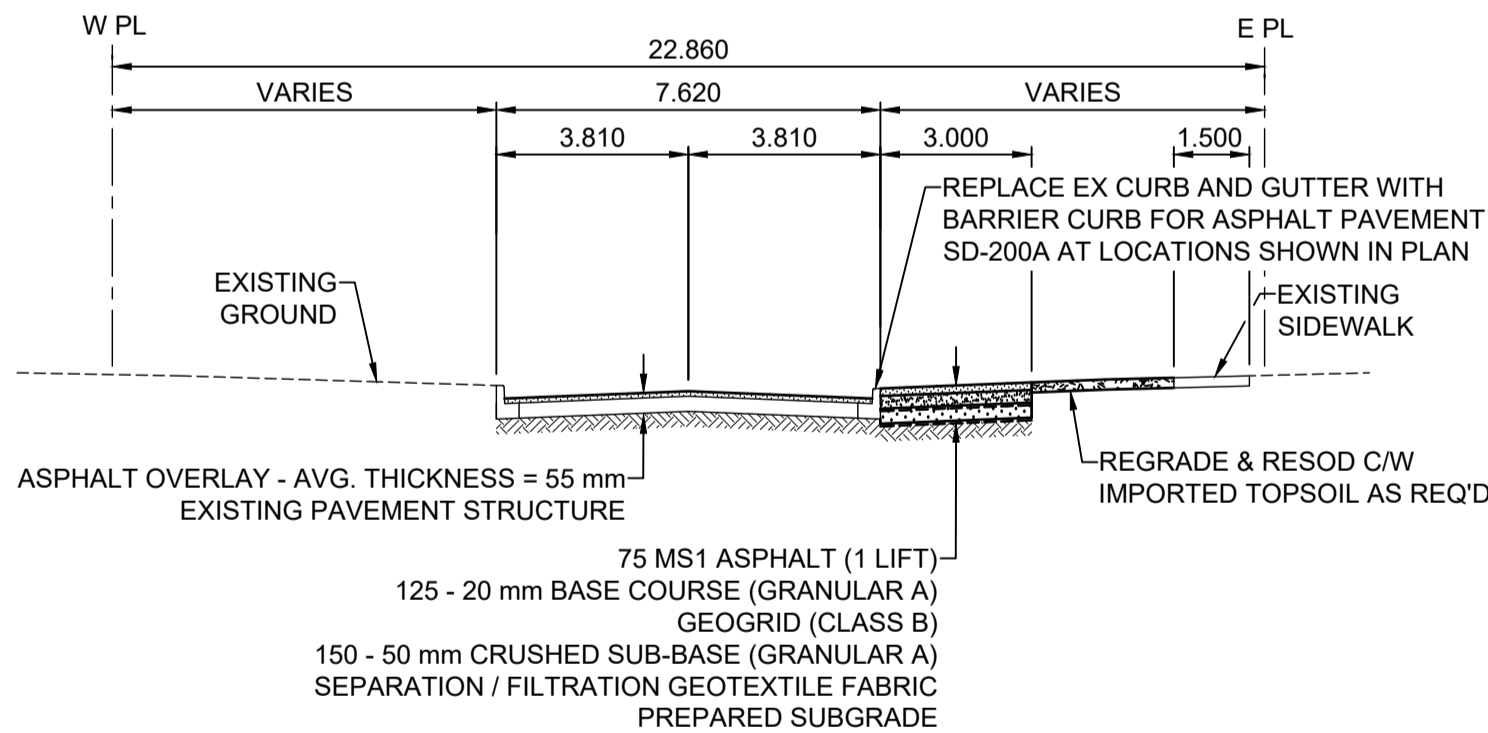
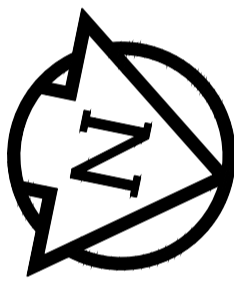
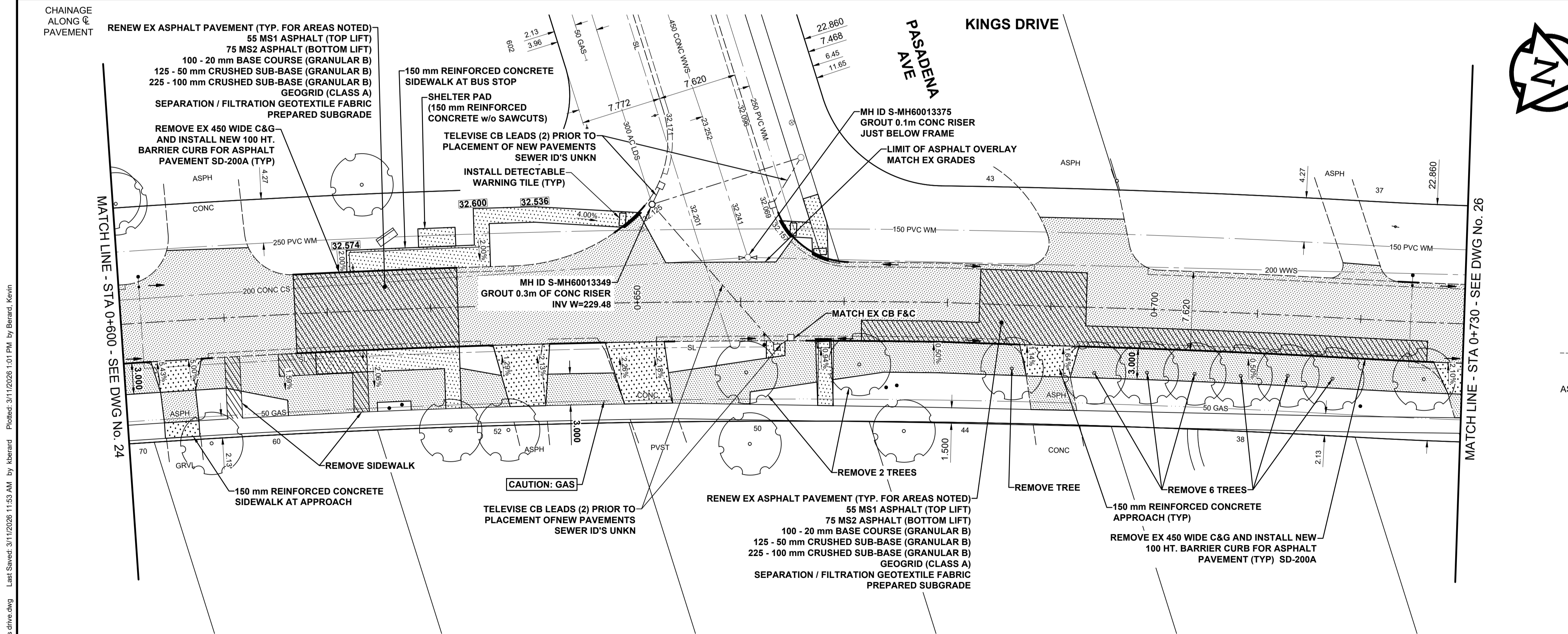

TYPICAL PAVEMENT SECTION
ASPHALT REHABILITATION
SCALE: NTS

METRIC
WHOLE NUMBERS INDICATE MILLIMETRES
DECIMALIZED NUMBERS INDICATE METRES

EXISTING	LEGEND - PLAN	PROPOSED	EXISTING	LEGEND - PLAN	PROPOSED	EXISTING	LEGEND - PLAN	PROPOSED
○	HYDRANT	◆	---	LDS / WWS	---	---	CONCRETE	---
⊗	VALVE	⊗	---	WATER MAIN	---	---	CONC SIDEWALK / MEDIAN	---
⊙	CURB STOP	⊙	---	GAS	---	---	ASPHALT	---
○	MANHOLE	●	---	TRAFFIC SIGNALS	---	---	PAVING STONE	---
□	CATCH BASIN / CATCH PIT	■	---	HYDRO / STREET LIGHT	---	---	GRAVEL	---
△	CURB INLET	▲	---	COMMUNICATIONS	---	---	PLANING / REMOVAL	---
•	POLE	•	---	CURB RENEWAL	---	---	DITCH FLOW	---
•	LIGHT STANDARD	•	---	PROPERTY LINE	---	---	TOP OF SLOPE	---
•	TRAFFIC SIGNAL POLE	•	---	RAMP CURB	---	---	CULVERT	---
+	SURVEY BAR	+	---	ELEVATIONS	(33.333)	---	SEWER FLOW DIRECTION	---
⊕	GEODETIC BENCH MARK	⊕	---	TREE / TREELINE	---	---	TEST HOLE / CORE HOLE	---
⊕	EXISTING	⊕	---	LEGEND - PLAN	---	---	LEGEND - PLAN	---

PLAN
SCALE: 1:250

LOCATION APPROVED
UNDERGROUND STRUCTURES

SUPR. U/G STRUCTURES DATE
COMMITTEE

NOTE:
LOCATION OF UNDERGROUND STRUCTURES AS SHOWN ARE BASED ON THE BEST INFORMATION AVAILABLE BUT NO GUARANTEE IS GIVEN THAT ALL EXISTING UTILITIES ARE SHOWN OR THAT THE GIVEN LOCATIONS ARE EXACT. CONFIRMATION OF EXISTENCE AND EXACT LOCATION OF ALL SERVICES MUST BE OBTAINED FROM THE INDIVIDUAL UTILITIES BEFORE PROCEEDING WITH CONSTRUCTION.

BM	GBM 77-016	S. side Kilkenny Dr., W. of Kings Dr., Tblt. In E. Conc.
ELEV	232.103 m	Foundation of No. 912 Kilkenny Dr., 7.5m S. & 0.1 m below station of N.E. Cor. of house.
No.	0	ISSUED FOR TENDER
REVISIONS	26/03/11	JGK
DATE	March 11, 2026	

Stantec
500 - 311 Portage Avenue, Winnipeg M8 Canada R3B 2B9
Tel. 204.489.5900 Fax. 204.453.9012 www.stantec.com

DESIGNED BY	JGK	CHECKED BY	GFC
DRAWN BY	KMB	APPROVED BY	RPB
HOR SCALE	1:250	RELEASED FOR CONSTRUCTION	
VERT SCALE	1:10		
DATE	March 11, 2026		

PROFESSIONAL SEAL
PROVINCE OF MANITOBA
REGISTERED PROFESSIONAL ENGINEER
J.G. KENNEDY
Member
22326
2025-03-11
CONSULTANT FILE NAME
01009c-kings drive.dwg

THE CITY OF WINNIPEG
PUBLIC WORKS DEPARTMENT
ENGINEERING DIVISION

2026 LOCAL STREET RENEWAL PROGRAM
KINGS DRIVE
KILKENNY DR TO SEIER BAY
REHABILITATION
PAVING AND GRADING
STA 0+600 TO STA 0+730

CITY DRAWING NUMBER
N/A
SHEET
25 OF 41
DRAWING NUMBER
25

TENDER No. 33-2026