

ISO A1 - 594mm x 841mm
U:\1325010090\0300_drawing\0302_sheet_files\02_civil\010090-chancellor.dwg
Last Saved: 3/11/2026 11:47 AM by lbeard
Plotted: 3/11/2026 12:54 PM by lbeard, Kevin

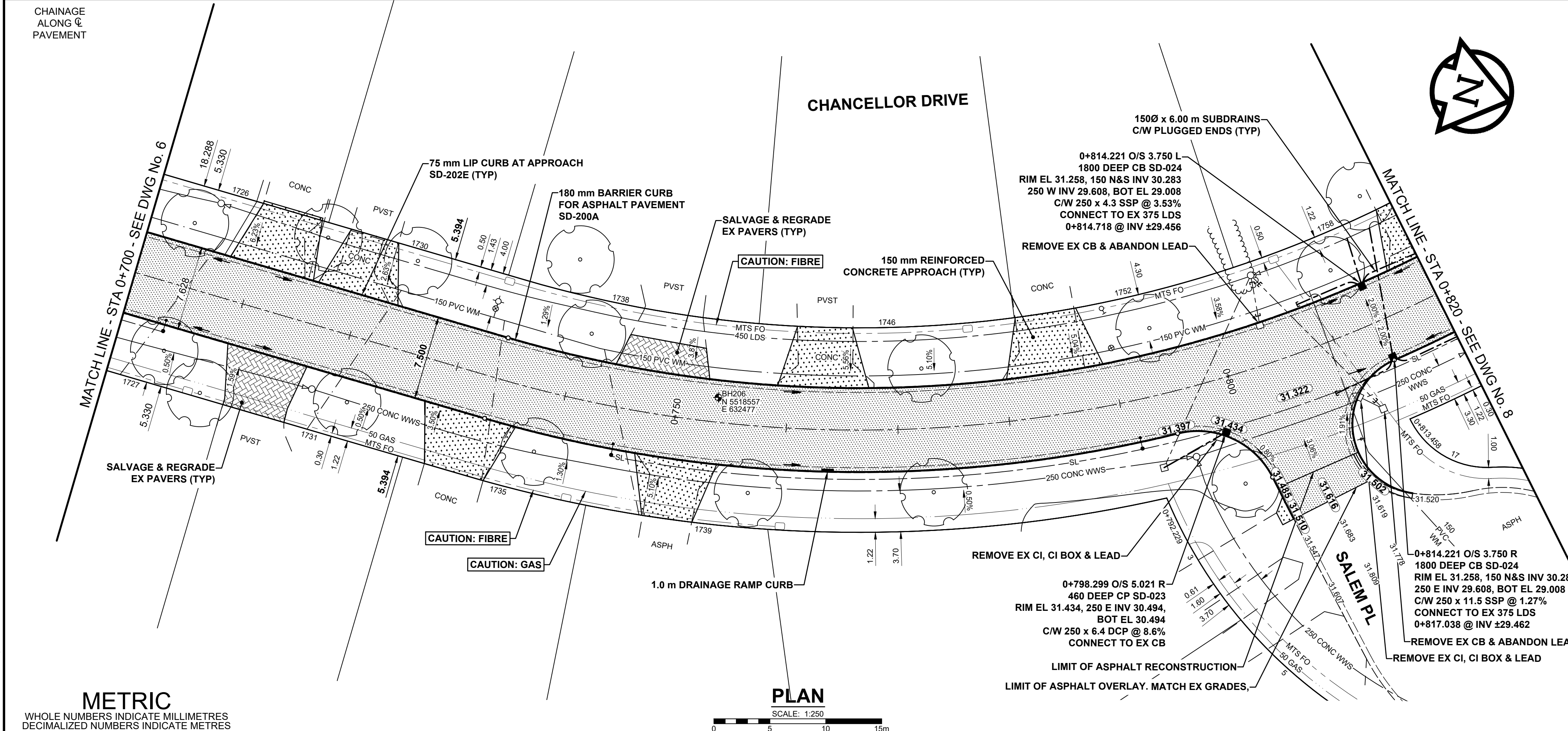
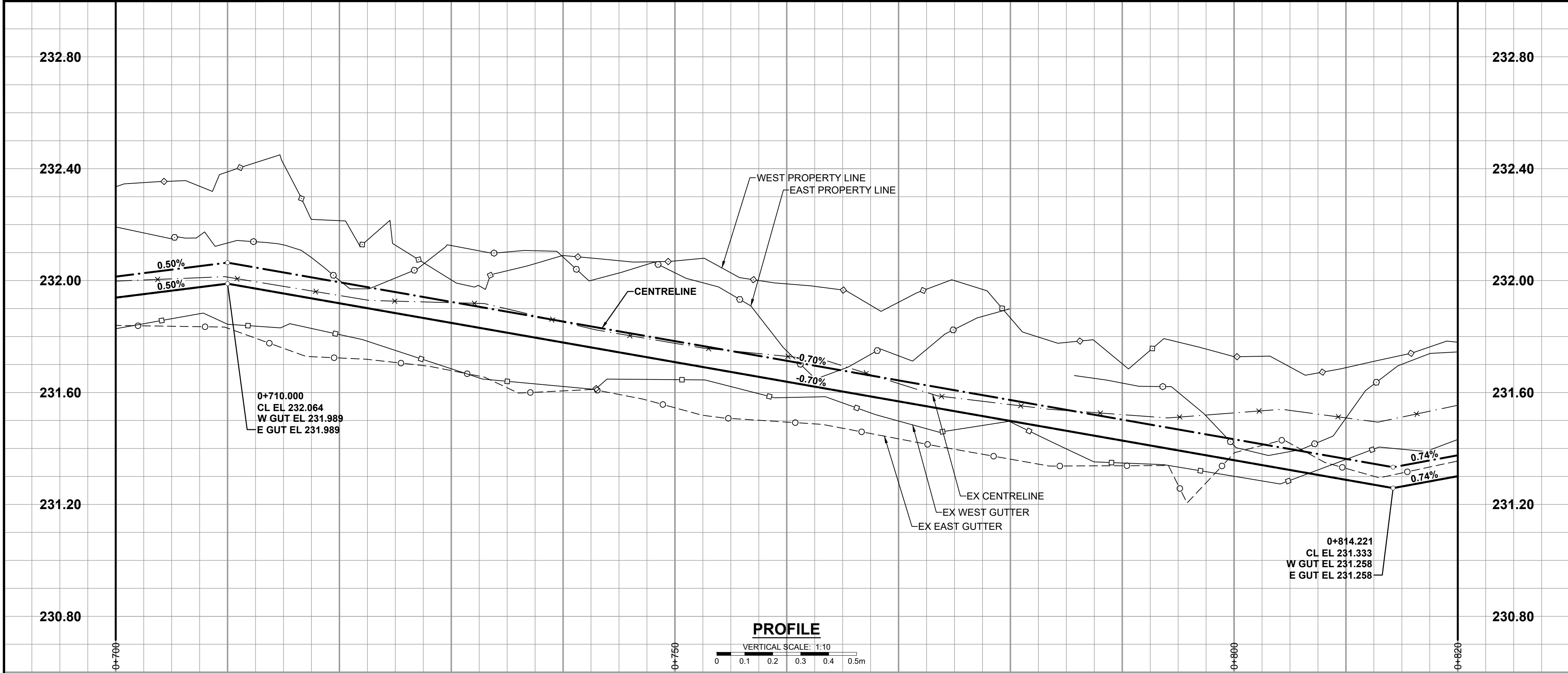

METRIC					
WHOLE NUMBERS INDICATE MILLIMETRES					
DECIMALIZED NUMBERS INDICATE METRES					
EXISTING	LEGEND - PLAN	PROPOSED	EXISTING	LEGEND - PLAN	PROPOSED
○	HYDRANT	◆	---	LDS / WWS	---
⊙	VALVE	⊙	---	WATER MAIN	---
⊙	CURB STOP	⊙	---	GAS	---
○	MANHOLE	●	---	TRAFFIC SIGNALS	---
□	CATCH BASIN / CATCH PIT	■	---	HYDRO / STREET LIGHT	---
△	CURB INLET	▲	---	COMMUNICATIONS	---
•	POLE	•	---	CURB RENEWAL	---
•	LIGHT STANDARD	•	---	PROPERTY LINE	---
•	TRAFFIC SIGNAL POLE	•	---	RAMP CURB	---
⊕	SURVEY BAR	⊕	---	ELEVATIONS	(33.333)
⊙	GEODETIC BENCH MARK	⊙	---	TREE / TREELINE	---

LOCATION APPROVED	
UNDERGROUND STRUCTURES	
SUPR. U/G STRUCTURES	DATE
COMMITTEE	
NOTE:	
LOCATION OF UNDERGROUND STRUCTURES AS SHOWN ARE BASED ON THE BEST INFORMATION AVAILABLE BUT NO GUARANTEE IS GIVEN THAT ALL EXISTING UTILITIES ARE SHOWN OR THAT THE GIVEN LOCATIONS ARE EXACT. CONFIRMATION OF EXISTENCE AND EXACT LOCATION OF ALL SERVICES MUST BE OBTAINED FROM THE INDIVIDUAL UTILITIES BEFORE PROCEEDING WITH CONSTRUCTION.	

REVISIONS	
No.	REVISIONS
0	ISSUED FOR TENDER
1	26/03/11
2	JGK
3	BY
4	DATE
5	March 11, 2026

500 - 311 Portage Avenue, Winnipeg M8 Canada R3B 2B9
Tel. 204.489.5900 Fax. 204.453.9012 www.stantec.com

DESIGNED BY	ACK	CHECKED BY	JGK
DRAWN BY	DML	APPROVED BY	RPB
HOR SCALE	1:250	RELEASED FOR CONSTRUCTION	
VERT SCALE	1:10		
DATE	March 11, 2026	DATE	

CONSULTANT FILE NAME
010090c-chancellor.dwg

2026 LOCAL STREET RENEWAL PROGRAM
CHANCELLOR DRIVE
#1662 CHANCELLOR DR TO MARKHAM RD
ASPHALT RECONSTRUCTION
PAVING AND GRADING
STA 0+700 TO STA 0+820

CITY DRAWING NUMBER	N/A
SHEET	7 OF 41
DRAWING NUMBER	7

- NOTES
- ADJUST MH AND CB RIMS TO NEW GRADES.
 - LAMP STANDARDS, HYDRO POLES, AND ANCHORS THAT REQUIRE TEMPORARY SUPPORT, REMOVAL OR REPLACEMENT, TO BE DONE SO AT THE EXPENSE OF THE CONTRACTOR AS NECESSARY.
 - CONTRACTOR TO REGRADE/RENEW EXISTING PRIVATE SIDEWALKS TO LIMITS AS SHOWN. SIDEWALKS TO BE RENEWED WITH CONCRETE UNLESS NOTED OTHERWISE.
 - CONTRACTOR TO TAKE PRECAUTIONARY STEPS TO PROTECT EXISTING TREES WITHIN THE LIMITS OF CONSTRUCTION FROM DAMAGE FROM CONSTRUCTION ACTIVITIES AS OUTLINED IN THE SPECIFICATIONS.
 - CONTRACTOR TO CONFIRM THE LOCATION OF ALL UTILITIES/SERVICES IN THE FIELD PRIOR TO CONSTRUCTION.
 - CB SD-023 & SD-024 OFFSETS ARE DIMENSIONED TO BOC. CB SD-025 OFFSETS ARE DIMENSIONED O/C. TF-100 OFFSETS ARE DIMENSIONED TO FACE OF CURB.
 - IN GENERAL, PAVEMENT AND SIDEWALK AREAS TO BE REMOVED. MATCH RECONSTRUCTION LIMITS.
 - REFER TO TENDER FOR DETAILS REGARDING TRAFFIC MANAGEMENT.
 - EXISTING LONG WATER SERVICES TO BE INSULATED (SD-018). REFER TO TENDER FOR FURTHER REQUIREMENTS AND AS NOTED IN PLAN.
 - ALL COSTS, MATERIALS AND LABOR ASSOCIATED WITH THE RESTORATION OF THE CATHODIC PROTECTED WATERMAIN WILL BE RESPONSIBILITY OF THE CONTRACTOR.
 - MODIFIED BARRIER CURB & GUTTER INLET FRAME & COVER TF-122.
 - ADD 200.000 m TO ABBREVIATED ELEVATIONS TO OBTAIN GEODETIC ELEVATIONS.

