

EARL GREY SCHOOL



EXISTING WOODEN SHADE STRUCTURE

DEMOLITION & REMOVALS NOTES

- 1. ALL WORK TO CONFORM TO CURRENT CITY OF WINNIPEG STANDARD CONSTRUCTION SPECIFICATIONS AND DETAILS UNLESS OTHERWISE NOTED
- 2. DIMENSIONS ARE IN METERS UNLESS OTHERWISE NOTED
- 3. DO NOT SCALE DRAWINGS
- 4. PROTECT EXISTING TREES TO REMAIN, TYP.
- 5. SECURE CONSTRUCTION SITE AND STAGING AREA WITH CONSTRUCTION FENCING C/W SAFETY SIGNAGE
- 6. CONFIRM STAGING AREA W/ CONTRACT ADMINISTRATOR PRIOR TO CONSTRUCTION

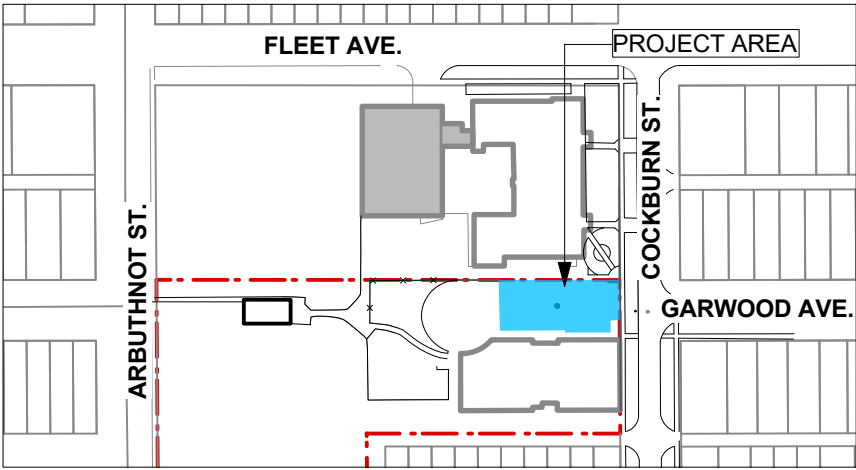

KEY PLAN 1:2500

LEGEND

- 1 REMOVE & LEGALLY DISPOSE OF EXISTING WOODEN SHADE STRUCTURE
- 2 REMOVE & LEGALLY DISPOSE OF EXISTING PLAY EQUIPMENT, TIMBER EDGING (134 LM), DAYCARE SIGN (1), FENCING (38 LM) AND BENCHES (5). REMOVE BIKE RACK AND STORE FOR REINSTALLATION (1).
- 3 EXCAVATE & LEGALLY DISPOSE OF EXISTING SAFETY SURFACE AND EARTHEN MATERIAL WITHIN PROPOSED PLAY AREAS TO ALLOW FOR REQUIRED DEPTH OF RUBBER SURFACING FOR PROPOSED PLAY EQUIPMENT FALL HEIGHTS, WITH MANUFACTURER'S SPECIFIC DRAINAGE SYSTEM (BLUE AREA, 333 SM). SALVAGE CLEAN FILL FOR ROUGH GRADING AS REQUIRED AND LEGALLY DISPOSE OF THE REST
- 4 EXCAVATE & LEGALLY DISPOSE OF EXISTING SAFETY SURFACING AND EARTHEN MATERIAL INSIDE PROPOSED NATURE PLAY AREA TO ALLOW FOR 200 mm DEPTH COMPACTED ENGINEERED WOOD FIBRE AND MANUFACTURER'S SPECIFIED DRAINAGE SYSTEM (PURPLE AREA, 16 CM)
- 5 EXCAVATE & LEGALLY DISPOSE OF EXISTING SAFETY SURFACING AND EARTHEN MATERIAL OUTSIDE PROPOSED PLAY AREA AND PATHWAYS TO MIN 200mm DEPTH (ORANGE AREA, 10 CM)
- 6 EXCAVATE & LEGALLY DISPOSE OF EXISTING SAFETY SURFACING AND EARTHEN MATERIALS OUTSIDE PROPOSED PLAY AREA TO MIN 600 mm DEPTH TO ACCOMODATE TREE WELLS, UNLESS OTHERWISE NOTED, (DASHED BLACK AREA, 40 CM)
- 7 EXCAVATE & LEGALLY DISPOSE OF EXISTING ASPHALT PATHWAY (264 SM) TO A MIN DEPTH OF 275 mm BELOW FINISHED GRADE
- 8 REMOVE & LEGALLY DISPOSE OF EXISTING TREE (1) AND FILL TREE WELLS (2)
- 9 EXISTING PYLON SIGN TO REMAIN

CONTRACTOR TO CONFIRM ALL DIMENSIONS AND REPORT ANY DISCREPANCIES TO CONTRACT ADMINISTRATOR PRIOR TO CONSTRUCTION. LOCATION OF UNDERGROUND STRUCTURES AS SHOWN ARE BASED ON THE BEST INFORMATION AVAILABLE BUT NO GUARANTEE IS GIVEN THAT ALL EXISTING UTILITIES ARE SHOWN OR THAT THE GIVEN LOCATIONS ARE EXACT. CONFIRMATION OF EXISTENCE AND EXACT LOCATION OF ALL SERVICES MUST BE OBTAINED FROM THE INDIVIDUAL UTILITIES BEFORE PROCEEDING WITH CONSTRUCTION.

DRAWING TITLE
Earl Grey CC
Playground Redevelopment
Existing Conditions & Removals

SITE ADDRESS 360 Cockburn St. N.

DRAWING NO.

E.3-G1

BID OPPORTUNITY NO.
55-2026

EARL GREY COMMUNITY CENTRE

LEGEND

- EXISTING FENCE
- PROPOSED FENCE
- WATER MAIN
- SEWER MAIN
- PROPERTY LINE
- CATCH BASIN

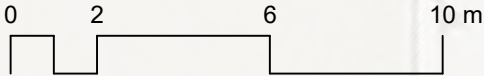

THE CITY OF WINNIPEG
Planning, Property and Development Department
Planning and Land Use Division
Unit 15 - 30 Fort Street, Winnipeg, MB, (R3C 4X5)

DESIGNED BY MA

CHECKED BY

DRAWN BY MA

APPROVED BY

HORIZ. SCALE 1:175
VERT. SCALE

DATE January 2026

MANAGER,
PARK AND OPEN SPACES

DATE

MANAGER,
PLANNING AND LAND USE DIVISION

DATE