

Drawing Title:

HEAVY DUTY DECORATIVE POST AND WOOD FENCING

Drawing No:

SCD-105I

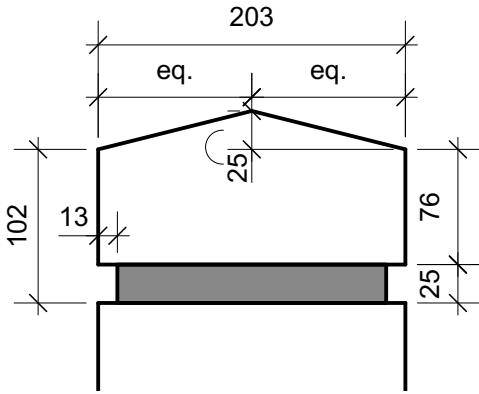

Post Top Detail
NTS

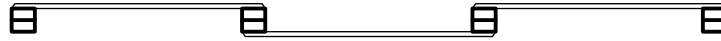

Plan View
NTS

38mm X 235mm (2"x10")
PT boards w/ chamfered edges

203 x 203 x 2440 (8" x 8" x
8'0") PT post c/w routed
dado (all sides), see Post Top
detail

13 x 114 (1/2" x 4.5") galv. lag
bolt & washer, predrill &
countersink

OR
#15 (5/16") exterior coated
structural screw, min. 50mm
(2") penetration into post

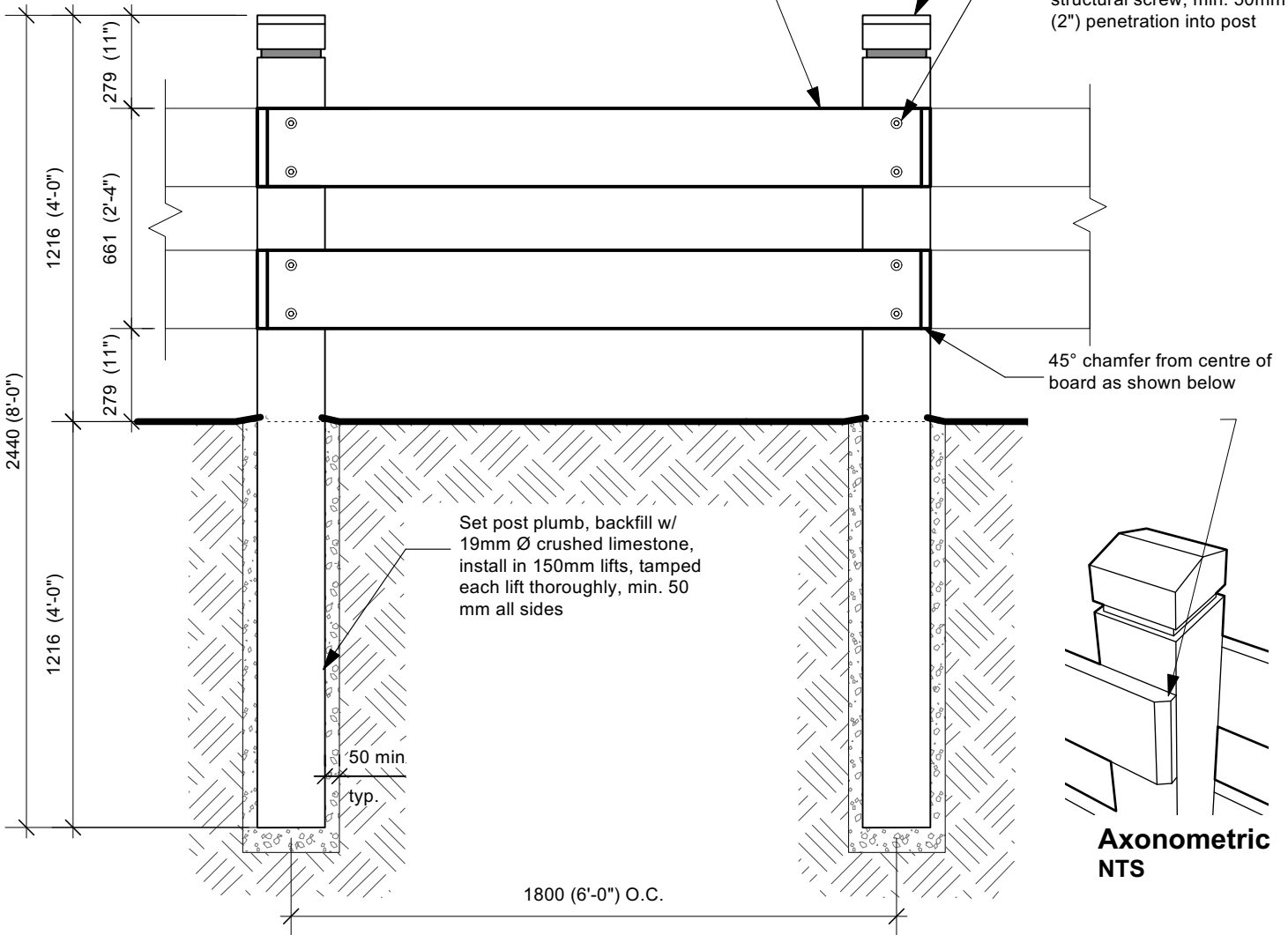

45° chamfer from centre of
board as shown below

Set post plumb, backfill w/
19mm Ø crushed limestone,
install in 150mm lifts, tamped
each lift thoroughly, min. 50
mm all sides

50 min
typ.

1800 (6'-0") O.C.

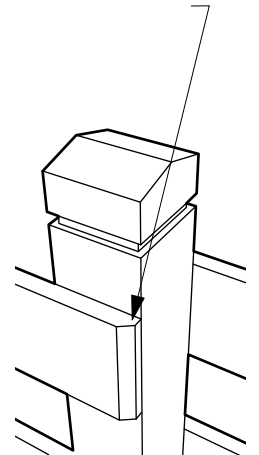

Axonometric
NTS

DIMENSIONS SHOWN ARE IN MILLIMETRES UNLESS OTHERWISE SPECIFIED

REVISION: 4
DATE: May 3/21
SCALE: N.T.S
DRAWN BY: IL/GZ

The City of Winnipeg
Planning, Property and Development Department
Planning and Land Use Division
Unit 15 - 30 Fort Street, Winnipeg, MB, R3C 4X5

