

NOTES:

Synthetic Turf to be suitable for sports field application and approved by Contract Administrator. Installed as per Manufacturer's written instructions.

Subgrade and Compacted Granular Base as per City of Winnipeg Specification CW 3110 – SUB-GRADE, SUB-BASE AND BASE COURSE CONSTRUCTION (latest revision)

Drawing Title:

SYNTHETIC TURF CRICKET PITCH WITH GRANULAR BASE

Drawing No:

SCD-376

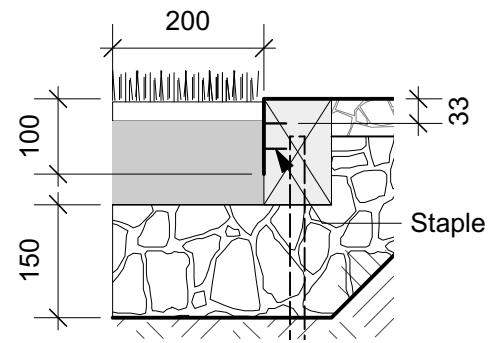
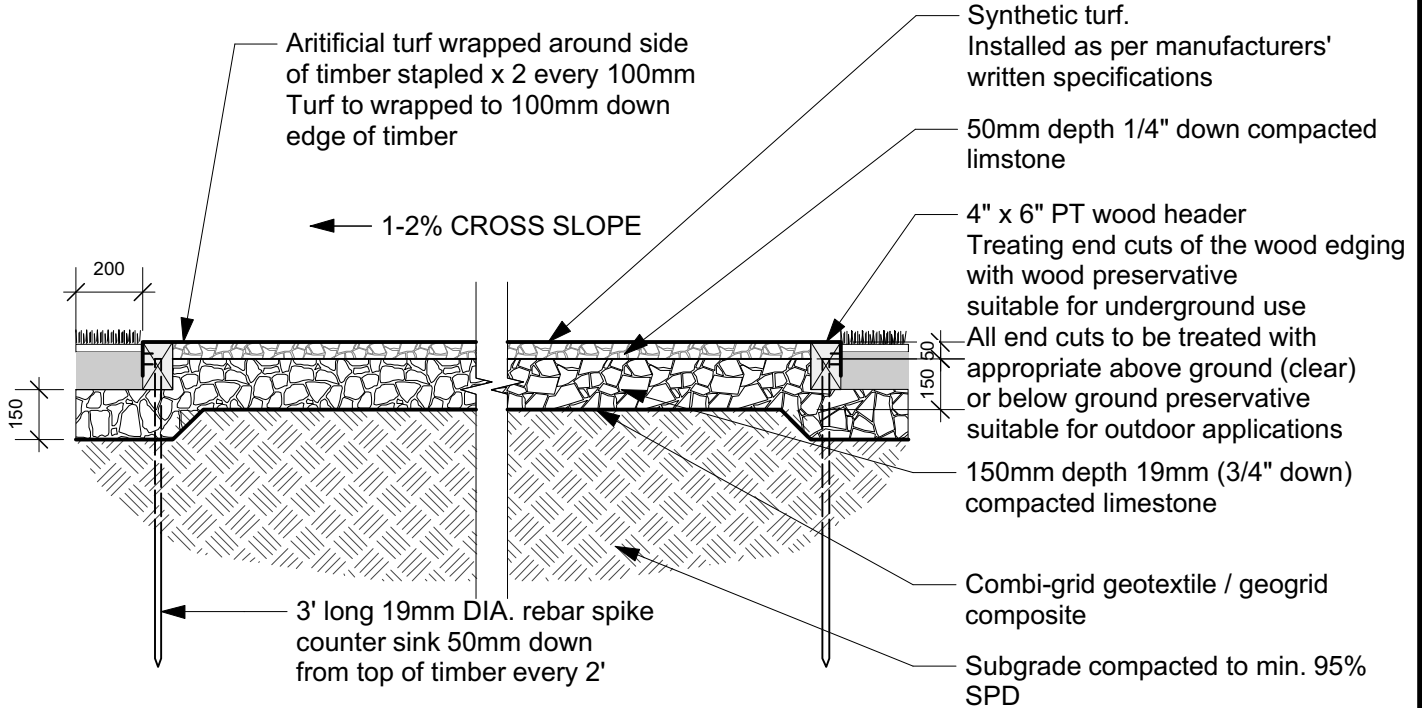

Artificial Turf Wrapping Detail

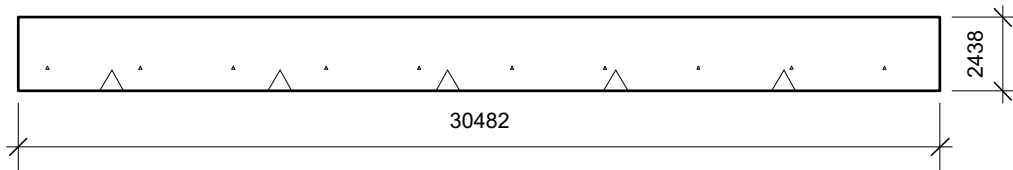

Pitch Plan View

DIMENSIONS SHOWN ARE IN MILLIMETRES UNLESS OTHERWISE SPECIFIED

REVISION:

DATE: Dec 13, 2019
 SCALE: N.T.S
 DRAWN BY: GZ

The City of Winnipeg
 Planning, Property and Development Department
 Planning and Land Use Division
 Unit 15 - 30 Fort Street, Winnipeg, MB, R3C 4X5

