

Empress Corridor Design Study

Stakeholder meeting

June 26, 2024

Welcome!

Introductions

Damir Muhurdarević – Project Manager – City of Winnipeg

David Wiebe – Project Manager – Dillon Consulting

Ryan Segal – Stakeholder Engagement – Urban Systems

Meeting purpose

- Share study information
- Help in understanding how your property and property access will be affected by the design and through future construction
- Collect feedback to help us ensure that the proposed improvements align with your property and operational needs

Meeting overview

Presentation

- Introductions and project background
- Existing conditions
- Conceptual design
- Next steps
- Questions

Review design and discussion with project team

Project area



Project scope

- Preliminary design of Empress corridor from St. Matthews Avenue to Saskatchewan Avenue
- Omand's Creek bank stabilization and naturalization
- Pedestrian/cycling facility improvements and connections
- Improved Transit stop facilities
- Culvert replacement (Wellington Avenue)

Background – project timeline



We are here!

Existing conditions

Existing conditions

There is a need for pedestrian & bicycle infrastructure.



Roadway pavements and sidewalks are in poor condition.



Omand's Creek bank stabilization will be required.



Existing conditions

Vehicle turning and access is challenging in some locations and intersections



Walmart Entrance

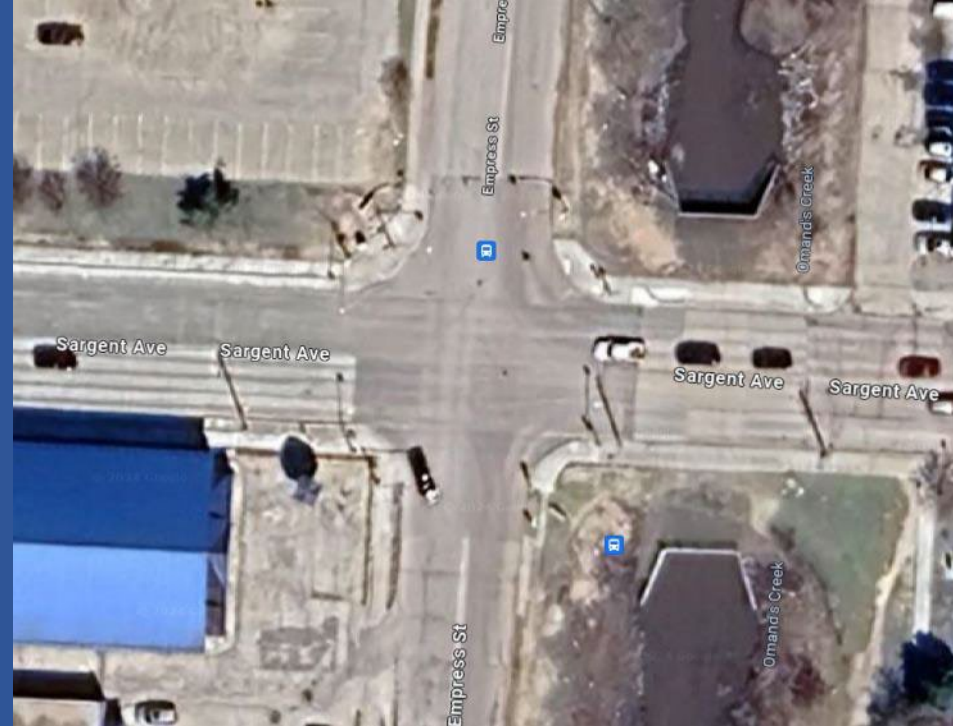

Sargent Avenue

Pedestrian and cycling network

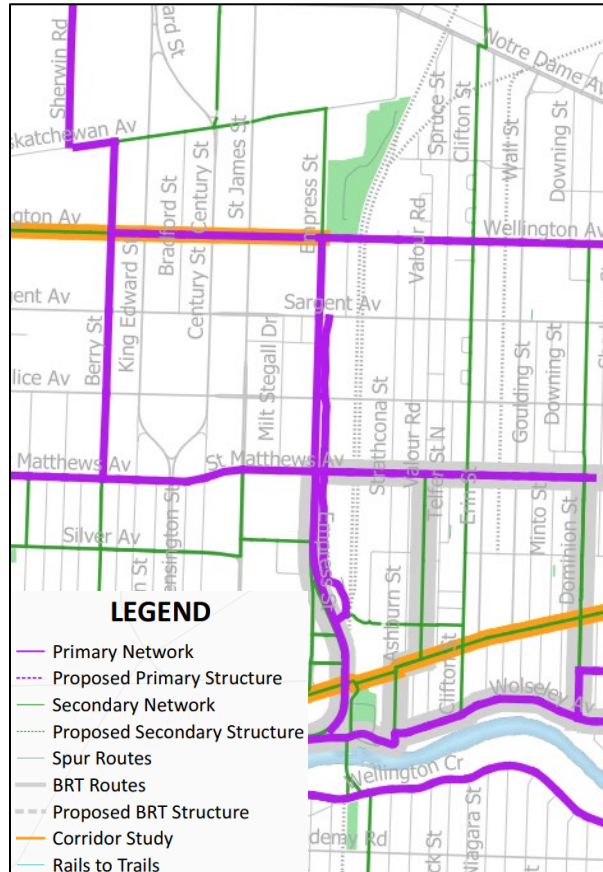

- Identified in the Pedestrian and Cycling Strategies (2015)
- Design:
 - Connect to existing bicycle infrastructure on Empress
 - Connect to Wellington Avenue
 - Wellington Railway crossing – alternate route

Pedestrian and cycling network

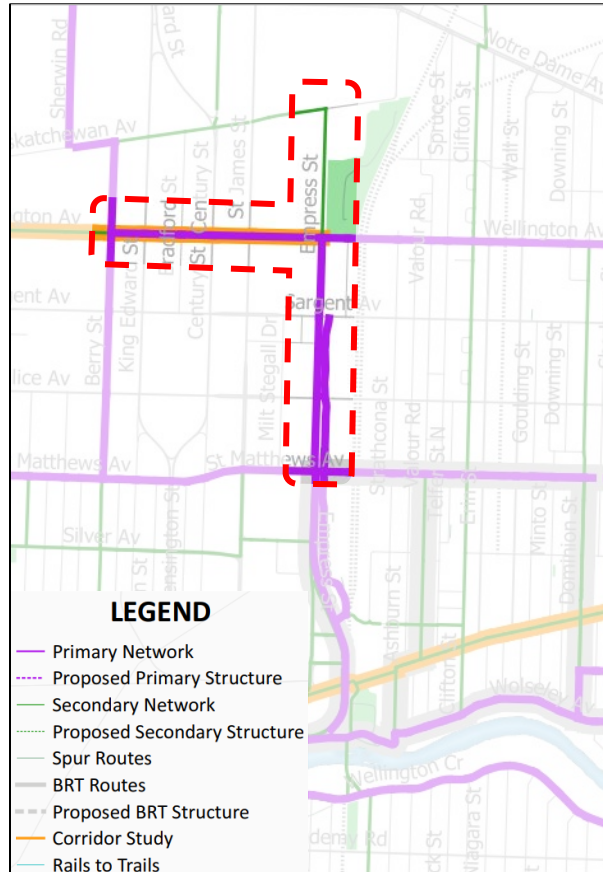

- Identified in the Pedestrian and Cycling Strategies (2015)
- Design:
 - Connect to existing bicycle infrastructure on Empress
 - Connect to Wellington Avenue
 - Wellington Railway crossing – alternate route

Conceptual design

Project area segments

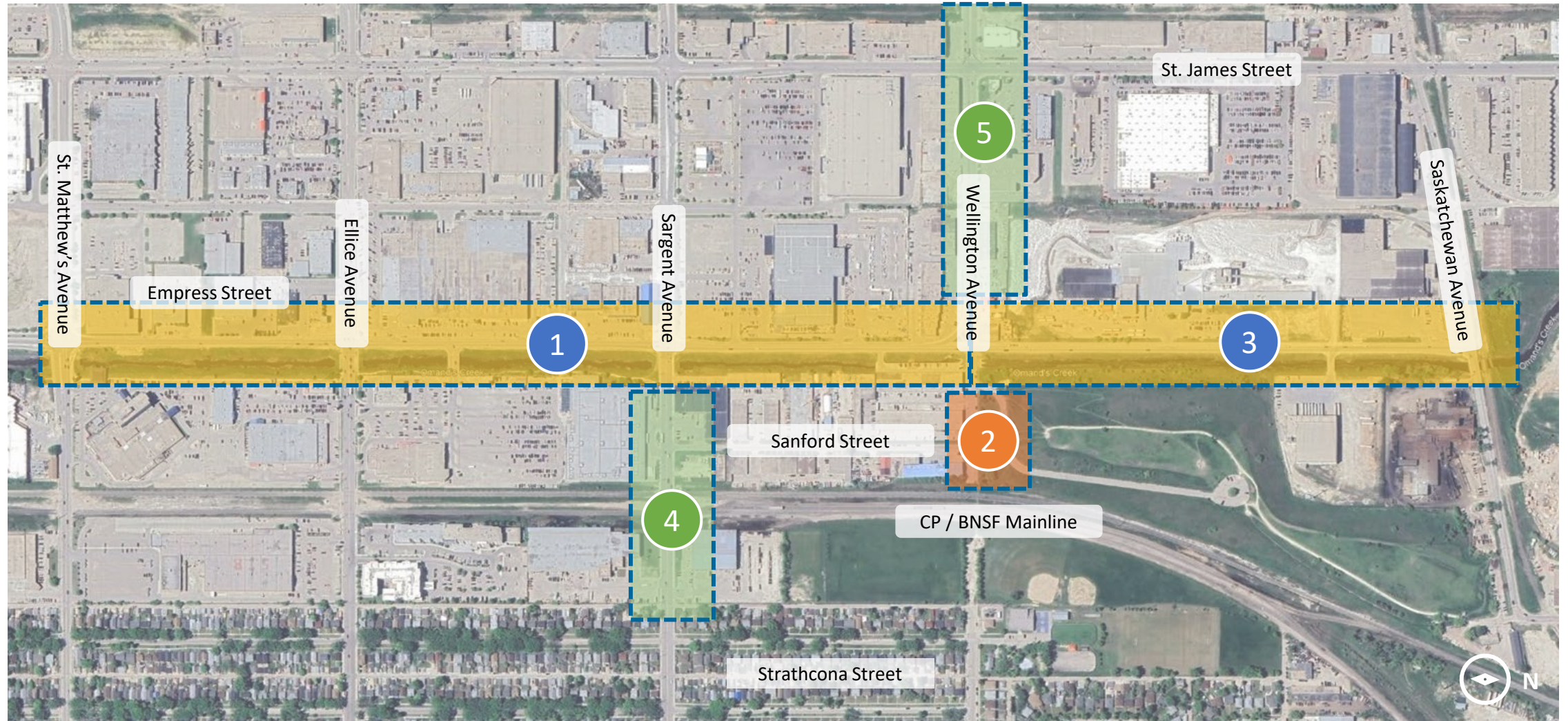



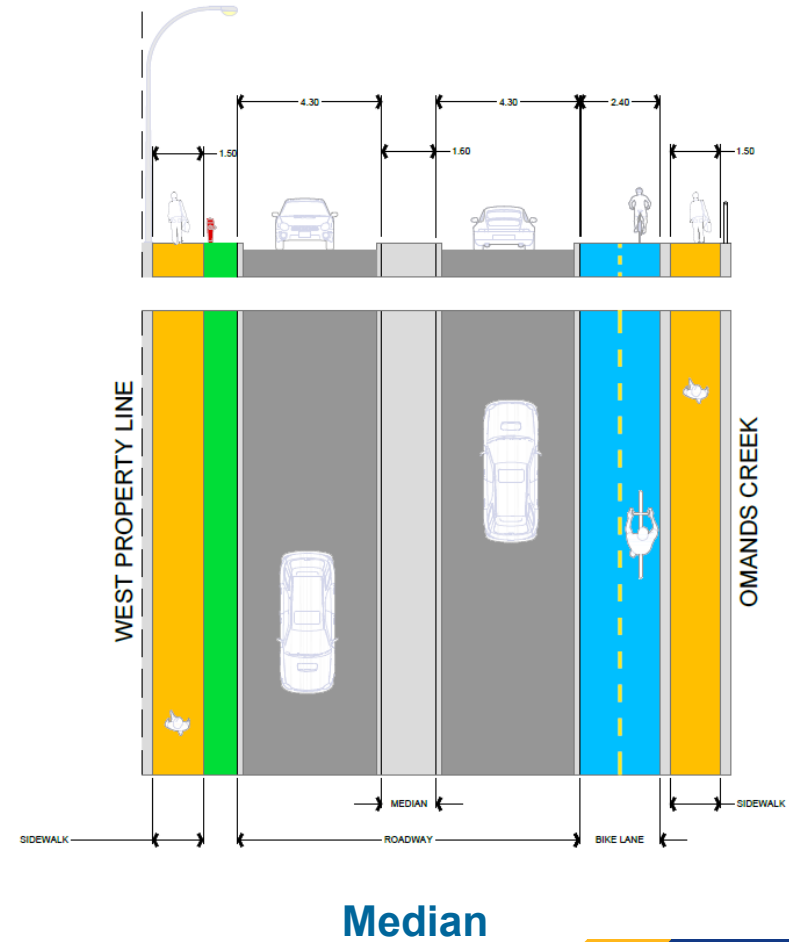
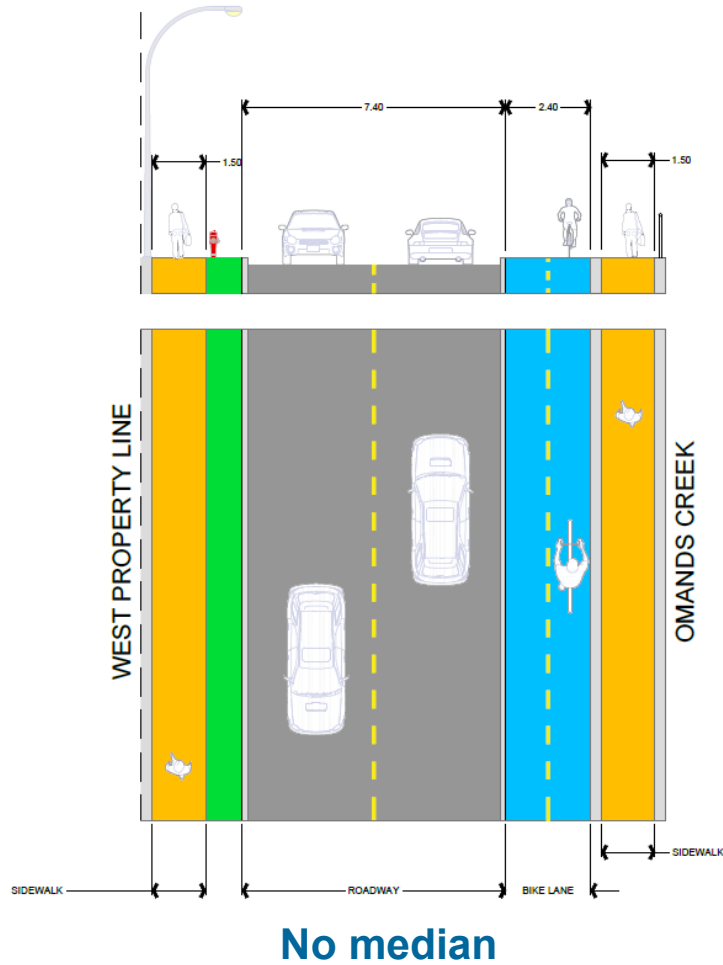



Roadway design

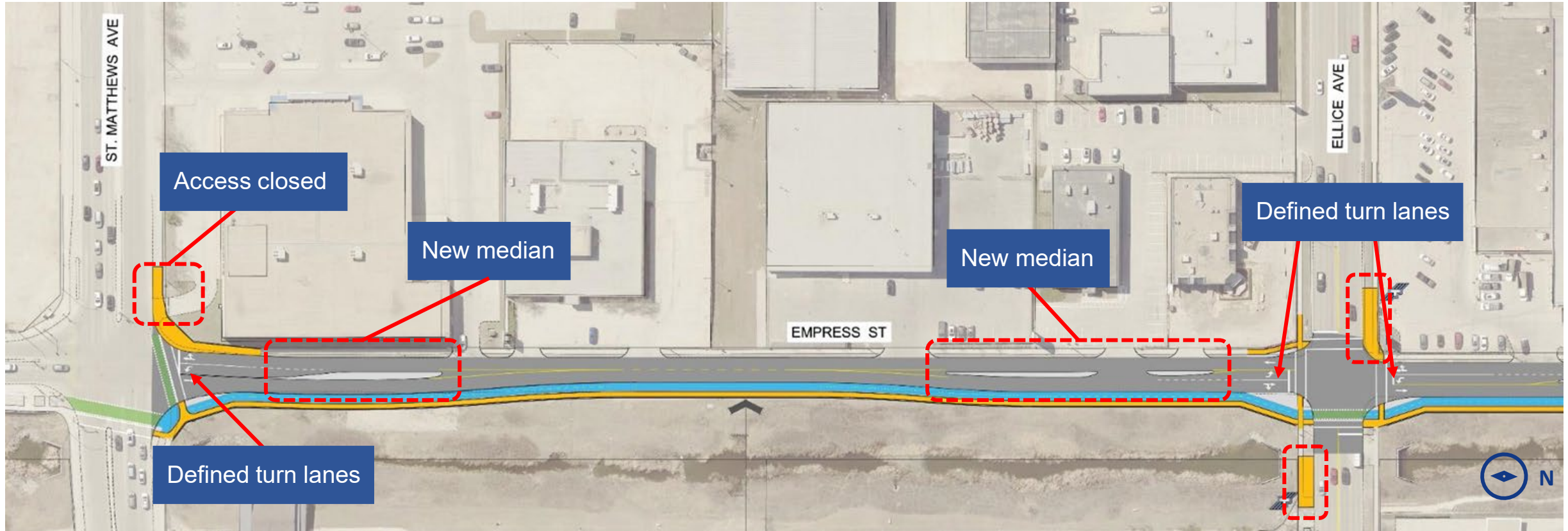
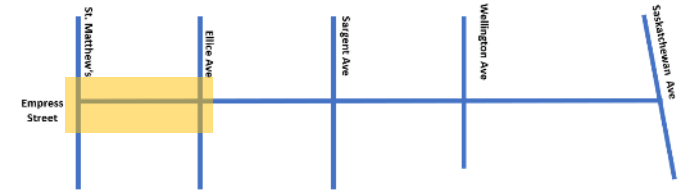

Design overview

1 St. Matthews Avenue to Ellice Avenue

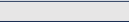





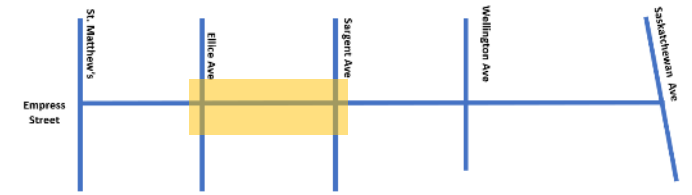

- | | |
|-----------------------------------------------------------------------------------------------------------|-----------------------------------------------------------------------------------------------------------------|
|  Sidewalk |  Roadway |
|  Bicycle infrastructure |  Median / concrete boulevard |
|  Intersection crossing |  Existing sidewalk |

Design overview

1 Ellice Avenue to Sargent Avenue





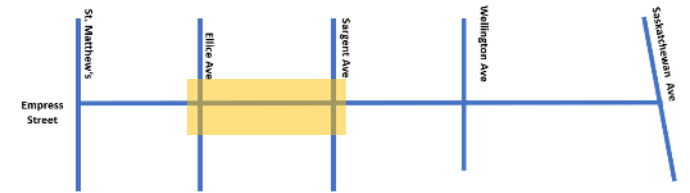

-  Sidewalk
-  Bicycle infrastructure
-  Intersection crossing
-  Roadway
-  Median / concrete boulevard
-  Existing sidewalk

Design overview

1 Ellice Avenue to Sargent Avenue



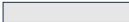



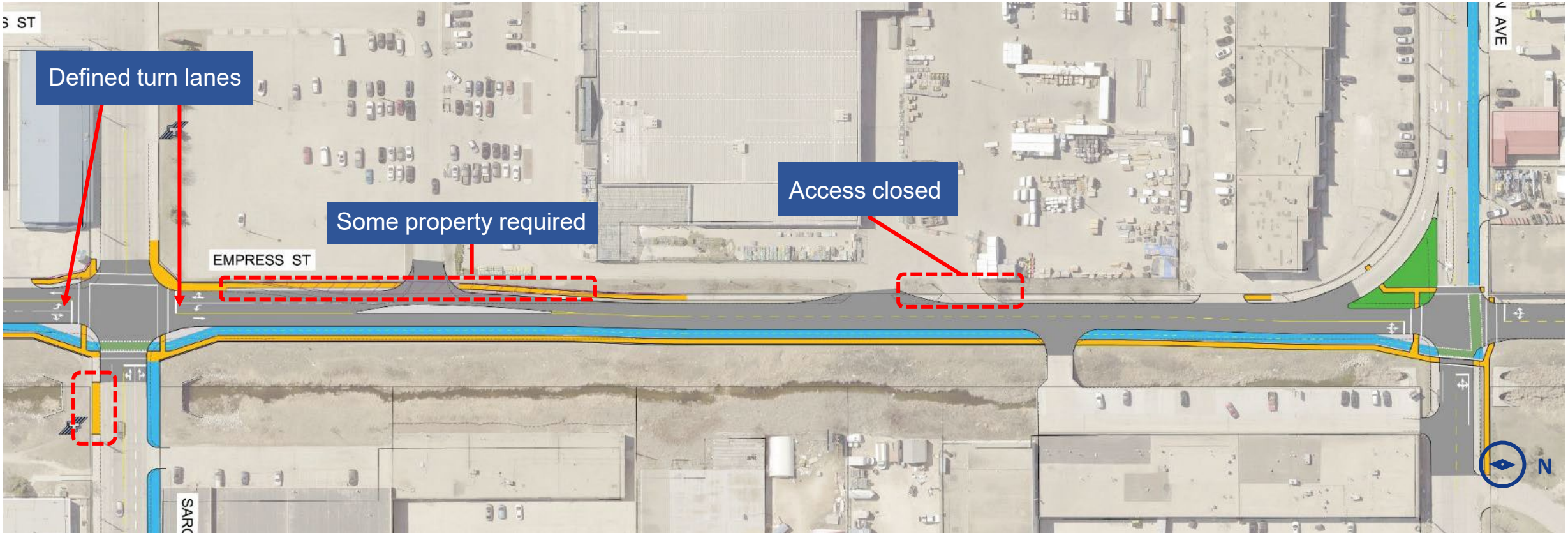
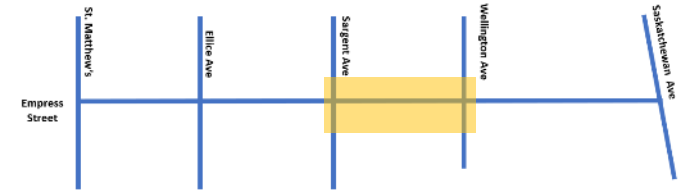

Alterations to access required for grade compatibility with pedestrian and bike infrastructure

- | | |
|-----------------------------------------------------------------------------------------------------------|-----------------------------------------------------------------------------------------------------------------|
|  Sidewalk |  Roadway |
|  Bicycle infrastructure |  Median / concrete boulevard |
|  Intersection crossing |  Existing sidewalk |

Design overview

1 Sargent Avenue to Wellington Avenue



-  Sidewalk
-  Bicycle infrastructure
-  Intersection crossing
-  Roadway
-  Median / concrete boulevard
-  Existing sidewalk

Design overview

1 Sargent Avenue to Wellington Avenue

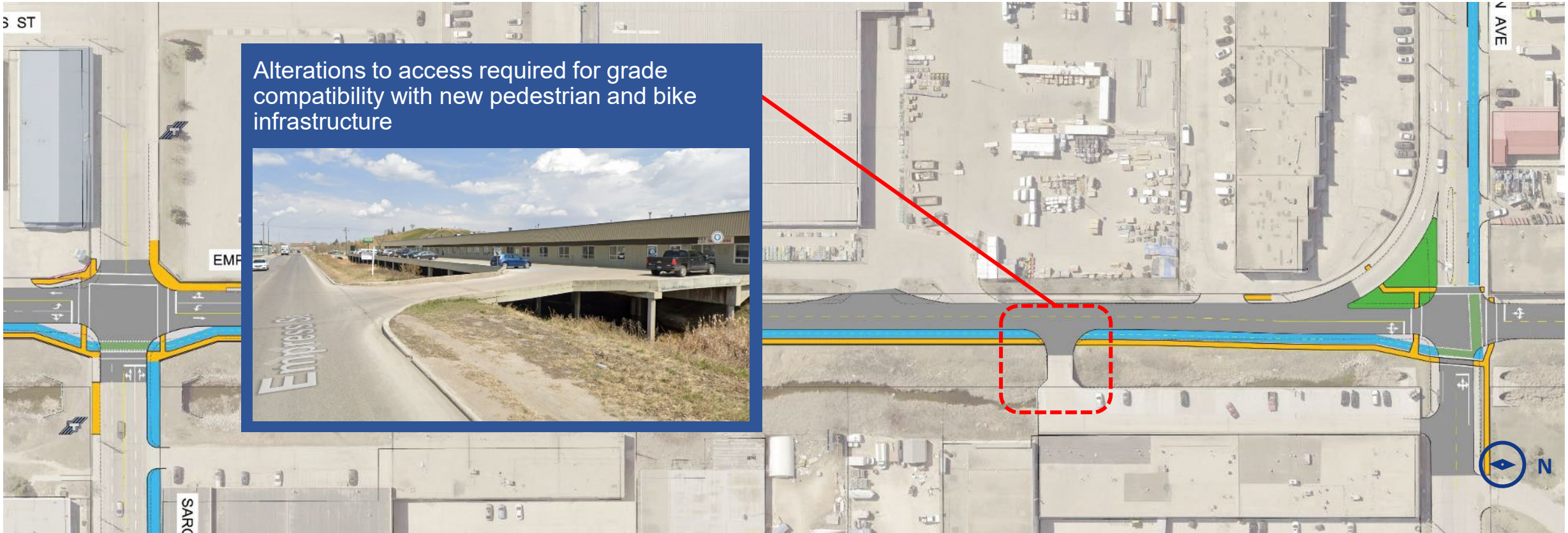
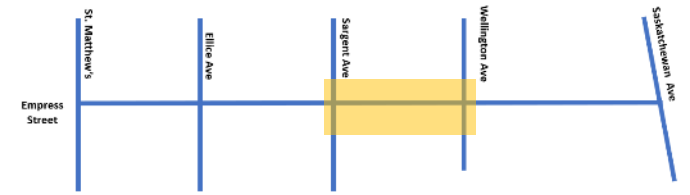





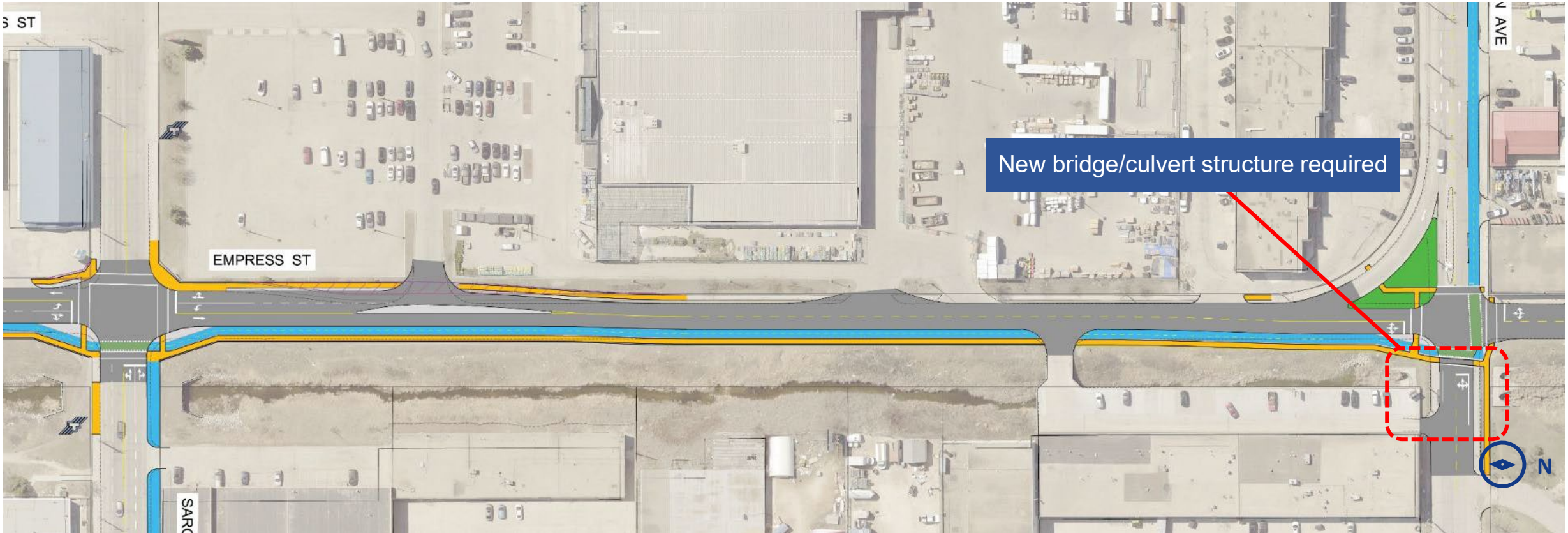
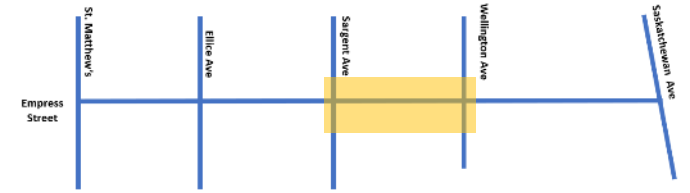

Alterations to access required for grade compatibility with new pedestrian and bike infrastructure

- Sidewalk
- Bicycle infrastructure
- Intersection crossing
- Roadway
- Median / concrete boulevard
- Existing sidewalk

Design overview

1 Sargent Avenue to Wellington Avenue

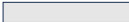

- | | |
|-----------------------------------------------------------------------------------------------------------|-----------------------------------------------------------------------------------------------------------------|
|  Sidewalk |  Roadway |
|  Bicycle infrastructure |  Median / concrete boulevard |
|  Intersection crossing |  Existing sidewalk |

Design overview

2 Option 1: Single-span bridge with cast-in-place deck

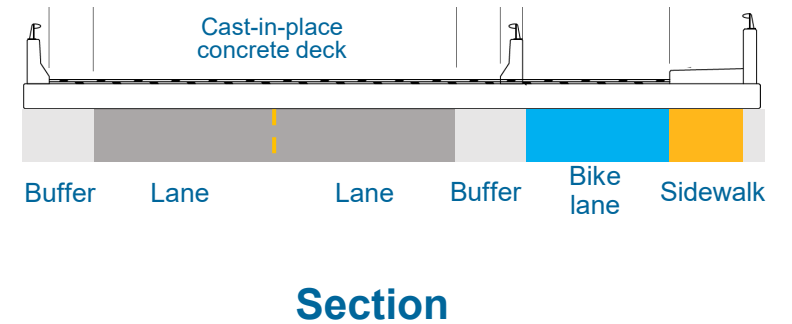
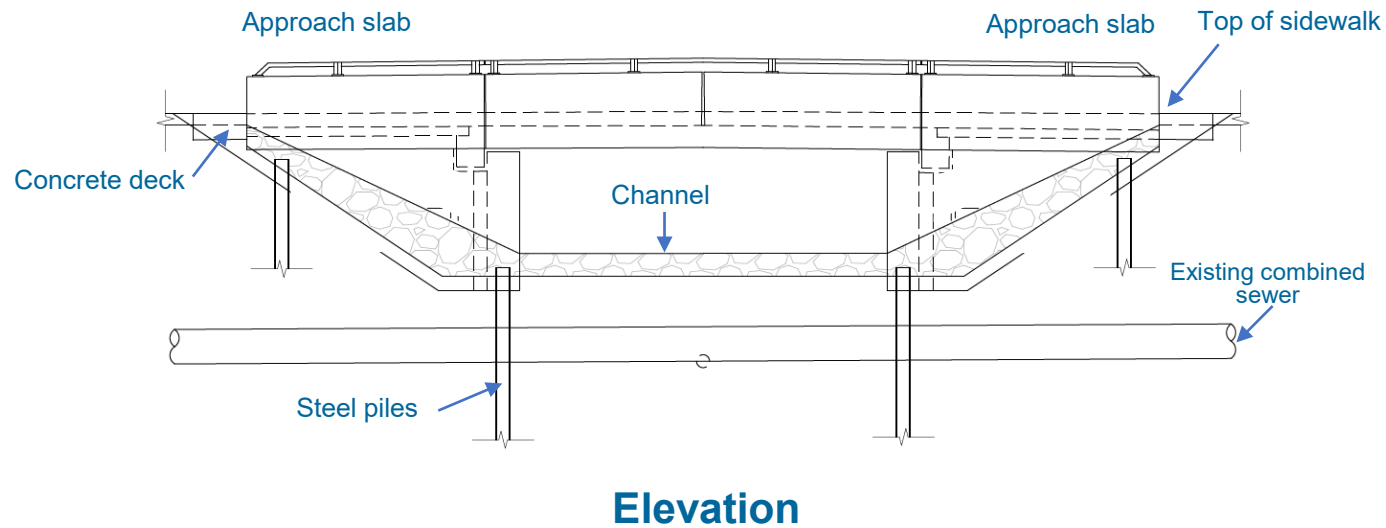

Design overview

2 Option 2 – Double cell cast-in-place concrete box culvert

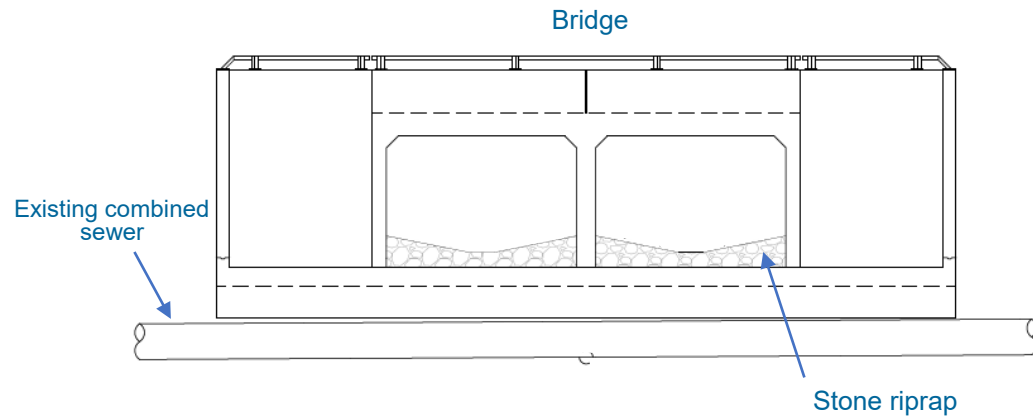

Section

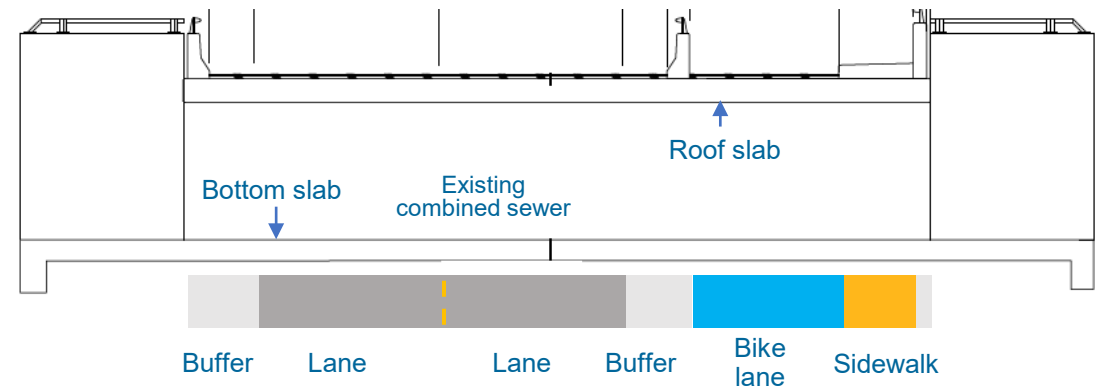

Elevation







(looking west)

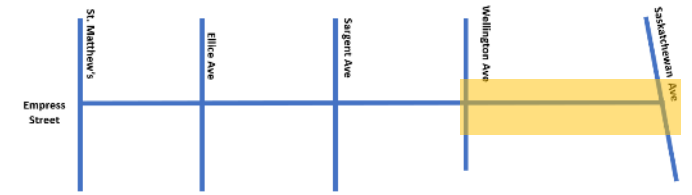

Design overview

3 Wellington Avenue to Saskatchewan Ave

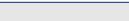



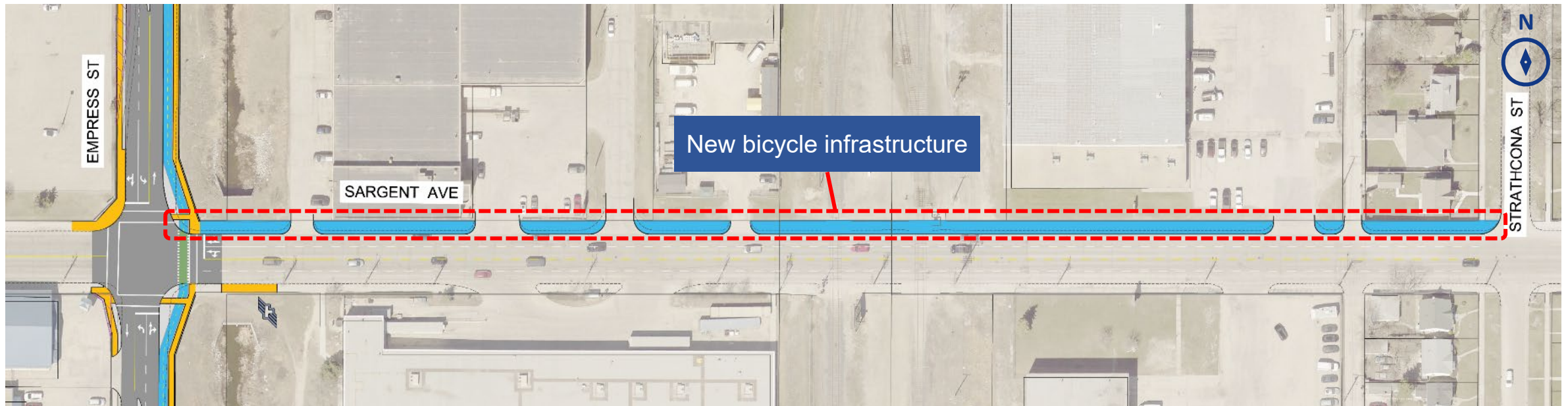
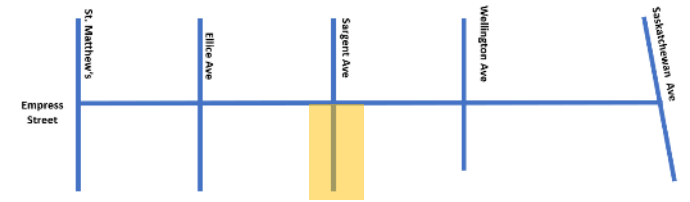

-  Sidewalk
-  Bicycle infrastructure
-  Intersection crossing
-  Roadway
-  Median / concrete boulevard
-  Existing sidewalk

Design overview

4 Sargent Avenue bicycle infrastructure





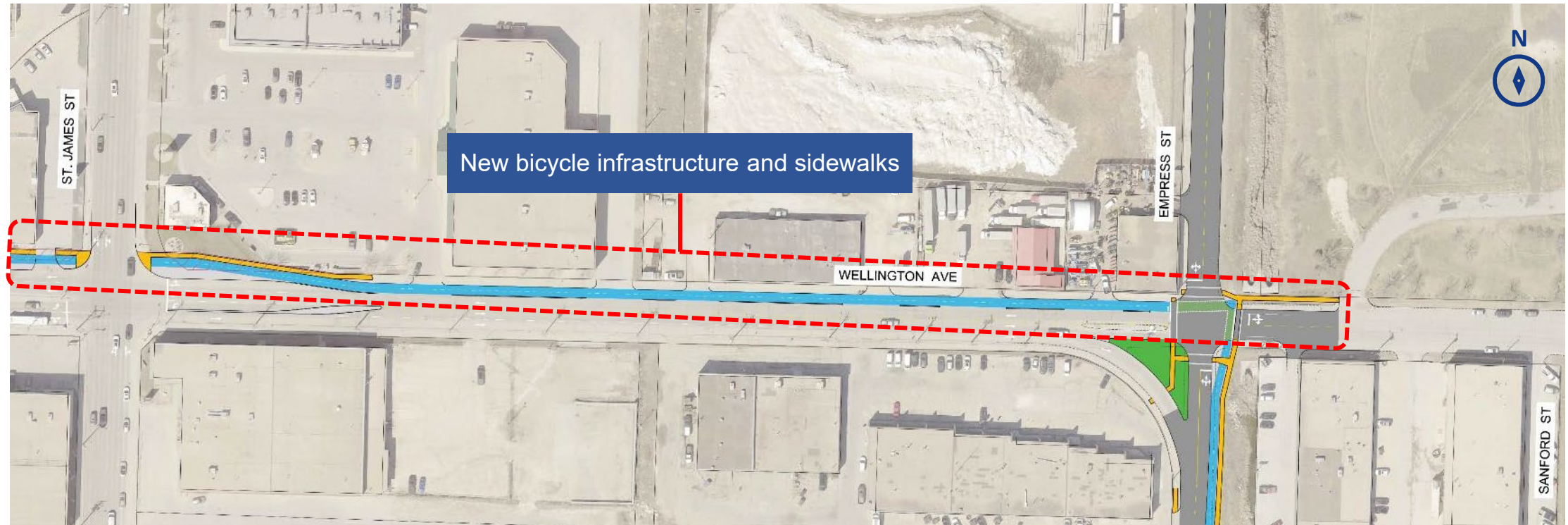
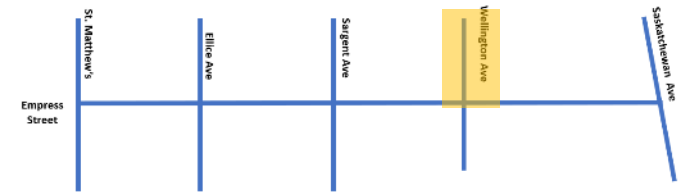

-  Sidewalk
-  Bicycle infrastructure
-  Intersection crossing
-  Existing sidewalk

Design overview

5 Wellington Avenue bicycle infrastructure



-  Sidewalk
-  Bicycle infrastructure
-  Intersection crossing
-  Existing sidewalk

Design overview



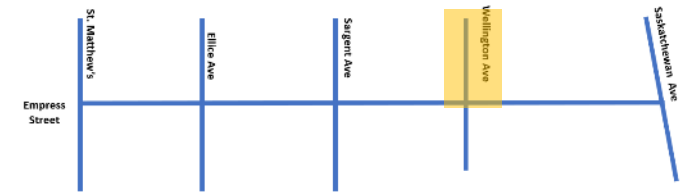

5 Wellington Avenue bicycle infrastructure

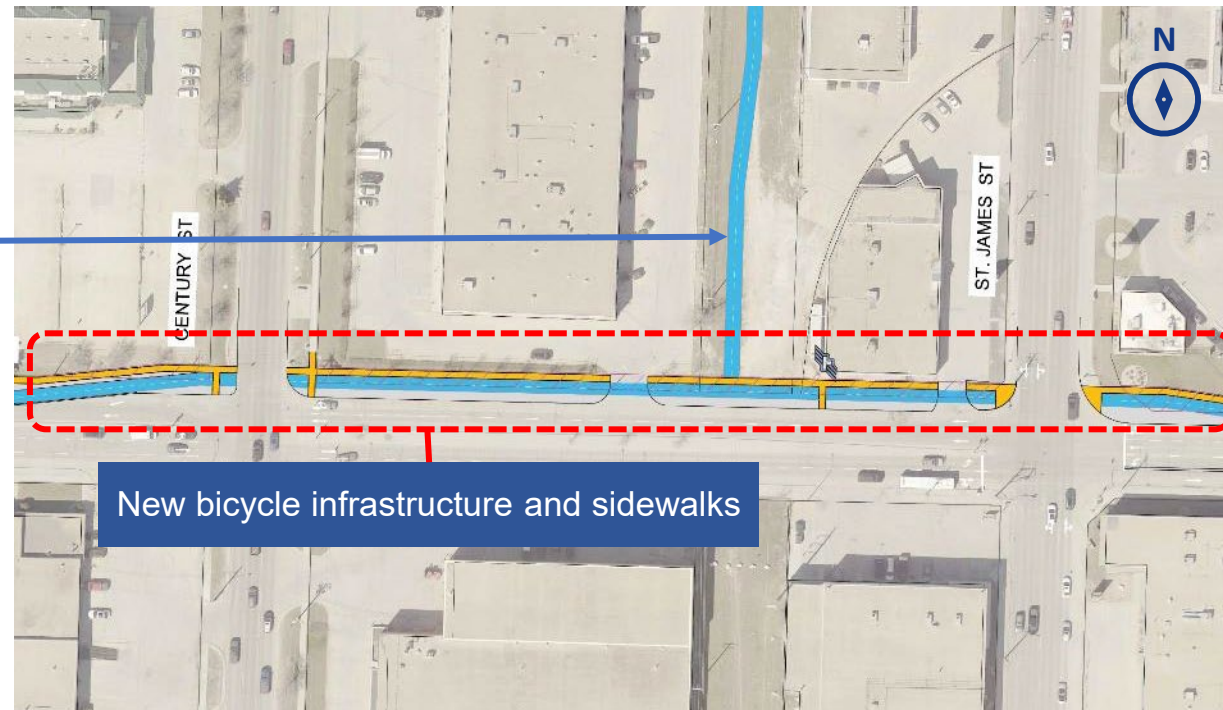

New bicycle infrastructure







New bicycle infrastructure and sidewalks

-  Sidewalk
-  Bicycle infrastructure
-  Intersection crossing
-  Existing sidewalk

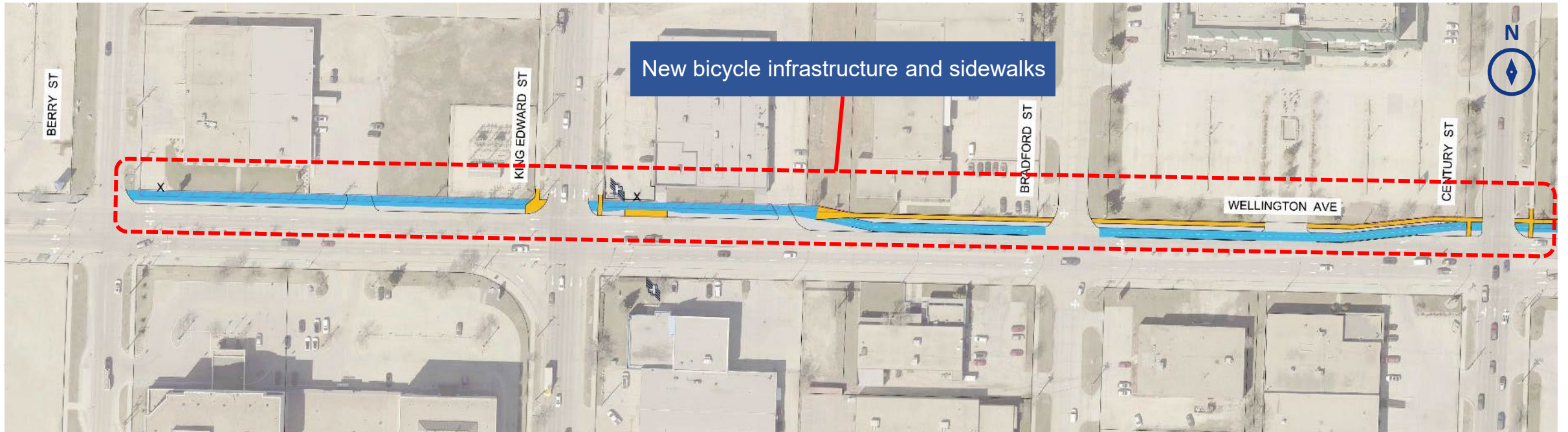
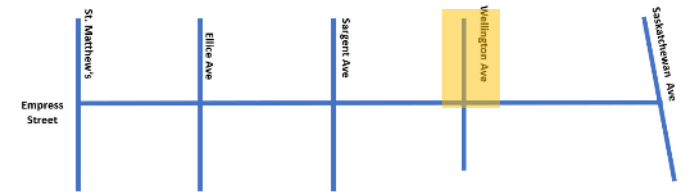
Design overview

5 Wellington Avenue bicycle infrastructure



-  Sidewalk
-  Bicycle infrastructure
-  Intersection crossing
-  Existing sidewalk

Next steps



We are here!

Next Steps:

Preliminary design

&

Submit final preliminary design report

Thank you

Questions

Empress Corridor Design Study

rsegal@urbansystems.ca

204-259-3691

