

P:\2019\160379200-2019-2023 Eira-Wall-Sargent Street\103 CAD\09 Staging\Sargent\1603792 Sargent Staging - FOR CITY WEBSITE.dwg Last Saved: 30/2020 9:41 AM by diana P:\2019\160379200-2019-2023 Eira-Wall-Sargent Street\103 CAD\09 Staging\Sargent\1603792 Sargent Staging - FOR CITY WEBSITE.dwg

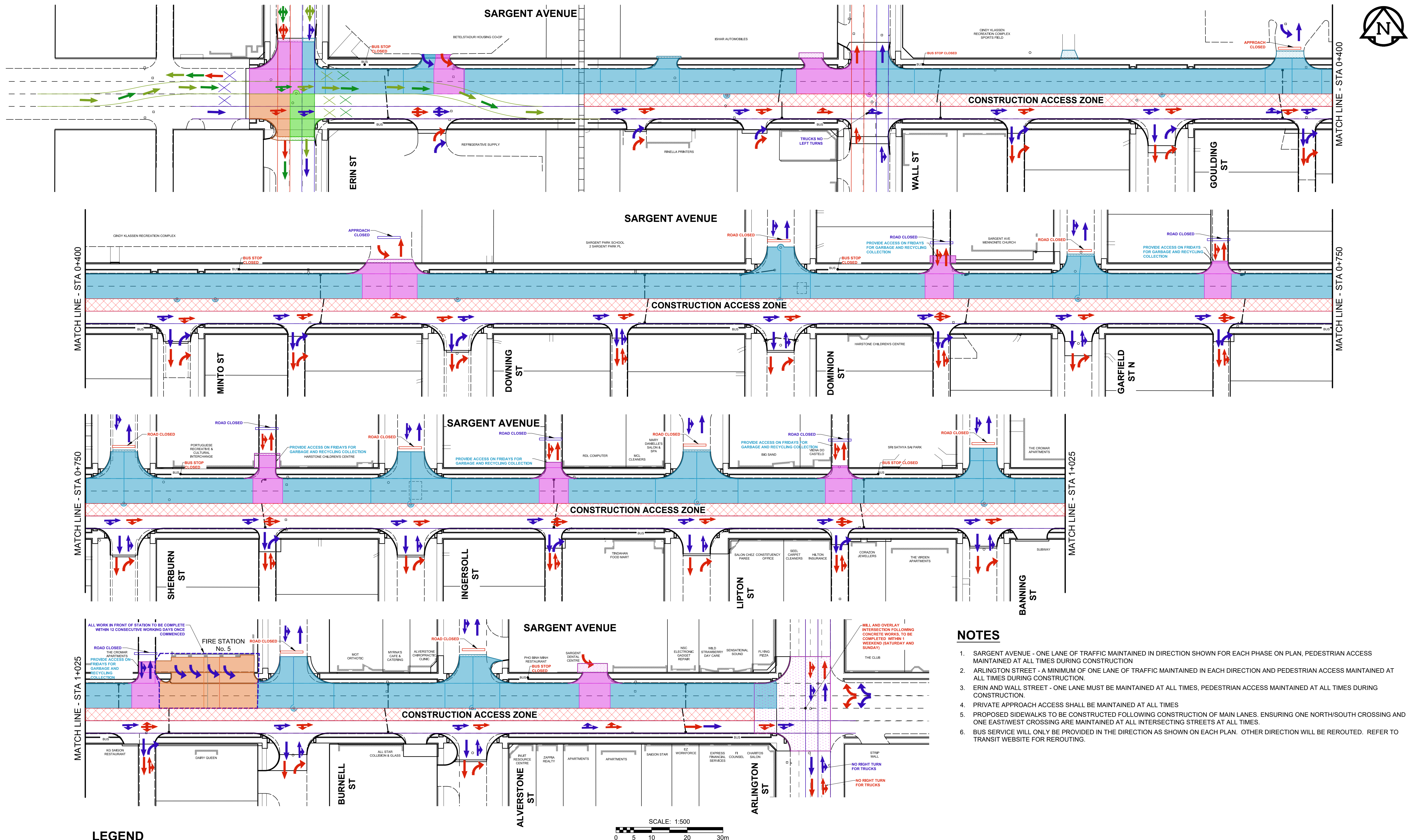

LEGEND

PHASE 2

- STAGE 3 - TRAFFIC
- STAGE 3 - CONSTRUCTION
- STAGE 3 - ASPHALT OVERLAY
- STAGE 4 - TRAFFIC
- STAGE 4 - CONSTRUCTION
- STAGE 4 - ASPHALT OVERLAY

- STAGE 5 - TRAFFIC
- STAGE 5 - CONSTRUCTION
- STAGE 5 - ASPHALT OVERLAY
- STAGE 6 - TRAFFIC
- STAGE 6 - CONSTRUCTION
- STAGE 6 - ASPHALT OVERLAY

SCALE: 1:500
0 5 10 20 30m

NOTES

- SARGENT AVENUE - ONE LANE OF TRAFFIC MAINTAINED IN DIRECTION SHOWN FOR EACH PHASE ON PLAN, PEDESTRIAN ACCESS MAINTAINED AT ALL TIMES DURING CONSTRUCTION
- ARLINGTON STREET - A MINIMUM OF ONE LANE OF TRAFFIC MAINTAINED IN EACH DIRECTION AND PEDESTRIAN ACCESS MAINTAINED AT ALL TIMES DURING CONSTRUCTION.
- ERIN AND WALL STREET - ONE LANE MUST BE MAINTAINED AT ALL TIMES, PEDESTRIAN ACCESS MAINTAINED AT ALL TIMES DURING CONSTRUCTION.
- PRIVATE APPROACH ACCESS SHALL BE MAINTAINED AT ALL TIMES
- PROPOSED SIDEWALKS TO BE CONSTRUCTED FOLLOWING CONSTRUCTION OF MAIN LANES. ENSURING ONE NORTH/SOUTH CROSSING AND ONE EAST/WEST CROSSING ARE MAINTAINED AT ALL INTERSECTING STREETS AT ALL TIMES.
- BUS SERVICE WILL ONLY BE PROVIDED IN THE DIRECTION AS SHOWN ON EACH PLAN. OTHER DIRECTION WILL BE REROUTED. REFER TO TRANSIT WEBSITE FOR REROUTING.