

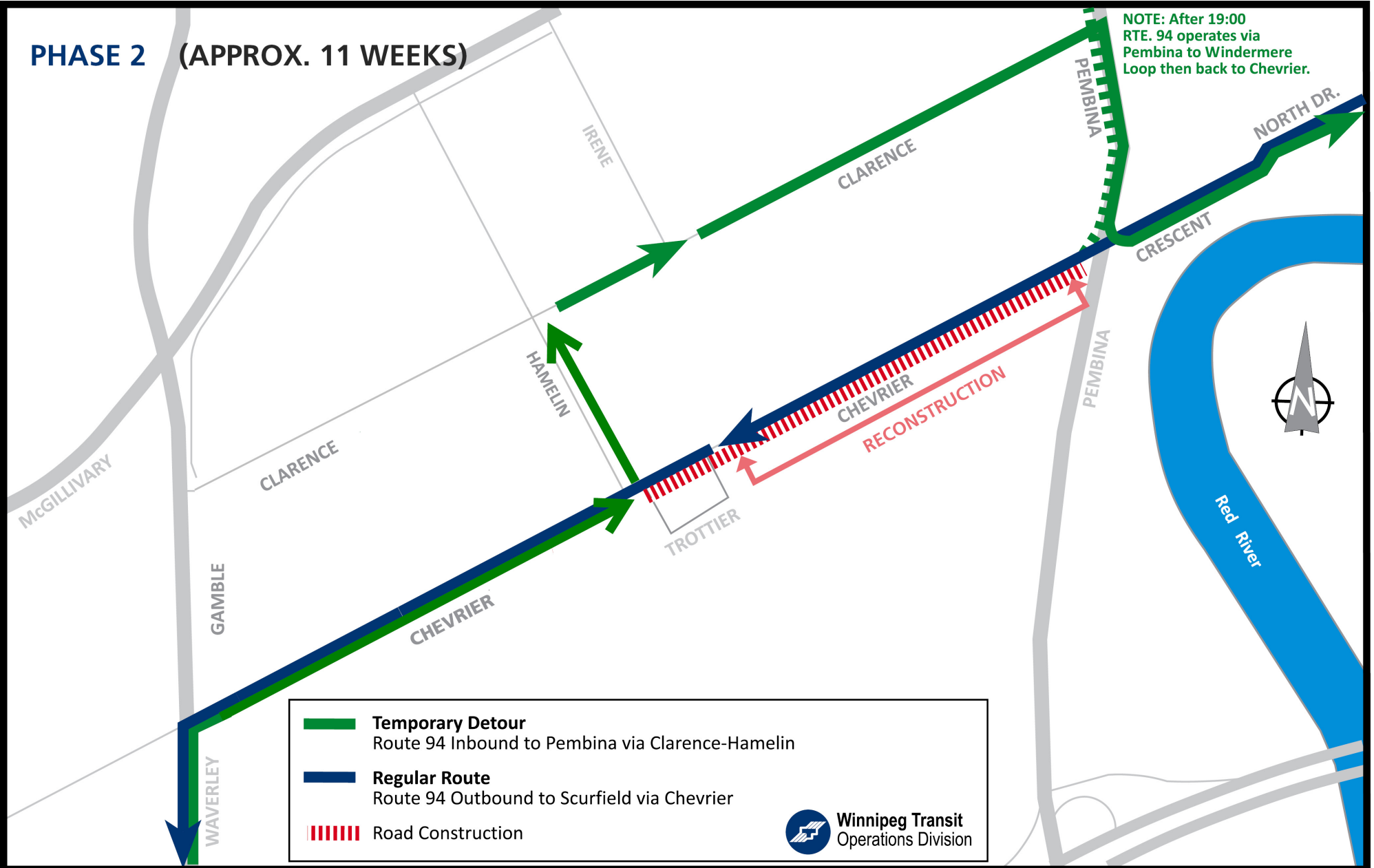



ROUTE 94 during Chevrier Bv. Reconstruction

PHASE 2 (APPROX. 11 WEEKS)

NOTE: After 19:00 RTE. 94 operates via Pembina to Windermere Loop then back to Chevrier.



	Temporary Detour Route 94 Inbound to Pembina via Clarence-Hamelin
	Regular Route Route 94 Outbound to Scurfield via Chevrier
	Road Construction

 **Winnipeg Transit**
Operations Division